

B.M. 34.5329 ELEV. 11.75.964  
 12" DIA. 7.6 IN. WINGS W/ 4" CONC. & P.C. CONCRETE  
 1" W/4 OF E. END 4.1 21" W/4 140000 &  
 MULHOLLAND DRIVE & MULHOLLAND INT. HIGHWAY  
 MULHOLLAND DRIVE & MULHOLLAND HIGHWAY  
 12/12/11 QUAD. 19 60

DOUBLE SCALE  
 CALABASAS BLDG. DIST. NO. 91

PROFILE ALIGNMENT AND GRADE OF P.C. 7611  
 SANITARY SEWERS PAGE 1  
 TO BE CONSTRUCTED IN

RECONSTRUCTION EAST OF MULHOLLAND DRIVE

PRIVATE CONTRACT NO. 7611

W.S. 60  
 1 SHEETS, 2 PAGES

SCALE: VERT. 1" = 4' HORIZ. 1" = 40'

MARCH, 1968  
 PREPARED IN THE OFFICES OF  
 ERVIN ENGINEERING  
 320 N. OLIVE ST. LOS ANGELES, CALIFORNIA 90012  
 Fred J. Ervin  
 REG. C. E. NO. 17812

39860

FOR LEGEND SEE PLAN NO. S-1

- NOTES:
1. NO REPRESENTATIVE OF THE COUNTY ENGINEER WILL SURVEY OR LAY OUT ANY PORTION OF THE WORK.
  2. NO REVISIONS SHALL BE MADE IN THESE PLANS WITHOUT THE APPROVAL OF THE COUNTY ENGINEER.
  3. THE CONTRACTOR SHALL NOTIFY THE CONSTRUCTION DIVISION BY TELEPHONE, MADISON 9-4747, EXT. 8158, AT LEAST TWENTY-FOUR HOURS BEFORE STARTING ANY WORK UNDER THIS CONTRACT.
  4. MANHOLE SHALL BE BRICK SEWER STRUCTURES PER S-3. PRECAST CONCRETE MANHOLES PER S-5 OR S-6 MAY BE USED AS AN ALTERNATE IN LOCATIONS APPROVED BY THE COUNTY ENGINEER.
  5. USE STANDARD MANHOLE FRAMES AND COVERS, S-15, EXCEPT AS NOTED.
  6. MANHOLE TOPS IN UNIMPROVED RIGHTS-OF-WAY TO BE SIX INCHES ABOVE FINISHED GRADE.
  7. USE EXTRA STRENGTH PIPE. ALL PIPE IS STANDARD DEPTH EXCEPT AS NOTED.
  8. USE MECHANICAL COMPRESSION JOINTS FOR ALL V.C.P. JOINTS PER SPECS., SECS. 34 & 40.
  9. IF DURING THE COURSE OF CONSTRUCTION IT IS DETERMINED THAT THERE IS LESS THAN FOUR FEET OF COVER OVER THE TOP OF A MAIN LINE V.C.P. SEWER WHICH IS NOT INDICATED ON THE PLANS, THE PIPE SHALL BE ENCASED PER S-23 UNLESS OTHERWISE APPROVED BY THE COUNTY ENGINEER.
  10. FOR ALLOWABLE LEAKAGE TEST USE FORMULA NO. 1, SPECS., SEC. 54. METHOD USED FOR TESTING WILL BE THE SAME AS LOS ANGELES COUNTY EXCEPT THE FORMULA TO BE USED IS AS FOLLOWS:  
 $0.033 \text{ GALLONS / MINUTE / INCH OF DIAMETER / 1000 FEET}$   
 $\text{OR } 250 \text{ GALLONS / DAY / INCH OF DIAMETER / MILE.}$
  11. ALL STATE & LOCAL TRAFFIC SAFETY DEVICES WILL BE PROMPTLY ENFORCED.
  12. MANHOLE LEAKAGE TESTS AT THE DISCRETION OF THE DISTRICT'S REPRESENTATIVE ONE MANHOLE OUT OF EVERY TEN MANHOLES, AND A MINIMUM OF TWO SHALL BE FILLED WITH WATER AND AFTER THREE HOURS WILL BE CHECKED FOR LEAKAGE. WITH NO LEAKS IN LEVEL, TOP COVER AND MANHOLE NOT PASSING TESTS THE MORE WILL BE TESTED AT THE DISCRETION OF THE DISTRICT'S REPRESENTATIVE.

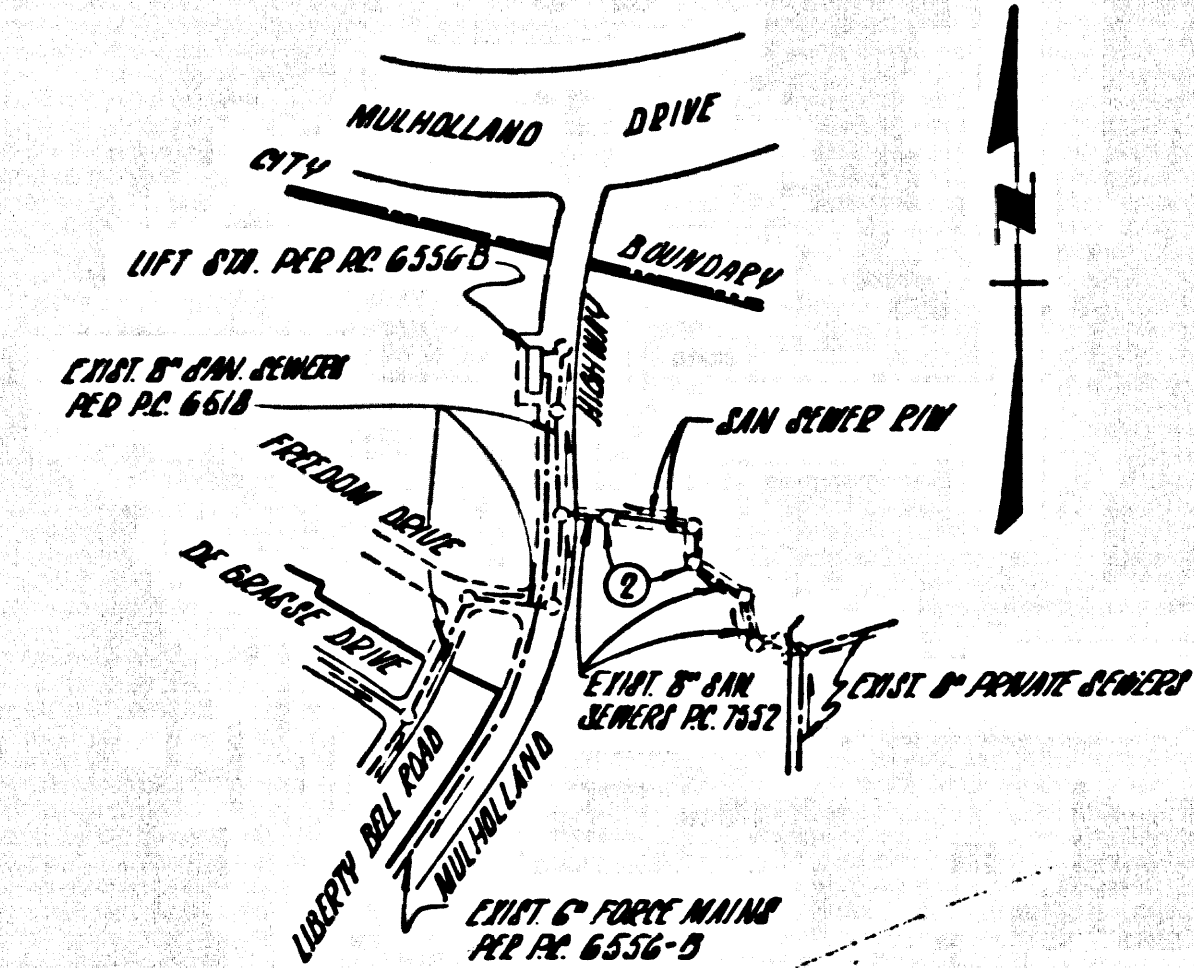

INDEX MAP  
 RECONSTRUCTION EAST OF MULHOLLAND DRIVE  
 PC 7611  
 SCALE: 1" = 600'

PRIVATE ENGINEER'S  
 NOTICE TO CONTRACTOR  
 THE EXISTENCE AND LOCATION OF ANY UNDERGROUND UTILITY PIPES OR STRUCTURES SHOWN ON THESE PLANS ARE OBTAINED BY A SEARCH OF THE AVAILABLE RECORDS TO THE BEST OF OUR KNOWLEDGE THERE ARE NO EXISTING UTILITIES EXCEPT AS SHOWN ON THIS MAP. THE CONTRACTOR IS REQUIRED TO TAKE PRECAUTIONARY MEASURES TO PROTECT THE UTILITY LINES SHOWN AND ANY OTHER LINES NOT OF RECORD OR NOT SHOWN ON THIS DRAWING.

COLLECT CHARGES  
 AS INDICATED  
 William Ervin

COUNTY OF LOS ANGELES, CALIFORNIA  
 JOHN A. LAMBIE, COUNTY ENGINEER  
 L.A. VIRBENER MUNICIPAL WATER DISTRICT  
 APPROVED BY: [Signature] ASSISTANT SANITATION ENGINEER  
 APPROVED BY: [Signature] OFFICE ENGINEER  
 SUBMITTED BY: [Signature] REGIONAL ENGINEER  
 APPROVED BY: [Signature] CHIEF ENGINEER - REGIONAL MANAGER  
 CHECKED BY: [Signature] REG. C.E. NO. 12653

J.N. 0367.87

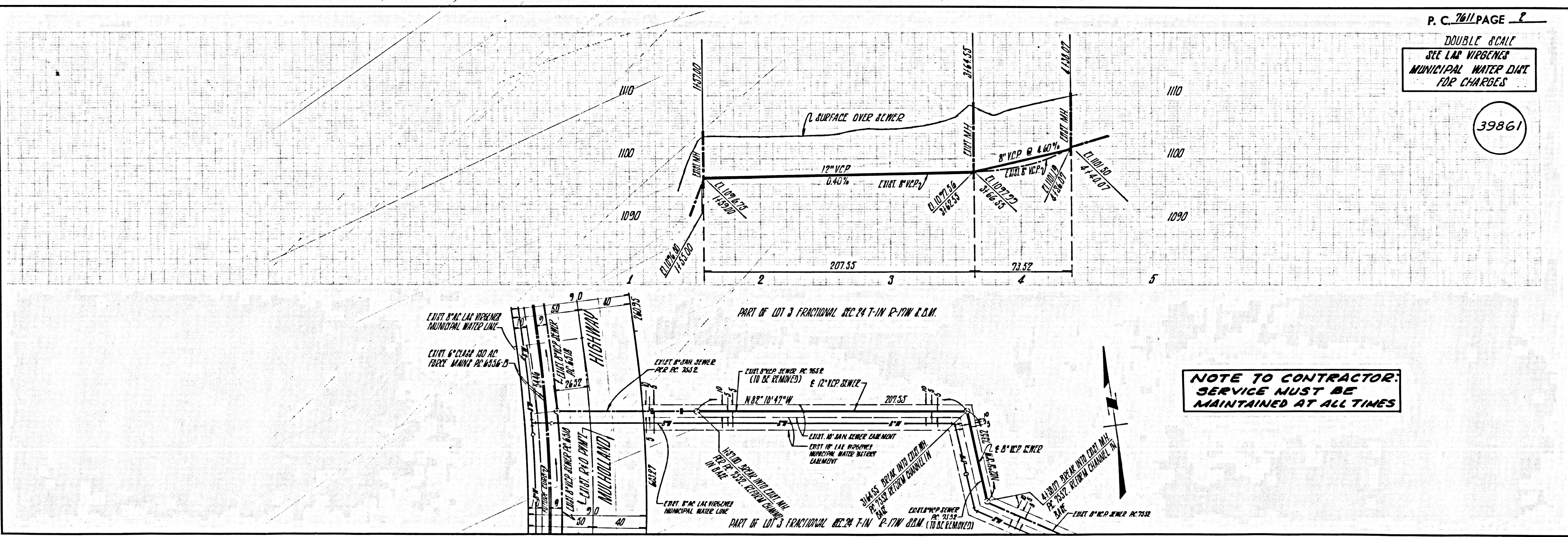

P. C. 7611 PAGE 2  
 DOUBLE SCALE  
 SEE LAR VIRBENER  
 MUNICIPAL WATER DISTRICT  
 FOR CHARGES  
 39861

NOTE TO CONTRACTOR:  
 SERVICE MUST BE  
 MAINTAINED AT ALL TIMES