

DOUBLE SCALE
CITY OF ROLLING HILLS ESTATES BLDG. DIST. NO. 12.03

REVISIONS:
Revised Sewer grades on Shady Vista Road,
Sta. 14+11.0 to Sta. 20+38.00, Page 10.
Approved: *Edward J. Valdey* Date: 1-17-67

- TBM "A" El. 548.07 - LIT in North curb Silver Saddle Ln. at approx. sewer Sta. 10+67.
- TBM "B" El. 604.90 - LIT in North curb Silver Saddle Ln. on E. Golden Spur Pl. prod.
- TBM "C" El. 600.18 - LIT in NW corner at lot No. 40, West side Golden Spur Pl.
- TBM "D" El. 580.12 - Top of steel C.B. face of North end of catch basin, South end of Golden Spur Pl.
- TBM "E" El. 605.99 - LIT in North curb Santa Bella Rd. on E. Shady Vista Rd. prod.
- TBM "F" El. 571.6 - LIT in South curb Santa Bella Rd. at lot No. 9E.
- TBM "G" El. 583.61 - LIT in curb at end of Santa Bella Rd. on E.
- TBM "H" El. 610.72 - LIT in West curb Shady Vista Rd. at NW corner Shady Vista Rd. & Seashore Dr., N. North of C.E.
- TBM "I" El. 606.82 - LIT in curb at S'E end of Shady Vista Rd. on E. prod.

- NOTE:
1. PROVIDE STAKES ON THE PROPERTY LINE OR PROPERTY LINES PRODUCED AT RIGHT ANGLES TO THE SEWER LINE AT THE CENTER LINE OF EACH MANHOLE.
 2. NO REPRESENTATIVE OF THE CITY ENGINEER WILL SURVEY OR LAY OUT ANY PORTION OF THE WORK.
 3. THE ENGINEER OF WORK SHALL FURNISH THE CITY ENGINEER WITH GRADE SHEETS AND STATIONING FOR ALL HOUSE LATERALS AND "T" MANHOLES AND SHALL PROVIDE STAKES FOR THEM AT THEIR PROPER LOCATIONS WITH STATIONING PLAINLY MARKED. ALL HOUSE LATERALS SHALL BE CONSTRUCTED IN A STRAIGHT ALIGNMENT AT RIGHT ANGLES FROM THE MAIN LINE SEWER EXCEPT AS SHOWN ON THE PLANS. HOUSE LATERALS FROM CHIMNEYS SHALL NOT HAVE AN ANGLE OF LESS THAN 45° WITH THE MAIN LINE SEWER. ANY CHANGE IN ALIGNMENT SHALL BE REQUESTED IN WRITING BY THE CONTRACTOR.
 4. THE ENGINEER OF WORK SHALL FURNISH THE HOUSE LATERAL DEPTH AT THE PROPERTY LINE BELOW THE TOP OF CURB ELEVATION FOR EACH HOUSE LATERAL ON THE GRADE SHEET.
 5. NO REVISIONS SHALL BE MADE IN THESE PLANS WITHOUT THE APPROVAL OF THE CITY ENGINEER.
 6. THE CONTRACTOR SHALL NOTIFY THE ENGINEER OF WORK AT LEAST TWENTY-FOUR HOURS BEFORE STARTING ANY WORK UNDER THE CONTRACT.
 7. MANHOLES SHALL BE BRICK STRUCTURES PER S-2. PRECAST CONCRETE MANHOLES PER S-3 OR S-4 MAY BE USED AS AN ALTERNATE IN LOCATIONS APPROVED BY THE ENGINEER OF WORK.
 8. USE STANDARD MANHOLE FRAMES AND COVERS, S16, EXCEPT AS NOTED.
 9. MANHOLE TOPS IN UNIMPROVED AREAS OR HAY TO BE 36 INCHES ABOVE FINISHED GRADE.
 10. USE EXTRA STRENGTH PIPE. ALL PIPE IS STANDARD UNLESS NOTED OTHERWISE.
 11. USE MECHANICAL COMPRESSION JOINTS FOR ALL V.C.P. JOINTS PER SPEC. SECS. 3A, 4B & 4F.
 12. IF A POWER POLE IS WITHIN THREE FEET OF THE SEWER, THE SEWER SHALL BE ENCASED, PER S-23, TWO FEET ON EACH SIDE FROM THE POINT OF INTERFERENCE.
 13. DURING THE COURSE OF CONSTRUCTION IT IS DEEMED THAT THERE IS LESS THAN FOUR FEET OF COVER OVER THE TOP OF A MAIN LINE OR HOUSE LATERAL V.C.P. SEWER WHICH IS NOT INDICATED ON THE PLANS, THE PIPE SHALL BE ENCASED PER S-23, UNLESS OTHERWISE APPROVED BY THE CITY ENGINEER.
 14. HOUSE LATERALS TO BE CONSTRUCTED WITH INVERTS AT PROPERTY LINE SEWER BELOW CURB GRADE EXCEPT AS NOTED.
 15. REPAIRS ALL TRENCHES WITHIN PAVED AREAS TO MEET L.A. COUNTY ROAD DEPT. OR CALIFORNIA STATE HIGHWAY REQUIREMENTS IN ACCORDANCE WITH PERMITS.
 16. FOR ALLOWABLE LEAKAGE TEST USE FORMULA NO. 3, SPEC. SEC. 54.
 17. ALL STATE AND LOCAL TRENCH SAFETY ORDERS WILL BE STRICTLY ENFORCED.
 18. THE LOCATION & SIZE OF WATER MAINS & GAS MAINS SHOWN ON THESE PLANS WERE OBTAINED FROM THE UTILITY COMPANY OWNING THE LINE. IT SHALL BE THE RESPONSIBILITY OF THE CONTRACTOR TO VERIFY THE LOCATION, SIZE & DEPTH OF THESE LINES PRIOR TO THE STARTING OF ANY CONSTRUCTION. ANY DAMAGE TO THESE LINES OR CONNECTIONS THERE TO, RESULTING FROM ANY PHASE OF THE CONTRACTOR'S OPERATION SHALL BE REPAIRED AT THE CONTRACTOR'S EXPENSE BUT NO ADDITIONAL COST TO THE CITY.
 19. WORDS IN CIRCLES AT ENDS OF HOUSE LATERALS INDICATE 1/4" SHALL BE LAID HORIZONTAL AND HOUSE LATERALS SHALL BE CONSTRUCTED WITH 1/4" RISE PER FOOT TO PROPERTY LINE.
 20. FIGURES IN CIRCLES AT ENDS OF HOUSE LATERALS INDICATE HOUSE LATERALS SHALL BE CONSTRUCTED WITH 1/4" RISE PER FOOT TO PROPERTY LINE.
 21. WHERE STATIONS ARE SHOWN AT THE END OF HOUSE LATERALS, THE LOCATIONS OF SUCH HOUSE LATERALS SHALL NOT BE MOVED UP GRADE FROM THE STATIONS INDICATED.
 22. BEFORE BREAKING INTO ANY EXISTING STRUCTURE AND BEFORE FINAL ACCEPTANCE OF THIS WORK, COUNTY SANITATION DISTRICT (CJ4-1281) SHALL BE NOTIFIED IN ORDER THAT REQUIRED INSPECTION CAN BE MADE.

PROFILE, ALIGNMENT AND GRADE OF P.C. 7652
PAGE 1
ROLLING HILLS ESTATES SEWER IMPROVEMENT
SANITARY DISTRICT NO. 4

PRIVATE CONTRACT NO. 7652

W.S. 27
7 SHEETS, 14 PAGES
SCALE: VERT. 1" = 4' HORIZ. 1" = 40' APRIL, 1966

PREPARED IN THE OFFICES OF
SOUTH BAY ENGINEERING CORPORATION

By: *Raymond L. Quigley*
REG. C.E. NO. 4191

FOR RECORD SEE PLAN NTS-1

NOTE:
GRADES TO WHICH THIS IMPROVEMENT IS TO BE CONSTRUCTED ARE SHOWN ON PLANS AND PROFILES. AT ALL POINTS BETWEEN DESIGNATED POINTS THE GRADE SHALL BE ESTABLISHED SO AS TO CONFORM TO A STRAIGHT LINE DRAWN BETWEEN SAID DESIGNATED POINTS. REVISIONS MADE BY THE ENGINEER OF WORK SHALL BE INDICATED BY A CIRCLE WITH THE LETTERS "R" AND "E" ON THE DRAWING. THE DRAWING AND THE DATA HEREON ARE HEREBY MADE A PART OF THE SPECIFICATIONS. AS REVISED, THE CONTRACTOR SHALL BE RESPONSIBLE FOR OBTAINING ALL NECESSARY PERMITS FROM THE CITY ENGINEER AND SHALL BE PROSECUTED ONLY IN THE PRESENCE OF THE ENGINEER OF WORK. THE CITY ENGINEER SHALL NOT BE RESPONSIBLE FOR THE ACCURACY OF THE DATA OBTAINED FROM THE CITY ENGINEER OR FROM ANY OTHER SOURCE. THE CONTRACTOR SHALL BE RESPONSIBLE FOR VERIFYING THE LOCATION OF ALL EXISTING UTILITIES PRIOR TO THE STARTING OF ANY CONSTRUCTION. THE CONTRACTOR SHALL BE RESPONSIBLE FOR OBTAINING ALL NECESSARY PERMITS FROM THE CITY ENGINEER AND SHALL BE PROSECUTED ONLY IN THE PRESENCE OF THE ENGINEER OF WORK. THE CITY ENGINEER SHALL NOT BE RESPONSIBLE FOR THE ACCURACY OF THE DATA OBTAINED FROM THE CITY ENGINEER OR FROM ANY OTHER SOURCE. THE CONTRACTOR SHALL BE RESPONSIBLE FOR VERIFYING THE LOCATION OF ALL EXISTING UTILITIES PRIOR TO THE STARTING OF ANY CONSTRUCTION. THE CONTRACTOR SHALL BE RESPONSIBLE FOR OBTAINING ALL NECESSARY PERMITS FROM THE CITY ENGINEER AND SHALL BE PROSECUTED ONLY IN THE PRESENCE OF THE ENGINEER OF WORK. THE CITY ENGINEER SHALL NOT BE RESPONSIBLE FOR THE ACCURACY OF THE DATA OBTAINED FROM THE CITY ENGINEER OR FROM ANY OTHER SOURCE. THE CONTRACTOR SHALL BE RESPONSIBLE FOR VERIFYING THE LOCATION OF ALL EXISTING UTILITIES PRIOR TO THE STARTING OF ANY CONSTRUCTION.

CITY OF ROLLING HILLS ESTATES, CALIFORNIA
JOHN A. LAMBIE, CITY ENGINEER
J. D. PARKHURST, CHIEF ENGINEER

APPROVED BY: *Raymond L. Quigley*
PALOS VERDES-CENTINELLA VALLEY
SUBMITTED BY: *Raymond L. Quigley*
SPECIAL ENGINEER

CHECKED BY: *Edward J. Valdey*
REG. C.E. NO. 36522

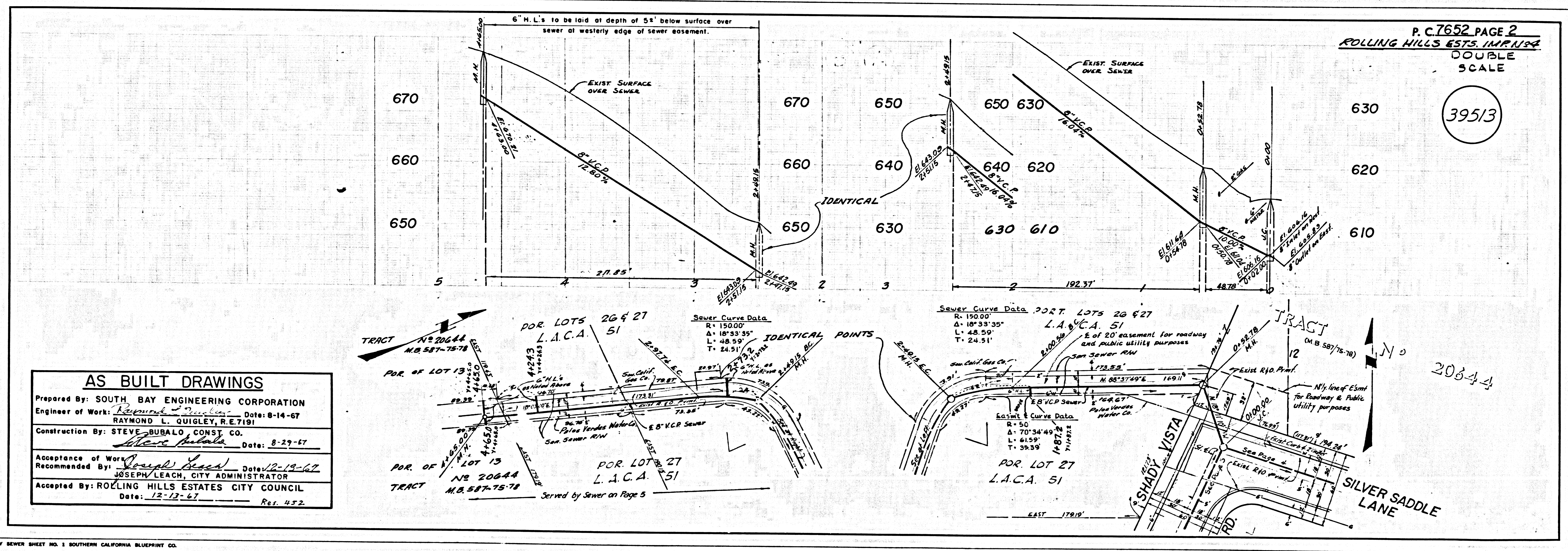

AS BUILT DRAWINGS

Prepared By: SOUTH BAY ENGINEERING CORPORATION
Engineer of Work: *Raymond L. Quigley* Date: 8-14-67
Construction By: STEVE BUBALO CONST. CO.
Date: 8-29-67

Acceptance of Work: *Joseph Leach* Date: 12-19-67
Recommended By: JOSEPH LEACH, CITY ADMINISTRATOR
Accepted By: ROLLING HILLS ESTATES CITY COUNCIL
Date: 12-17-67 Res. 452

AS BUILT

