

BM. B.G. 1596 ELEV. 502.271
 Rd. Dept. B.M. Tag in case. Cal
 wall of Private Dr. So. of Orange
 Grove Ave. & E. E. grad. of 733
 Ave. 243' So. of 222' E. & 1/2
 WHITTIER QUAD. 1965

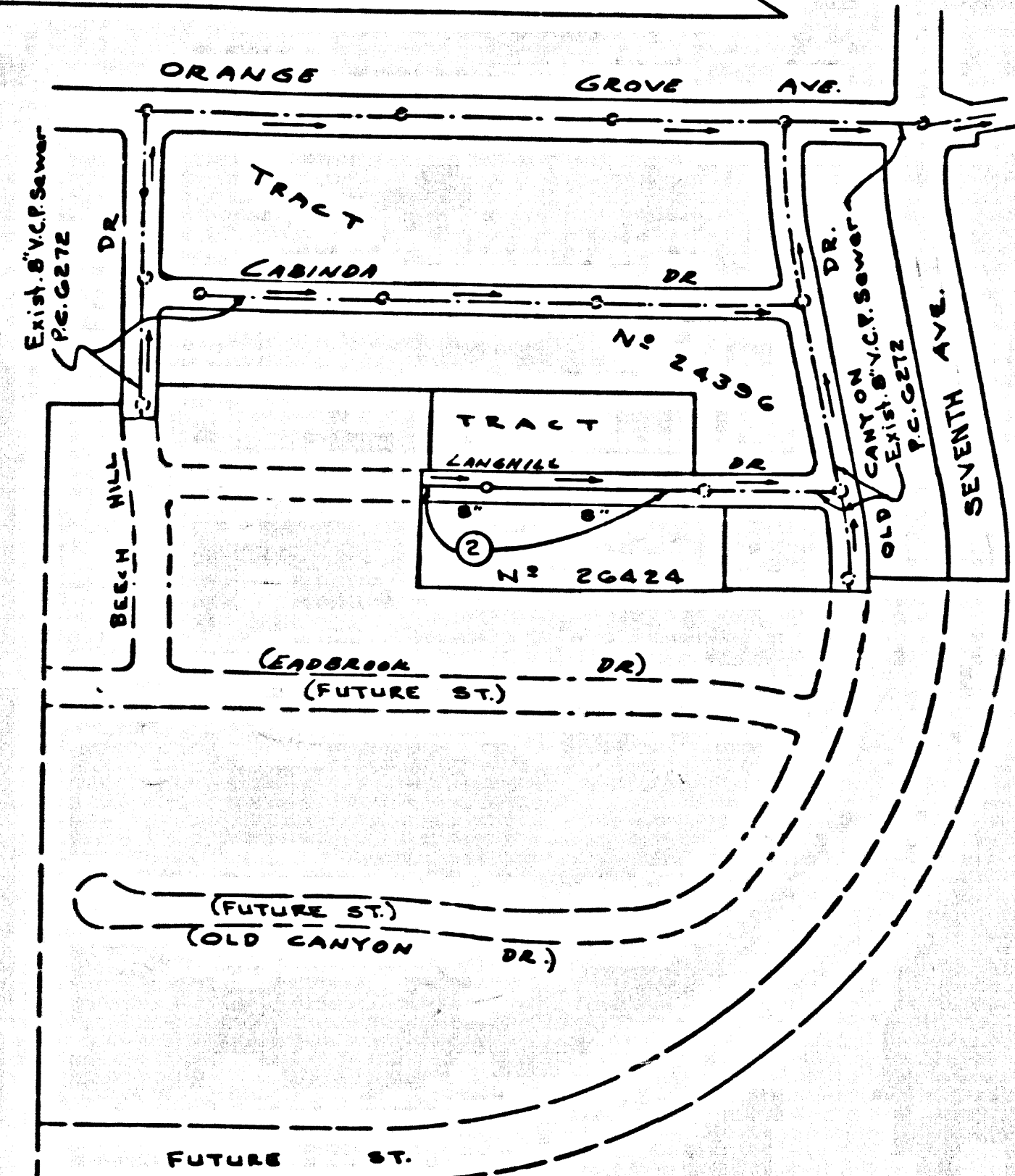

INDEX MAP
 TRACT No 26424
 P.C. 7665
 SCALE: 1"=50'

NOTE:
 The existence and approximate location of underground utilities or structures shown on these plans were determined by a search of available public records. To the best of our knowledge there are no existing underground utilities or structures except as shown on these maps.
 The Contractor is required to take due precautionary measures to protect the utilities or structures shown and any other utilities or structures at the site it shall be the Contractor's responsibility to notify the owners of the utilities or structures concerned before starting work.

Any connection to the sewage system of County Sanitation District, provided directly or indirectly by the sewers shown on these plans, shall be considered a temporary connection until all area sewered is annexed to said district, at which time the connection shall become permanent. If for any reason the annexation to the district of any area sewered hereunder is not completed, the property not in the district will be required to disconnect unless a contract is entered into with the district providing for the disposal of sewage from the area.

**DOUBLE VERTICAL SCALE
 LA PUENTE BLDG. DIST. NO. 2**

- NOTES:**
1. PROVIDE STAFFS ON THE PROPERTY LINE OR PROPERTY LINES PRODUCED AT RIGHT ANGLES TO THE SEWER LINE AT THE CENTER LINE OF EACH MANHOLE.
 2. NO REPRESENTATIVE OF THE COUNTY ENGINEER WILL SURVEY OR LAY OUT ANY PORTION OF THE WORK.
 3. THE OWNER OR HIS AUTHORIZED REPRESENTATIVE SHALL FURNISH THE COUNTY ENGINEER WITH GRADE SHEETS AND STATIONING FOR ALL HOUSE LATERALS AND Y BRANCHES AND SHALL PROVIDE STAKES FOR THEM AT THEIR PROPER LOCATIONS WITH STATIONING PLAINLY MARKED. ANY CHANGE IN LOCATION SHALL BE REQUESTED IN WRITING BY THE OWNER OR HIS REPRESENTATIVE.
 4. THE PRIVATE ENGINEER SHALL FURNISH THE HOUSE LATERAL DEPTH AT THE PROPERTY LINE BELOW THE TOP OF CURB ELEVATION FOR EACH HOUSE LATERAL ON THE GRADE SHEET.
 5. NO REVISIONS SHALL BE MADE IN THESE PLANS WITHOUT THE APPROVAL OF THE COUNTY ENGINEER.
 6. USE STANDARD MANHOLE FRAMES AND COVERS, 5-18.
 7. USE EXTRA STRENGTH PIPE. ALL PIPE IS STANDARD DEPTH.
 8. USE MECHANICAL COMPRESSION JOINTS FOR ALL V.C.P. JOINTS PER SPECS. SEC. 36 & 40 & 49.
 9. RESURFACE ALL TRENCH WITHIN PAVED AREA TO MEET L.A. COUNTY ROAD DEPT. OR CALIF. STATE HIGHWAY REQUIREMENTS IN ACCORDANCE WITH PERMITS.
 10. IF A POWER POLE IS WITHIN 3 FEET OF THE SEWER, THE SEWER SHALL BE ENCASED PER S-23, 2 FEET ON EITHER SIDE FROM THE POLE INTERFERABLE.
 11. HOUSE LATERALS TO BE CONSTRUCTED WITH INVERTS AT PROPERTY LINE 6 FEET BELOW CURB GRADE.
 12. ALL MANHOLES SHALL BE BRICK SEWER STRUCTURES PER S-20 PRECAST CONCRETE MANHOLES PER S-24 OR S-25 MAY BE USED AS AN ALTERNATE TO BRICK MANHOLES APPROVED BY THE COUNTY ENGINEER.
 13. FOR ALLOWABLE LEAKAGE TEST USE FORMULA NO. 2 PER S-20, SPEC. SEC. 14.
 14. MANHOLE SOLES IN UNPAVED AREAS TO BE 6" MINIMUM THICKNESS CONCRETE.
 15. THE CONTRACTOR SHALL NOTIFY THE CONSTRUCTION DIVISION BY TELEPHONE, MADISON 5-4141, EXT. 101, AT LEAST TWENTY-FOUR HOURS BEFORE STARTING ANY WORK UNDER THIS CONTRACT.
 16. IF DURING THE COURSE OF CONSTRUCTION IT IS DETERMINED THAT THERE IS LESS THAN 4 FEET OF COVER OVER THE TOP OF A MAIN LINE OR HOUSE LATERAL V.C.P. SEWER WHICH IS NOT INDICATED ON THE PLANS, THE PIPE SHALL BE ENCASED PER S-23 UNLESS OTHERWISE APPROVED BY THE COUNTY ENGINEER.
 17. ALL STATE AND LOCAL TRAFFIC SAFETY ORDERS WILL BE RIGIDLY ENFORCED.

NO CONNECTIONS FOR THE DISPOSAL OF INDUSTRIAL WASTES SHALL BE MADE TO SEWERS SHOWN ON THESE DRAWINGS WITHOUT WRITTEN PERMISSION FROM THE CHIEF ENGINEER AND GENERAL MANAGER OF THE COUNTY SANITATION DISTRICTS.

NO CHARGE FOR CONNECTIONS
Sheldon W. Knevel

ISSUE NO HOUSE CONNECTION PERMITS UNTIL PC 6272 IS ACCEPTED

PROFILE ALIGNMENT AND GRADE OF **P.C. 7665**
SANITARY SEWERS PAGE 1
 CONSTRUCTED IN

TRACT No 26424

PRIVATE CONTRACT NO. 7665

W.S. 37

1 SHEET OF 2 PAGES

SCALE: VERT. 1"=4' HORIZ. 1"=40'

MAY, 1966

PREPARED IN THE OFFICES OF

MANNING ENGINEERING CO.

By: *James L. Manning*
 REG. C.E. NO. 7679

FOR LEGEND SEE PLAN NO. S-1

NOTE:
 GRADES TO WHICH THIS IMPROVEMENT IS TO BE CONSTRUCTED ARE SHOWN ON PLANS AND PROFILES. GRADE POINTS FOR TOP OF CURB, CENTER LINE OF STREETS, OR CENTER LINE OF ALLEYS ARE SHOWN BY CIRCLES ON PROFILES AT ALL POINTS BETWEEN DESIGNATED POINTS THE GRADE SHALL BE ESTABLISHED SO AS TO CONFORM TO A STRAIGHT LINE DRAWN BETWEEN SAID DESIGNATED POINTS.
 ELEVATIONS ARE IN FEET ABOVE U.S.C. & G.S. SEA LEVEL DATUM OF 1929.
 THE DRAWING AND DATA HEREON ARE HEREBY MADE A PART OF THE SPECIFICATIONS.
 WORK SHALL BE CONSTRUCTED ACCORDING TO SPECIFICATIONS ON THIS MATTER, ISSUED HEREBY IN THE OFFICE OF THE COUNTY ENGINEER AND SHALL BE PROSECUTED ONLY IN THE PRESENCE OF THE COUNTY ENGINEER.
 BEFORE WORK CAN BE STARTED THE CONTRACTOR MUST OBTAIN A PERMIT TO EXCAVATE IN COUNTY STREETS FROM THE L.A. COUNTY ROAD DEPT. DISTRICT OFFICE NO. 338 AND PAY A FEE OF \$10.00. THE COUNTY ENGINEER ROOM 338 COUNTY ENGINEERING BLDG. AND WORKING OFFICE OF THE SANITATION ENGINEER, SUPERVISOR TO CHIEF OF CONSTRUCTION INSPECTOR AND RECORDS CLERK.
 APPROVAL OF THIS PLAN BY THE COUNTY OF LOS ANGELES DOES NOT CONSTITUTE A REPRESENTATION AS TO THE ACCURACY OF THE LOCATION OF OR THE EXISTENCE OR NON-EXISTENCE OF ANY UNDERGROUND UTILITY PIPE, OR STRUCTURE POINTS TO BE DONE IN A STATE HIGHWAY. A PERMIT MUST BE OBTAINED FROM THE STATE OF CALIFORNIA, DIVISION OF HIGHWAYS, 120 SOUTH SPRING STREET.

COUNTY OF LOS ANGELES, CALIFORNIA

JOHN A. LAMBIE, COUNTY ENGINEER J.D. PARK HURST, CHIEF ENGINEER

APPROVED BY *Col. J. A. Lambie* FOR SANITATION ENGINEER APPROVED BY *J. D. Park Hurst* CHIEF ENGINEER

SUBMITTED BY *Sheldon W. Knevel* SANITATION ENGINEER

CHECKED BY *Sheldon W. Knevel* P.E. REG. C.E. NO. 7665

J.N. 0367.68

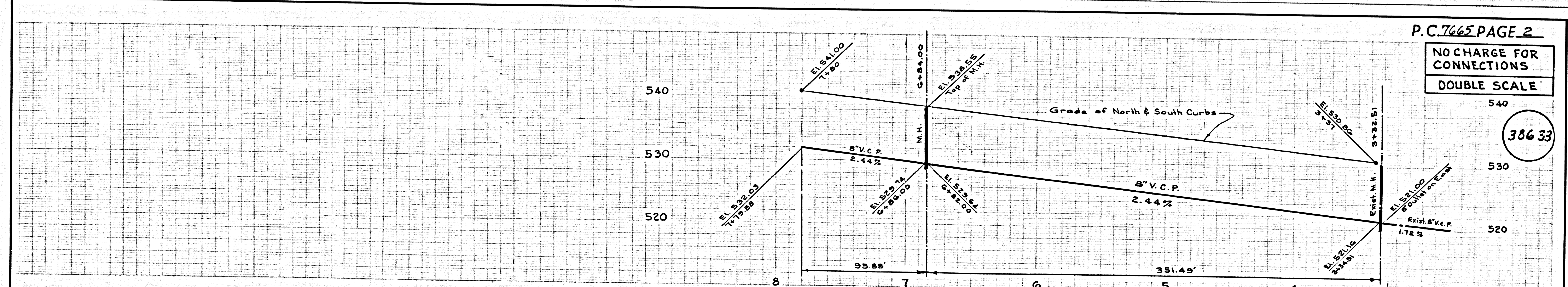

NO CHARGE FOR CONNECTIONS
DOUBLE SCALE
 38633

