

ASBTT CA

DOUBLE SCALE WEST HOLLYWOOD BLDG. DIST. NO. 9

PC. 7718-A
PAGE 1
J.N. 0540.00

- NOTES:
1. USE "WEDGE LOCK" OR "SPEED SEAL" FOR ALL V.C.P. JOINTS PER SPEC., SECS. 36 & 48.
 2. TO BE CONSTRUCTED UNDER JEWEL MAINTENANCE FORCE ACCOUNT.
 3. FOR BENCH MARK DATUM REFER TO JANITATION DISTRICT TRUNK JEWEL - SHERMAN TRUNK.
 4. LOCATE AND RECONNECT HOUSE LATERALS, SERVING LOTS 45 AND 47 TO 55, TO JANITATION DISTRICT TRUNK JEWEL.
 5. ROAD DEPARTMENT PERMIT REQUIRED.
 6. JANITATION DISTRICT CONNECTION PERMITS TO BE OBTAINED.

PROFILE ALIGNMENT AND GRADE OF
SANITARY SEWERS
TO BE CONSTRUCTED IN
HUNTLEY DRIVE 39267
PRIVATE CONTRACT NO. 7718-A
COUNTY OF LOS ANGELES, CALIFORNIA
PAGE 1 OF 2 PAGES

SCALE: VERT. 1"=8'
HORIZ. 1"=40'
SEPTEMBER, 1966
FOR THE WEST HOLLYWOOD AND SHERMAN JEWEL MAINTENANCE DISTRICT
JOHN A. LAMBIE COUNTY ENGINEER

RECOMMENDED: *[Signature]*
JEWEL MAINTENANCE DISTRICT ENGINEER
APPROVED: *[Signature]*
JANITATION ENGINEER
JOHN D. PARKHURIT
CHIEF ENGINEER OF COUNTY
JANITATION DISTRICT NO. 4
[Signature]
OFFICE ENGINEER

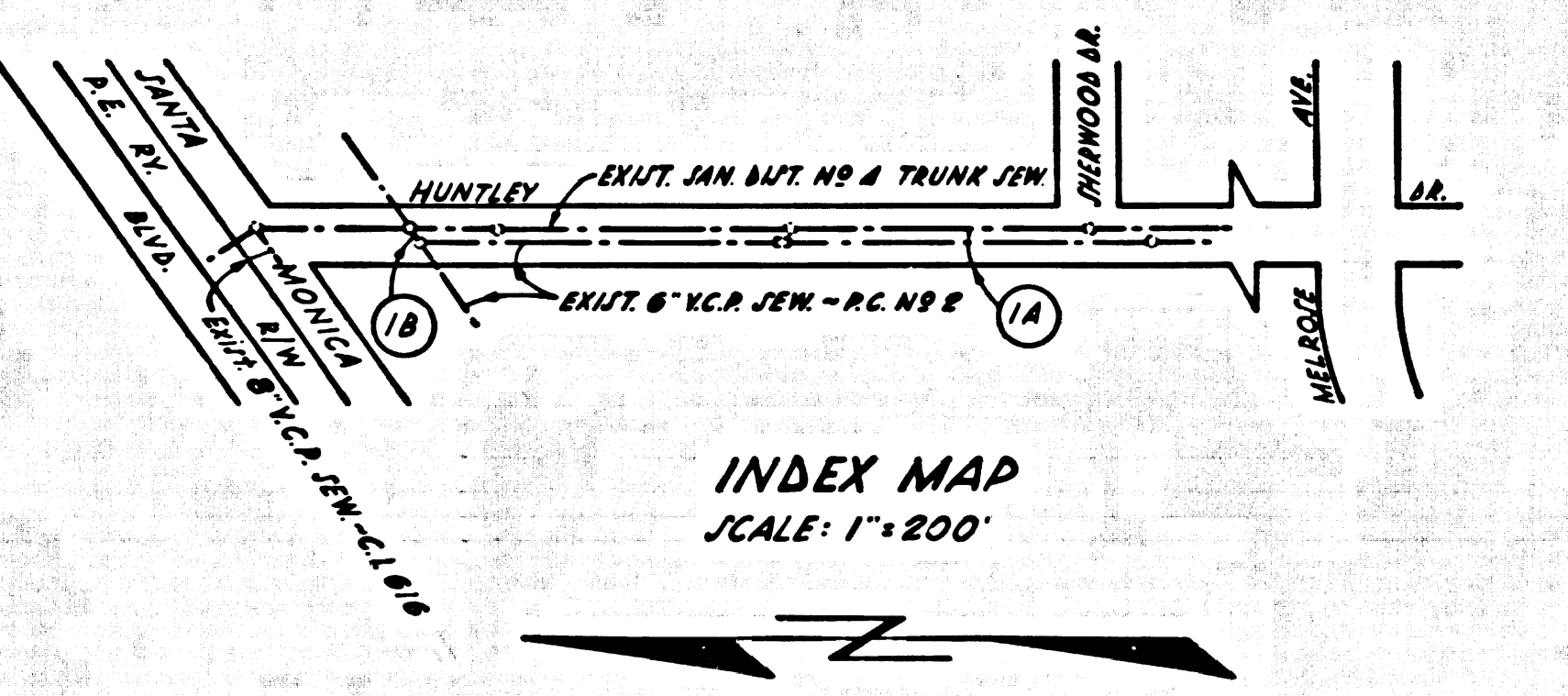

ALL CONNECTIONS FOR THE DISPOSAL OF INDUSTRIAL WASTES SHALL BE MADE TO SEWERS SHOWN ON THESE DRAWINGS WITHOUT WRITTEN PERMISSION FROM THE CHIEF ENGINEER AND GENERAL MANAGER OF THE COUNTY SANITATION DISTRICTS.

NOTE: ELEVATIONS ARE IN FEET ABOVE U.S.C. & G.S. SEA LEVEL DATUM AS OF 1929. THIS DRAWING AND THE DATA HEREON ARE HEREBY MADE A PART OF THIS SPECIFICATION.

BEFORE BREAKING INTO ANY EXISTING STRUCTURE AND BEFORE FINAL ACCEPTANCE OF THIS WORK, COUNTY SANITATION DISTRICT (DU 4-1281) SHALL BE NOTIFIED IN ORDER THAT REQUIRED INSPECTION CAN BE MADE.

REFERENCES			
DESIGNED	KOGA	SEPTEMBER, 1966	
DRAWN	KOGA	SEPTEMBER, 1966	
CHECKED	CADWELL	SEPTEMBER, 1966	

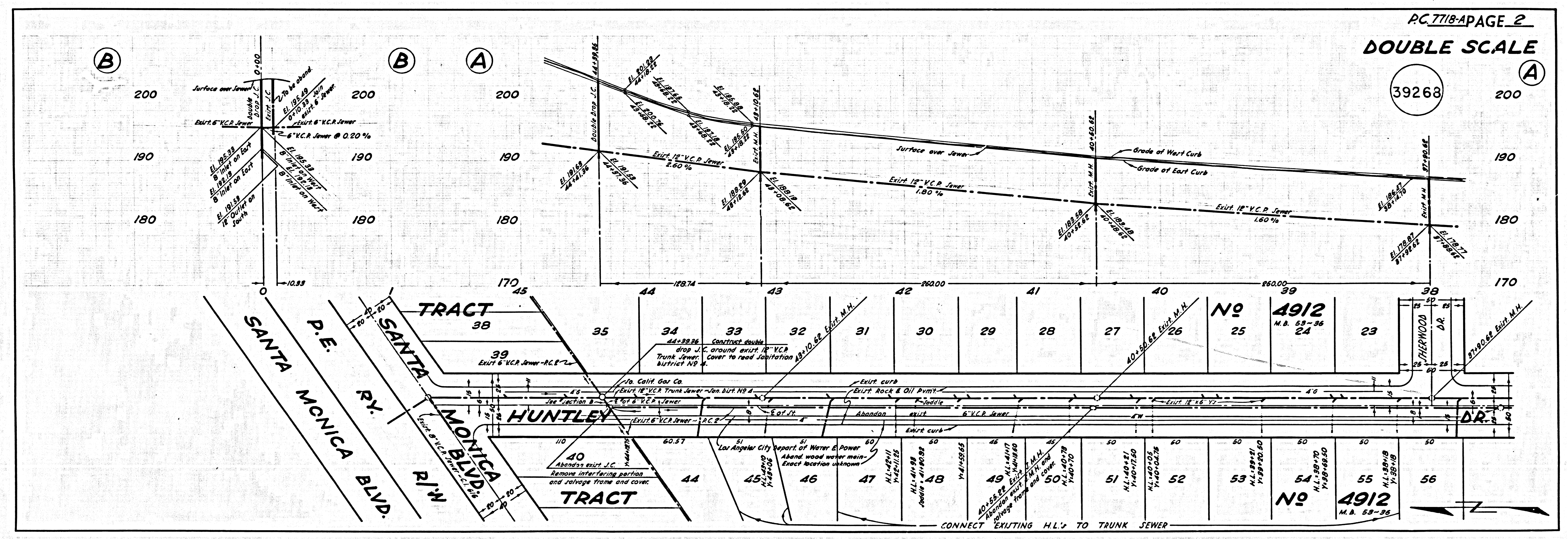

PC 7718-A