

B.M. NO. 120001 ELEV. 28.750
 L.A. COUNTY TRUNK MAIN C-3A UNDEP. 100 FT. DIA. OF
 30" CORR. ALUMINUM PLANT. DIST. 100 FT. FROM
 WITH FROM L.V. IN AD. CO. IN END. TOWNSHIP
 1210202. QUAD. 19.55 (221)

DOUBLE SCALE
 MALIBU BLDG. DIST. NO. 92

PROFILE ALIGNMENT AND GRADE OF
 SANITARY SEWERS PAGE 1
 TO BE CONSTRUCTED IN

TRACT NO. 28339
 PRIVATE CONTRACT NO. 7724

W.S. 58
 2 SHEETS, 4 PAGES
 SCALE: VERT. 1"=4' AUGUST, 1966
 PREPARED IN THE OFFICES OF
 EDWIN CANNON/LEUNG
 729 SO. PARK VIEW ST. LOS ANGELES, CALIFORNIA 90024
 REG. C.E. NO. 11282

38821

FOR LEGEND SEE PLAN NO. S-1

NOTE:
 GRADES TO WHICH THIS IMPROVEMENT IS TO BE CONSTRUCTED ARE SHOWN ON PLANS AND PROFILES. GRADE POINTS FOR TOP OF
 CURBS, CENTER LINE OF STREETS, OR CENTER LINE OF ALLEYS ARE SHOWN BY CIRCLES ON PROFILES. AT ALL POINTS BETWEEN DESIGNATED
 POINTS THE GRADE SHALL BE ESTABLISHED SO AS TO CONFORM TO A STRAIGHT LINE DRAWN BETWEEN SAID DESIGNATED POINTS.
 SEWER LATERALS ARE TO BE CONSTRUCTED TO THE PROPERTY LINE OF EACH LOT. ALL SEWER LATERALS SHALL BE CONSTRUCTED TO
 THE PROPERTY LINE OF EACH LOT. THIS DRAWING AND THE DATA HEREON ARE HEREBY MADE A PART OF THE SPECIFICATIONS FOR THE
 WORK SHOWN AND SHALL BE PROSECUTED ONLY IN THE PRESENCE OF THE COUNTY ENGINEER.
 APPROVAL OF THIS PLAN BY THE COUNTY OF LOS ANGELES DOES NOT CONSTITUTE A REPRESENTATION AS TO THE ACCURACY OF THE
 LOCATION OF OR THE EXISTENCE OR NON-EXISTENCE OF ANY UNDERGROUND UTILITY PIPE, OR STRUCTURE WITHIN THE LIMITS OF THIS
 PROJECT. THIS NOTE APPLIES TO ALL PAGES.
 IF WORK IS TO BE DONE BY A STATE HIGHWAY, A PERMIT MUST BE OBTAINED FROM THE STATE OF CALIFORNIA, DIVISION OF HIGHWAYS,
 126 SOUTH SPRING STREET, LOS ANGELES, CALIFORNIA.

COUNTY OF LOS ANGELES, CALIFORNIA
 JOHN A. LAMBE, COUNTY ENGINEER J. D. PARKHURST, CHIEF ENGINEER
 CO. SAN DIST. NO. 11
 APPROVED BY: *R. J. ...* APPROVED BY: *J. D. Parkhurst*
 OFFICE ENGINEER

NO CONNECTIONS FOR THE DISPOSAL OF
 INDUSTRIAL WASTES SHALL BE MADE TO
 SEWERS SHOWN ON THESE DRAWINGS
 WITHOUT WRITTEN PERMISSION FROM THE
 CHIEF ENGINEER AND GENERAL MANAGER
 OF THE COUNTY SANITATION DISTRICT.
 BEFORE BREAKING INTO ANY EXISTING STRUCTURES
 AND BEFORE FINAL ACCEPTANCE OF THIS WORK,
 COUNTY SANITATION DISTRICT (DU 4-1253) SHALL
 BE NOTIFIED IN ORDER THAT REQUIRED INSPECTION
 CAN BE MADE.

J.N. 0250.02

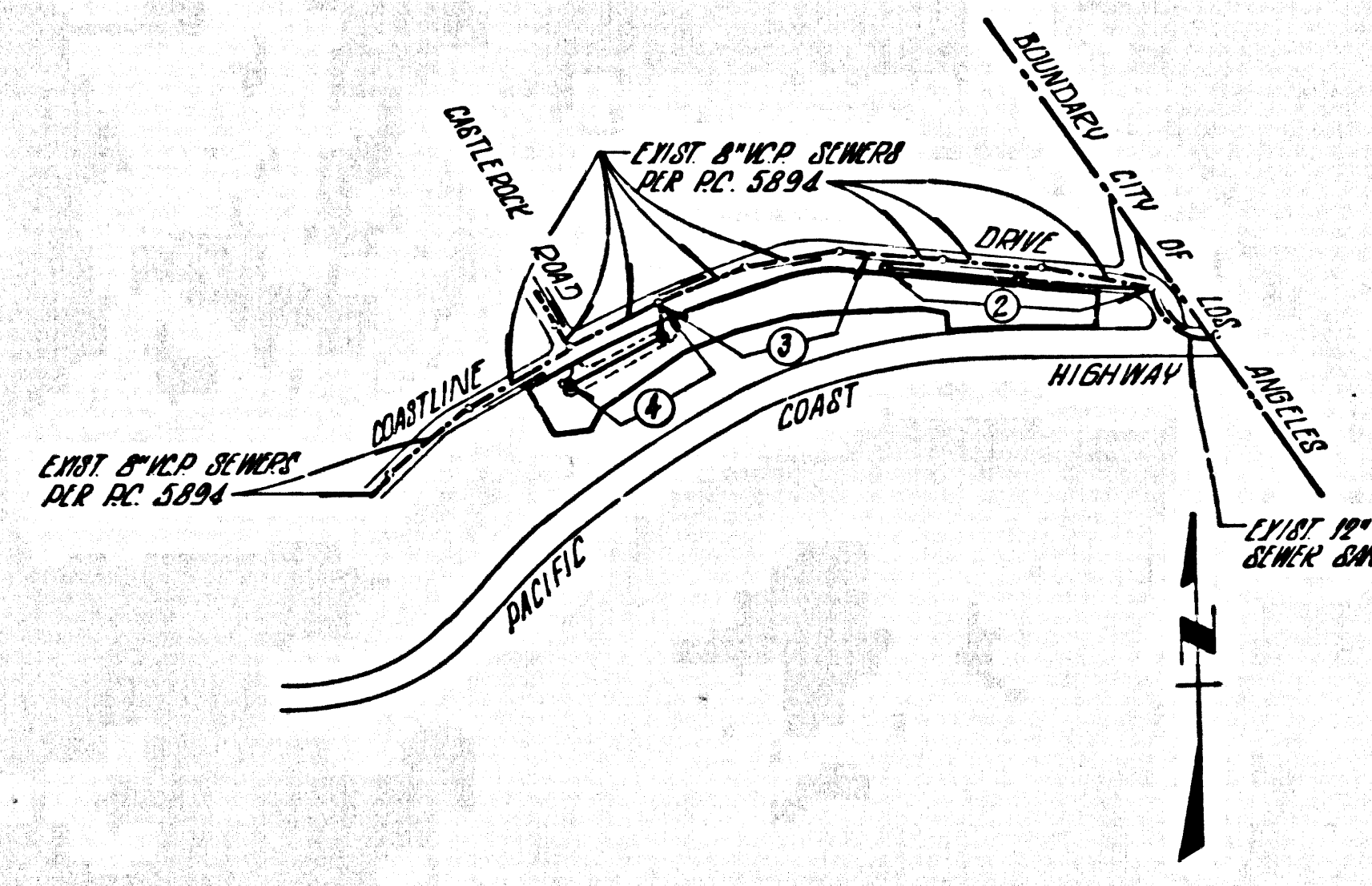

INDEX MAP
 TRACT NO. 28339
 P.C. 7724
 SCALE 1"=600'

COLLECT CHARGES
 AS INDICATED
L. Curtis 10/4/66

PRIVATE ENGINEER'S
 NOTICE TO CONTRACTOR
 THE EXISTENCE AND LOCATION OF ANY UNDERGROUND UTILITY PIPES
 OR STRUCTURES SHOWN ON THESE PLANS ARE OBTAINED BY A SEARCH
 OF THE AVAILABLE RECORDS TO THE BEST OF OUR KNOWLEDGE THERE
 ARE NO EXISTING UTILITIES EXCEPT AS SHOWN ON THIS MAP.
 THE CONTRACTOR IS REQUIRED TO TAKE PRECAUTIONARY MEASURES
 TO PROTECT THE UTILITY LINES SHOWN AND ANY OTHER LINES NOT
 OF RECORD OR NOT SHOWN ON THIS DRAWING.

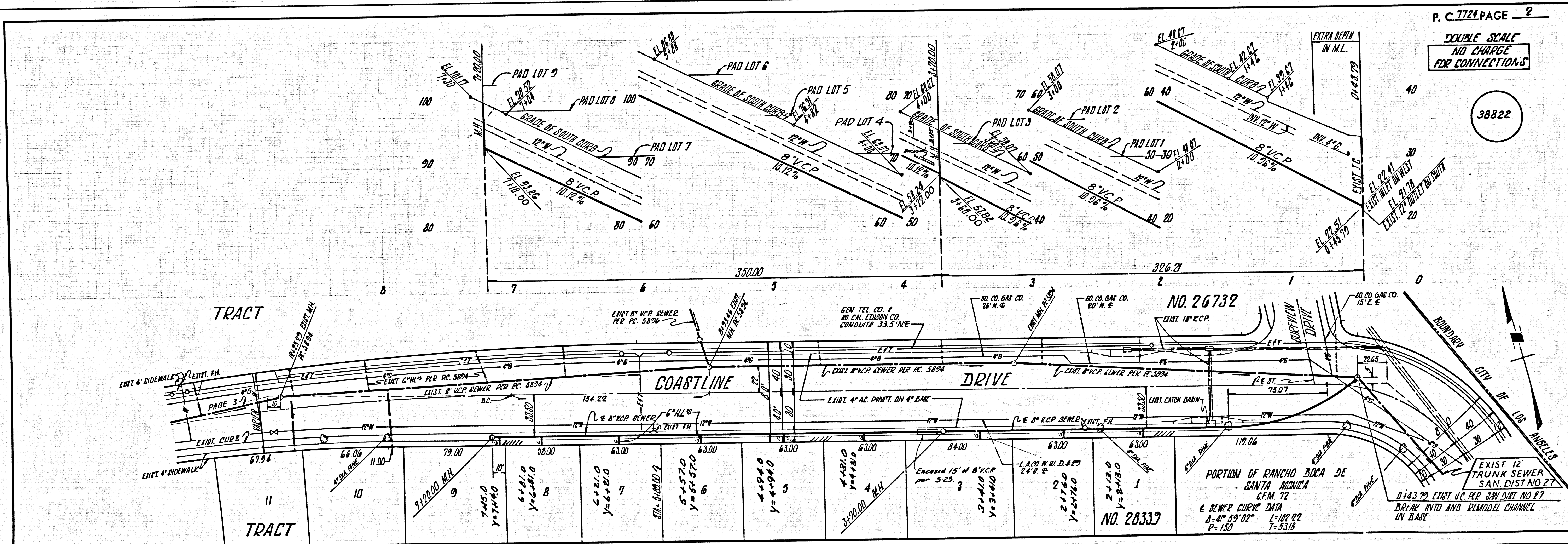

P.C. 7724 PAGE 2
 DOUBLE SCALE
 NO CHARGE
 FOR CONNECTIONS

38822

