

B.M. M.M.-72 ELEV. 171.716  
 F.B. 2713, Page 196  
 Milrose Ave. & Norwich Dr.  
 S.W. cor. 81' spk in ch. 64' E. of W. end  
 cb. ref. 1966

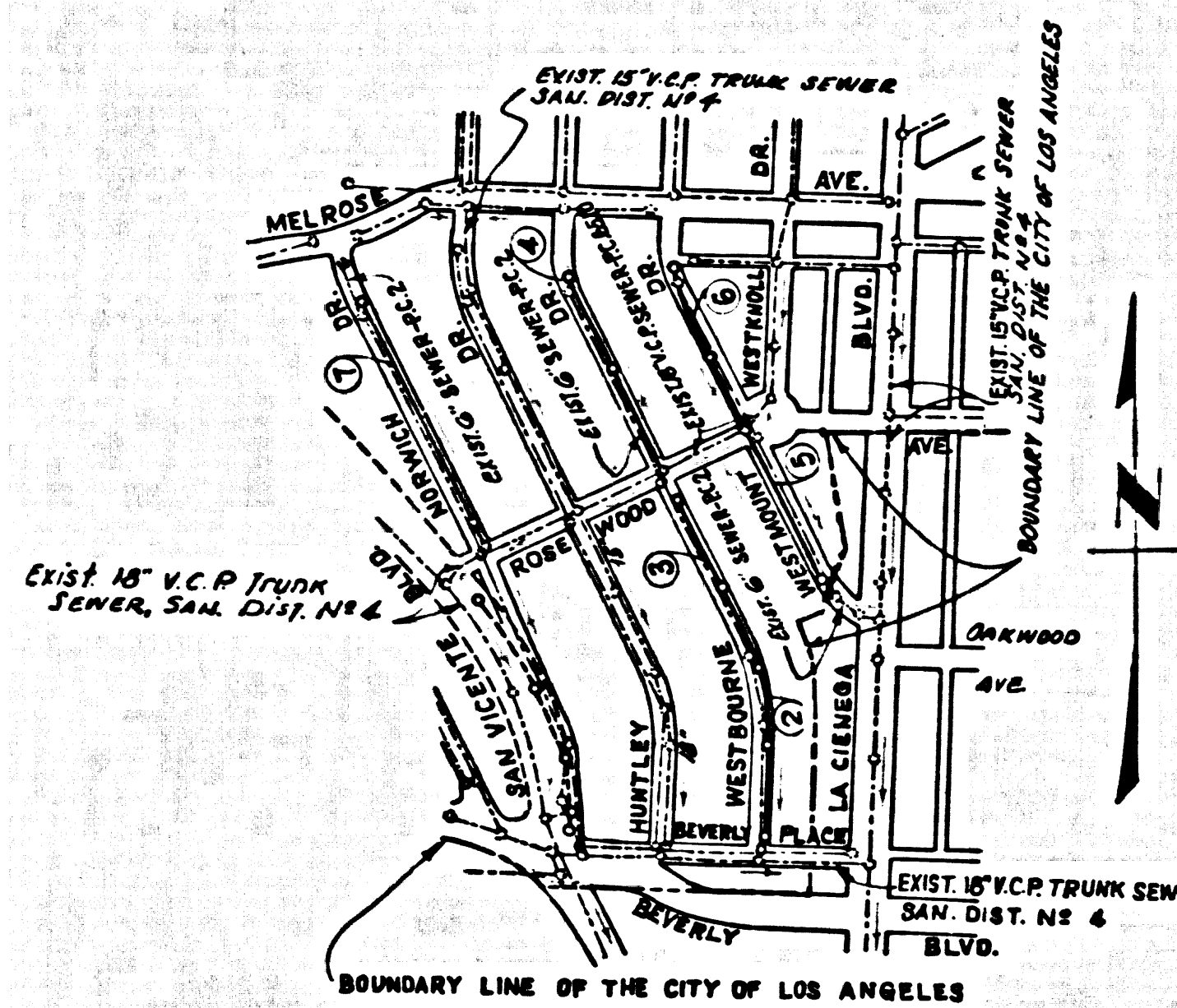

INDEX MAP  
 WESTBOURNE DRIVE - C.C. 7736  
 Scale: 1"=600'

### WEST HOLLYWOOD BUILDING DISTRICT No. 9

APPROVAL OF THIS PLAN BY THE COUNTY OF LOS ANGELES DOES NOT CONSTITUTE A REPRESENTATION AS TO THE ACCURACY OF THE LOCATION OF OR THE EXISTENCE OR NON-EXISTENCE OF ANY UNDERGROUND UTILITY PIPE OR STRUCTURE WITHIN THE LIMITS OF THIS PROJECT.  
 NO REVISIONS SHALL BE MADE IN THESE PLANS WITHOUT THE APPROVAL OF THE COUNTY ENGINEER.  
 LOCATIONS OF HOUSE LATERALS SHOWN WITHOUT PERMIT NUMBERS ARE APPROXIMATE. CONTRACTOR SHALL VERIFY LOCATIONS OF HOUSE LATERALS PRIOR TO CONSTRUCTION OF MAIN LINE SEWER.  
 4" OR 6" BRANCHES MAY BE USED FOR CONNECTIONS TO MAIN LINE SEWER.  
 PRIOR TO CONSTRUCTION, THE CONTRACTOR SHALL SECURE A PER-EXEMPT ROAD PERMIT, COUNTY ROAD DEPARTMENT, 8830 WEST 83RD. STREET, LOS ANGELES, 90048.  
 PRIOR TO CONSTRUCTION, THE CONTRACTOR SHALL SECURE A PER-EXEMPT CONSTRUCTION PERMIT, COUNTY ENGINEER SANITATION, Rm. 310, 100 WEST 4TH STREET, LOS ANGELES, 90013.  
 HOUSE LATERALS MAY BE CONSTRUCTED DURING CONSTRUCTION OF MAIN LINE SEWER USING 2" STANDARD BEDDING FOR SEWER PIPE PER S-1.

- Construction Inspector shall be notified prior to the following as this required inspection can be made (Phone 516-3007):
- (1) Commencement of construction of manhole on Beverly Street.
  - (2) Breaking into existing manhole on District Trunk sewer.
  - (3) Drilling fire-dial trunk sewer.
  - (4) Construction of house connections to District Trunk sewer.
  - (5) Acceptance of the project.

NO CONNECTIONS FOR THE DISPOSAL OF INDUSTRIAL WASTES SHALL BE MADE TO SEWERS SHOWN ON THESE DRAWINGS WITHOUT WRITTEN PERMISSION FROM THE CHIEF ENGINEER AND OPERATIONAL MANAGER OF THE COUNTY SANITATION DISTRICTS.

**NO CHARGE FOR CONNECTIONS**

USE EXTRA STRENGTH PIPE, ALL JOBS IN STANDARD DEPTH EXCEPT AS NOTED.  
 USE TYPE "A" OR "B" JOINTS FOR ALL VITRIFIED CLAY PIPE SEWERS, PER SEC. 1266-2 OF THE S.F.S. SPEC. EXCEPT AS NOTED.  
 ALL STRUCTURES SHALL BE BRICK MANHOLES.  
 USE STANDARD MANHOLE FRAMES AND COVERS.  
 A SOILS INVESTIGATION REPORT IS NOT AVAILABLE FOR THIS PROJECT.  
 CONCRETE HOUSE LATERALS WITH UNVELOPED 4" OR 6" DIAMETER SHALL BE CONSTRUCTED TO GRADE OR CENTER LINE OF GRADE, EXCEPT AS NOTED.  
 HOUSES IN CIRCLES AT ENDS OF HOUSE LATERALS INDICATE DEPTH BELOW CURB GRADE, OR GRADE OF CENTER LINE OF STREET.  
 HOUSES IN CIRCLES AT ENDS OF HOUSE LATERALS INDICATE HOUSE LATERALS SHALL BE CONSTRUCTED WITH 1/4" SLOPE PER FOOT TO PROPERTY LINE.  
 HOUSES IN CIRCLES AT ENDS OF HOUSE LATERALS INDICATE 1/4" SLOPE TO MAIN LINE SEWER EXCEPT AS NOTED.  
 ALL HOUSE LATERALS SHALL BE CONSTRUCTED IN A STRAIGHT ALIGNMENT AT RIGHT ANGLES FROM THE MAIN LINE SEWER EXCEPT AS SHOWN ON THE PLANS. HOUSE LATERALS FROM CHIMNEYS SHALL NOT HAVE AN ANGLE OF LESS THAN 45 DEGREES WITH THE MAIN LINE SEWER.  
 THE CONTRACTOR SHALL NOTIFY THE CONSTRUCTION DIVISION BY TELEPHONE MADISON 9-4742, EXT. 81561 AT LEAST 24 HOURS BEFORE STARTING ANY WORK UNDER THIS CONTRACT.  
 CONSTRUCTION IN STATE HIGHWAYS SHALL CONFORM WITH STATE HIGHWAY PERMIT AND THE CONTRACTOR SHALL PAY ALL COSTS IN CONNECTION THEREWITH.  
 ALL STATE AND LOCAL TRENCH SAFETY ORDERS WILL BE RIGIDLY ENFORCED.  
 NOTES: TEMPORARY PREMIX (MIN. 5" THICK) SHALL BE INSTALLED AND MAINTAINED FOR A MINIMUM PERIOD OF 90 DAYS. FINAL RESURFACING SHALL BE IN ACCORDANCE WITH THE FOLLOWING RESURFACING SCHEDULE:

PAGE NO.	STREET	FROM	TO	TYPE OF RESURFACING
2-3	WESTBOURNE DR.	0+80	12+70	4" TYPE I A.C. ON
4	WESTBOURNE DR.	1+07	7+63	"
5	WESTMOUNT DR.	0+89	6+15	8" CRUSHED AGGREGATE BASE
6	WESTMOUNT DR.	1+10	6+48	"
7	NORWICH DR.	1+75	10+80	5" TYPE I A.C. & 5" CRUSHED AGG. BASE

ALL CONCRETE CROSS GUTTERS, CURBS, GUTTERS, PARAPETS, AND DRIVEWAYS SHALL BE TUNNELED OR JACKED PER LOS ANGELES COUNTY ROAD DEPARTMENT REQUIREMENTS.  
 THE FOLLOWING LATEST REVISED STANDARD PLANS ON FILE IN THE OFFICE OF COUNTY ENGINEER SHALL APPLY IN THE CONSTRUCTION OF THIS PROJECT:

- LEADS . . . . . S-1
- MINIMUM EXCAVATION SAFETY REQUIREMENTS . . . . . S-2
- BRICK MANHOLE . . . . . S-3
- MANHOLE FRAME AND COVER . . . . . S-15
- MANHOLE STEP . . . . . S-17
- BEDDING FOR SEWER PIPE . . . . . S-21
- SPECIAL SUPPORT AND PROTECTION . . . . . S-22
- CRADLING AND BRACING . . . . . S-23
- STANDARD WYE SUPPORT . . . . . S-24
- ALTERNATE TRENCH WIDTHS . . . . . S-28
- DROP MANHOLE . . . . . S-4

THE UNDERGROUND UTILITY COMPANIES WITHIN THE LIMITS OF THIS PROJECT ARE AS FOLLOWS:

- (1) BEVERLY HILLS WATER (1)
- (2) CALIE GAS CO. (2)
- (3) PACIFIC TEL. CO. (3)
- (4) D. L. (4) ORNAMENTAL LIGHTING

### WEST HOLLYWOOD RELIEF SEWERS CASH CONTRACT NO. 7736

PROFILE, ALIGNMENT AND GRADE OF  
 SANITARY SEWERS  
 TO BE CONSTRUCTED IN  
**WESTBOURNE DRIVE**  
 AND OTHER RIGHTS OF WAY

4 SHEETS, 7 PAGES

SCALE: HORIZ. 1"=40'

DECEMBER 1967

COUNTY OF LOS ANGELES, CALIFORNIA

JOHN A. LAMBE

COUNTY ENGINEER

APPROVED BY *Richard M. Carr*  
 ASST. COUNTY ENGINEER

J. D. PARKURST  
 CHIEF ENGINEER OF COUNTY  
 SANITATION DISTRICT NO. 9

SUBMITTED BY *Richard M. Carr*  
 R.E.E. NO. 14550

APPROVED BY *Richard M. Carr*  
 OFFICE ENGINEER

NOTES:  
 WORK SHALL BE CONSTRUCTED ACCORDING TO STANDARD SPECIFICATIONS FOR PUBLIC WORKS CONSTRUCTION ON FILE IN THE OFFICE OF THE COUNTY ENGINEER AND SHALL BE PROSECUTED ONLY IN THE PRESENCE OF THE COUNTY ENGINEER.  
 GRADES TO WHICH THIS IMPROVEMENT IS TO BE CONSTRUCTED ARE SHOWN ON PLANS AND PROFILES. GRADE POINTS FOR TOP OF CURB, CENTER LINE OF STREET OR CENTER LINE OF ALLEY ARE SHOWN BY CIRCLES ON PROFILES AT ALL POINTS BETWEEN DESIGNATED POINTS. THE GRADE SHALL BE ESTABLISHED SO AS TO CONFORM TO A STRAIGHT LINE DRAWN BETWEEN SAID DESIGNATED POINTS.  
 ELEVATIONS ARE IN FEET ABOVE U.S.C. & G.S. SEA LEVEL DATUM OF 1929.  
 UNIT PRICES FOR ADDITIONAL WORK WHICH MAY BE REQUIRED BUT WHICH CANNOT BE ASCERTAINED IN ADVANCE, SHALL BE SUBMITTED IN THE PROPOSAL.  
 THIS DRAWING AND THE DATA HEREON ARE HEREBY MADE A PART OF THE SPECIFICATIONS.

DATE	BY	REVISION	DESCRIPTION	DATE
LAYOUT	R. GONZALEZ-RUBIO	MARCH 1967	UNDERGROUND	R.W. SCOTT 7-22-67
TRACED	R. GONZALEZ-RUBIO	MARCH 1967	BENCH MARKS	L.J. BOYLES 7-20-67
CHECKED	H. GIRAUD & E. WEBER	DEC. 1967	MAINTENANCE	G.M. CADWELL 7-24-67
F. B. 2713, 2709			INSPECTOR	
A. B.		W. S. 22	RECORD PLANS	

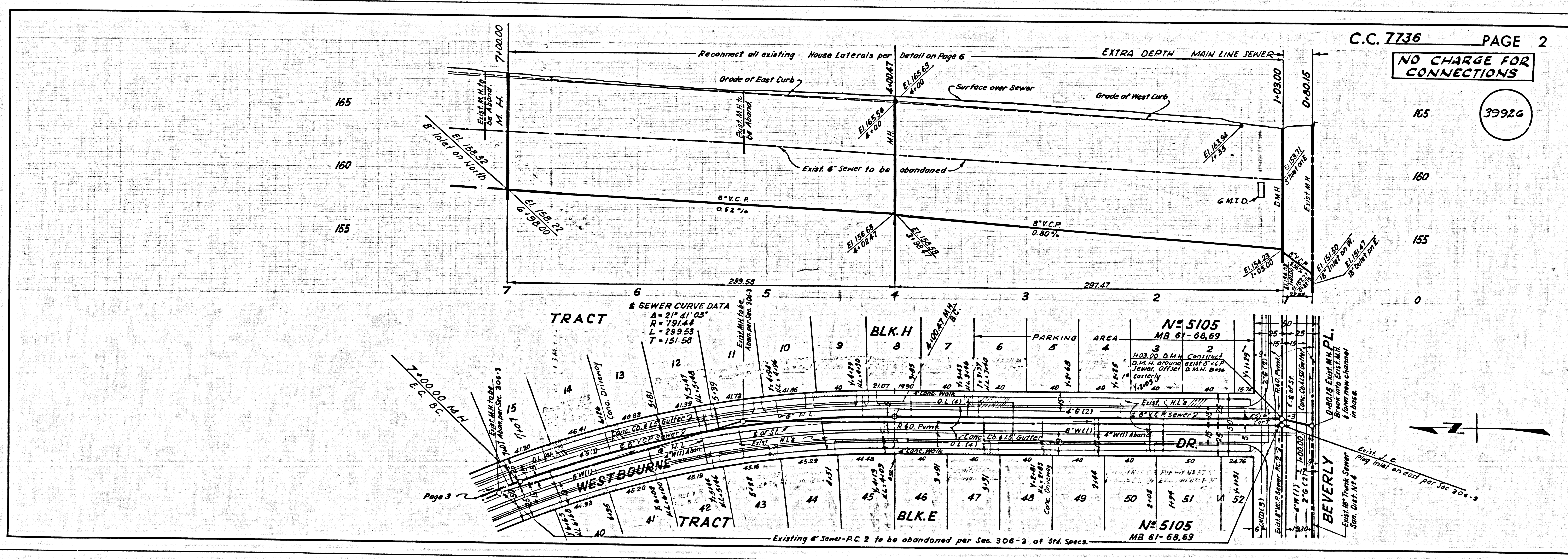

**NO CHARGE FOR CONNECTIONS**

39926

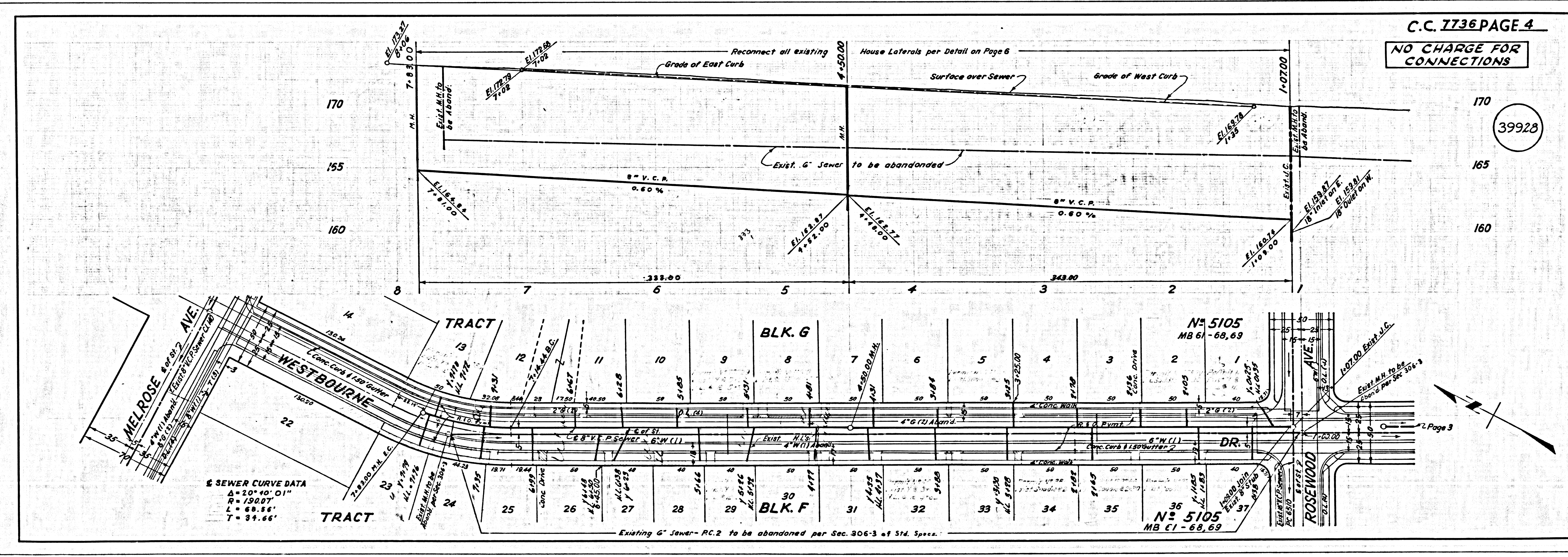
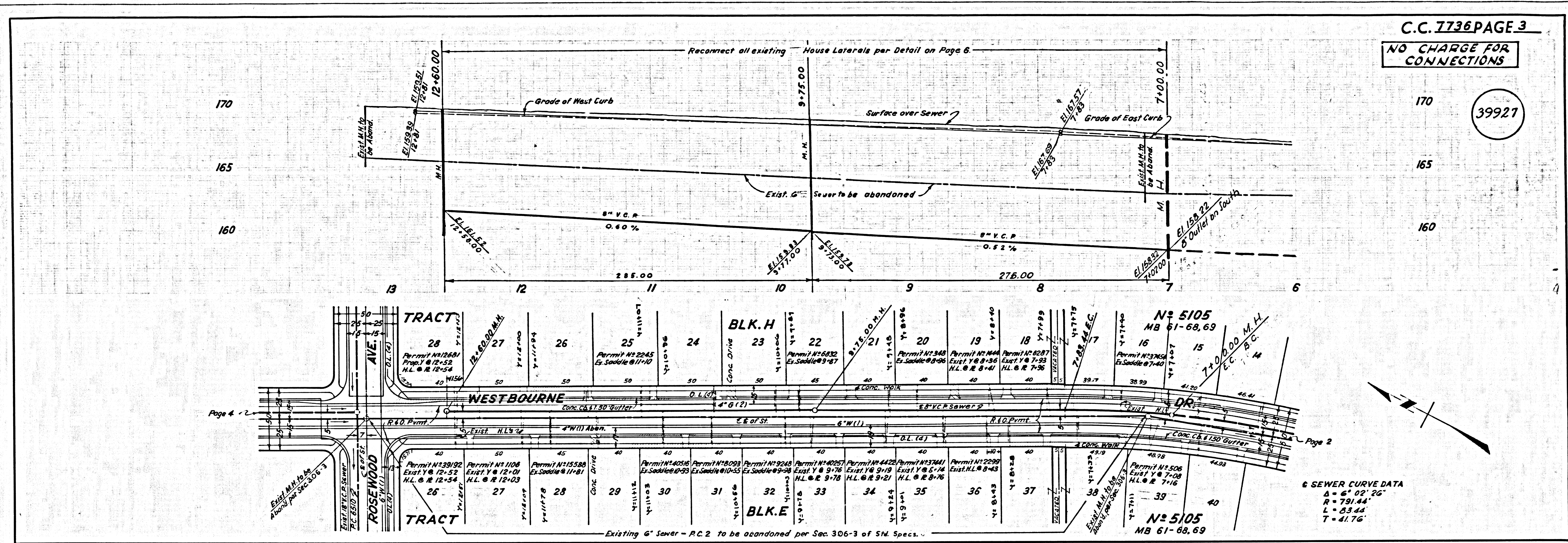

NO CHARGE FOR CONNECTIONS

39929

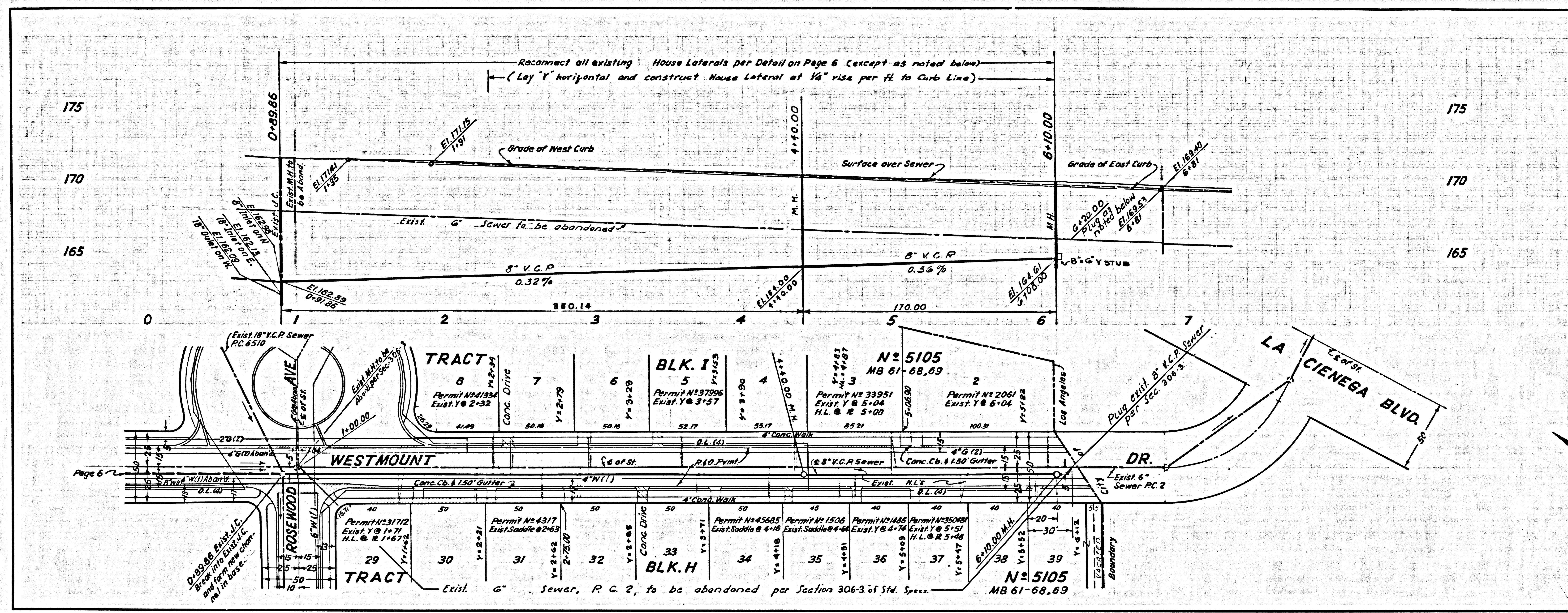

NO CHARGE FOR CONNECTIONS

39930

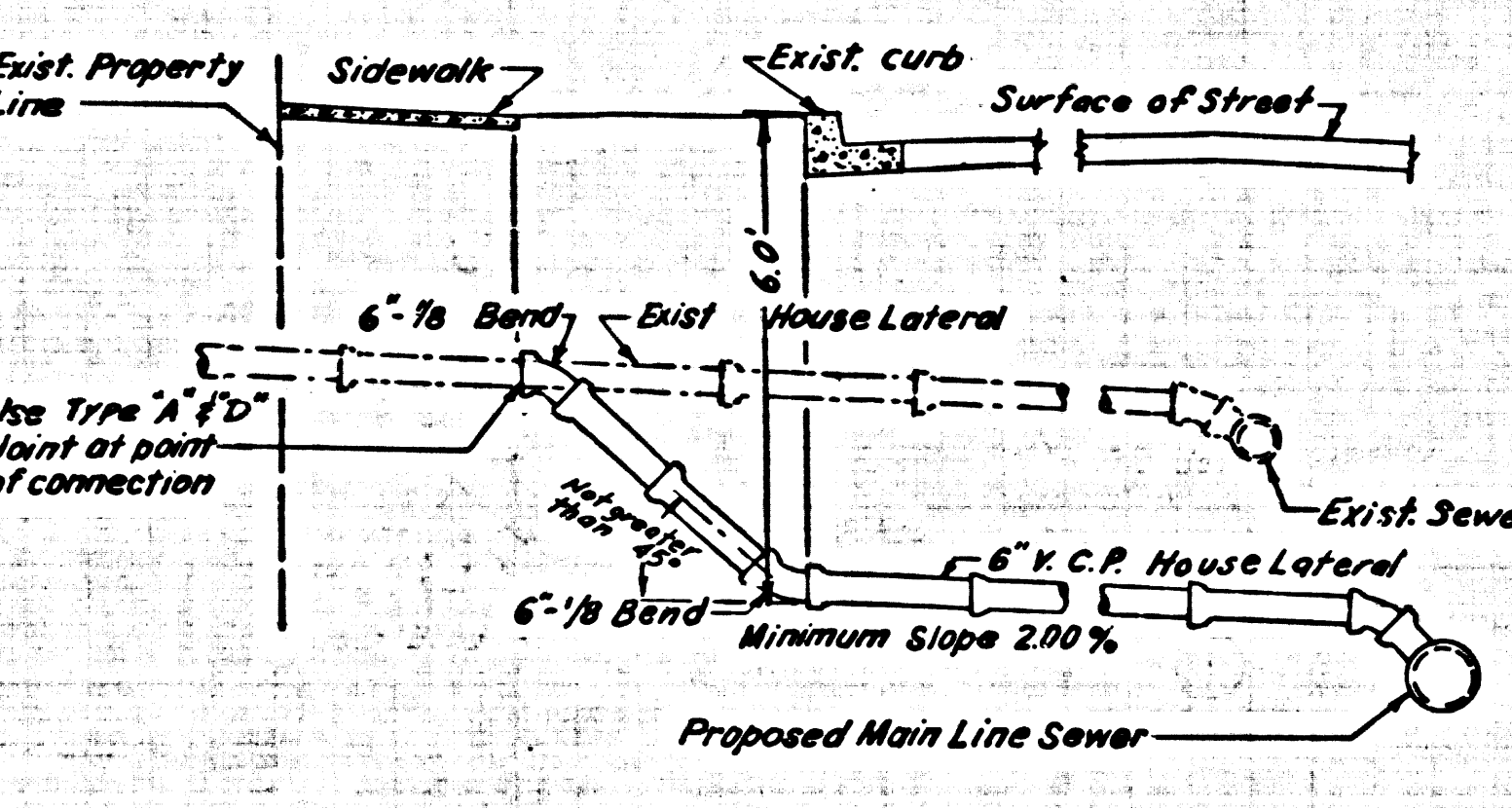
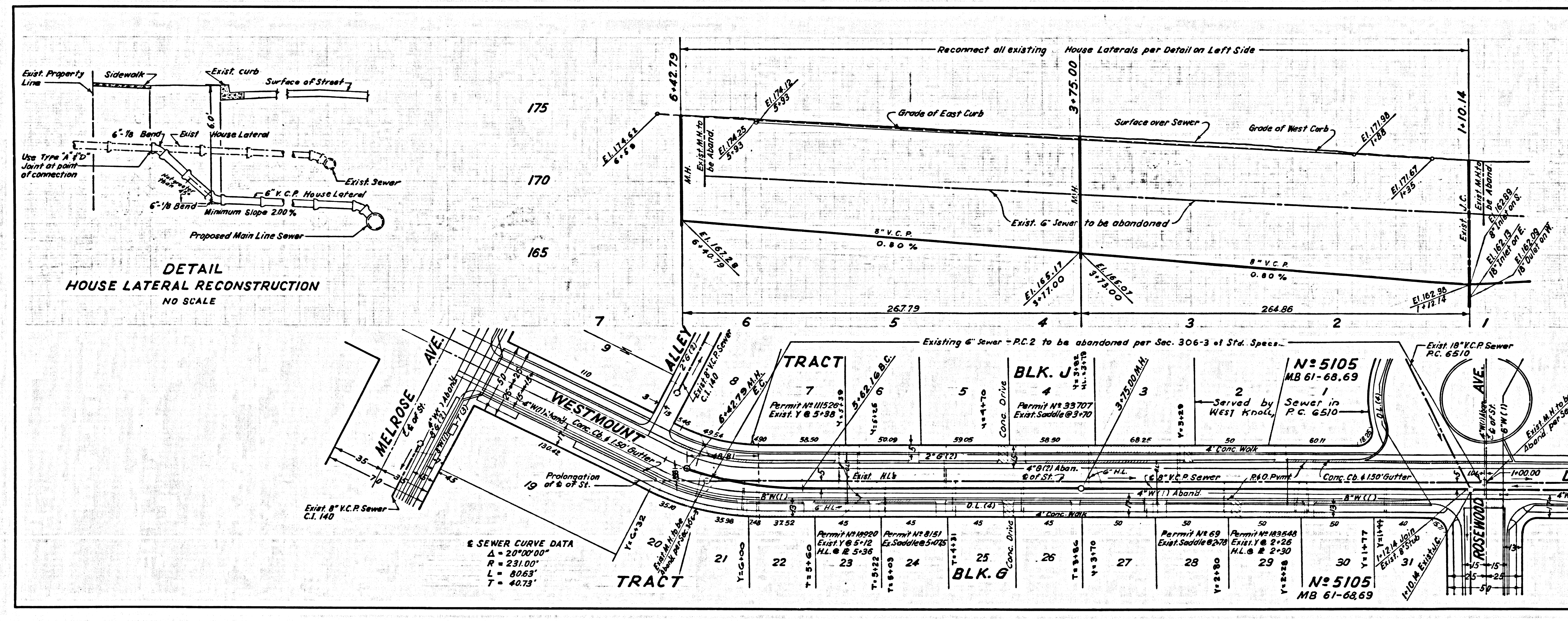

SEWER CURVE DATA  
 $\Delta = 20^{\circ}00'00''$   
 $R = 231.00'$   
 $L = 80.63'$   
 $T = 40.73'$

