

B.M. 4929 ELEV. 920.634 (M.O.A.)
 R.D.M. THE CONV. CA 5 1/2 SE GUARD HOUSE
 ENTRANCE TO HIDDEN HILLS 2 1/2 NORTH &
 LONG VALLEY ROAD. (PRIVATE ROAD)
 QUAD. 19

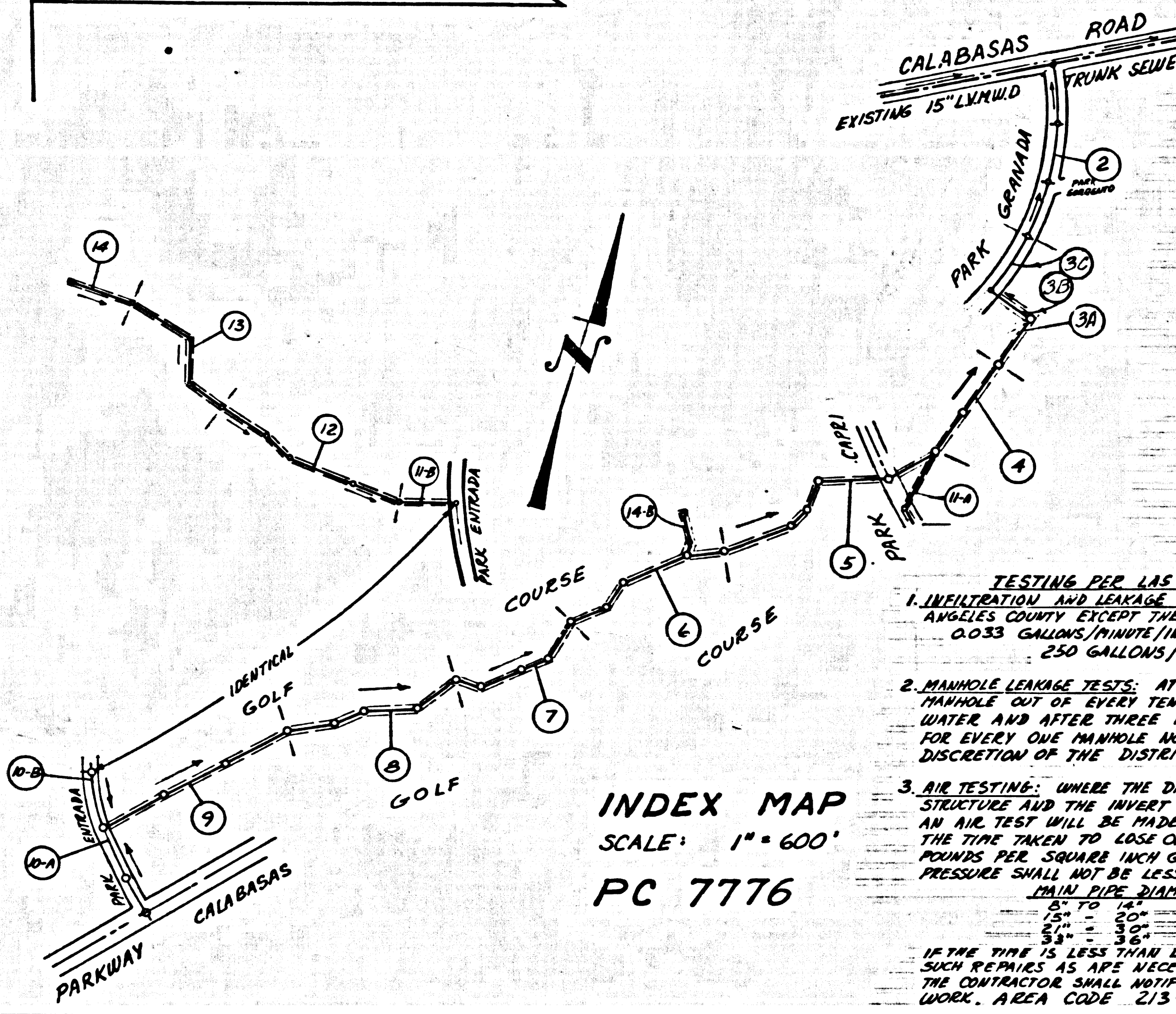

REVISIONS:

NO.	DATE	DESCRIPTION
1	10-26-67	ADJUSTMENT & GRADE CHANGE FROM STA. 55+25 TO STA. 60+12.48
2	10-26-67	GRADE CHANGE FROM STA. 140 TO STA. 3+25.27
3	10-26-67	ADDED
4	10-26-67	RAISE SEWER GRADE BETWEEN STA. 60+12.48 AND STA. 61+72.13
5	10-26-67	LOWER SEWER GRADE IN PARK GRANADA (CONV.) BETWEEN STA. 140 AND STA. 140+75.00
6	10-26-67	ADDED
7	10-26-67	ADJUSTMENT AND GRADE CHANGE FROM STA. 41+72.37 TO STA. 48+41.56
8	10-26-67	ADD 6" HOUSE LATERALS
9	10-26-67	DELETE "S-3" RECONSTRUCTION ON ALL MANHOLES
10	10-26-67	ADD MANHOLE FROM STA. 12+14.15 TO STA. 26+75.50
11	10-26-67	REMOVE ALIGNMENT AND GRADE: STA. 140 TO STA. 3+25.27
12	10-26-67	ADJUSTMENT AND GRADE CHANGE FROM STA. 54+66.83 TO STA. 55+108.30
13	10-26-67	REMOVE STRUCTURE AND RAISE SEWER GRADE FROM STA. 25+49.50 TO STA. 26+75.50
14	10-26-67	ADDED
15	10-26-67	CHANGE STRUCTURE
16	10-26-67	STA. 53+70.78 AND 60' OF 6" I.D. TO SEWER CONDUIT STATION
17	10-26-67	ADD 6" MANHOLE 6' DIA. NORTH OF TRUNK SEWER
18	10-26-67	GRADE SEWER FROM STA. 140 TO STA. 3+25.27
19	10-26-67	ADDED
20	10-26-67	ADJUSTMENT AND GRADE CHANGE FROM STA. 140 TO STA. 2+45.00
21	10-26-67	REMOVE MANHOLE FROM STA. 140 TO STA. 3+76.09 AND 60' DIA. AT STA. 2+45.00, C/P. RELOCATED TO STA. 3+71.50/400' DIA. (NEARLY STRAIGHT MANHOLE)
22	10-26-67	ADDED

TESTING PER LAS VIRGENES MUNICIPAL WATER DISTRICT
 1. INFILTRATION AND LEAKAGE TEST: METHOD USED FOR TESTING WILL BE THE SAME AS LOS ANGELES COUNTY EXCEPT THE FORMULA TO BE USED IS AS FOLLOWS:
 0.033 GALONS/PINCH/TWENTY IN. PHOSPHORUS DIPHOSPHATE / 1,000 FEET², OR
 0.50 GALLONS/ONE HUNDRED OF 24 INCHES DIAMETER

2. MANHOLE LEAKAGE TEST: AT THE DISCRETION OF THE DISTRICTS REPRESENTATIVE ONE MANHOLE OUT OF EVERY TEN MANHOLES, AS A MINIMUM OF TWO WILL BE FILLED WITH WATER AND AFTER THREE HOURS WILL BE CHECKED FOR LEAKAGE, WITH NO DROP IN LEVEL. FOR EVERY ONE MANHOLE NOT PASSING TESTS, FIVE MORE WILL BE TESTED AT THE DISCRETION OF THE DISTRICTS REPRESENTATIVE.

3. AIR TESTING: WHERE THE DIFFERENCE IN ELEVATION BETWEEN THE INVERT OF THE UPPER STRUCTURE AND THE INVERT OF THE LOWER STRUCTURE IS MORE THAN SIX FEET (6') AN AIR TEST WILL BE MADE.
 THE TIME TAKEN TO LOSE ONE (1) POUND PER SQUARE INCH GAUGE PRESSURE FROM THREE (3) POUNDS PER SQUARE INCH GAUGE PRESSURE TO TWO (2) POUNDS PER SQUARE INCH GAUGE PRESSURE SHALL NOT BE LESS THAN TIMES SHOWN IN THE FOLLOWING TABLE:

MINIMUM TIME TO LOSE	MINIMUM TIME TO LOSE
1" DIA.	5 MINUTES
2" DIA.	6 MINUTES
3" DIA.	7 MINUTES
4" DIA.	8 MINUTES
6" DIA.	10 MINUTES

IF THE TIME IS LESS THAN LISTED IN THE TABLE ABOVE, THE CONTRACTOR SHALL MAKE SUCH REPAIRS AS ARE NECESSARY TO ELIMINATE THE EXCESSIVE LEAKAGE.
 THE CONTRACTOR SHALL NOTIFY THE L.V.M.W.D. 48 HOURS PRIOR TO COMMENCING WORK. AREA CODE 213-689-0110.

DOUBLE SCALE
 CALABASAS BLDG. DIST. NO. 9.1

- PROVIDE STAKES ON THE PROPERTY LINE OR PROPERTY LINES PRODUCED AT RIGHT ANGLES TO THE SEWER LINE AT THE CENTER LINE OF EACH MANHOLE.
- NO REPRESENTATIVE OF THE COUNTY ENGINEER WILL SURVEY OR LAY OUT ANY PORTION OF THE WORK.
- THE PRIVATE ENGINEER SHALL FURNISH THE COUNTY ENGINEER WITH GRADE SHEETS AND STATIONING FOR ALL HOUSE LATERALS AND "T" BRANCHES AND SHALL PROVIDE STAKES FOR THEM AT THEIR PROPER LOCATIONS WITH STATIONING PLAINLY MARKED. ALL HOUSE LATERALS SHALL BE CONSTRUCTED IN A STRAIGHT ALIGNMENT AT RIGHT ANGLES FROM THE MAIN LINE SEWER EXCEPT AS SHOWN ON THE PLANS. HOUSE LATERALS FROM CHIMNEYS SHALL NOT HAVE AN ANGLE OF LESS THAN 45° WITH THE MAIN LINE SEWER. ANY CHANGE IN ALIGNMENT SHALL BE REQUESTED IN WRITING BY THE PRIVATE ENGINEER.
- THE PRIVATE ENGINEER SHALL FURNISH THE HOUSE LATERAL DEPTH AT THE PROPERTY LINE BELOW THE TOP OF CURB ELEVATION FOR EACH HOUSE LATERAL ON THE GRADE SHEET.
- NO REVISIONS SHALL BE MADE IN THESE PLANS WITHOUT THE APPROVAL OF THE COUNTY ENGINEER.
- THE CONTRACTOR SHALL NOTIFY THE COUNTY ENGINEER BY TELEPHONE, MADISON 9-4747, EXT. 8128, AT LEAST TWENTY-FOUR HOURS BEFORE STARTING ANY WORK UNDER THIS CONTRACT.
- MANHOLES SHALL BE BRICK SEWER STRUCTURES PER S-3 PRECAST CONCRETE MANHOLES PER S-3 OR S-4 EXCEPT AS NOTED.
- USE STANDARD MANHOLE FRAMES AND COVERS, S-16, EXCEPT AS NOTED.
- MANHOLE TOPS IN UNIMPROVED RIGHTS-OF-WAY TO BE SIX INCHES ABOVE FINISHED GRADE.
- USE EXTRA STRENGTH PIPE. ALL PIPE IS STANDARD DEPTH EXCEPT AS NOTED.
- USE MECHANICAL COMPRESSION JOINTS FOR ALL V.C.P. JOINTS PER SPCS., SECS. 24, 26 & S-4.
- IF A POWER POLE IS WITHIN THREE FEET OF THE SEWER, THE SEWER SHALL BE ENCASED, PER S-25, TWO FEET ON EACH SIDE FROM THE POINT OF INTERFERENCE.
- IF DURING THE COURSE OF CONSTRUCTION IT IS DETERMINED THAT THERE IS LESS THAN FOUR FEET OF COVER OVER THE TOP OF A MAIN LINE OR HOUSE LATERAL V.C.P. SEWER WHICH IS NOT INDICATED ON THE PLANS, THE PIPE SHALL BE ENCASED PER S-25, UNLESS OTHERWISE APPROVED BY THE COUNTY ENGINEER.
- HOUSE LATERALS TO BE CONSTRUCTED WITH INVERTS AT PROPERTY LINE 6 FEET BELOW CURB GRADE EXCEPT AS NOTED.
- RESURFACE ALL TRENCHES WITHIN PAVED AREAS TO MEET L.A. COUNTY ROAD DEPT. OR CALIFORNIA STATE HIGHWAY REQUIREMENTS IN ACCORDANCE WITH PERMITS.
- FOR ALLOWABLE GRADES PER USE FORMULA NO. 2, SPEC. E, SEC. 84.
- ALL STATE AND LOCAL TRENCH SAFETY ORDINANCES WILL BE STRICTLY ENFORCED.
- SPECIAL BACKFILL IN DESIGNATED AREAS:
 - BACKFILL TRENCH AND REPLACE OTHER EARTH ON GRADING SO AS TO ACHIEVE THE NATURAL OR FINISHED GRADES AND SLOPES EXISTING IN THE READING PLAN APPROVED FOR THIS DEVELOPMENT BY THE BUILDING AND SAFETY DIVISION.
 - ALL BACKFILL AND EARTH REPLACED SHALL BE COMPACTED TO A MINIMUM OF 90% OF MAXIMUM DENSITY PER A.S.T.M. STANDARD METHOD OF D 698-57 T AS NOTIFIED. ACCEPTABLE CERTIFICATION OF SUCH COMPACTNESS SHALL BE SUBMITTED TO THE CONSTRUCTION DIVISION.
- FOR SEWER PIPE BEHAVIOR SEE COUNTY ENGINEER STD. DRAWING S-21.
- ALL JOINTS BETWEEN CAST IRON PIPE AND VITRIFIED CLAY PIPE SHALL BE MADE WITH A RUBBER SLEEVE JOINT (WITH HOOP IF NECESSARY) PER STANDARD SPECIFICATIONS, SECTION 36, OR APPROVED EQUAL.

COLLECT CHARGES
 AS INDICATED
 [Signature]

PROFILE, ALIGNMENT AND GRADE OF P.C. 7776
 SANITARY SEWERS PAGE 1
 TO BE CONSTRUCTED IN
 SANITARY SEWER R/W
 CALABASAS PARK OUTLET SEWER

PRIVATE CONTRACT NO. 7776
 W.S. 60
 8 SHEETS, 15 PAGES
 SCALE: VERT. 1" = 4' HORIZ. 1" = 40'
 DECEMBER, 1966
 39490

PREPARED IN THE OFFICES OF
 BECHTEL CORPORATION
 23600 CALABASAS ROAD, CALABASAS, CALIFORNIA.
 BY: [Signature]
 A. STANLEY BOWEN, REG. C.E. NO. 14223

FOR LEGEND SEE PLAN NO. S-1
 NOTE: GRADES TO WHICH THIS IMPROVEMENT IS TO BE CONSTRUCTED ARE SHOWN ON PLANS AND PROFILES. GRADE POINTS FOR TOP OF CURB, CENTER LINE OF STREETS, OR CENTER LINE OF ALLEYS ARE SHOWN BY CIRCLES ON PROFILES. AT ALL POINTS BETWEEN DESIGNATED POINTS THE GRADE SHALL BE ESTABLISHED SO AS TO CONFORM TO A STRAIGHT LINE BETWEEN SAID DESIGNATED POINTS. ELEVATIONS ARE IN FEET ABOVE U.S.C. & G.S. MEAN SEA LEVEL DATUM OF 1929. THE ORIGINAL AND THE DATA PROVIDED HEREIN SHALL BE A PART OF THE SPECIFICATIONS. AS REVISED. WORK SHALL BE CONSTRUCTED ACCORDING TO STANDARD SPECIFICATIONS DATED JULY 25, 1962, ON FILE IN THE OFFICE OF THE COUNTY ENGINEER AND SHALL BE PROSECUTED ONLY IN THE PRESENCE OF THE COUNTY ENGINEER. BEFORE WORK CAN BE STARTED, THE CONTRACTOR MUST OBTAIN A PERMIT TO EXCAVATE IN COUNTY STREETS FROM THE L.A. COUNTY COUNTY ENGINEER AND SHALL BE PROSECUTED ONLY IN THE PRESENCE OF THE COUNTY ENGINEER. THE COUNTY ENGINEER'S BUILDING, 300 WEST SECOND STREET OR PALLOS VERDES-CANTONIA, PALM BEACH, FLORIDA. APPROVAL OF THIS PLAN BY THE COUNTY OF LOS ANGELES DOES NOT CONSTITUTE A REPRESENTATION AS TO THE ACCURACY OF THE LOCATION OR OF THE EXISTENCE OR NON-EXISTENCE OF ANY UNDERGROUND UTILITY PIPE, OR STRUCTURE WITHIN THE LIMITS OF THE PROJECT. THIS NOTE APPLIES TO ALL PAGES. IF WORK IS TO BE DONE IN A STATE HIGHWAY, A PERMIT MUST BE OBTAINED FROM THE STATE OF CALIFORNIA, DIVISION OF HIGHWAYS, 180 SOUTH SPRING STREET, LOS ANGELES, CALIFORNIA.

COUNTY OF LOS ANGELES, CALIFORNIA
 JOHN A. LAMBIE, COUNTY ENGINEER
 APPROVED BY: [Signature] REGIONAL ENGINEER
 LAS VIRGENES MUNICIPAL WATER DISTRICT
 APPROVED BY: [Signature] CHIEF ENGINEER

CHECKED BY: [Signature] 10-26-67
 REG. C.E. NO. 12220
 J.N. 0368.16

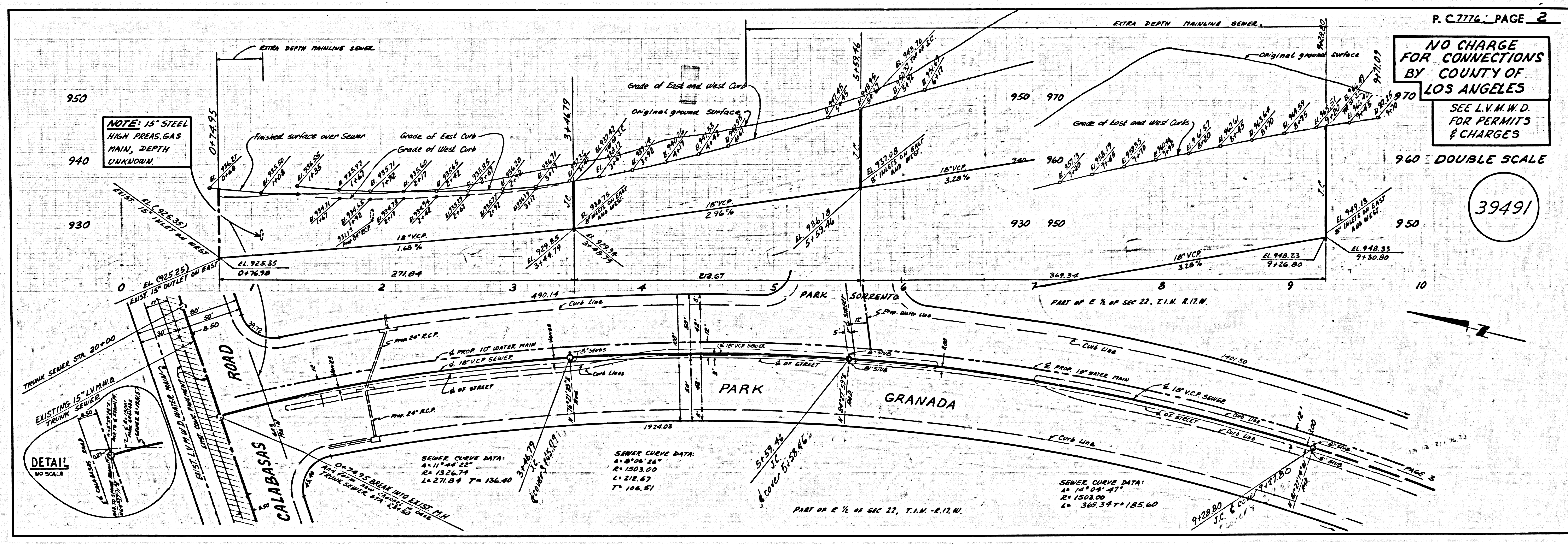

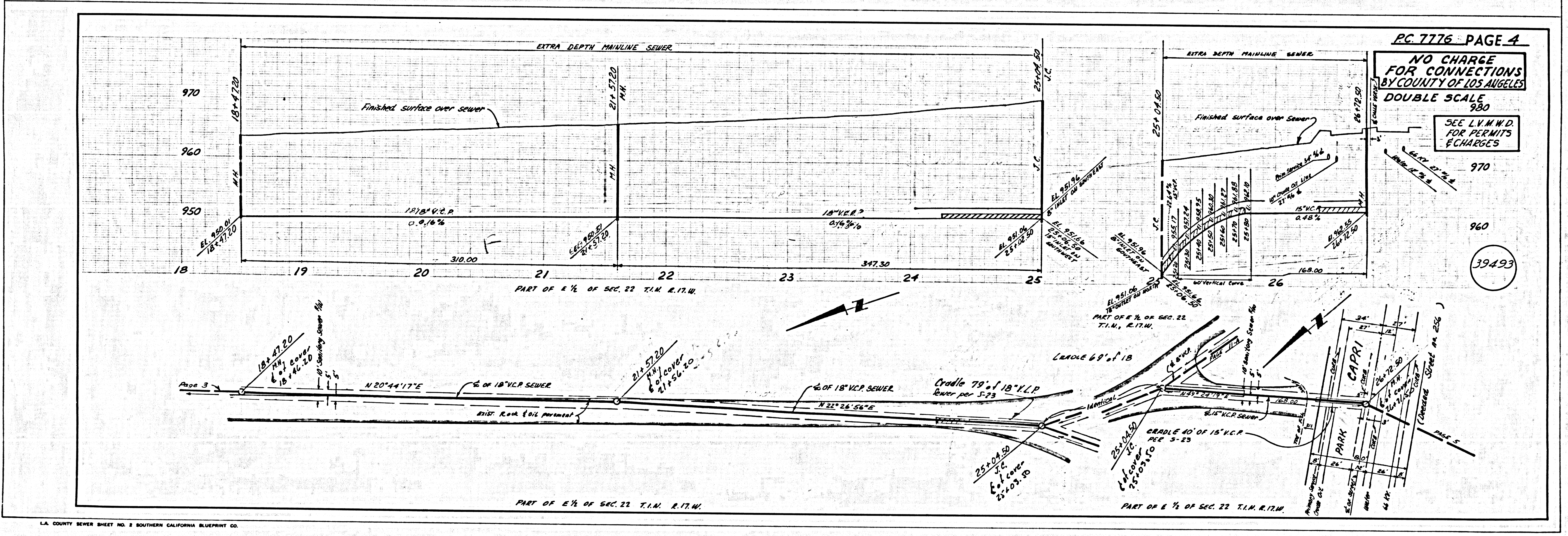
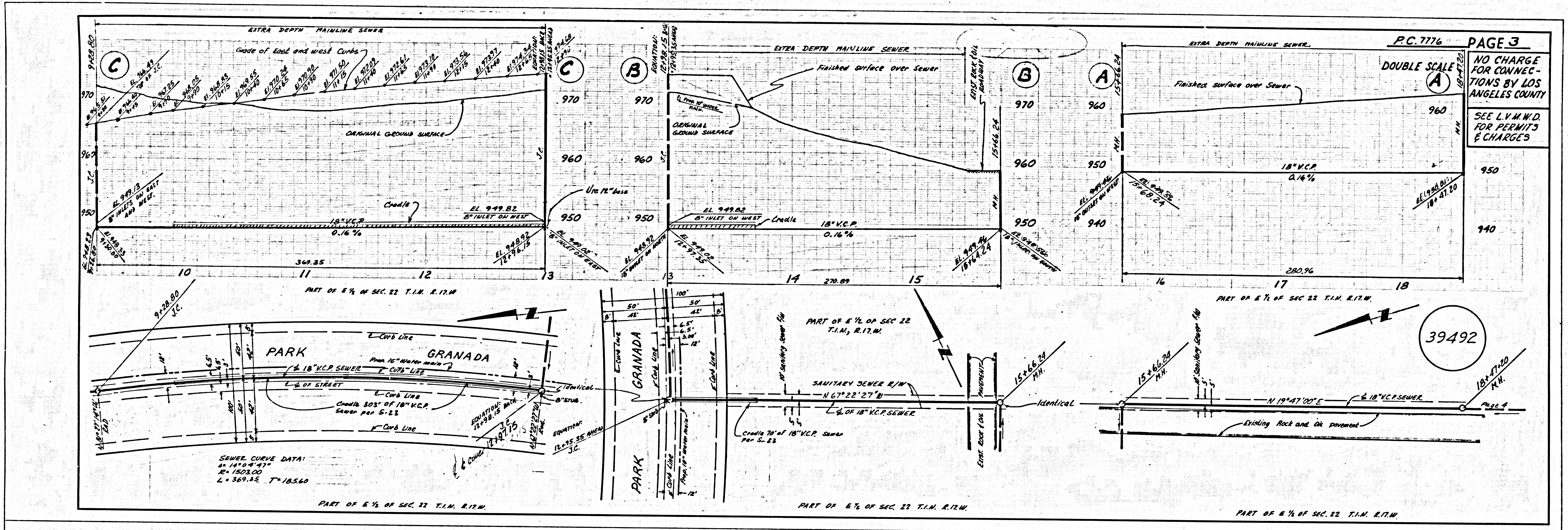

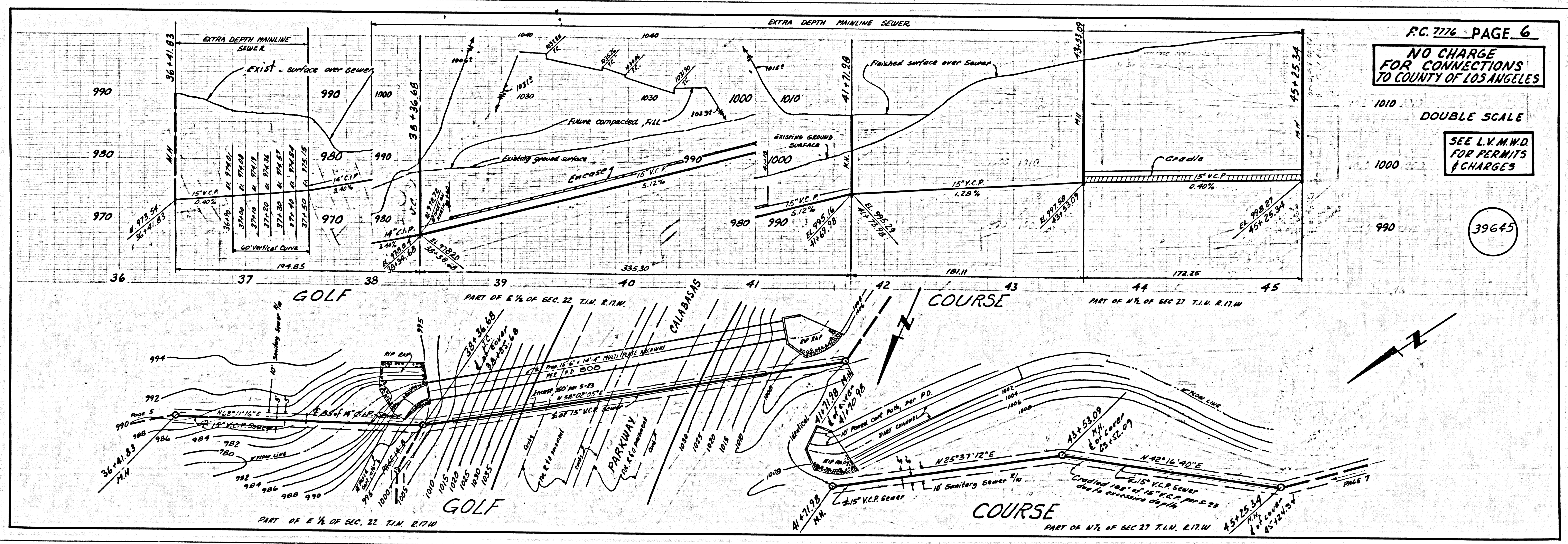
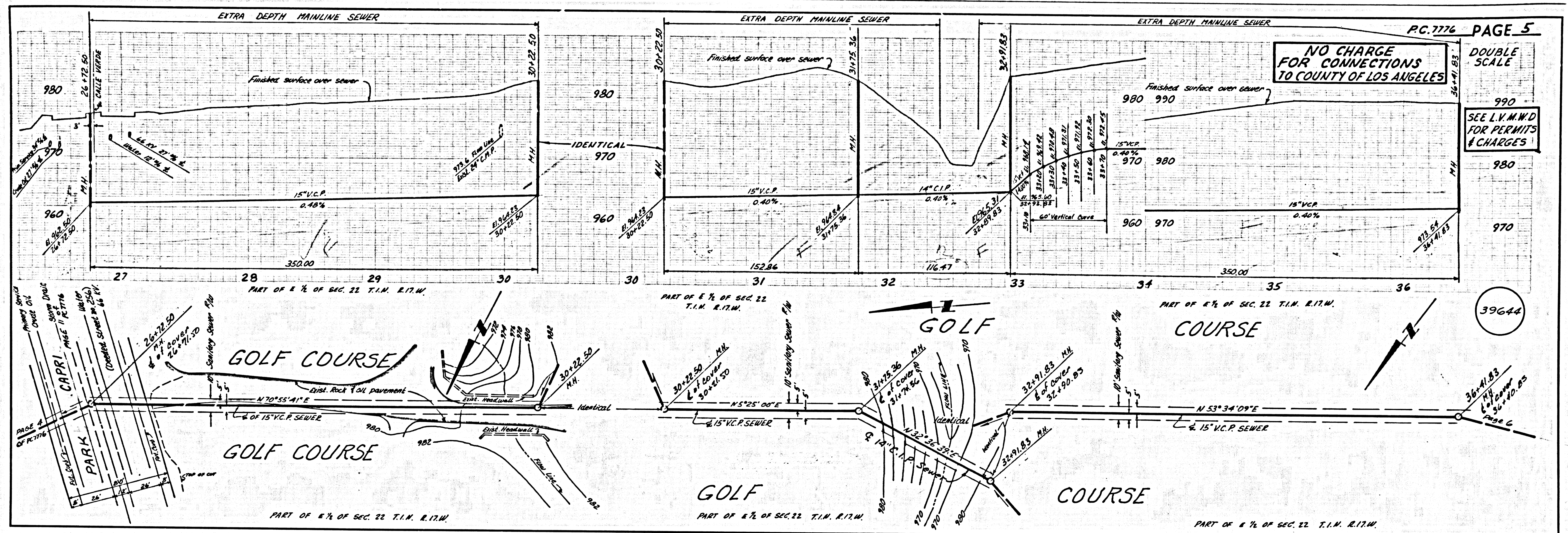

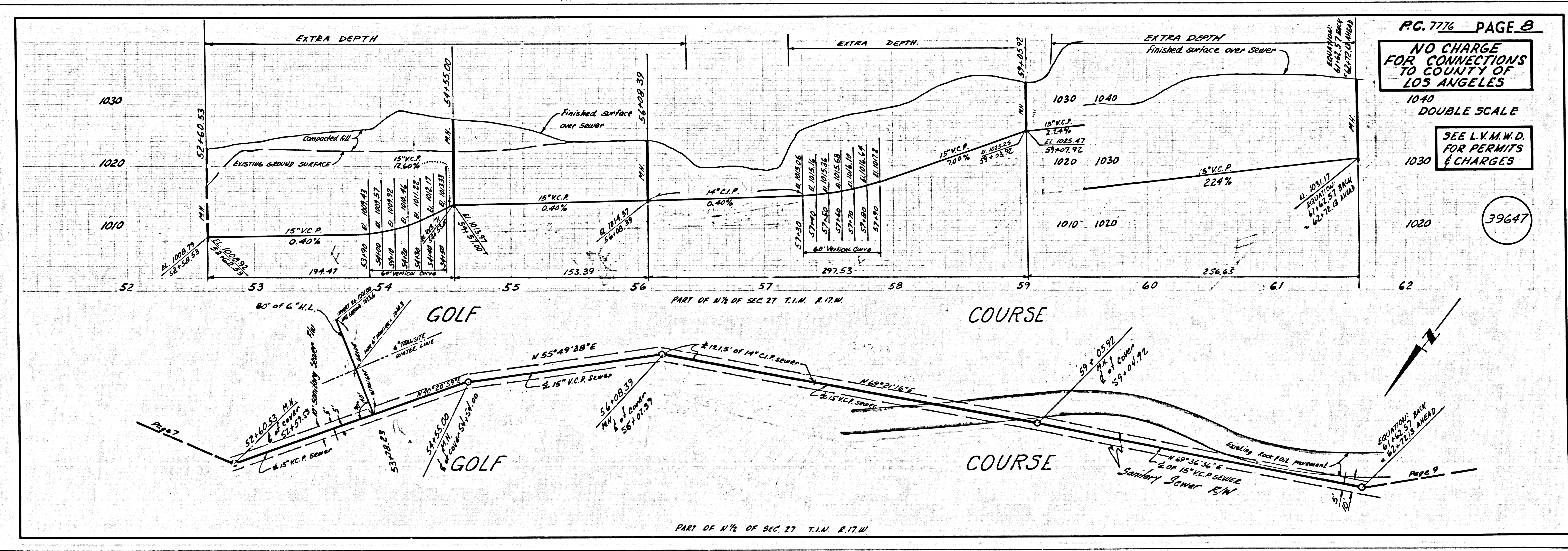
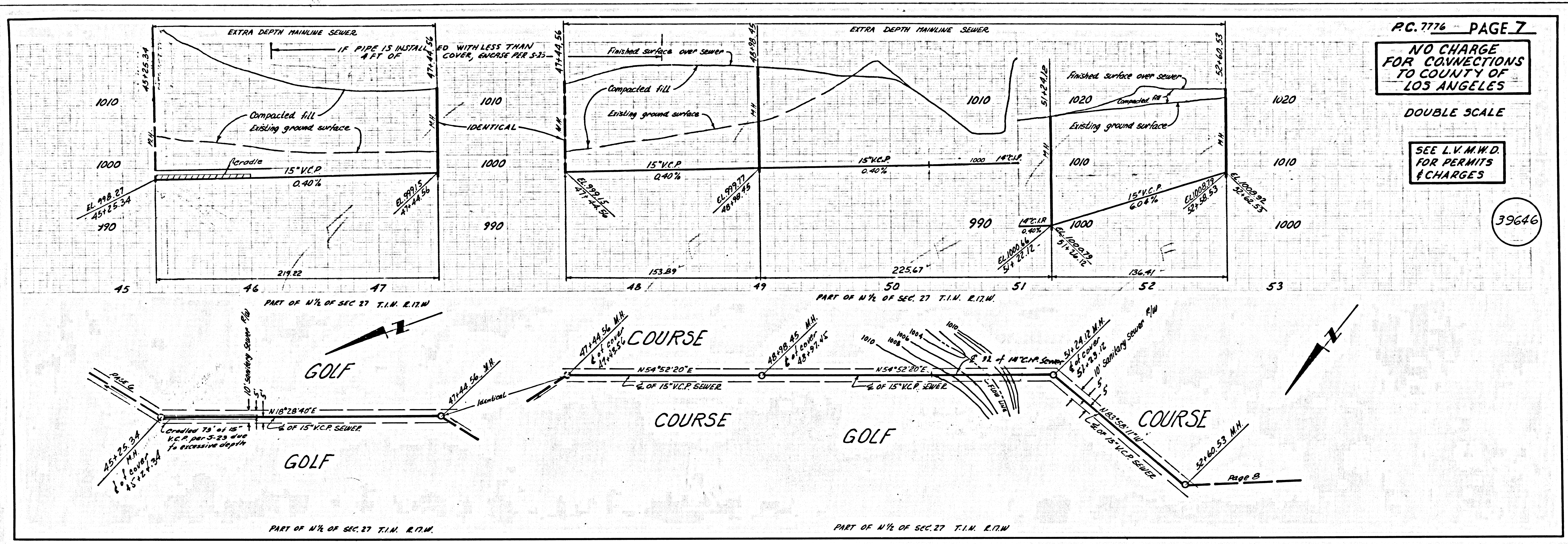

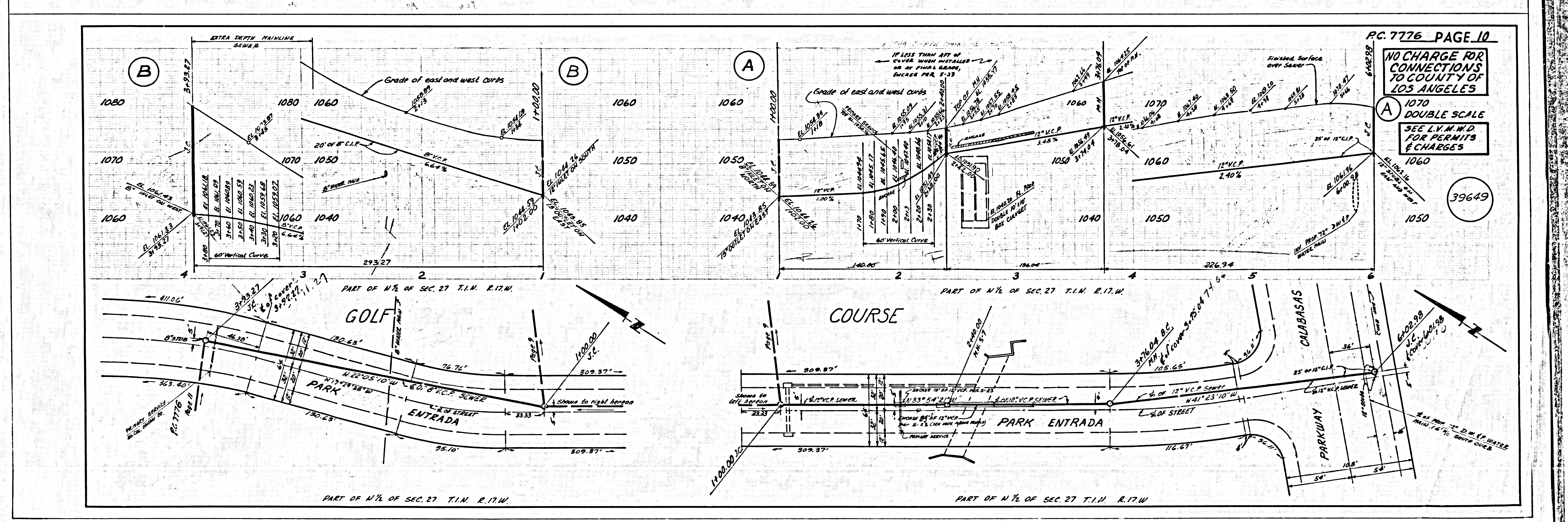
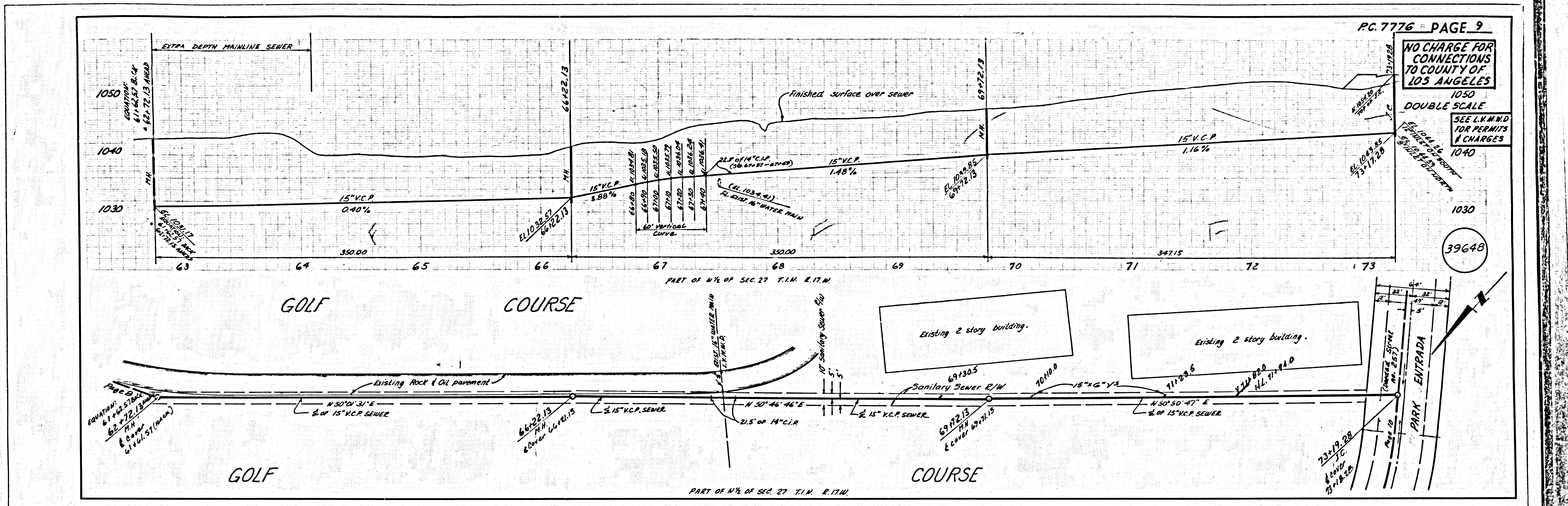

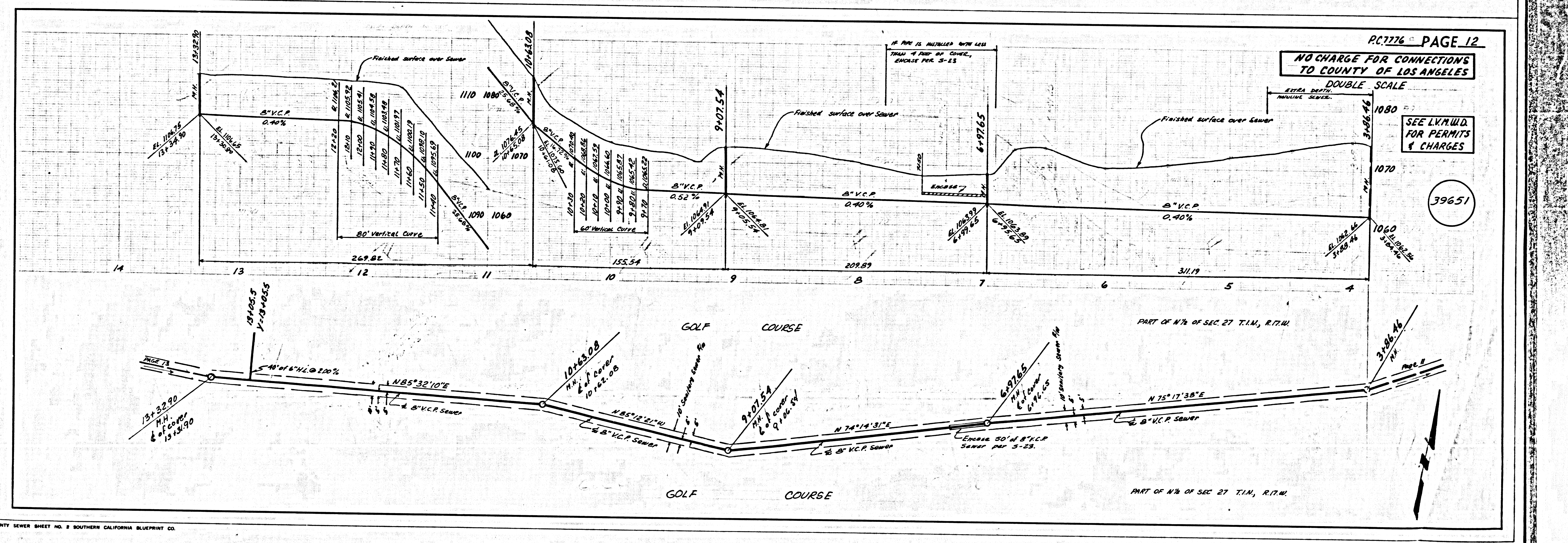
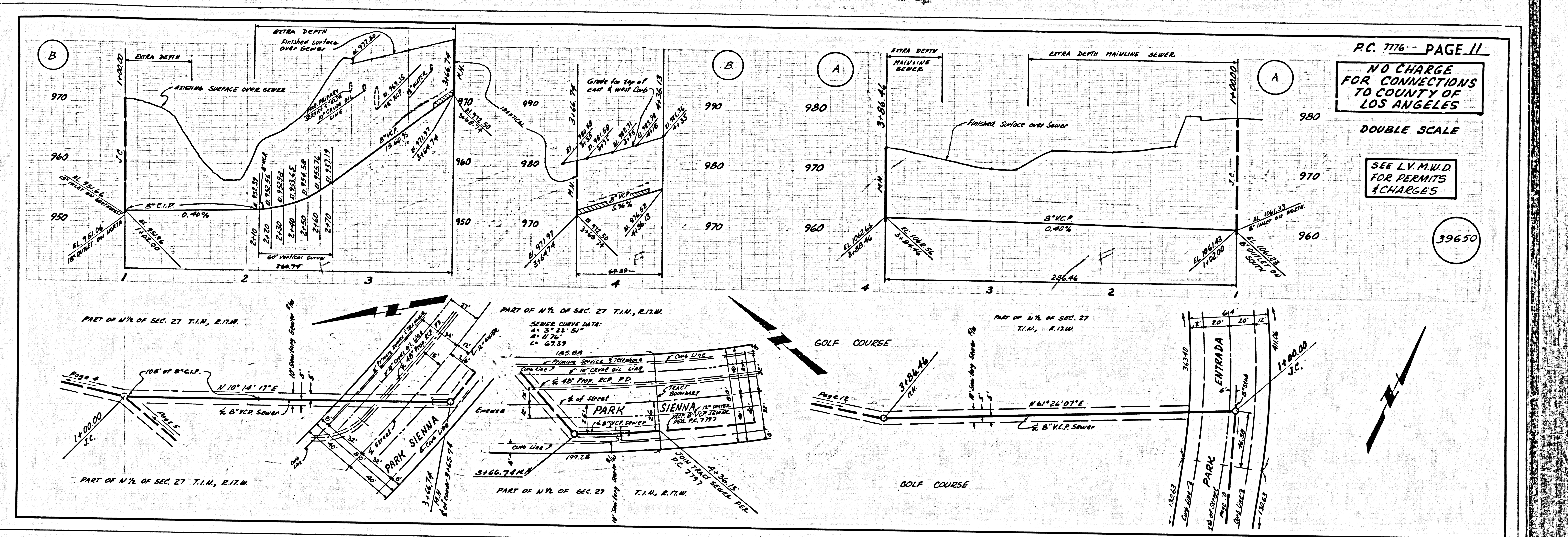

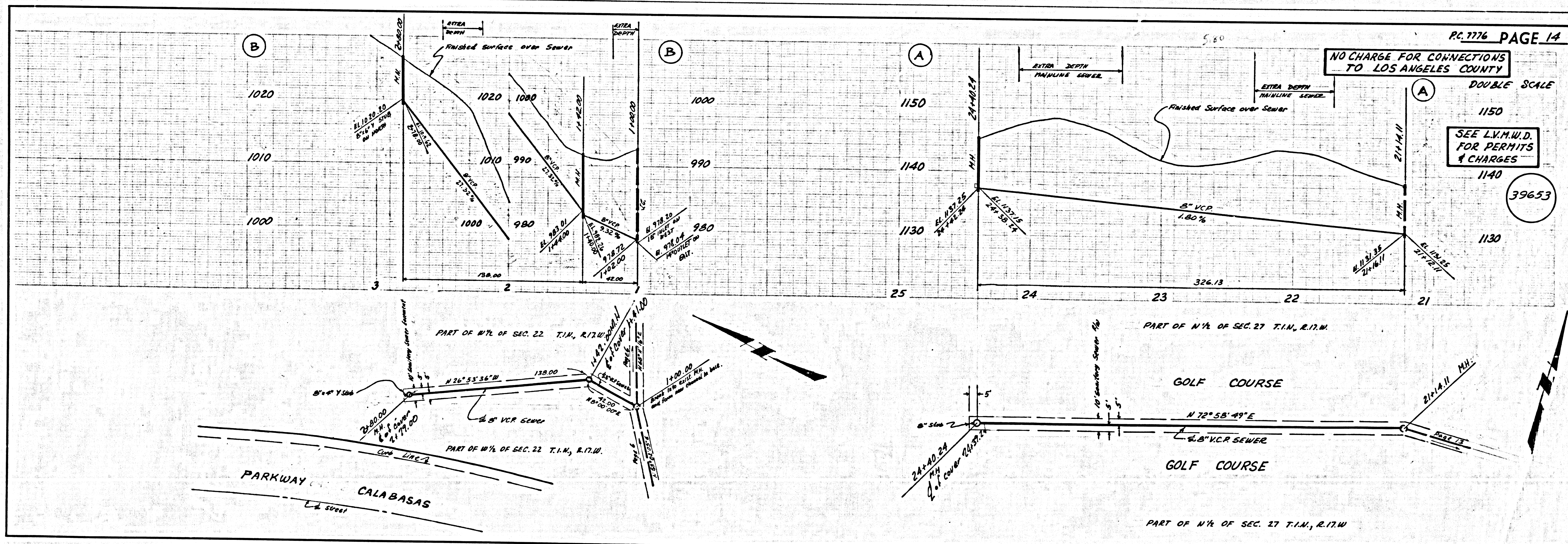
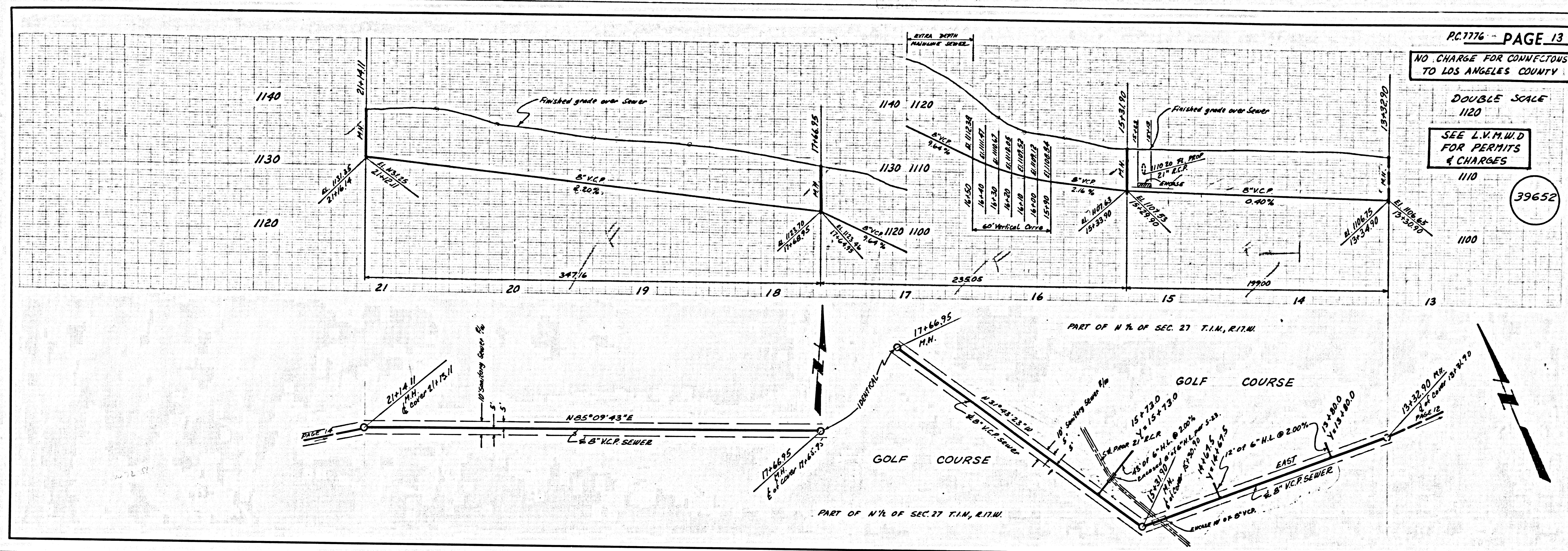

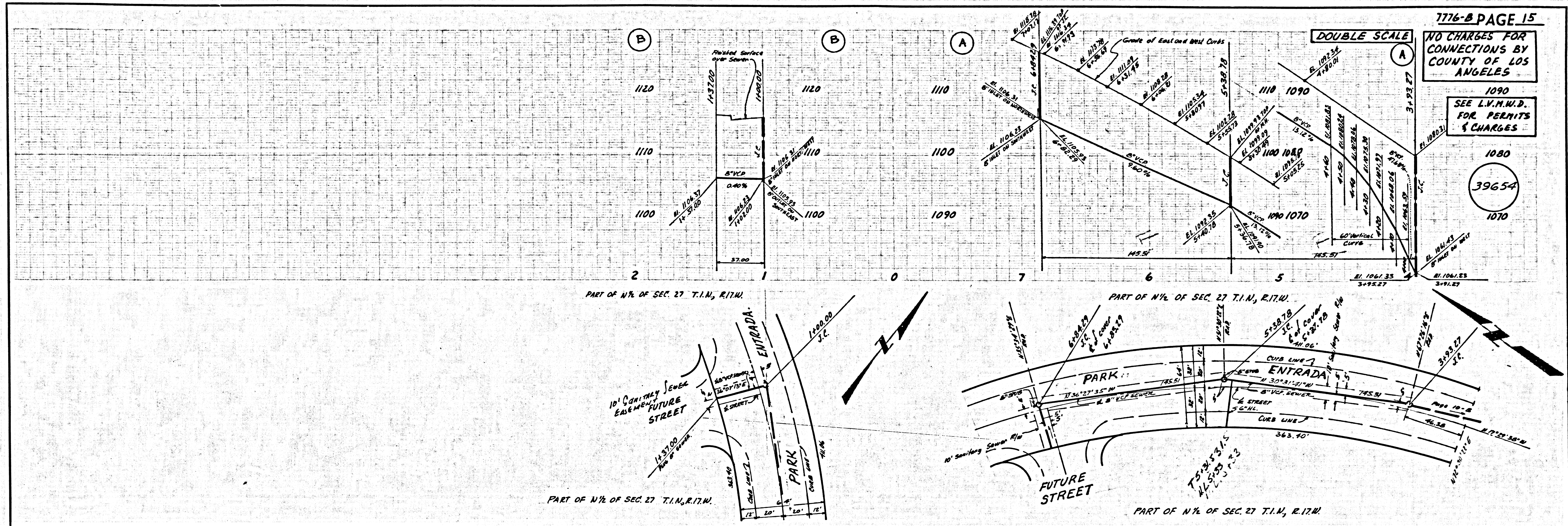

PAGE