

B.M. 51.1774 ELEV. 1078.163
 RD 8M TAB SLY CB TRAFFIC ISLAND
 IS 7' BY 11' SLY BARREL SAUGUS
 VENTURA 10' TO FT W/ OF FRWY. BR
 N 53-1622
 NEWHALL QUAD. 19 58

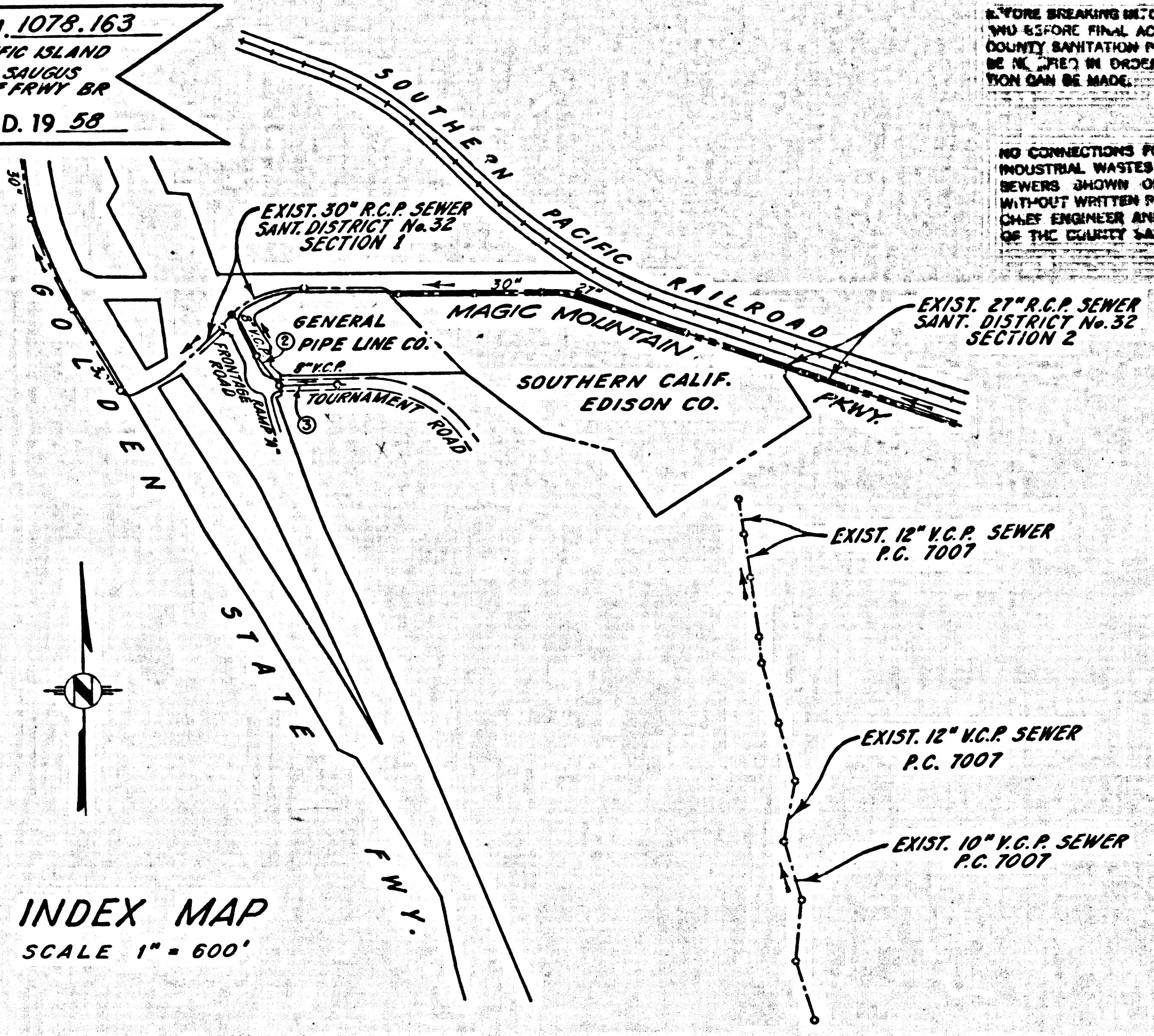

NO CONNECTIONS FOR THE DISPOSAL OF INDUSTRIAL WASTES SHALL BE MADE TO SEWERS EXCEPT ON THESE DISTRICTS WITHOUT WRITTEN PERMISSIONS FROM THE CHIEF ENGINEER AND APPROVED BY THE COUNTY SANITATION SECTION.

NEWHALL BLDG. DIST. NO. 8.2

- NOTE:
1. PROVIDE STAKES ON THE PROPERTY LINE OR PROPERTY LINES PRODUCED AT RIGHT ANGLES TO THE SEWER LINE AT THE CENTER LINE OF EACH MANHOLE.
 2. NO REPRESENTATIVE OF THE COUNTY ENGINEER WILL SURVEY OR LAY OUT ANY PORTION OF THE WORK.
 3. THE PRIVATE ENGINEER SHALL FURNISH THE COUNTY ENGINEER WITH GAUGE SHEETS AND STATIONING FOR ALL HOUSE LATERALS AND "Y" BRANCHES AND "U" PROVIDE STAKES FOR THEM AT THEIR PROPER LOCATIONS WITH STATIONING PLAINLY MARKED. ALL HOUSE LATERALS SHALL BE CONSTRUCTED IN A STRAIGHT ALIGNMENT AT RIGHT ANGLES FROM THE MAIN LINE SEWER EXCEPT AS SHOWN ON THE PLANS. ANY CHANGE IN ALIGNMENT SHALL BE REQUESTED IN WRITING BY THE PRIVATE ENGINEER.
 4. THE PRIVATE ENGINEER SHALL FURNISH THE HOUSE LATERAL DEPTH AT THE PROPERTY LINE BELOW THE TOP OF CURB ELEVATION FOR EACH HOUSE LATERAL ON THE GAUGE SHEET.
 5. NO REVISIONS SHALL BE MADE IN THESE PLANS WITHOUT THE APPROVAL OF THE COUNTY ENGINEER.
 6. THE CONTRACTOR SHALL NOTIFY THE CONSTRUCTION DIVISION BY TELEPHONE, ROOM 9-47, EXT. 6158, AT LEAST TWENTY-FOUR HOURS BEFORE STARTING ANY WORK UNDER THIS CONTRACT.
 7. MANHOLES SHALL BE BRICK SEWER STRUCTURES PER S-8 OR PRECAST CONCRETE MANHOLES PER S-8 OR S-8 EXCEPT AS NOTED.
 8. USE STANDARD MANHOLE FRAMES AND COVERS, S-16 EXCEPT AS NOTED.
 9. MANHOLE TOPS IN UNIMPROVED RIGHTS-OF-WAY TO BE SIX INCHES ABOVE FINISHED GRADE.
 10. USE EXTRA STRENGTH PIPE, ALL PIPE IS STANDARD DEPTH EXCEPT AS NOTED.
 11. USE MECHANICAL COMPRESSION JOINTS FOR ALL V.C.P. JOINTS PER SPECS., SECS. 34, 48 & 49.
 12. IF A POWER POLE IS WITHIN THREE FEET OF THE SEWER, THE SEWER SHALL BE ENCASED PER S-23, TWO FEET ON EACH SIDE FROM THE POINT OF INTERFERENCE.
 13. IF DURING THE COURSE OF CONSTRUCTION IT IS DETERMINED THAT THERE IS LESS THAN FOUR FEET OF COVER OVER THE TOP OF A MAIN LINE OR HOUSE LATERAL V.C.P. SEWER WHICH IS NOT INDICATED ON THE PLANS, THE PIPE SHALL BE ENCASED PER S-23, UNLESS OTHERWISE APPROVED BY THE COUNTY ENGINEER.
 14. HOUSE LATERALS TO BE CONSTRUCTED WITH INVERTS AT PROPERTY LINE & FEET BELOW CURB GRADE EXCEPT AS NOTED.
 15. REINFORCE ALL TRENCHES WITHIN PAVED AREAS TO MEET L.A. COUNTY ROAD DEPT. OR CALIFORNIA STATE HIGHWAY REQUIREMENTS IN ACCORDANCE WITH PERMITS.
 16. FOR ALLOWABLE LEAKAGE TEST USE FORMULA NO. 2, SPECS., SEC. 54.
 17. ALL STATE AND LOCAL TRENCH SAFETY ORDERS WILL BE STRICTLY ENFORCED.

NOTE: ISSUE NO HOUSE CONNECTION PERMITS UNTIL AUTHORIZED IN WRITING BY SANITATION DISTRICT.

ISSUE NO HOUSE CONNECTION PERMITS UNTIL A SANITARY SEWER EASEMENT IS GRANTED TO THE COUNTY OF LOS ANGELES. SEE PAGE 3.

COLLECT CHARGES AS INDICATED
Ralph Johnson

INDUSTRIAL WASTE PERMITS
 Approved By *[Signature]*
 Date 7 APRIL 1967

PROFILE, ALIGNMENT AND GRADE OF **P.C. 7809**
39331 SANITARY SEWERS PAGE 1
 CONSTRUCTED IN

TOURNAMENT ROAD AND OTHER R/W'S
PRIVATE CONTRACT NO. 7809

W.S. 63 (2D)
 2 SHEETS, 3 PAGES

SCALE: HORIZ. 1" = 100' VERT. 1" = 4'

PREPARED IN THE OFFICES OF
QUINTON ENGINEERS, LTD.
 812 W. 8TH ST., LOS ANGELES, CALIF.
 BY *Martin T. Quinn*
 REG. C. E. NO. 13005

FOR LEGEND SEE PLAN NO. S-1

NOTE:
 GRADES TO WHICH THIS IMPROVEMENT IS TO BE CONSTRUCTED ARE SHOWN ON PLANS AND PROFILES. GRADE POINTS FOR TOP OF CURBS, CENTER LINE OF STREETS, OR CENTER LINE OF ALLEYS ARE SHOWN BY CIRCLES ON PROFILES. AT ALL POINTS BETWEEN INDICATED POINTS THE GRADE SHALL BE ESTABLISHED SO AS TO CONFORM TO A STRAIGHT LINE DRAWN BETWEEN SAID DESIGNATED POINTS. THE DRAWINGS AND THE DATA HEREON ARE HEREBY MADE A PART OF THE SPECIFICATIONS. THESE DRAWINGS AND THE DATA HEREON ARE HEREBY MADE A PART OF THE SPECIFICATIONS. THE WORK SHALL BE CONSTRUCTED ACCORDING TO THE SPECIFICATIONS OF THE COUNTY ENGINEER. THE COUNTY ENGINEER'S OFFICE OF THE COUNTY ENGINEER AND SHALL BE PROSECUTED ONLY IN THE PRESENCE OF THE COUNTY ENGINEER. BEFORE WORK CAN BE STARTED, THE CONTRACTOR SHALL OBTAIN A PERMIT TO EXCAVATE IN COUNTY STREETS FROM THE L.A. COUNTY ROAD DEPT., DISTRICT OFFICE 409, 410 & 411, 1100 WEST SECOND STREET, LOS ANGELES, CALIF. AND PAY A FEE TO THE COUNTY ENGINEER, ROOM 301, COUNTY ENGINEER'S BUILDING, 90005. DISTRICT OFFICE 409, 410 & 411, 1100 WEST SECOND STREET, LOS ANGELES, CALIF. APPROVAL OF THIS PLAN BY THE COUNTY OF LOS ANGELES DOES NOT CONSTITUTE A GUARANTEE AS TO THE ACCURACY OF THE LOCATION OR OF THE EXISTENCE OR NON-EXISTENCE OF ANY UNDERGROUND UTILITY PIPE, OR STRUCTURE WITHIN THE LIMITS OF THE PROJECT. THIS NOTE APPLIES TO ALL PAGES.
 IF WORK IS TO BE DONE IN A STATE HIGHWAY, A PERMIT MUST BE OBTAINED FROM THE STATE OF CALIFORNIA, DIVISION OF HIGHWAY, 180 SOUTH SPRING STREET, LOS ANGELES, CALIFORNIA.

COUNTY OF LOS ANGELES, CALIFORNIA
 JOHN A. LAMBIE, COUNTY ENGINEER J. D. PARKHURST, CHIEF ENGINEER
 CO. SAN. DIST. NO. 8.2
 APPROVED BY *Richard M. Cron* ASSISTANT SANITATION ENGINEER APPROVED BY *[Signature]* OFFICE ENGINEER

SUBMITTED BY *[Signature]* SPECIAL ENGINEER
 CHECKED BY *Ralph Johnson* 4/6/67
 REG. C. E. NO. 13466

J.N. 036825

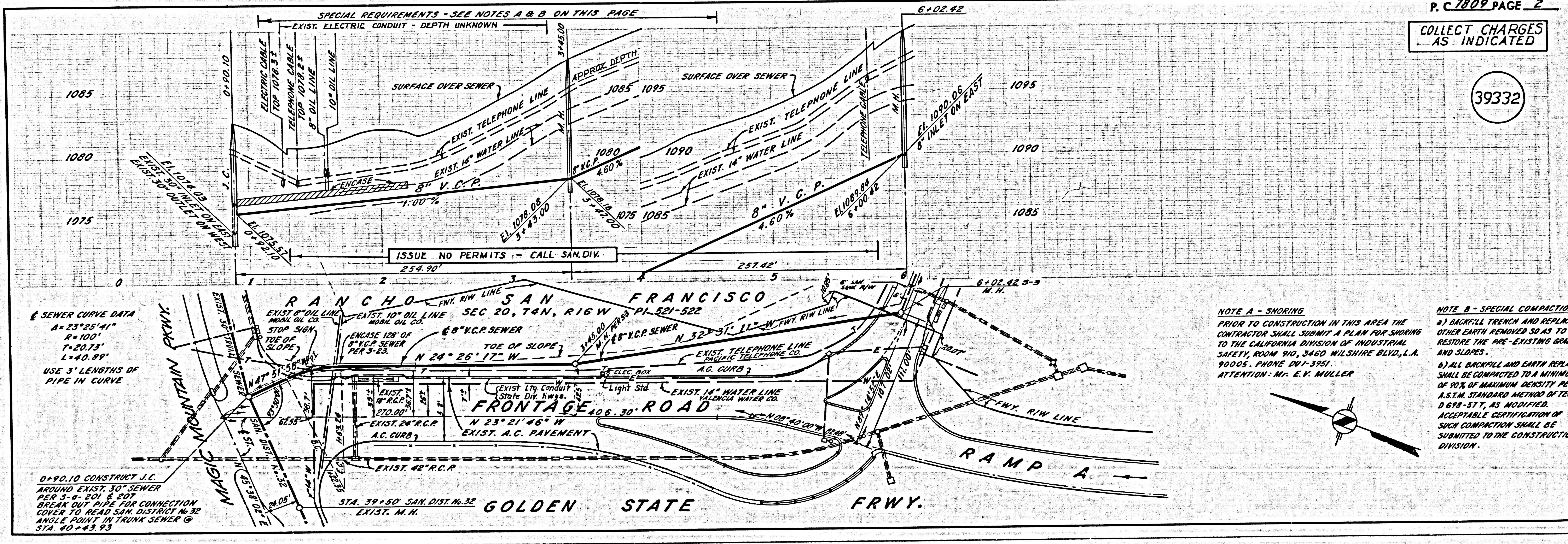

P. C. 7809 PAGE 2
COLLECT CHARGES AS INDICATED

39332

SEWER CURVE DATA
 Δ = 23°28'41"
 R = 100'
 L = 20.73'
 T = 40.89'
 USE 3' LENGTHS OF PIPE IN CURVE

0+90.10 CONSTRUCT J.C. AROUND EXIST. 30" SEWER PER S-9, 201 & 201 ENCASE OUT PIPE FOR CONNECTION OVER TO ROAD SAN. DISTRICT NO. 32 ANGLE POINT IN TRUNK SEWER @ STA. 40+23.93

NOTE A - SHORING PRIOR TO CONSTRUCTION IN THIS AREA THE CONTRACTOR SHALL SUBMIT A PLAN FOR SHORING TO THE CALIFORNIA DIVISION OF INDUSTRIAL SAFETY, ROOM 210, 3460 WILSHIRE BLVD., L.A. 90005. PHONE DU-1-3951. ATTENTION: Mr. E.V. MULLER

NOTE B - SPECIAL COMPACTION
 a) BACKFILL TRENCH AND REPLACE OTHER EARTH REMOVED SO AS TO RESTORE THE PRE-EXISTING GRADES AND SLOPES.
 b) ALL BACKFILL AND EARTH REPLACED SHALL BE COMPACTED TO A MINIMUM OF 90% OF MAXIMUM DENSITY PER A.S.T.M. STANDARD METHOD OF TEST D 698-57 T, AS ADVISED. ACCEPTABLE CERTIFICATION OF SUCH COMPACTION SHALL BE SUBMITTED TO THE CONSTRUCTION DIVISION.

COLLECT CHARGES AS INDICATED

39333

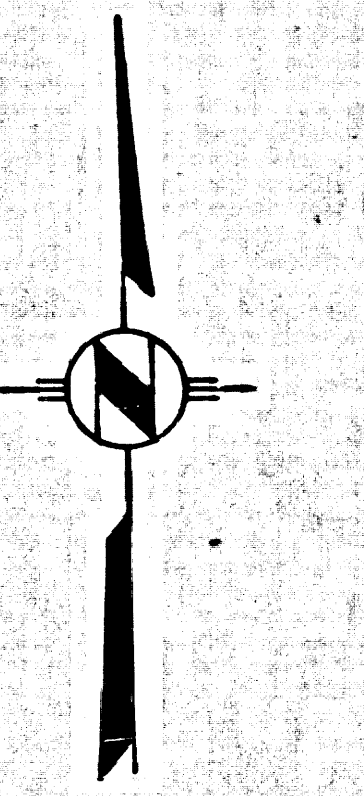
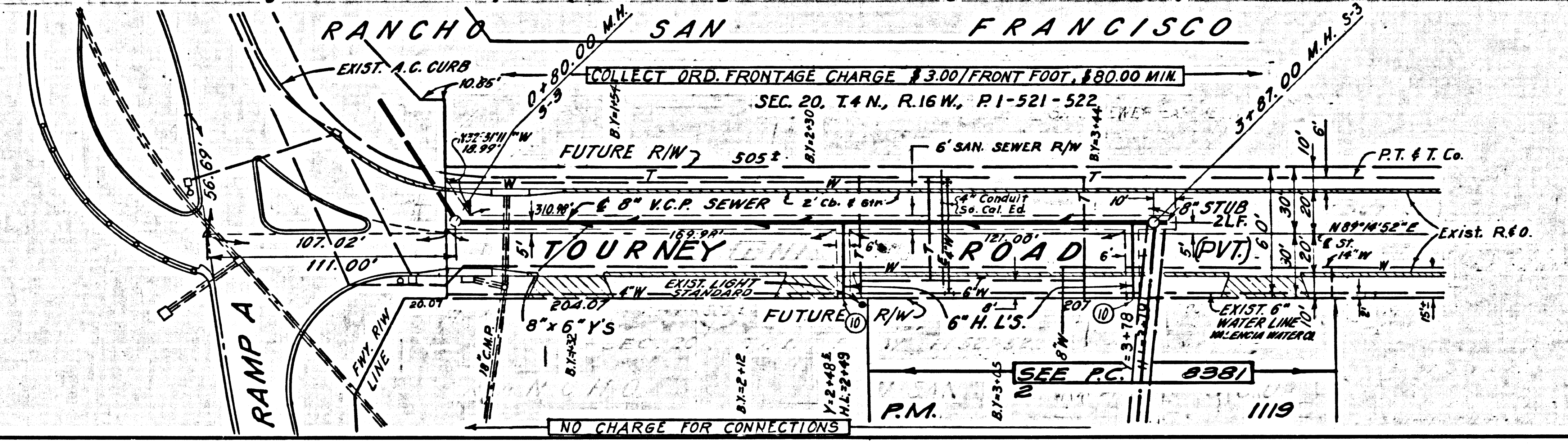
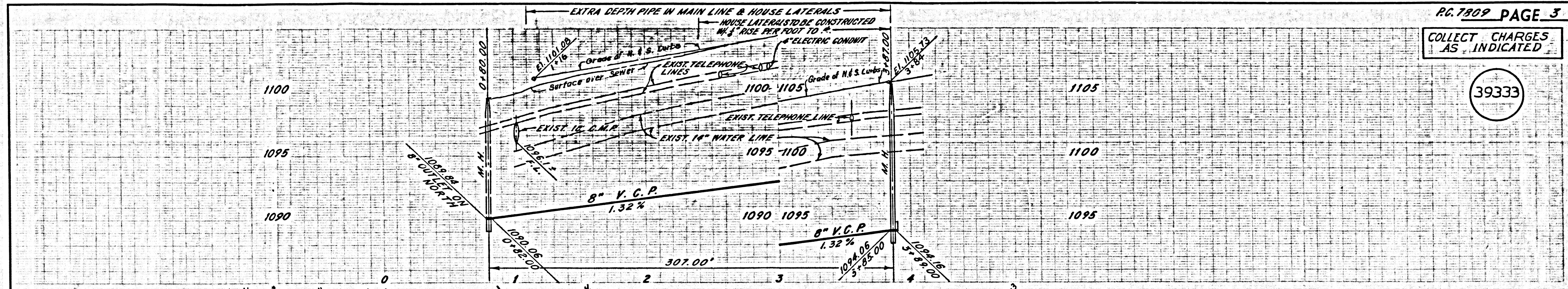

PG 7809