

B.M. BY 6210 ELEV. 161.283
 L.A. N. C.B. & B.C.R. SERVICE
 ISLAND, 36 FT. N. 135 FT. W. E.
 INT. CANDACE AVE. & WASHINGTON
 BLVD.
 RIVERA QUAD. 19 65

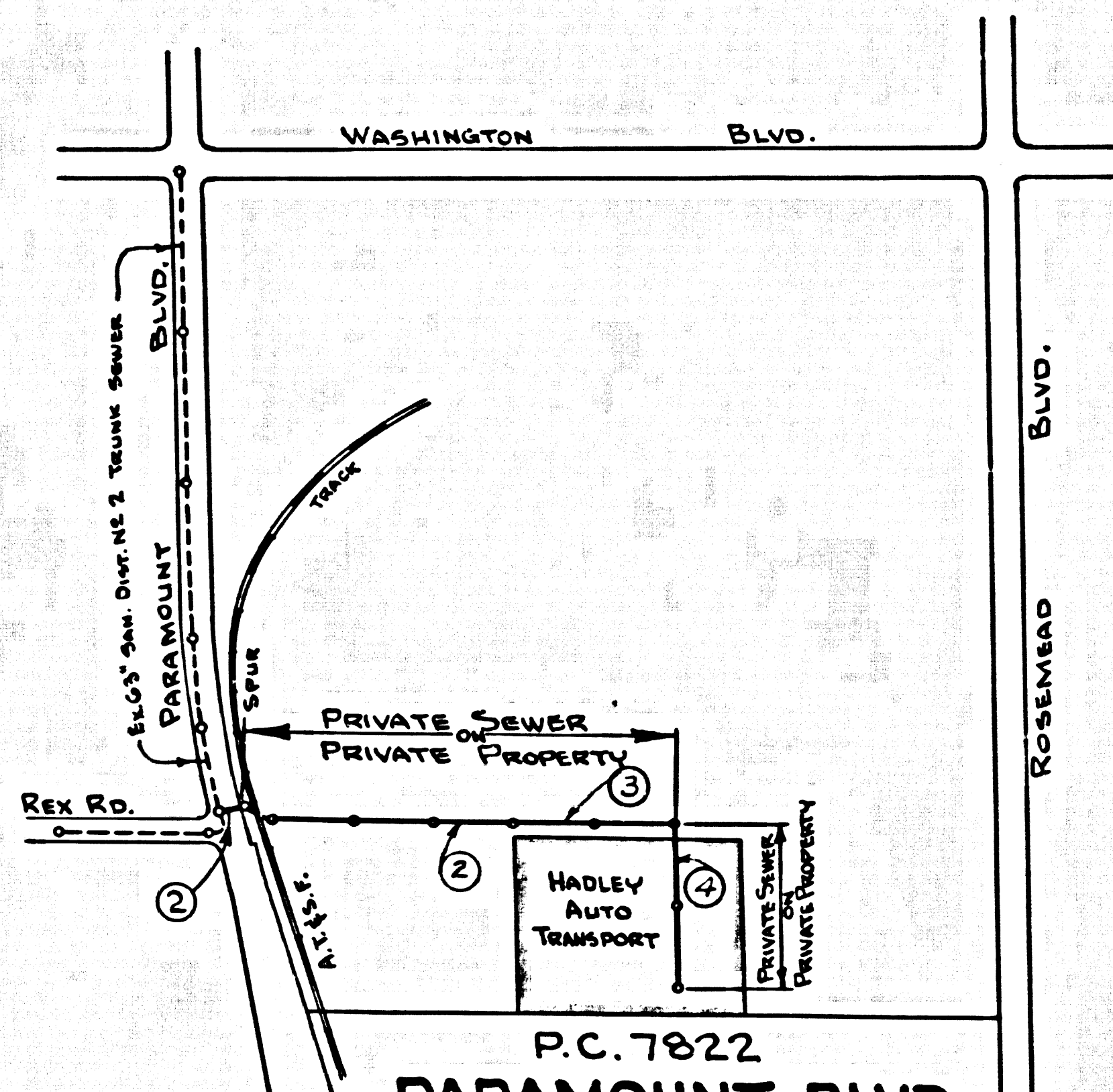

P.C. 7822
PARAMOUNT BLVD.
 INDEX MAP
 SCALE: 1" = 600'

NOTE:
 THIS IS A PRIVATE SEWER
 NO MORE THAN ONE PROPERTY MAY CONNECT

NOTE:
 THIS SEWER, FROM STATION 0+00 PAGE 2, SHEET 1, TO STATION 14+46.46 PAGE 3, SHEET 2 HAS BEEN CONSTRUCTED TO MAIN LINE STANDARDS AND IF PROPERLY MAINTAINED WILL BE ACCEPTABLE FOR DEDICATION TO THE CITY AS A PUBLIC SEWER. THE SECTION FROM STATION 14+46.46 TO STATION 22+27.00 ALL ON PAGE 4, SHEET 2 WILL NOT BE ACCEPTABLE FOR DEDICATION AND IS CONSIDERED A HOUSE LATERAL.

CITY OF PICO RIVERA
 DIRECTOR OF ENGINEERING SERVICES

NO CONNECTIONS FOR THE DISPOSAL OF INDUSTRIAL WASTES SHALL BE MADE TO SEWERS SHOWN ON THESE DRAWINGS WITHOUT WRITTEN PERMISSION FROM THE CHIEF ENGINEER AND GENERAL MANAGER OF THE COUNTY SANITATION DISTRICTS.

PICO RIVERA BLDG. DIST. NO. 11.01

- NOTES:**
- PROVIDE STAKES ON THE PROPERTY LINE OR PROPERTY LINES PRODUCED AT RIGHT ANGLES TO THE SEWER LINE AT THE CENTER LINE OF EACH MANHOLE.
 - NO REPRESENTATIVE OF THE CITY ENGINEER WILL SURVEY OR LAY OUT ANY PORTION OF THE WORK.
 - THE PRIVATE ENGINEER SHALL FURNISH THE CITY ENGINEER WITH GRADE SHEETS AND STATIONING FOR ALL HOUSE LATERALS AND "Y" BRANCHES AND SHALL PROVIDE STAKES FOR THEM AT THEIR PROPER LOCATIONS WITH STATIONING PLAINLY MARKED. ALL HOUSE LATERALS SHALL BE CONSTRUCTED IN A STRAIGHT ALIGNMENT AT RIGHT ANGLES FROM THE MAIN LINE SEWER EXCEPT AS SHOWN ON THE PLANS. HOUSE LATERALS FROM CHIMNEYS SHALL NOT HAVE AN ANGLE OF LESS THAN 45° WITH THE MAIN LINE SEWER. ANY CHANGE IN ALIGNMENT SHALL BE REQUESTED IN WRITING BY THE PRIVATE ENGINEER.
 - THE PRIVATE ENGINEER SHALL FURNISH THE HOUSE LATERAL DEPTH AT THE PROPERTY LINE BELOW THE TOP OF CURB ELEVATION FOR EACH HOUSE LATERAL ON THE GRADE SHEET.
 - NO REVISIONS SHALL BE MADE IN THESE PLANS WITHOUT THE APPROVAL OF THE CITY ENGINEER.
 - THE CONTRACTOR SHALL NOTIFY THE CONSTRUCTION DIVISION BY TELEPHONE, MADISON 9-87, EXT. 8158, AT LEAST TWENTY-FOUR HOURS BEFORE STARTING ANY WORK UNDER THIS CONTRACT.
 - MANHOLES SHALL BE BRICK SEWER STRUCTURES PER S-3, EXCEPT AS NOTED.
 - USE STANDARD MANHOLE FRAMES AND COVERS, S-15, EXCEPT AS NOTED.
 - MANHOLE TOPS IN UNIMPROVED RIGHTS-OF-WAY TO BE SIX INCHES ABOVE FINISHED GRADE. EXCEPT AS NOTED.
 - USE EXTRA STRENGTH PIPE. ALL PIPE IS STANDARD DEPTH EXCEPT AS NOTED.
 - USE MECHANICAL COMPRESSION JOINTS FOR ALL V.C.P. JOINTS PER SPECS., SECS. 34, 48 & 49.
 - IF A POWER POLE IS WITHIN THREE FEET OF THE SEWER, THE SEWER SHALL BE ENCASED, PER S-23, TWO FEET ON EACH SIDE FROM THE POINT OF INTERFERENCE.
 - IF DURING THE COURSE OF CONSTRUCTION IT IS DETERMINED THAT THERE IS LESS THAN FOUR FEET OF COVER OVER THE TOP OF A MAIN LINE OR HOUSE LATERAL V.C.P. SEWER WHICH IS NOT INDICATED ON THE PLANS, THE PIPE SHALL BE ENCASED PER S-23, UNLESS OTHERWISE APPROVED BY THE CITY ENGINEER.
 - ALL C.T.P. SHALL BE CLASS 150 OR BETTER.
 - RESURFACE ALL TRENCHES WITHIN PAVED AREAS TO MEET L.A. COUNTY ROAD DEPT. OR CALIFORNIA STATE HIGHWAY REQUIREMENTS IN ACCORDANCE WITH PERMITS.
 - FOR ALLOWABLE LEAKAGE TEST USE FORMULA NO. 8, SPEC. 8, SEC. 54.
 - ALL STATE AND LOCAL TRENCH SAFETY ORDERS WILL BE STRICTLY ENFORCED.
 - BEFORE ANY WORK IS STARTED IN PARAMOUNT BLVD. THE CONTRACTOR SHALL MAKE ARRANGEMENTS WITH THE CITY OF PICO RIVERA FOR TRAFFIC CONTROL AND SHALL POST BOUND WITH THE CITY, SUFFICIENT TO COVER THE COST OF SAID CONTROL.
 - ALL JOINTS BETWEEN CAST IRON PIPE AND STEEL OR STEEL PIPE SHALL BE MADE WITH RUBBER GASKET JOINTS (WITH WOOD IF NECESSARY) PER STANDARD SPECIFICATIONS, SECTION 34, OR APPROVED EQUIVALENT.
 - ALL C.T.P. JOINTS SHALL BE "TYTON" OR APPROVED EQUAL PER STANDARD SPECIFICATIONS, SECTIONS 34, 48 & 49.

COLLECT CHARGES AS INDICATED
 1/2/62

REVIEWED BY: *R.M. Moore*
 INDUSTRIAL WASTE DIVISION

PROFILE, ALIGNMENT AND GRADE OF **P.C. 7822**
SANITARY SEWERS PAGE 1

PARAMOUNT BLVD.
 IN THE CITY OF PICO RIVERA

PRIVATE CONTRACT NO. 7822

W.S. 36
 2 SHEETS, 4 PAGES
 SCALE: VERT. 1" = 4' HORIZ. 1" = 40'
 FEBRUARY, 1962

PREPARED IN THE OFFICES OF
 McDANIEL & ASSOCIATES
 550 N. ANAHEIM BLVD.
 ANAHEIM, CALIFORNIA
 BY: *Richard M. Con* 2/28/62
 REG. C.E. NO. 2208

FOR LEGEND SEE PLAN NO. S-1

NOTE:
 GRADES TO WHICH THE IMPROVEMENT IS TO BE CONSTRUCTED ARE SHOWN ON PLANS AND PROFILES. GRADE POINTS FOR TOP OF CURBS, CENTER LINE OF STREETS, OR CENTER LINE OF ALLEYS ARE SHOWN BY CIRCLES ON PROFILES. AT ALL POINTS BETWEEN DESIGNATED POINTS THE GRADE SHALL BE ESTABLISHED SO AS TO CONFORM TO A STRAIGHT LINE DRAWN BETWEEN SAID DESIGNATED POINTS. ELEVATIONS ARE PER ABOVE U.S.C. & G.S. SEA LEVEL DATUM OF 1929.
 THIS DRAWING AND THE DATA HEREON ARE HEREBY MADE A PART OF THE SPECIFICATIONS (AS AMENDED) WHICH SHALL BE CONSIDERED TO GOVERN IN THE EVENT OF A DISCREPANCY BETWEEN THE DRAWING AND THE SPECIFICATIONS. NO WORK SHALL BE CONSTRUCTED UNLESS THE CONTRACTOR HAS OBTAINED A PERMIT TO EXCAVATE IN COUNTY STREETS FROM THE L.A. COUNTY ROAD DEPT. (SECTION 104) AND MAKE A DEPOSIT WITH THE CITY OF PICO RIVERA TO COVER THE COST OF CONSTRUCTION INSPECTION AND RECORD PLANS.
 APPROVAL OF THIS PLAN BY THE CITY OF PICO RIVERA DOES NOT CONSTITUTE A REPRESENTATION AS TO THE ACCURACY OF THE LOCATION OF OR THE EXISTENCE OR NON-EXISTENCE OF ANY UNDERGROUND UTILITY PIPE, OR STRUCTURE WITHIN THE LIMITS OF THIS PROJECT. THE NOTE APPLIES TO ALL PAGES.
 IF WORK IS TO BE DONE IN A STATE HIGHWAY, A PERMIT MUST BE OBTAINED FROM THE STATE OF CALIFORNIA, DIVISION OF HIGHWAYS, 126 SOUTH SPRING STREET, LOS ANGELES, CALIFORNIA.

CITY OF PICO RIVERA, CALIFORNIA
 JOHN A. LAMBIE, CITY ENGINEER J. D. PARKHURST, CHIEF ENGINEER
 CO. SAN. DIST. NO. 2
 APPROVED BY: *Richard M. Con* ASSISTANT SANITATION ENGINEER APPROVED BY: *J. D. Parkhurst* CHIEF ENGINEER

SUBMITTED BY: *Richard M. Con* ASSISTANT SANITATION ENGINEER
 CHECKED BY: *David E. McCall* REGIONAL ENGINEER
 REG. C.E. NO. 15731
 REVISION: RELOCATED SEWER LINE ALONGSIDE SECURITY FENCE FROM 2.5' SOUTHWESTLY TO 5.0' SOUTHWESTLY OF FENCE. A(1) (GT. 2.5' SOUTHWESTLY OF FENCE) 2/28/62
 APPROVED BY: *David E. McCall* SANITATION DIVISION
 CITY OF PICO RIVERA
 APPROVED BY: *Richard M. Con* DIRECTOR OF ENGINEERING SERVICES

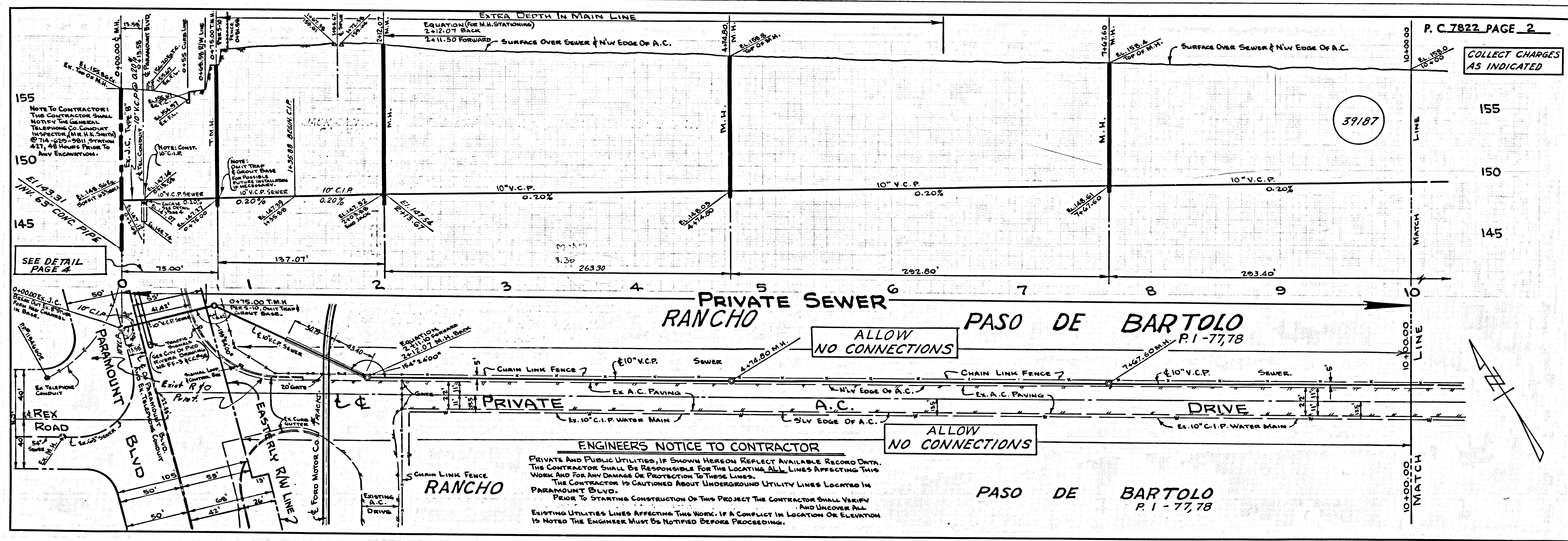

155
 NOTE TO CONTRACTOR:
 THE CONTRACTOR SHALL NOTIFY THE GENERAL TELEPHONE CO. CONDUCTOR INSPECTOR (M.R. H.S. SMITH) @ 714-622-1001, SECTION 421, 48 HOURS PRIOR TO ANY EXCAVATIONS.

150
 SEE DETAIL PAGE 4

145
 10" V.C.P. SEWER
 0.20%
 137.07'

EXTRA DEPTH IN MAIN LINE
 EQUATION (FOR M.H. STATIONING)
 2+12.01' BACK
 12+11.50 FORWARD SURFACE OVER SEWER & N.W. EDGE OF A.C.

PRIVATE SEWER
RANCHO PASO DE BARTOLO
 ALLOW NO CONNECTIONS

ENGINEERS NOTICE TO CONTRACTOR
 PRIVATE AND PUBLIC UTILITIES, IF SHOWN HEREON REFLECT AVAILABLE RECORD DATA. THE CONTRACTOR SHALL BE RESPONSIBLE FOR THE LOCATING ALL LINES AFFECTING THIS WORK AND FOR ANY DAMAGE OR PROTECTION TO THESE LINES. THE CONTRACTOR IS CAUTIONED ABOUT UNDERGROUND UTILITY LINES LOCATED IN PARAMOUNT BLVD. PRIOR TO STARTING CONSTRUCTION OF THIS PROJECT THE CONTRACTOR SHALL VERIFY AND UNDERSTAND ALL EXISTING UTILITIES LINES AFFECTING THIS WORK. IF A CONFLICT IN LOCATION OR ELEVATION IS NOTED THE ENGINEER MUST BE NOTIFIED BEFORE PROCEEDINGS.

ALLOW NO CONNECTIONS
PRIVATE
RANCHO PASO DE BARTOLO
 P. 1 - 77,78

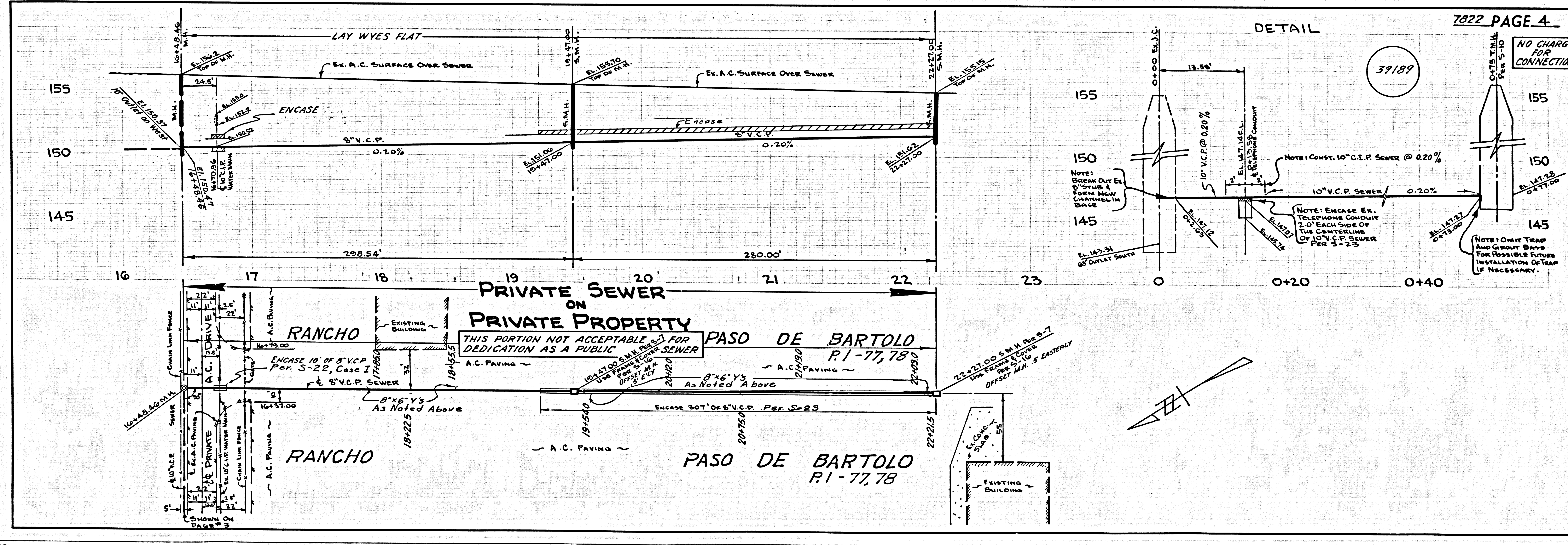
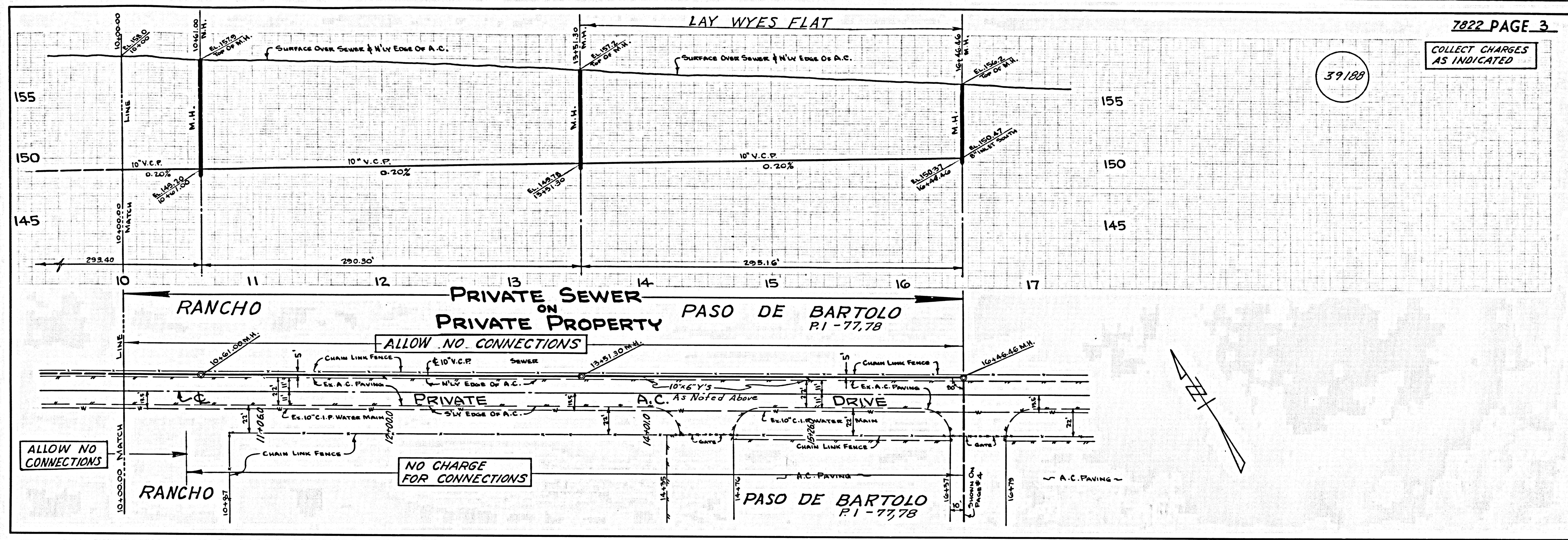

PLAN 2 ENCL