

PROFILE SCALE

HORIZ. 1" = 40'
VERT. 1" = 4'

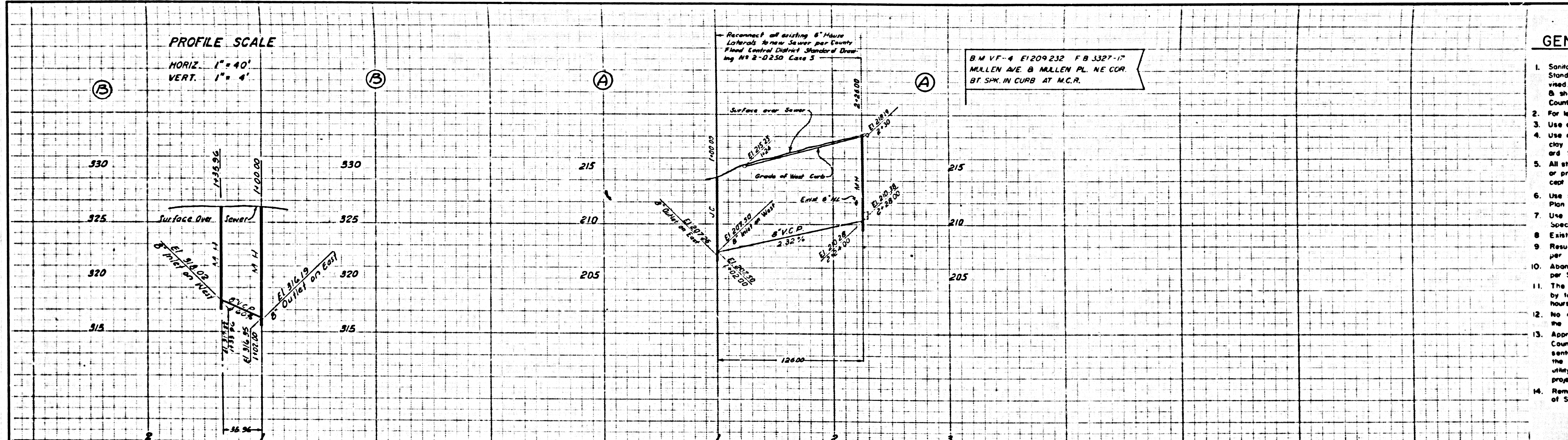

GENERAL SEWER NOTES

1. Sanitary sewers shall be constructed according to Standard Specifications dated May 25, 1962, as revised, on file in the Office of the County Engineer & shall be prosecuted only in the presence of the County Engineer.
2. For legend see Standard Plan S-1.
3. Use extra strength vitrified clay pipe.
4. Use mechanical compression joints for all vitrified clay pipe sewers per Sections 36, 48, & 49 of Standard Sewer Specifications.
5. All structures shall be either brick manholes per S-3 or precast concrete manholes per S-5 or S-6, except as noted.
6. Use standard manhole frames & covers per Standard Plan S-15.
7. Use formula No. 2, Section 54 of Standard Sewer Specifications, to compute allowable leakage.
8. Existing service to be maintained at all times.
9. Resurface trenches within paved area of streets per Section 69 of Standard Sewer Specifications.
10. Abandoned portions of house laterals shall be sealed per Section 60 of Standard Sewer Specifications.
11. The Contractor shall notify the Construction Division by telephone, 629-4747, Ext B1551, at least 24 hours before starting any work under this project.
12. No revisions shall be made in these plans without the approval of the County Engineer.
13. Approval of the sewer plans for this project by the County of Los Angeles does not constitute a representation as to the accuracy of the location of, or the existence or non-existence of any underground utility pipe or structure within the limits of the project.
14. Remove & replace existing sidewalk per Section 67 of Standard Sewer Specifications.

P.C. 7654 (20 B&V 1558)

40606

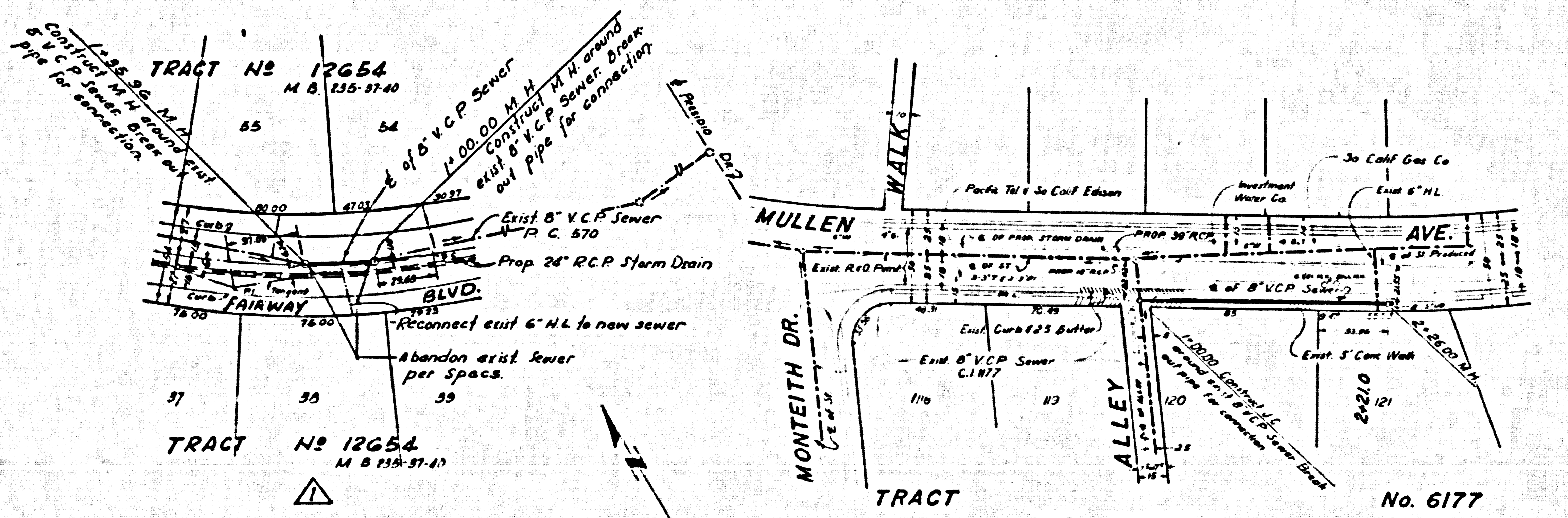

NO CHARGE FOR CONNECTIONS

REVISIONS			
T.M.	MARK	DATE	DESCRIPTION
K.N.W.	Δ	8/28/68	Done per S.C. B-P
T.H.			
H.J.G.			

NO CONNECTIONS FOR THE DISPOSAL OF INDUSTRIAL WASTES SHALL BE MADE TO SEWERS, UNLESS THE DESIGNER OF THE SEWER SYSTEM HAS BEEN ADVISED BY THE CHIEF ENGINEER AND GENERAL MANAGER OF THE COUNTY SANITATION DISTRICTS.

APPROVED BY
JOHN D. PARKHURST
CHIEF ENGINEER
COUNTY SAN. DIST. No. 5

PREPARED BY
JOHN A. LAMBIE
COUNTY ENGINEER

P.C. No 7654
RECOMMENDED BY
Richard W. Carr
ASSISTANT SANITATION DISTRICT ENGINEER

1964 STORM DRAIN BOND ISSUE
LOS ANGELES COUNTY
FLOOD CONTROL DISTRICT

STA. TO STA.
PLAN AND PROFILE

SCALE: 1" = 40'
DATE: 8-28-68
DWG. NO. 7654
SHEET 1 OF 1