

PROFILE SCALE
 HORZ: 1" = 40'
 VERT: 1" = 5'

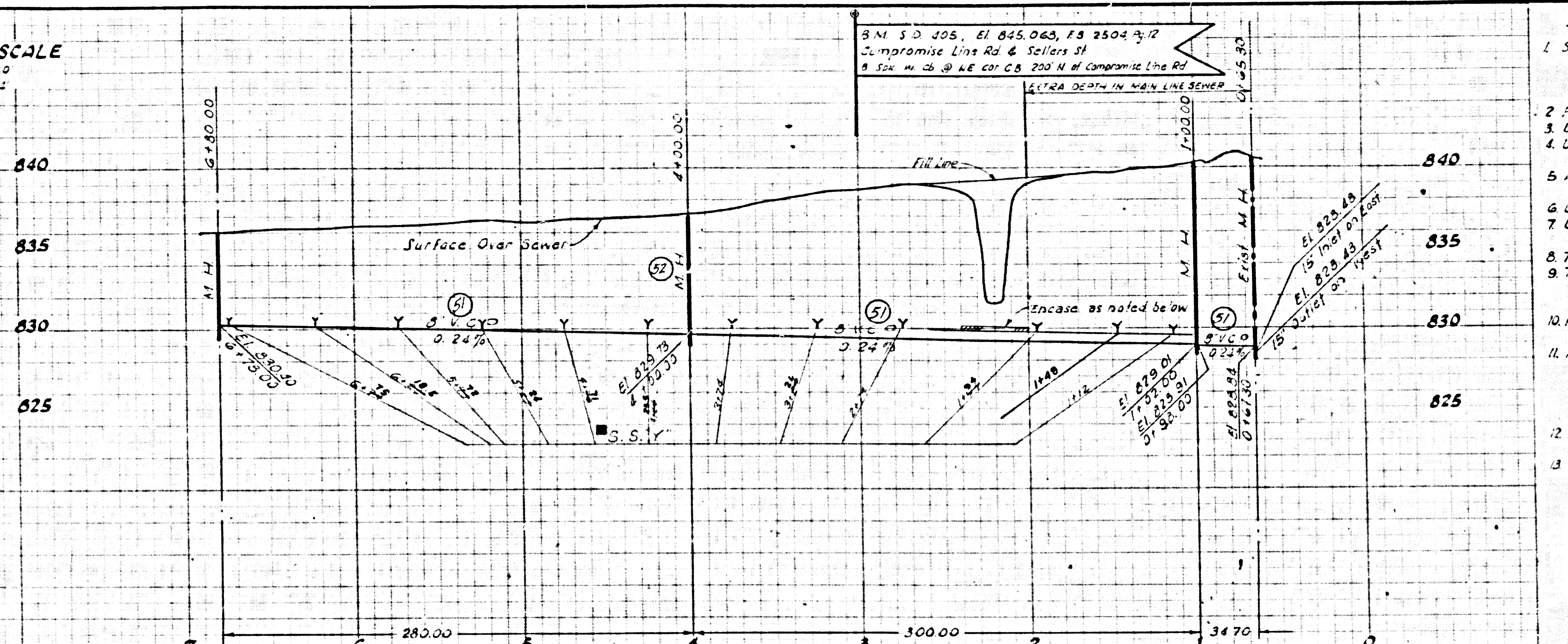

- GENERAL SEWER NOTES**
- Sanitary sewers shall be constructed according to Standard Specifications dated May 25, 1962, as revised, on file in the Office of the County Engineer & shall be prosecuted only in the presence of the County Engineer.
 - For legend see Standard Plan S-1.
 - Use extra strength vitrified clay pipe.
 - Use mechanical compression joints for all vitrified clay pipe sewers per Sections 36, 48, & 49 of Standard Sewer Specifications.
 - All structures shall be either brick manholes per S-3 or precast concrete manholes per S-5 or S-6.
 - Use standard manhole frames & covers per S-13.
 - Use formula No. 2, Section 54 of Standard Sewer Specifications, to compute allowable leakage.
 - The Contractor shall maintain service at all times.
 - The Contractor shall notify the Construction Division by Tel. 629-4747, Ext. 81551, at least 24 hrs before starting any work under this project.
 - No revision shall be made in these plans without the approval of the County Engineer.
 - Approval of the sewer plans for this project by the County of Los Angeles does not constitute a representation as to the accuracy of the location of, or the existence or non-existence of any underground utility pipe or structure within the limits of this project.
 - Returface trenches within paved area of streets per Road Department Specifications.
 - Use mechanical compression joints for all cast iron pipe sewers.

39394

NO CONNECTIONS FOR THE DISPOSAL OF INDUSTRIAL WASTES SHALL BE MADE TO SEWERS SHOWN ON THESE DRAWINGS WITHOUT WRITTEN PERMISSION FROM THE CHIEF ENGINEER AND GENERAL MANAGER OF THE COUNTY SANITATION DISTRICTS.

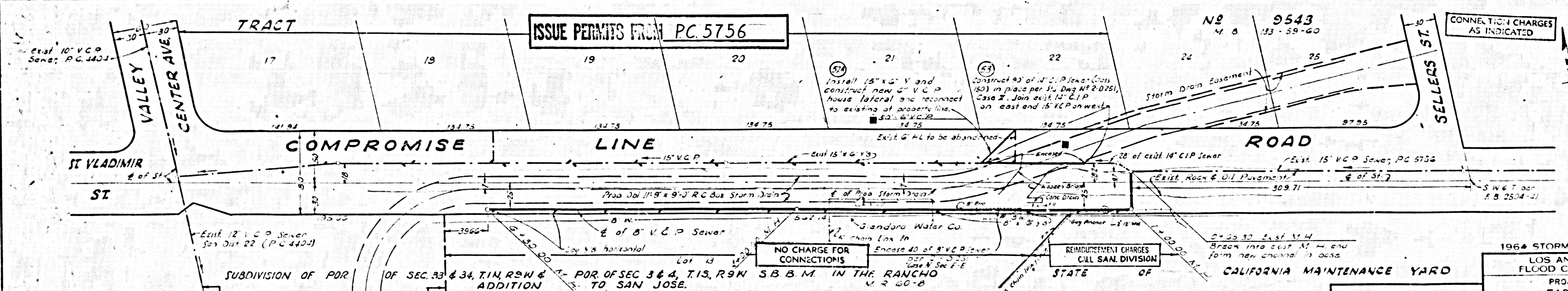

ISSUE PERMITS FROM PC. 5756

NO. 9543
 M. B. 133-59-60

CONNECTION CHARGES AS INDICATED

NO CHARGE FOR CONNECTIONS

REIMBURSEMENT CHARGES CALL SAN. DIVISION

ISSUE PERMITS FROM PC. 5756

- BY-6+15.0
- BY-6+18.5
- BY-5+72.0
- BY-5+24.0
- BY-4+71.0
- BY-4+23.5
- BY-3+74.0
- BY-3+21.0
- BY-2+74.0
- BY-1+94.0
- BY-1+48.0
- BY-1+12.0

REVISIONS		
MARK	DATE	DESCRIPTION
1	4-27-60	"As Built"

APPROVED
 JOHN O. PARAHURST
 CHIEF ENGINEER
 COUNTY SAN. DIST. NO. 22

PREPARED BY
 JOHN A. LAMBIE
 COUNTY ENGINEER
 P.C. 7871
 RECOMMENDED BY
 G. F. GILLESPIE
 ASSISTANT COUNTY ENGINEER
 COUNTY SAN. DIST. NO. 22

1964 STORM DRAIN BOND ISSUE
 LOS ANGELES COUNTY
 FLOOD CONTROL DISTRICT
 PROJECT NO. 518
 EAST BRANCH
 BIG DALTON WASH
 LINE A
 SANITARY SEWER CONSTRUCTION
 PLAN AND PROFILE

SCALE: 1" = 40'
 DATE: MAY '67
 DWG. NO. 275-518-0-21
 SHEET 21 OF 21