

Orange County Bench, 1929 Datum

B.M. LA-44-58 ELEV. 62.027

Centerline monument at intersection of Knott Ave and Artesia Ave 10' below surface in capped well. Orange Co. Surveyors Elev. QUAD. 1965

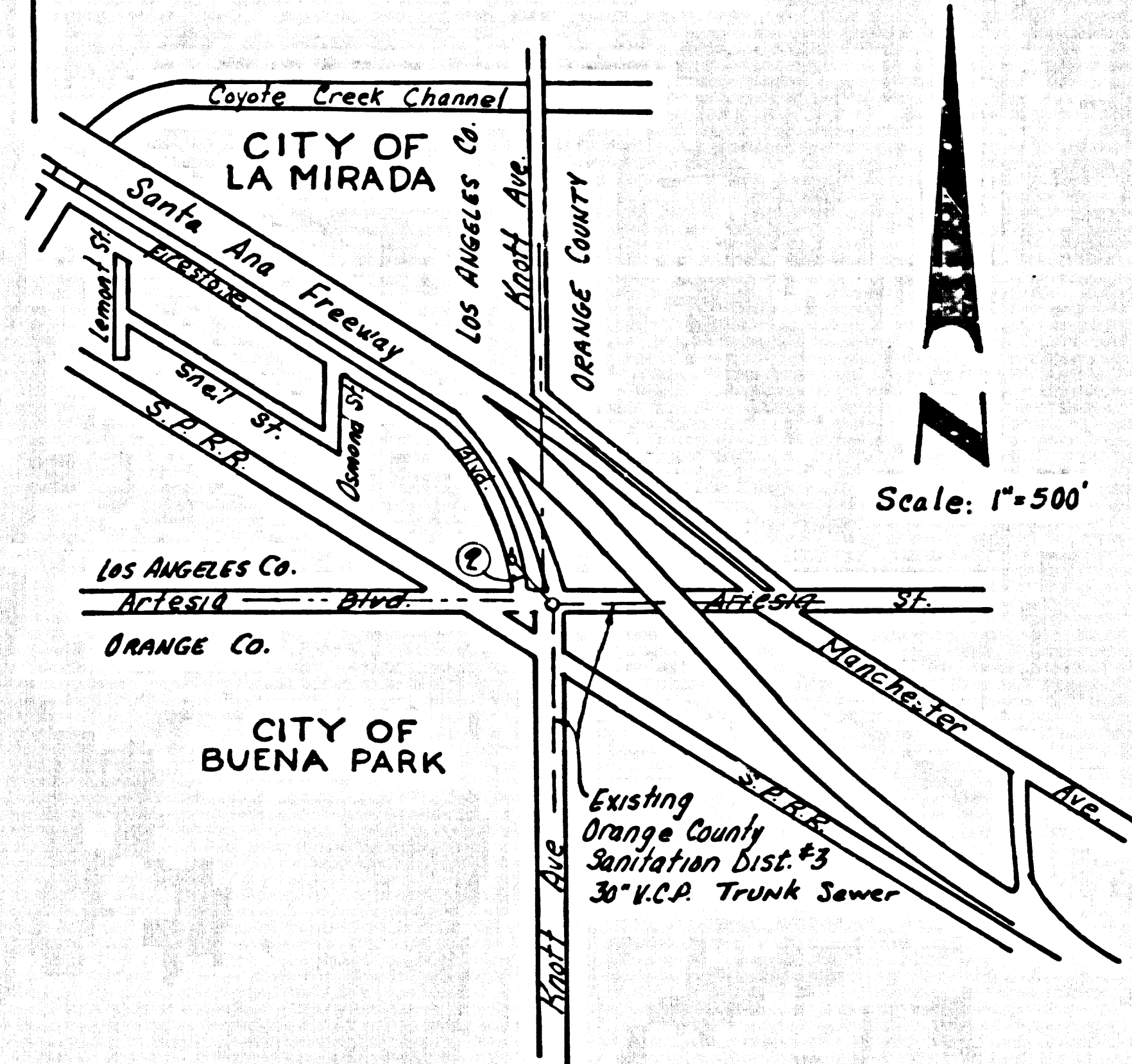

INDEX MAP

*Show City of Buena Park... 8/6/67*

### LA MIRADA BLDG. DIST. NO. 408

- NOTES:
1. PROPERTY STAKES ON THE PROPERTY LINE OR PROPERTY LINES PRODUCED AT RIGHT ANGLES TO THE SEWER LINE AT THE CENTER LINE OF EACH MANHOLE.
  2. NO REPRESENTATIVE OF THE CITY ENGINEER WILL SURVEY OR LAY OUT ANY PORTION OF THE WORK.
  3. THE PRIVATE ENGINEER SHALL FURNISH THE CITY ENGINEER WITH GRADE SHEETS AND STATIONING FOR ALL HOUSE LATERALS AND "Y" BRANCHES AND SHALL PROVIDE STAKES FOR THEM AT THEIR PROPER LOCATIONS WITH STATIONING PLAINLY MARKED. ALL HOUSE LATERALS SHALL BE CONSTRUCTED IN A STRAIGHT ALIGNMENT AT RIGHT ANGLES FROM THE MAIN LINE SEWER EXCEPT AS SHOWN ON THE PLANS. ANY CHANGE IN ALIGNMENT SHALL BE REQUESTED IN WRITING BY THE PRIVATE ENGINEER.
  4. THE PRIVATE ENGINEER SHALL FURNISH THE HOUSE LATERAL DEPTH AT THE PROPERTY LINE BELOW THE TOP OF CURB ELEVATION FOR EACH HOUSE LATERAL ON THE GRADE SHEET.
  5. NO REVISIONS SHALL BE MADE IN THESE PLANS WITHOUT THE APPROVAL OF THE CITY ENGINEER.
  6. THE CONTRACTOR SHALL NOTIFY THE CONSTRUCTION DIVISION BY TELEPHONE, MADISON 9-407, EXT. 81581, AT LEAST TWENTY-FOUR HOURS BEFORE STARTING ANY WORK UNDER THIS CONTRACT.
  7. ALL STRUCTURES SHALL BE EITHER DEWICK MANHOLES PER S-1 OR PRECAST MANHOLES PER S-6 OR S-8, EXCEPT AS NOTED.
  8. USE STANDARD MANHOLE FRAMES AND COVERS, S-1A.
  9. MANHOLE TOPS TO BE OF FINISHED GRADE.
  10. USE EXTRA STRENGTH PIPE.
  11. USE MECHANICAL COMPRESSION JOINTS FOR ALL V.C.P. JOINTS PER SPEC., SEC. 36, 48 & 49.
  12. IF A POWER POLE IS WITHIN THREE FEET OF THE SEWER, THE SEWER SHALL BE ENCASED, PER S-23, TWO FEET ON EACH SIDE FROM THE POINT OF INTERFERENCE.
  13. IF DURING THE COURSE OF CONSTRUCTION IT IS DETERMINED THAT THERE IS LESS THAN FOUR FEET OF COVER OVER THE TOP OF A MAIN LINE OR HOUSE LATERAL V.C.P. SEWER WHICH IS NOT INDICATED ON THE PLANS, THE PIPE SHALL BE ENCASED PER S-23, UNLESS OTHERWISE APPROVED BY THE CITY ENGINEER.
  14. HOUSE LATERALS TO BE CONSTRUCTED WITH INVERTS AT PROPERTY LINE 8 FEET BELOW SURFACE *EXCEPT SEWER*.
  15. RESURFACE ALL TRENCHES WITHIN PAVED AREAS TO MEET L.A. COUNTY ROAD DEPT. OR CALIFORNIA STATE HIGHWAY REQUIREMENTS IN ACCORDANCE WITH PERMITS.
  16. FOR ALLOWABLE LEAKAGE TEST USE FORMULA NO. 2, SPEC. S. 54.
  17. ALL STATE AND LOCAL TRENCH SAFETY ORDERS WILL BE STRICTLY ENFORCED.
  18. CONTRACTORS TO VERIFY THE EXISTING ELEVATIONS OF THE ORANGE CO. SANITARY DISTRICT MANHOLE PRIOR TO BEGINNING CONSTRUCTION. CONNECTION TO THE EXISTING MANHOLE SHALL BE IN ACCORDANCE WITH THE REQUIREMENTS OF S.C.S.D.'S. O.C.S.D. SHALL BE ADVISED BY TELEPHONE, 714-994-7110, AT LEAST 48 HOURS BEFORE STARTING ANY WORK ON THIS CONTRACT.

COLLECT CHARGES AS INDICATED  
 REVIEWED BY Alison Halley  
 Industrial Waste Division

### PROFILE, ALIGNMENT AND GRADE OF SANITARY SEWERS PAGE 1

TO BE CONSTRUCTED IN ARTESIA BLVD AND KNOTT AVE.

PRIVATE CONTRACT NO. 7881

W.S. 34  
 1 SHEET 2 PAGES  
 SCALE: VERT. 1"=4' HORIZ. 1"=40'  
 APRIL, 1967  
 PREPARED IN THE OFFICES OF  
 C.E.S. CIVIL ENGINEERS  
 4033 W. CHAPMAN AVE. ORANGE, CALIF.  
 BY Donald S. Mueck  
 REG. C. E. NO. 11271

FOR LEGEND SEE PLAN NO. S-1

NOTES:  
 GRADES TO WHICH THIS IMPROVEMENT IS TO BE CONSTRUCTED ARE SHOWN ON PLANS AND PROFILE. GRADE POINTS FOR TOP OF CURB, CENTER LINE OF STREETS, OR CENTER LINE OF ALLEYS ARE SHOWN BY CIRCLES ON PROFILES. AT ALL POINTS BETWEEN DESIGNATED POINTS THE GRADE SHALL BE ESTABLISHED SO AS TO CONFORM TO A STRAIGHT LINE DRAWN BETWEEN SAID DESIGNATED POINTS. ELEVATIONS ARE IN FEET ABOVE U.S.C. & G.S. MEAN LEVEL DATUM OF 1929. THIS SEWERING AND THE DATA HEREON ARE HEREBY MADE A PART OF THE SPECIFICATIONS. AS AMENDED WORK SHALL BE CONSTRUCTED ACCORDING TO STANDARD SPECIFICATIONS DATED MAY 13, 1953, ON FILE IN THE OFFICE OF THE CITY ENGINEER AND SHALL BE PROSECUTED ONLY IN THE PRESENCE OF THE CITY ENGINEER. BEFORE WORK CAN BE STARTED, THE CONTRACTOR MUST OBTAIN A PERMIT TO EXCAVATE IN CITY STREETS FROM THE L.A. COUNTY ROAD DEPT., DISTRICT OFFICE NO. 1, 11111 AND PAY A FEE TO THE CITY OF LA MIRADA, 1000 LA MIRADA BLVD. SUFFICIENT TO COVER THE COST OF CONSTRUCTION SUPERVISION AND RECORD PLANS. APPROVAL OF THIS PLAN BY THE CITY OF LA MIRADA DOES NOT CONSTITUTE A REPRESENTATION AS TO THE ACCURACY OF THE LOCATION OR THE EXISTENCE OR NON-EXISTENCE OF ANY UNDERGROUND UTILITY PIPE, OR STRUCTURE WITHIN THE LIMITS OF THE PROJECT. THIS NOTE APPLIES TO ALL PAGES. IF WORK IS TO BE DONE IN A STATE HIGHWAY, A PERMIT MUST BE OBTAINED FROM THE STATE OF CALIFORNIA, DIVISION OF HIGHWAYS, 126 SOUTH SPRING STREET, LOS ANGELES, CALIFORNIA.

CITY OF LA MIRADA, CALIFORNIA  
 JOHN A. LAMBIE, CITY ENGINEER  
 J. D. PARKHURST, CHIEF ENGINEER  
 CO. SAN. DIST. NO. 408  
 APPROVED BY Richard M. Cron ASSISTANT SANITATION ENGINEER  
 APPROVED BY J. D. Parkhurst OFFICE ENGINEER  
 SUBMITTED BY Sherwood K. Baker REGIONAL ENGINEER  
 CHECKED BY Donald S. Mueck C.E. NO. 15231  
 APPROVED BY Alison Halley 7-11-67  
 AUTHORITY: ADMINISTRATOR, CITY OF LA MIRADA

P. C. 7881 PAGE 2

NO CHARGE FOR CONNECTIONS

40101

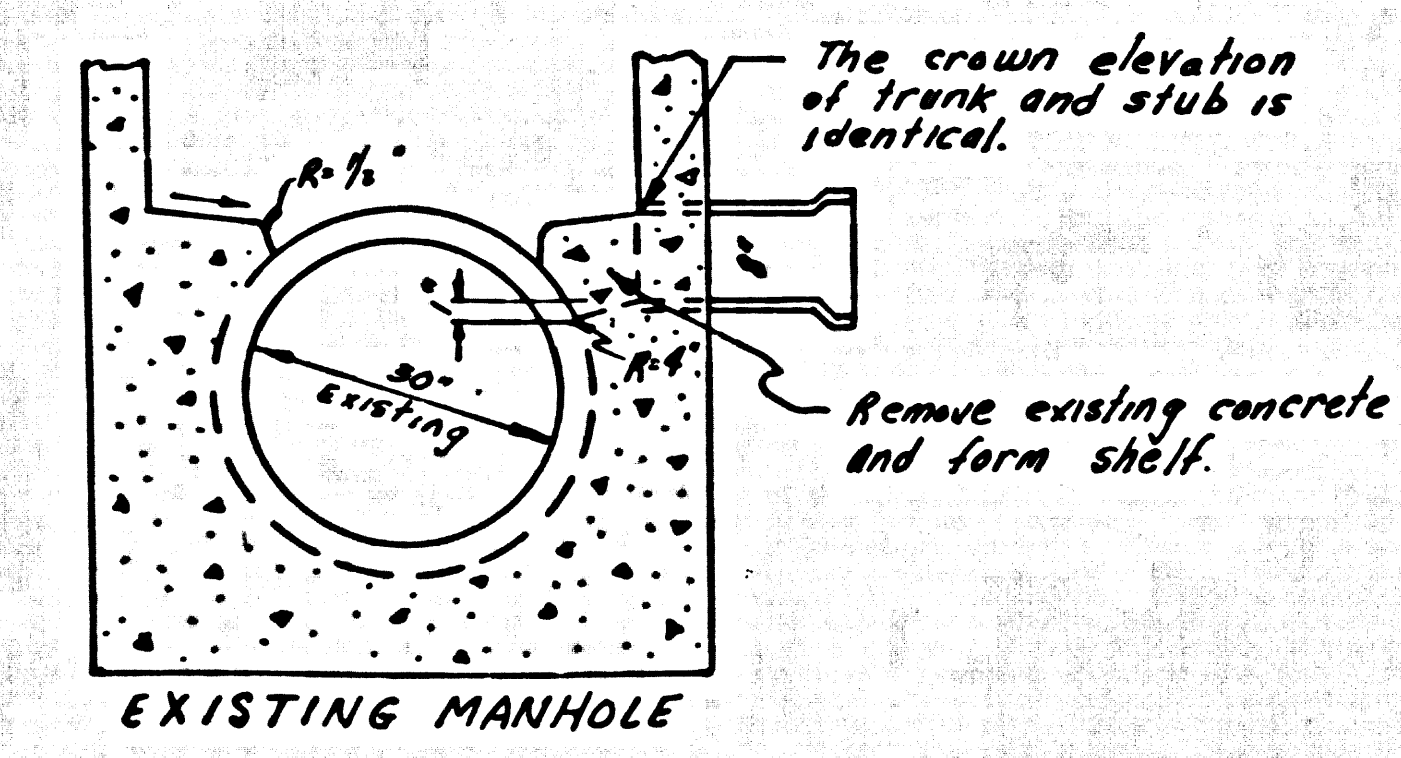
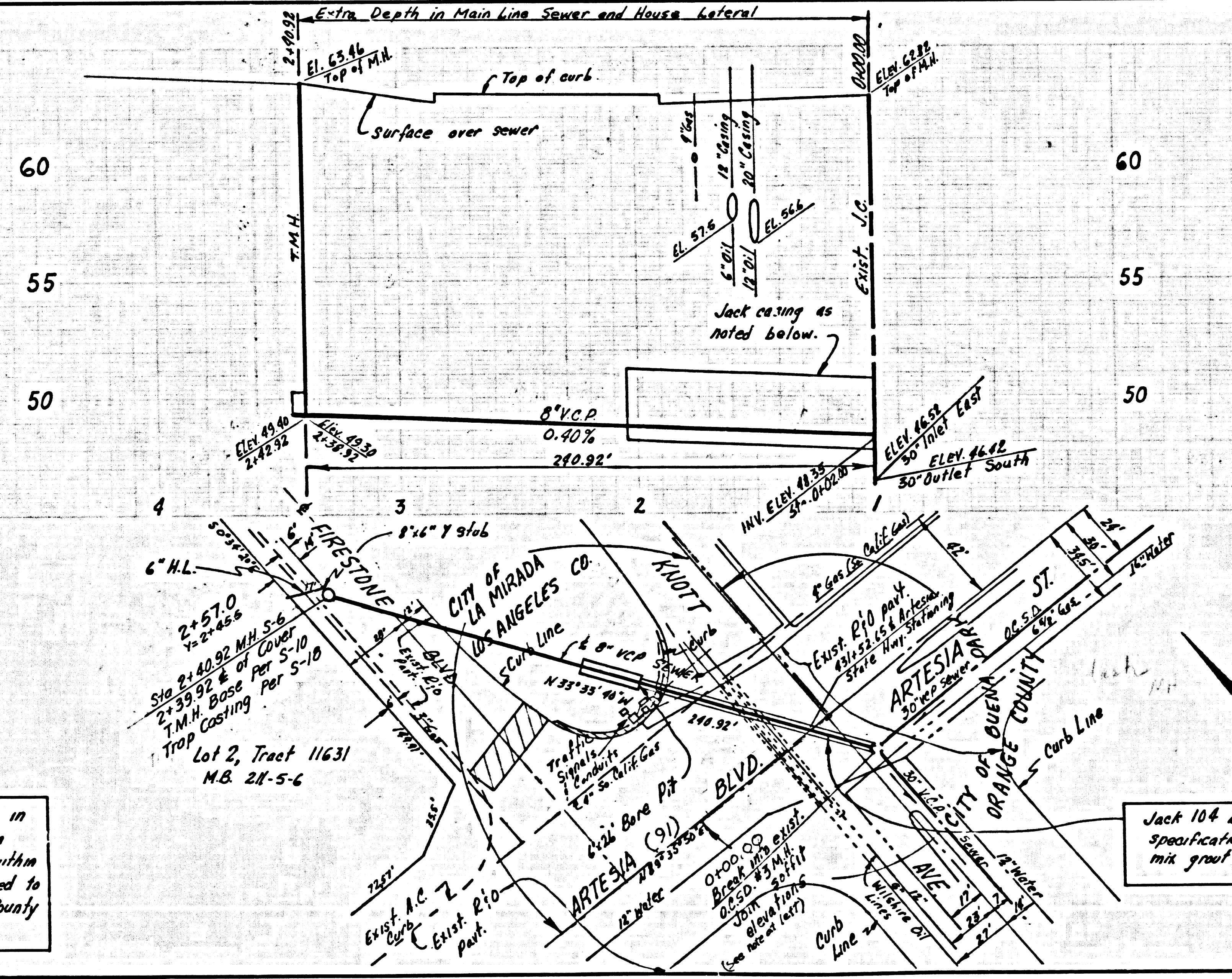

DETAIL OF MANHOLE CONNECTION

Connection to the existing manhole in Artesia Ave. shall be made from within the manhole. Sheeting within the manhole shall be accomplished to the satisfaction of the Orange County Sanitation District's inspector.

Jack 10' Lx 4' of 36" steel casing 1/2" thick per specifications Sec. 61, and backfill with a lean mix grout per Spec., Sec. 34.