

B.M. BY 6088 ELEV. 40.484  
 40 B.M. TAG IN CURB OF SCHOOL  
 ON WAY 55' W. OF DEL. AND BLVD  
 1500' N. OF PIONEER BLVD.  
 ARTESIA QUAD. 1965

**SUBSTRUCTURE NOTE**

THE EXISTENCE AND LOCATION OF ANY UNDERGROUND UTILITIES, PIPES, OR STRUCTURES, SHOWN ON THESE PLANS ARE OBTAINED BY A SEARCH OF AVAILABLE RECORDS, TO THE BEST OF OUR KNOWLEDGE, TRUST AND BELIEF. EXCEPT AS SHOWN ON THIS MAP, THE CONTRACTOR IS ASSURED TO TAKE THE PRECAUTIONARY MEASURES TO PROTECT THE UTILITY LINES SHOWN AND ALL OTHER LINES NOT OF RECORD OR NOT SHOWN ON THIS DRAWING.

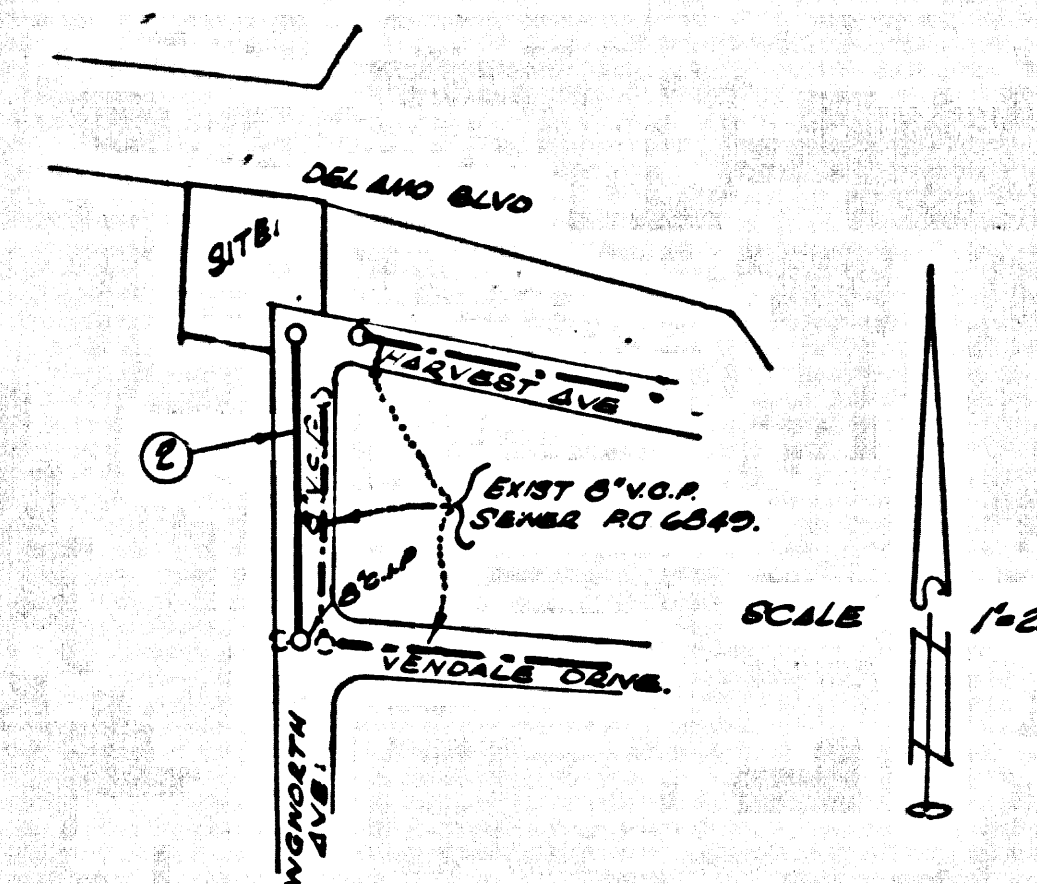

**INDEX MAP**  
 P.C. 7896  
 LONGWORTH AVENUE.

**LAKWOOD BLDG. DIST. NO. 4.01.**

1. POLYMER STAKES ON THE PROPERTY LINE OR PROPERTY LINES PRODUCED AT RIGHT ANGLES TO THE SEWER LINE AT THE CENTER LINE OF EACH MANHOLE.
2. NO REPRESENTATIVE OF THE CITY ENGINEER WILL SURVEY OR LAY OUT ANY PORTION OF THE WORK.
3. THE PRIVATE ENGINEER SHALL FURNISH THE CITY ENGINEER WITH CLEAR SHIFTS AND STATIONING FOR ALL HOUSE LATERALS AND "T" BRANCHES AND SHALL PROVIDE STAKES FOR THEM AT THEIR PROPER LOCATIONS WITH STATIONING PLAINLY MARKED. ALL HOUSE LATERALS SHALL BE CONSTRUCTED AT A STRAIGHT ALIGNMENT AT RIGHT ANGLES FROM THE MAIN LINE SEWER EXCEPT AS SHOWN ON THE PLANS. HOUSE LATERALS FROM CHIMNEYS SHALL HAVE AN ANGLE OF LESS THAN 45° WITH THE MAIN LINE SEWER. ANY CHANGE IN ALIGNMENT SHALL BE REQUESTED IN WRITING BY THE PRIVATE ENGINEER.
4. THE PRIVATE ENGINEER SHALL UNDERSTAND THE HOUSE LATERAL DEPTH AT THE PROPERTY LINE BELOW THE TOP OF CURB ELEVATION FOR EACH HOUSE LATERAL ON THE CLEAR SHIFT.
5. NO REVISIONS SHALL BE MADE IN THESE PLANS WITHOUT THE APPROVAL OF THE CITY ENGINEER.
6. THE CONTRACTOR SHALL NOTIFY THE CONSTRUCTION DIVISION BY TELEPHONE, MADISON 9-5757, EXT. 91381, AT LEAST TWENTY-FOUR HOURS BEFORE STARTING ANY WORK UNDER THIS CONTRACT.
7. MANHOLES SHALL BE BRICK SEWER STRUCTURES PER S.S. PRECAST CONCRETE MANHOLES PER S.S. OR S-4 MAY BE USED.
8. USE STANDARD MANHOLE FRAMES AND COVERS, S.S. DESIGN AS NOTED.
9. MANHOLE TOPS IN UNIMPROVED RIGHTS-OF-WAY TO BE SIX INCHES ABOVE FINISHED GRADE.
10. USE EXTRA STRENGTH PIPE, ALL PIPE IS STANDARD DEPTH.
11. USE MECHANICAL COMPRESSION JOINTS FOR ALL V.C.P. JOINTS PER SPEC. 1, SECC. 54, 48 & 49.
12. IF A POWER POLE IS WITHIN THREE FEET OF THE SEWER, THE SEWER SHALL BE ENCASED, PER S.S. TWO FEET ON EACH SIDE FROM THE POINT OF INTERFERENCE.
13. IF DURING THE COURSE OF CONSTRUCTION IT IS DETERMINED THAT THERE IS LESS THAN FOUR FEET OF COVER OVER THE TOP OF A MAIN LINE OR HOUSE LATERAL V.C.P. SEWER WHICH IS NOT INDICATED ON THE PLANS, THE PIPE SHALL BE ENCASED PER S.S. UNLESS OTHERWISE APPROVED BY THE CITY ENGINEER.
14. HOUSE LATERALS TO BE CONSTRUCTED WITH  $\frac{1}{4}$  MIN. PER FOOT TO PROPERTY LINE.
15. REINFORCE ALL TRENCHES WITHIN PAVED AREAS TO MEET L.A. COUNTY ROAD DEPT. OR CALIFORNIA STATE HIGHWAY REQUIREMENTS IN ACCORDANCE WITH PERMITS.
16. FOR ALLOWABLE LEAKAGE TEST USE FORMULA NO. 1, SPEC. 1, SEC. 54.
17. ALL STATE AND LOCAL TRENCH SAFETY ORDERS WILL BE STRICTLY ENFORCED.
18. "T" BRANCHES SHALL BE LAPPED INSTEAD OF Y BRANCHES AT ALL LOCATIONS.

PROFILE, ALIGNMENT AND GRADE OF P.C. 7896  
**SANITARY SEWERS PAGE 1**  
 TO BE CONSTRUCTED IN  
**LONGWORTH AVENUE**

**PRIVATE CONTRACT NO. 7896**

W.S. 31  
 1 SHEET 2 PAGES

SCALE: VERT. 1" = 4'  
 HORIZ. 1" = 40'

DATE: JUNE, 1967  
 PREPARED IN THE OFFICES OF  
**HOLM, TAIT & ASSOCIATES, ANAHEIM, CALIFORNIA.**

*John F. Holm*  
 REG. C. E. NO. 12252  
 39983

FOR LEGEND SEE PLAN NO. S-1

NOTE:  
 GRADES TO WHICH THIS IMPROVEMENT IS TO BE CONSTRUCTED ARE SHOWN ON PLANS AND PROFILES. GRADE POINTS FOR TOP OF CURBS, CENTER LINE OF STREETS, OR CENTER LINE OF ALLEYS ARE SHOWN BY CIRCLES ON PROFILES. AT ALL POINTS BETWEEN DESIGNATED POINTS THE GRADE SHALL BE ESTABLISHED SO AS TO CONFORM TO A STRAIGHT LINE DRAWN BETWEEN SAID DESIGNATED POINTS. REVISIONS ARE IN RED INCHES S.S. 1, S.S. 16, 17, 20, 21, 22, 23, 24, 25, 26, 27, 28, 29, 30, 31, 32, 33, 34, 35, 36, 37, 38, 39, 40, 41, 42, 43, 44, 45, 46, 47, 48, 49, 50, 51, 52, 53, 54, 55, 56, 57, 58, 59, 60, 61, 62, 63, 64, 65, 66, 67, 68, 69, 70, 71, 72, 73, 74, 75, 76, 77, 78, 79, 80, 81, 82, 83, 84, 85, 86, 87, 88, 89, 90, 91, 92, 93, 94, 95, 96, 97, 98, 99, 100. THIS DRAWING AND THE DATA HEREON ARE HEREBY MADE A PART OF THE SPECIFICATIONS. AS AMENDED, THESE SHALL BE CONSIDERED ACCORDING TO STANDARD SPECIFICATIONS DATE: JUNE 1965, ON FILE IN THE OFFICE OF THE CITY ENGINEER AND SHALL BE PROSECUTED ONLY IN THE PRESENCE OF THE CITY ENGINEER. BEFORE ANY WORK CAN BE STARTED, THE CONTRACTOR MUST OBTAIN A PERMIT TO EXCAVATE IN THE CITY OF LAKEWOOD FROM THE L.A. COUNTY ROAD DEPT. DISTRICT OFFICE NO. 4, AND MAKE A DEPOSIT WITH THE CITY OF LAKEWOOD SUPERVISOR TO COVER THE COST OF CONSTRUCTION INSPECTION AND RECORD PLANS. APPROVAL OF THIS PLAN BY THE CITY OF LAKEWOOD DOES NOT CONSTITUTE A REPRESENTATION AS TO THE ACCURACY OF THE LOCATION OR DEPTH OR NON-EXISTENCE OF ANY UNDERGROUND UTILITY PIPE, OR STRUCTURE WITHIN THE LIMITS OF THIS PROJECT. THIS NOTE APPLIES TO ALL PAGES OF THESE PLANS. A PERMIT MUST BE OBTAINED FROM THE STATE OF CALIFORNIA, DIVISION OF HIGHWAYS, 188 SOUTH SPRING STREET, LOS ANGELES, CALIFORNIA.

**CITY OF LAKEWOOD, CALIFORNIA.**  
 JOHN A. LAMBIE, CITY ENGINEER J. D. PARKHURST, CHIEF ENGINEER  
 CO. ENGINEER

APPROVED BY: *Sullivan C. Stiles* REGIONAL ENGINEER  
 125 CENTRIS REGIONAL ENGINEER

CHECKED BY: *Dwight E. McCall* 6/23/67  
 REG. C. E. NO. 12731

**REVISION**  
 1. REVISED LOCATION OF P.H. # STA. 1+00 TO CLEAR EXIST. WATER LINE TUBERT BLDG.  
 2. REVISED LOCATION OF END P.H. TO CLEAR EX. 10' METER MARK.  
 REVISED MAY 22-1968  
 APPROVED BY: *Dwight E. McCall* DATE 5/28/68

**COLLECT CHARGES AS INDICATED**  
*McCall & Co. with 7-27-67*  
 REVENUE *Charles J. ...*  
 INDUSTRIAL WASTE DIVISION

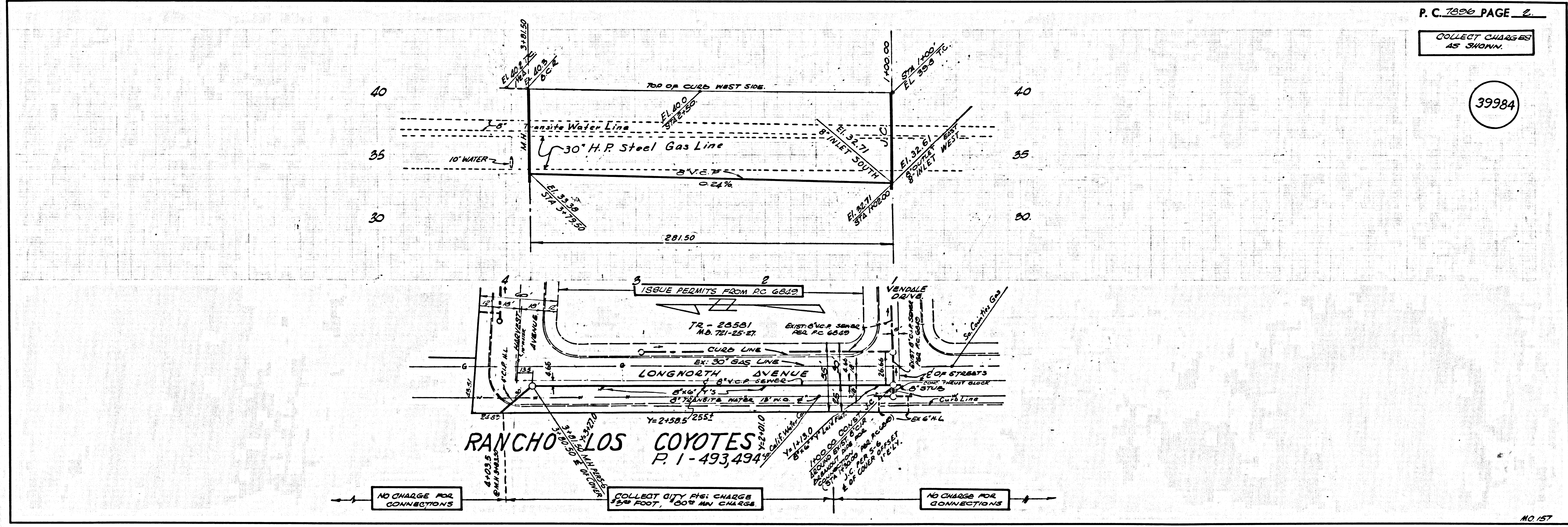

P.C. 7896 PAGE 2

COLLECT CHARGES AS SHOWN.

39984

NO CHARGE FOR CONNECTIONS  
 COLLECT CITY P.H. CHARGES \$24.00 PER FOOT, \$100.00 MIN. CHARGE  
 NO CHARGE FOR CONNECTIONS