

B.M. EY 2291 ELEV. 195.155
 TO C.T. IN CTR. CONC. WALK TO HOUSE
 1350 DUFFEE W. 208' E 4' TO N/O
 INT. FRIENDSHIP AVE & DUFFEE AVE
 TO 8' N/O BEGINNING OF WALK.
 BASELINE QUAD. 1955

PRIVATE ENGINEER'S NOTICE TO CONTRACTOR
 The existence and location of any underground utility pipes or structures shown on these plans are obtained by a search of the available records to the best of our knowledge there are no existing utilities except as shown on this plan. The Contractor is required to take due precautionary measures to protect the utility lines shown and any lines not of record or not shown on this drawing.

John E. Niman
 Registered Engineer No. 9915

ISSUE NO CONNECTION PERMITS UNTIL STREET DEDICATION IS COMPLETED

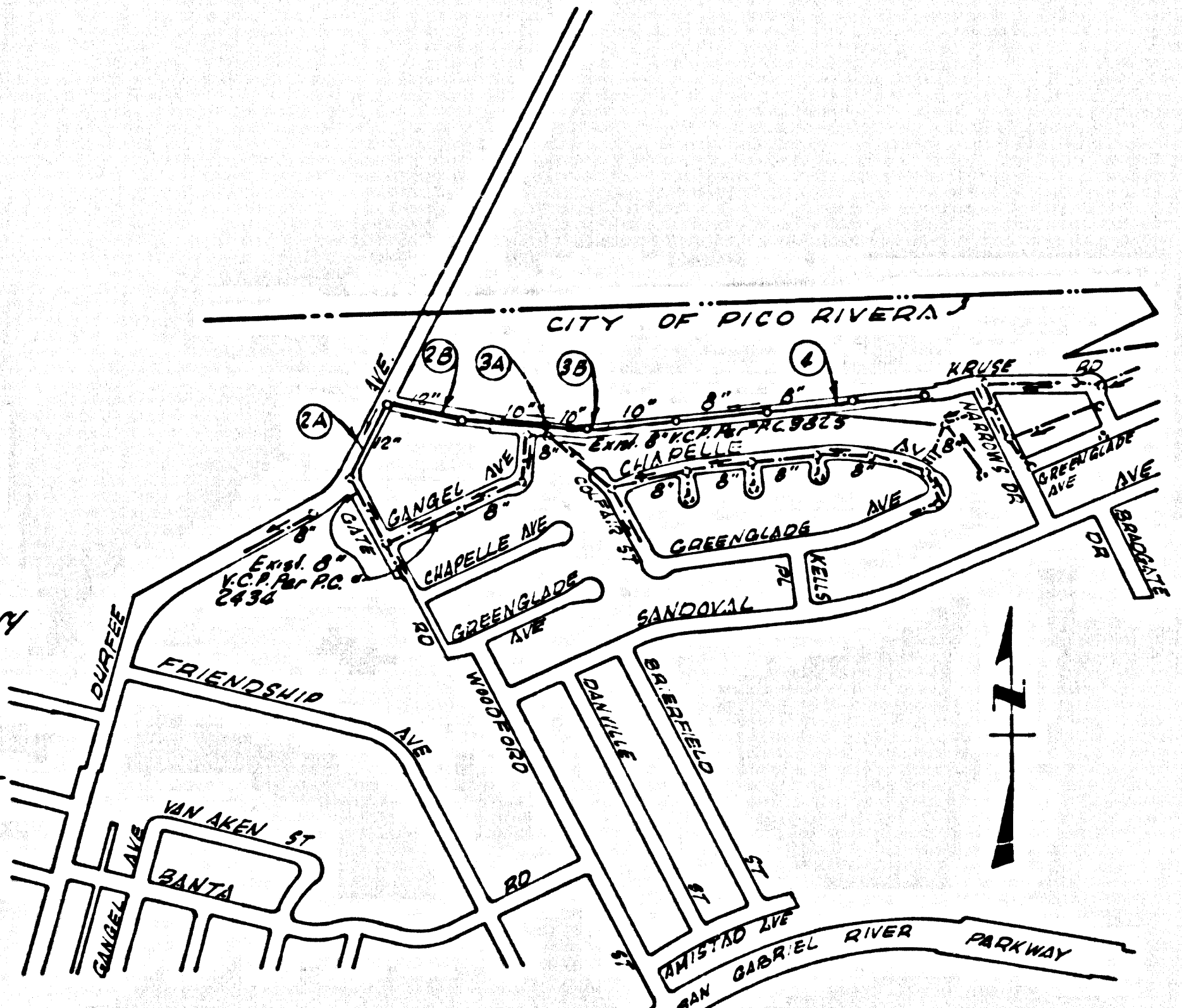

INDEX MAP
 SCALE 1"=600'
 P. C. NO. 7906
 DUFFEE AVE.

PICO RIVERA BLDG. DIST. NO. 11.01

- NOTES:
1. PROVIDE STAKES ON THE PROPERTY LINE OR PROPERTY LINES PRODUCED AT RIGHT ANGLES TO THE SEWER LINE AT THE CENTER LINE OF EACH MANHOLE.
 2. THE PRIVATE ENGINEER SHALL FURNISH THE CITY ENGINEER GRADE SHEETS AND STATIONING FOR ALL HOUSE LATERALS AND "T" BRANCHES AND SHALL PROVIDE STAKES FOR THEM AT THEIR PROPER LOCATIONS WITH STATIONING PLAINLY MARKED. ALL HOUSE LATERALS SHALL BE CONSTRUCTED IN A STRAIGHT ALIGNMENT AT RIGHT ANGLES FROM THE MAIN LINE SEWER EXCEPT AS SHOWN ON THE PLANS. HOUSE LATERALS FROM CHIMNEYS SHALL NOT HAVE AN ANGLE OF LESS THAN 45° WITH THE MAIN LINE SEWER. ANY CHANGE IN ALIGNMENT SHALL BE REQUESTED IN WRITING.
 3. THE PRIVATE ENGINEER SHALL FURNISH THE HOUSE LATERAL DEPTH AT THE PROPERTY LINE BELOW THE TOP OF CURB ELEVATION FOR EACH HOUSE LATERAL ON THE GRADE SHEET.
 4. NO REVISIONS SHALL BE MADE IN THESE PLANS WITHOUT THE APPROVAL OF THE CITY ENGINEER.
 5. THE CONTRACTOR SHALL NOTIFY THE COUNTY HIGHWAY DIVISION BY TELEPHONE, MAY-4151, EXT. 6551, AT LEAST TWENTY-FOUR HOURS BEFORE STARTING ANY WORK UNDER THIS CONTRACT.
 6. MANHOLES SHALL BE BRICK SEWER STRUCTURES PER S-2.
 7. USE STANDARD MANHOLE FRAMES AND COVERS, S-1.
 8. MANHOLE TOPS IN UNIMPROVED RIGHTS-OF-WAY TO BE FLUSH WITH FINISHED GRADE.
 9. USE EXTRA STRENGTH PIPE. ALL PIPE IS STANDARD DEPTH.
 10. USE MECHANICAL COMPRESSION JOINTS FOR ALL V.C.P. JOINTS PER SPECS. SECS. 34, 40 & 49.
 11. IF A POWER POLE IS WITHIN THREE FEET OF SEWER, THE SEWER SHALL BE ENCASED, PER S-13 TWO FEET ON EACH SIDE FROM THE POINT OF INTERFERENCE.
 12. IF DURING THE COURSE OF CONSTRUCTION IT IS DETERMINED THAT THERE IS LESS THAN FOUR FEET OF COVER OVER THE TOP OF A MAIN LINE OR HOUSE LATERAL V.C.P. SEWER WHICH IS NOT INDICATED ON THE PLANS, THE PIPE SHALL BE ENCASED PER S-23, UNLESS OTHERWISE APPROVED BY THE CITY ENGINEER.
 13. HOUSE LATERALS TO BE CONSTRUCTED WITH INVERTS AT 1/4" RISE PER FOOT TO THE PROPERTY LINE.
 14. RESURFACE ALL TRENCHES WITHIN PAVED AREAS TO MEET L.A. COUNTY ROAD DEPT. OR CALIFORNIA STATE HIGHWAY REQUIREMENTS IN ACCORDANCE WITH PERMITS.
 15. ALL STATE AND LOCAL TRENCH SAFETY ORDERS WILL BE STRICTLY ENFORCED.
 16. FOR ALLOWABLE LEAKAGE TEST USE FORMULA NO. 2, SPEC. 54.
 17. BEFORE STARTING WORK THE CONTRACTOR SHALL MAKE ARRANGEMENTS WITH THE DIRECTOR OF ENGINEERING SERVICES FOR TRAFFIC CONTROL AND SHALL DEPOSIT BOND WITH THE CITY IN AN AMOUNT SUFFICIENT TO COVER THE COST OF SAID TRAFFIC CONTROL.

COLLECT CHARGES AS INDICATED
John E. Niman
 Registered Engineer No. 9915

REVIEWED *John E. Niman*
 INDUSTRIAL WASTE DIVISION

PROFILE, ALIGNMENT AND GRADE OF
SANITARY SEWERS PAGE 1
 TO BE CONSTRUCTED IN
KRUSE ROAD

PRIVATE CONTRACT NO. 7906

W.S. 37
 2 SHEETS, 4 PAGES
 SCALE: VERT. 1"=4' HORIZ. 1"=40'
 MAY, 1960
 PREPARED IN THE OFFICES OF
WEACCO INC.

John E. Niman
 REG. C.E. NO. 9915

FOR LEGEND SEE PLAN NO. S-1

NOTE:
 GRADES TO WHICH THE IMPROVEMENT IS TO BE CONSTRUCTED ARE SHOWN ON PLANS AND PROFILES. GRADE POINTS FOR TOP OF CURB, CENTER LINE OF STREETS, ON CENTER LINE OF ALLEYS ARE SHOWN BY CIRCLES ON PROFILES. AT ALL POINTS BETWEEN DESIGNATED POINTS THE GRADE SHALL BE ESTABLISHED SO AS TO CONFORM TO A STRAIGHT LINE AND WITH NEITHER SAID DESIGNATED POINTS. ELEVATIONS ARE IN FEET ABOVE U.S.C. & G.S. SEA LEVEL DATUM OF 1929.
 THE DRAWING AND THE DATA HEREON ARE HEREBY MADE A PART OF THE SPECIFICATIONS. AS AMENDED.
 WORK SHALL BE CONSTRUCTED ACCORDING TO STANDARD SPECIFICATIONS DATED 12-25-52, ON FILE IN THE OFFICE OF THE CITY ENGINEER AND SHALL BE PROSECUTED ONLY IN THE PRESENCE OF THE CITY ENGINEER.
 BEFORE WORK CAN BE STARTED, THE CONTRACTOR MUST OBTAIN A PERMIT TO EXCAVATE IN THE CITY OF PICO RIVERA. THE CITY ENGINEER'S OFFICE WILL ADVISE THE CONTRACTOR OF THE COST OF SUCH PERMIT.
 APPROVAL OF THE PLAN BY THE CITY ENGINEER DOES NOT CONSTITUTE A REPRESENTATION AS TO THE ACCURACY OF THE LOCATION OR THE EXISTENCE OR NON-EXISTENCE OF ANY UNDERGROUND UTILITY PIPE, OR STRUCTURE WITHIN THE LIMITS OF THE PROJECT. THIS NOTE APPLIES TO ALL PAGES.
 IF WORK IS TO BE DONE ON A STATE HIGHWAY, A PERMIT MUST BE OBTAINED FROM THE STATE OF CALIFORNIA, DIVISION OF HIGHWAYS, 126 SOUTH SPRING STREET, LOS ANGELES, CALIFORNIA.

CITY OF PICO RIVERA, CALIFORNIA
 JOHN A. LAMBIE, CITY ENGINEER
 I. D. PARKHURST, CHIEF ENGINEER

APPROVED *John E. Niman* 5/14/60
 FOR LOS ANGELES REGIONAL ENGINEER

CHECKED BY *John E. Niman* 5/14/60
 REG. C.E. NO. 15731

APPROVED *John E. Niman*
 DIRECTOR OF ENGINEERING SERVICES

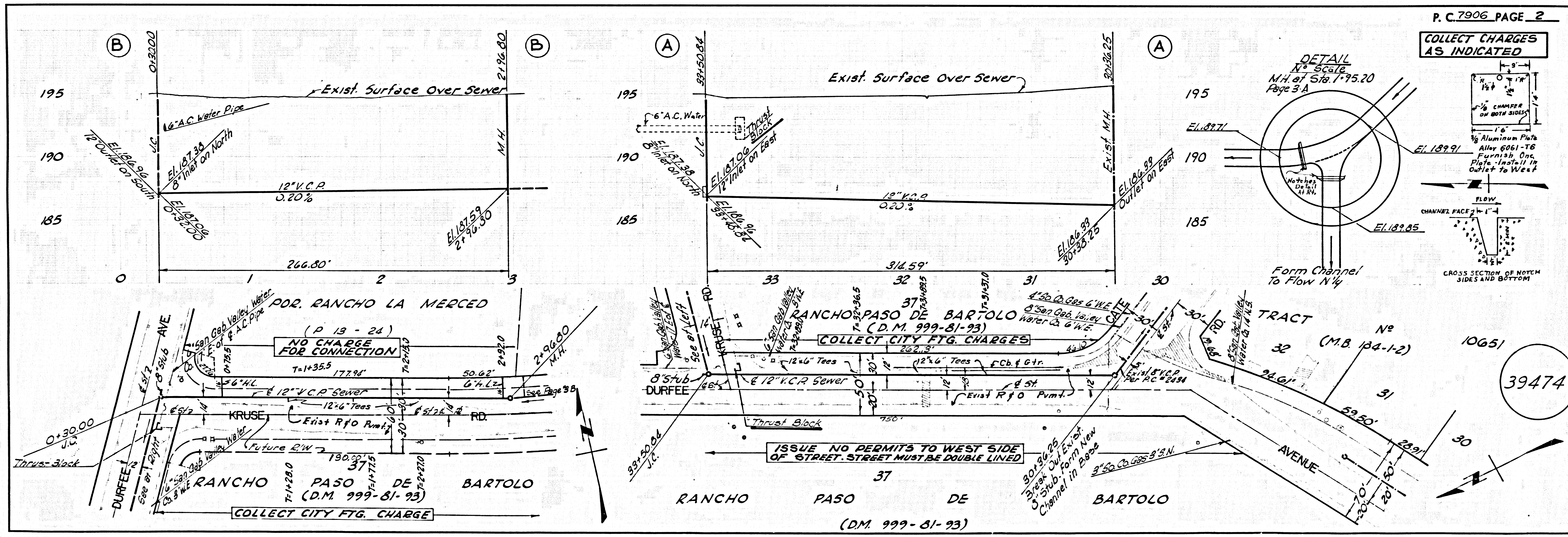

P. C. 7906 PAGE 2

COLLECT CHARGES AS INDICATED

39474

