

REVIEWED
 DESIGN SECTION DATE
 C.C. 7908
 J.N. 0778.21

GENERAL SEWER NOTES

- Sanitary sewers shall be constructed according to Standard Specifications dated May 25, 1962, as revised, and Standard Plans, on file in the Office of the County Engineer and shall be prosecuted only in the presence of the County Engineer.
- For legend see Standard Plan S-1.
- Use extra strength vitrified clay pipe.
- Use mechanical compression joints for all vitrified clay pipe sewers per Sections 36, 48, and 49 of Standard Sewer Specifications.
- All structures shall be either brick manholes per S-3 or precast concrete manholes per S-5 or S-6, except as noted.
- Use standard manhole frames and covers per Standard Plan S-15.
- Use formula No.2 Section 54 of Standard Sewer Specifications, to compute allowable leakage.
- Surface trenches within paved area of streets as noted on Los Angeles Co. Road Dept. road plans.
- Abandoned portions of house laterals shall be sealed per Section 60 of Standard Sewer Specifications.
- The Contractor shall notify the Construction Division by telephone, 629-4747 Ext. 81551, at least 24 hours before starting any work under this project.
- No revisions shall be made in these plans without the approval of the County Engineer.
- Existing service shall be maintained at all times.
- Approval of the sewer plans for this project by the County of Los Angeles does not constitute a representation as to the accuracy of the location of or the existence or non existence of any underground utility pipe or structure within the limits of this project.
- All state and local trench safety orders will be rigidly enforced.
- Construction of the sewer and appurtenances shall also comply with Standard Plans Nos. S-2, S-17, S-26, S-30.

B.M. BY 4688 ELEV. 1088.913, R.D.L.B. 479 Pg. 213
 On S. of Woodbury Rd. 200' E/O of Glenrose Ave. C.S. Man. in well 8' dia., mkd. P.I.
 PASADENA QUAD. 19 55

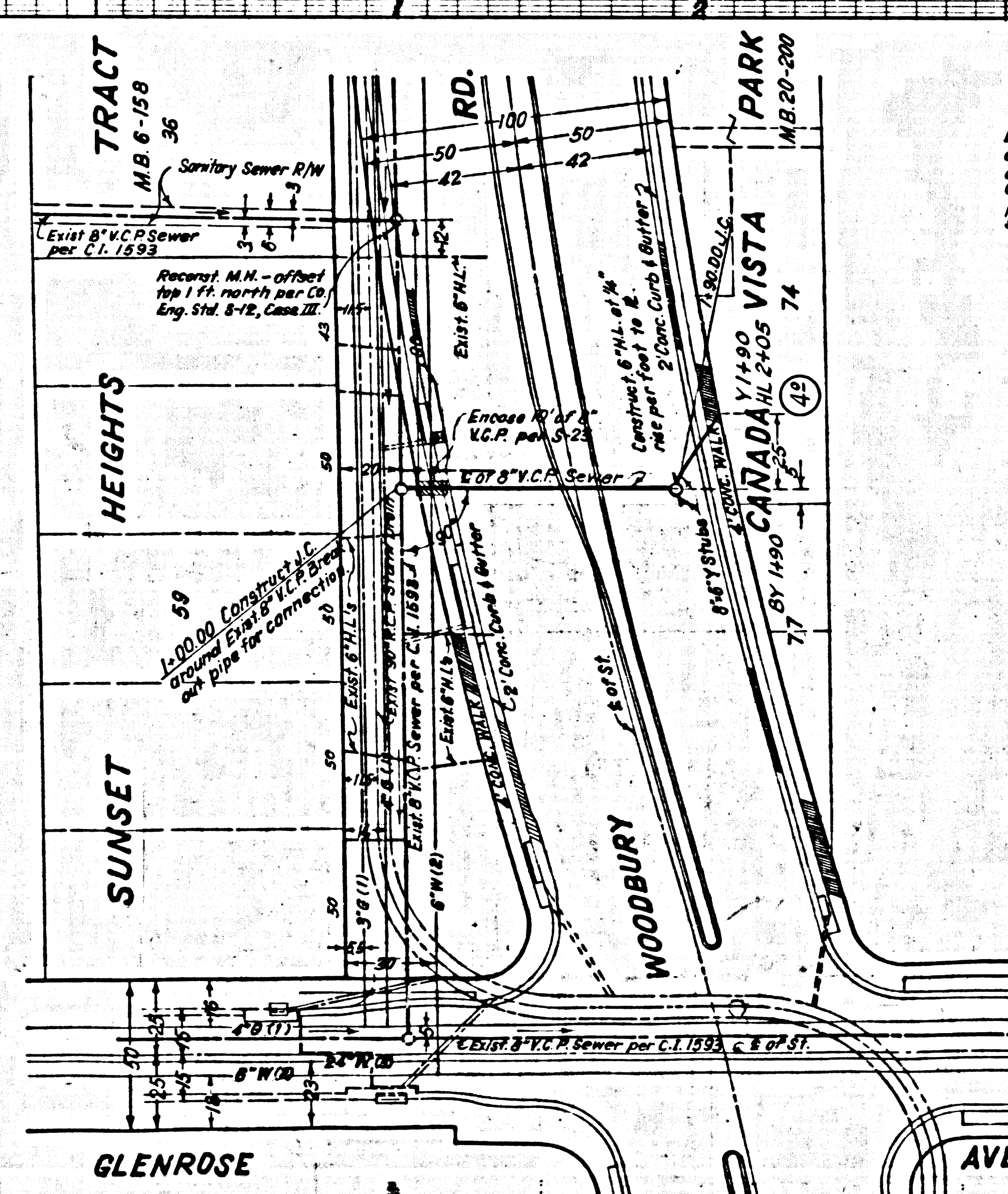
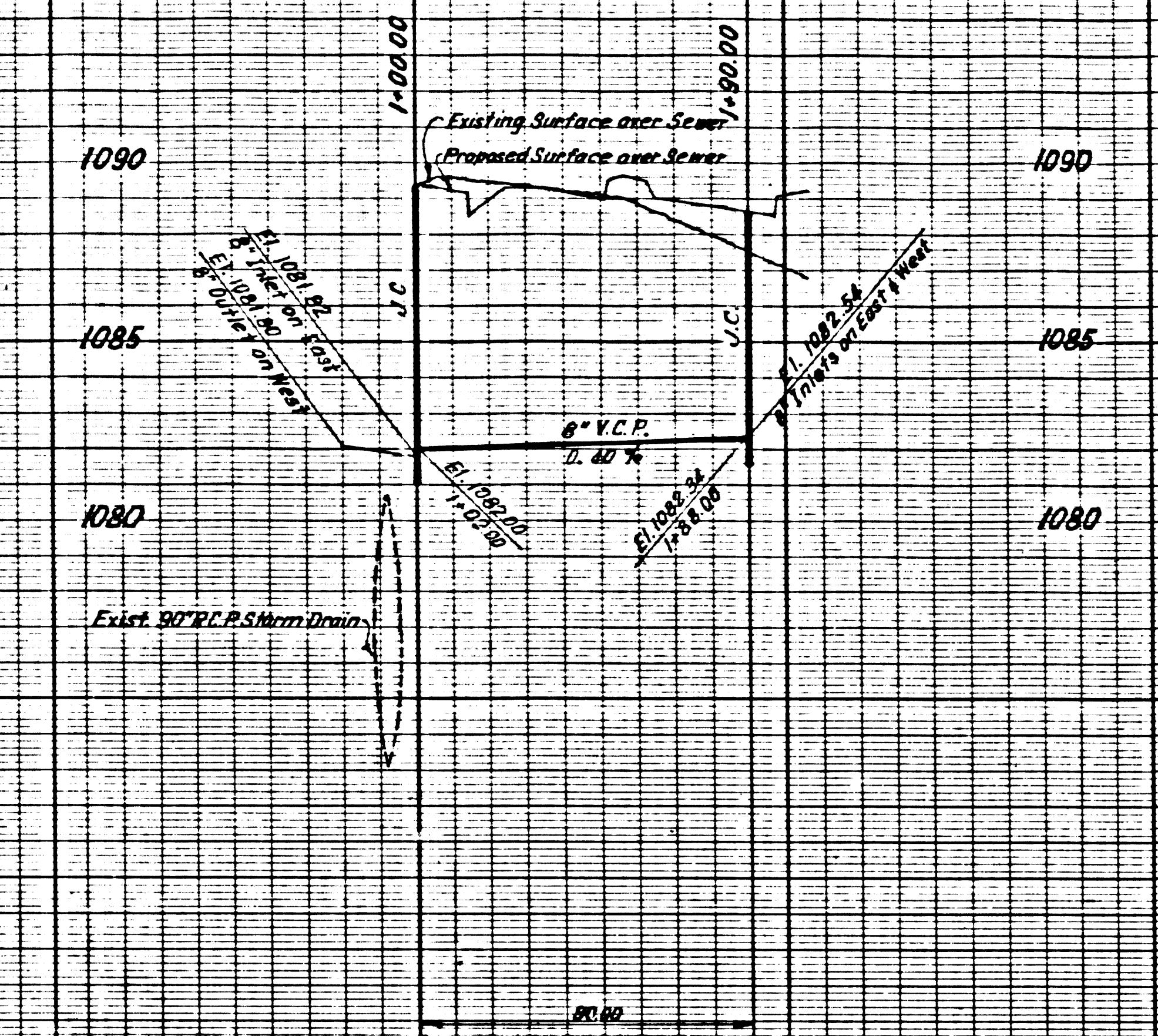

Existing 6" house laterals extending southerly from existing 8" V.C.P. Sewer per C.I. 1553 to be abandoned per Note 3 of General Sewer Notes.

NO CONNECTIONS FOR THE DISPOSAL OF INDUSTRIAL WASTES SHALL BE MADE TO SEWERS SHOWN ON THESE DRAWINGS WITHOUT WRITTEN PERMISSION FROM THE CHIEF ENGINEER AND GENERAL MANAGER OF THE COUNTY SANITATION DISTRICTS.

County Sanitation Districts shall be notified prior to the following so that required inspection can be made (Phone 337-1025):

- 1. Pasadena Water
- 2. Fourhill Municipal Water District

(5) Acceptance of the project.

41392

CASH CONTRACT
No 41256
 PROFILE, GRADE, AND ALIGNMENT OF
SANITARY SEWERS
 TO BE CONSTRUCTED IN
WOODBURY ROAD

COUNTY OF LOS ANGELES

JOHN A. LAMBE COUNTY ENGINEER
 DESIGNED BY *R.D. Sievert* APPROVED *R.D. Sievert*
 REG. C.E. NO. 14390 ASST. DIV. ENGINEER
 10-20-67 SANITATION DIVISION
 (DATE) 10-23-67 (DATE)

JOHN D. PARKHURST
 CHIEF ENGINEER COUNTY SAN. DIST. NO. 17
 APPROVED BY *J.D. Parkhurst*
 OFFICE ENGINEER

THE UNDERGROUND UTILITY COMPANIES WITHIN THE LIMITS OF THIS PROJECT ARE AS FOLLOWS:
 (1) So. Cal. Gas Co.
 (2) Pasadena Water
 (3) Fourhill Municipal Water District

REFERENCE	LAYOUT: R.D. Sievert	RECORD PLANS:
W.S. 88	TRACED - R. Gonzalez-Rubio	
R.D.F.B. 479	CHECKED: K. Weber	
R.D.L.B. 479	INSPECTOR:	

LOS ANGELES COUNTY ROAD DEPARTMENT
HIGHWAY DIVISION

DATE	BY	REVISIONS	SCALE	HORIZ. VERT.	JOB NO.	JOB NAME	SHEET OF SHTS.
			1" = 40'	1" = 4'			DWG. NO.

PROJECT ENGINEER
 DESIGNER
 CHECKER
 REFERENCES