

B.M. BY 6927 --- ELEV. 129.951
 USC & GS Disc in Co. Pacific
 Coast Hwy and Q1 Mt. E. Posco
 De Gracia Bl. Map (1033-1960)
 TORRANCE (Baseline) QUAD 1965

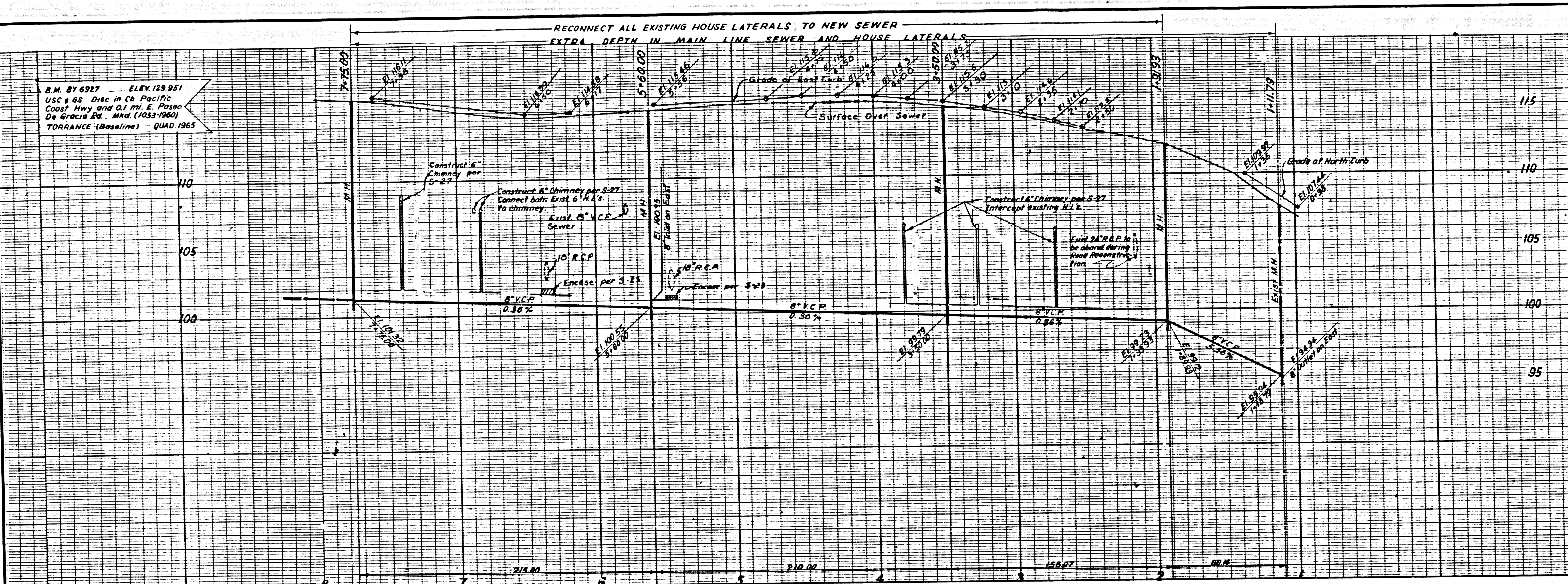

- REVIEWED _____ DESIGN SECTION ABC DATE _____
- ### GENERAL SEWER NOTES
- C.C. 7915 J.N. 0778.27
- Sanitary sewers shall be constructed in accordance with the Standard Specifications for Public Works Construction hereinafter referred to as the Standard Specifications, Special Provisions and Standard Plans on file in the Office of the County Engineer.
 - For Legend see Standard Plan S-1.
 - Use extra strength vitrified clay pipe. All pipe is standard depth, except as noted.
 - Vitrified clay pipe joints shall be Type "D", "F" or "G", per Section 208-2 of Standard Specifications.
 - "T" or "Y" branches may be used for connection to main line sewers, except as noted.
 - All structures shall be either brick manholes per S-3 or precast concrete manholes per S-5 or S-6, except as noted.
 - Use standard manhole frames and covers per Standard Plan S-15.
 - Sewer pipe and appurtenances shall be abandoned in accordance with Section 306-3 of Standard Specifications.
 - Sewers to be tested for leakage per Section 306-2, 3.7 Standard Specifications.
 - Refer to Section 7-10.4.1 of the Standard Specifications, regarding Safety orders.
 - Existing sewer services and flow shall be maintained at all times.
 - No revisions shall be made to these plans without the approval of the County Engineer.
 - The Contractor shall notify the Construction Division of the County Engineer by telephone 629-4747, Ext. 81551, at least twenty-four hours before starting any work under this contract.
 - All cast iron sewer pipe and joints shall be in accordance with Sections 207-91(b) and 207-97 of the Special Provisions and 306-2.3(b)(4) of the Standard Specifications.
 - In addition to standards listed above, the following latest revised Standard Plans shall apply in the construction of this project - S-2, S-17, S-21, S-22, S-23, S-25, S-33.
 - Use Case I Standard Bedding for Sewer Pipe per S-21.
 - All concrete cross gutters, curbs, gutters and driveways shall be tunneled or jacked per Los Angeles County Road Department requirements.

- County Sanitation Districts shall be notified prior to the following so that required inspection can be made (Phone 442-6309):
- Commencement of construction of manhole on District trunk sewer.
 - Breaking into existing manhole on District trunk sewer.
 - Core drilling District trunk sewer.
 - Construction of house connections to District trunk sewer.
- (b) Acceptance of the project.

NO CONNECTIONS FOR THE DISPOSAL OF INDUSTRIAL WASTES SHALL BE MADE TO SEWERS SHOWN ON THESE DRAWINGS WITHOUT WRITTEN PERMISSION FROM THE CHIEF ENGINEER AND GENERAL MANAGER OF THE COUNTY SANITATION DISTRICTS.

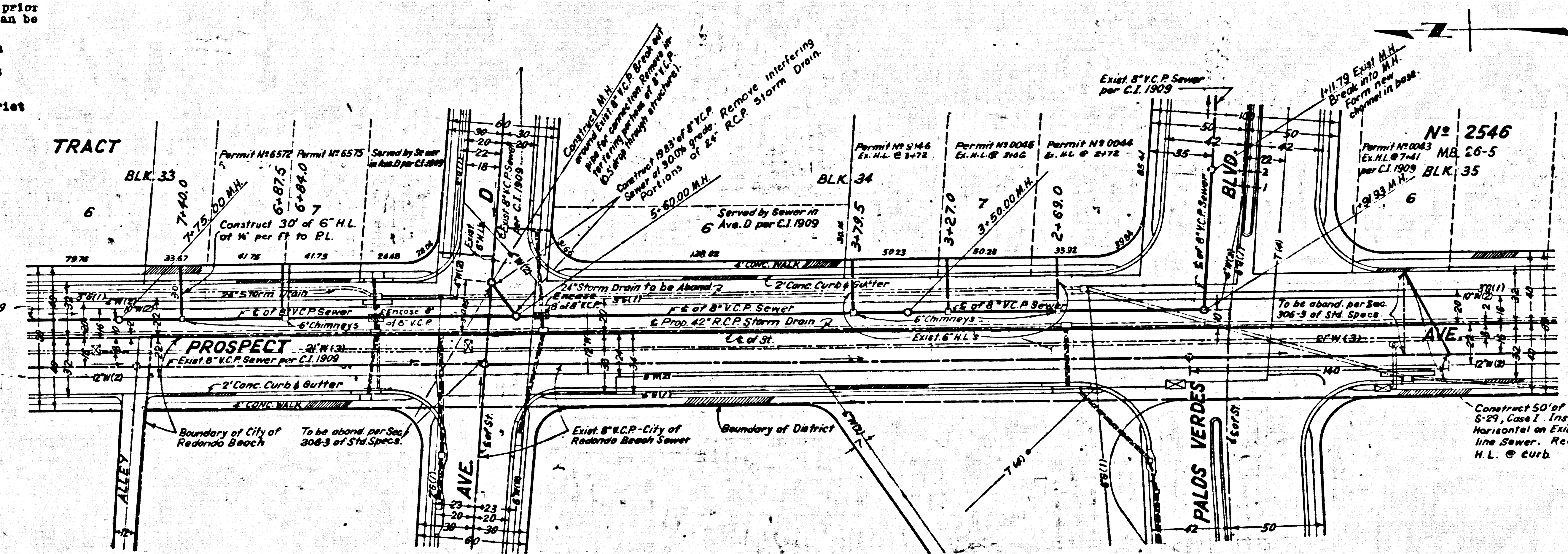

40804

CASH CONTRACT No 41306

PROFILE, GRADE, AND ALIGNMENT OF
 SANITARY SEWER
 TO BE CONSTRUCTED IN
 PROSPECT AVENUE
 COUNTY OF LOS ANGELES

JOHN A. LAMBIE COUNTY ENGINEER
 DESIGNED BY *Richard M. Lambie* APPROVED: *Richard M. Lambie*
 REG. E.C. No. 10399 C-28-67
 (DATE) (DATE)

JOHN D. PARKHURST
 CHIEF ENGINEER COUNTY SANITATION DISTRICT
 SOUTH BAY CITIES
 APPROVED BY *John D. Parkhurst*
 OFFICE ENGINEER

REFERENCE: S.S. 27	LAYOUT: S.S. 27, 28, 29, 30, 31, 32, 33, 34, 35, 36, 37, 38, 39, 40, 41, 42, 43, 44, 45, 46, 47, 48, 49, 50, 51, 52, 53, 54, 55, 56, 57, 58, 59, 60, 61, 62, 63, 64, 65, 66, 67, 68, 69, 70, 71, 72, 73, 74, 75, 76, 77, 78, 79, 80, 81, 82, 83, 84, 85, 86, 87, 88, 89, 90, 91, 92, 93, 94, 95, 96, 97, 98, 99, 100	RECORD PLANS:
R.D.P. 506	TRACED: S.S. 27, 28, 29, 30, 31, 32, 33, 34, 35, 36, 37, 38, 39, 40, 41, 42, 43, 44, 45, 46, 47, 48, 49, 50, 51, 52, 53, 54, 55, 56, 57, 58, 59, 60, 61, 62, 63, 64, 65, 66, 67, 68, 69, 70, 71, 72, 73, 74, 75, 76, 77, 78, 79, 80, 81, 82, 83, 84, 85, 86, 87, 88, 89, 90, 91, 92, 93, 94, 95, 96, 97, 98, 99, 100	
R.D.L. 2128	CHECKED: J. TORRES	
	INSPECTOR:	

LOS ANGELES COUNTY ROAD DEPARTMENT	
HIGHWAY	JOB NAME
DIVISION	LIMITS
DATE BY	JOB NO.
REVISIONS	SHEET 13 OF 51 SHTS.
SCALE: HORIZ. 1" = 40'	DWG. NO.
VERT. 1" = 4'	

- THE UNDERGROUND UTILITY COMPANIES WITHIN THE LIMITS OF THIS PROJECT ARE AS FOLLOWS:
- Southern California Gas Co.
 - California Water Service Co.
 - Western States Gas Co. (L.A.C.F.C.D.)
 - Pacific Telephone Co.

CONTRACTOR: _____
 CHECKED: _____
 DATE: _____

Chin ok
L.C.
12/1/69

REVIEWED			
DESIGN	SECTION	ABC	DATE

B.M. BY 6927 ELEV 129.951
 USC & GS, Dine in Ca Pacific
 Coast Hwy and O.I. E. 1950
 De Gracia Rd. Mkd. (1053-1960)
 TORRANCE (Baseline) QUAD 1865

RECONNECT ALL EXISTING HOUSE LATERALS TO NEW SEWER. MAKE CONNECTION TO
 EXISTING 8" V.C.P. LINES ON EAST SIDE OF STREET BY CONSTRUCTING 5" OF 8" V.C.P.
 EXTRA DEPTH IN MAIN LINE SEWER & HOUSE LATERALS.

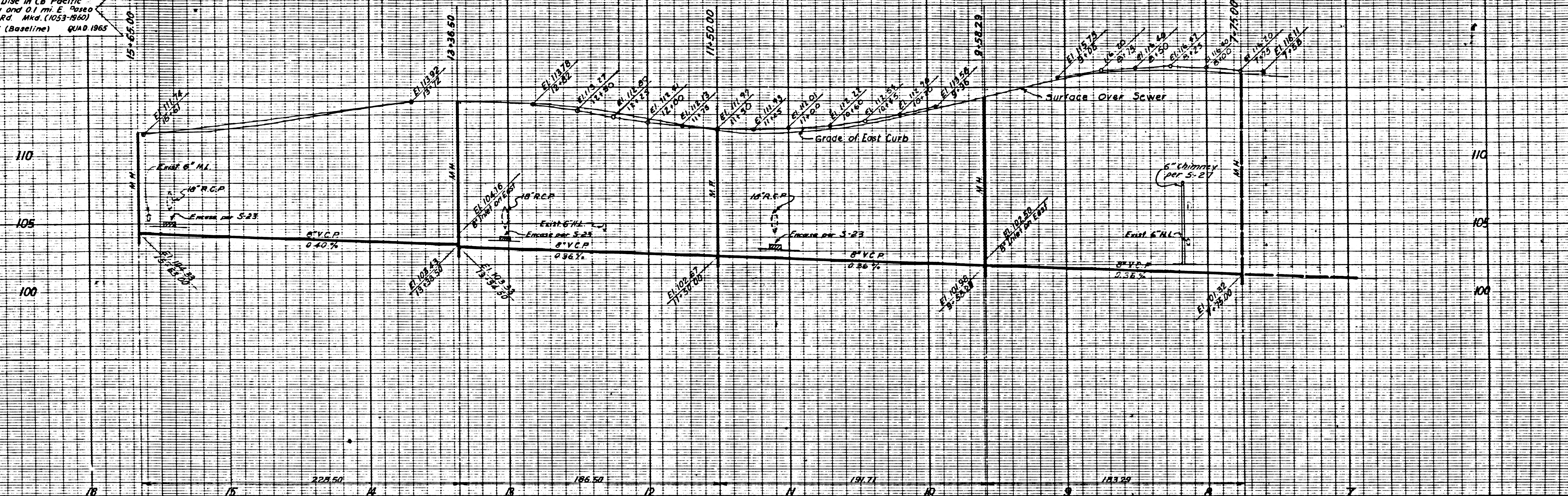

40805

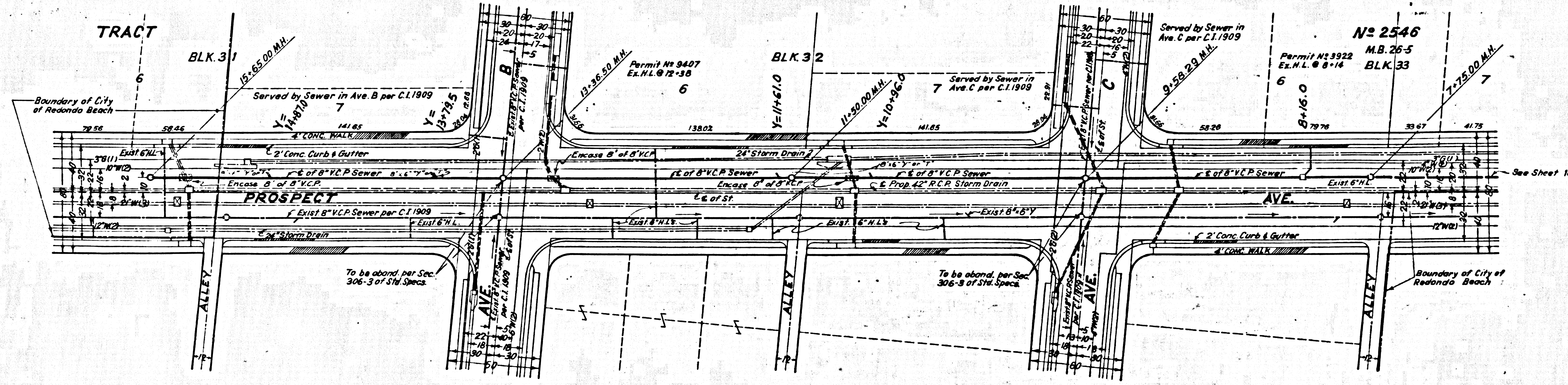

THE UNDERSIGNED HEREBY CERTIFIES THAT THE INFORMATION CONTAINED IN THIS PLAN IS TRUE AND CORRECT TO THE BEST OF HIS KNOWLEDGE AND BELIEF.

(1) Southern California Gas Co.
 (2) California Water Service Co.
 (3) Water Supply Conduit (L.A.C.F.C.D.)
 (4) Pacific Telephone Co.

DATE		BY		REVISIONS		HORIZ. 1" = 40'		SCALE VERT. 1" = 4'		JOB NO.		SHEET 79 OF 81	

LOS ANGELES COUNTY ROAD DEPARTMENT
 HIGHWAY DIVISION
 JOB NAME
 LIMITS

DESIGN	SECTION	DATE

SCALE
 Horiz. 1" = 40'
 Vert. 1" = 4'

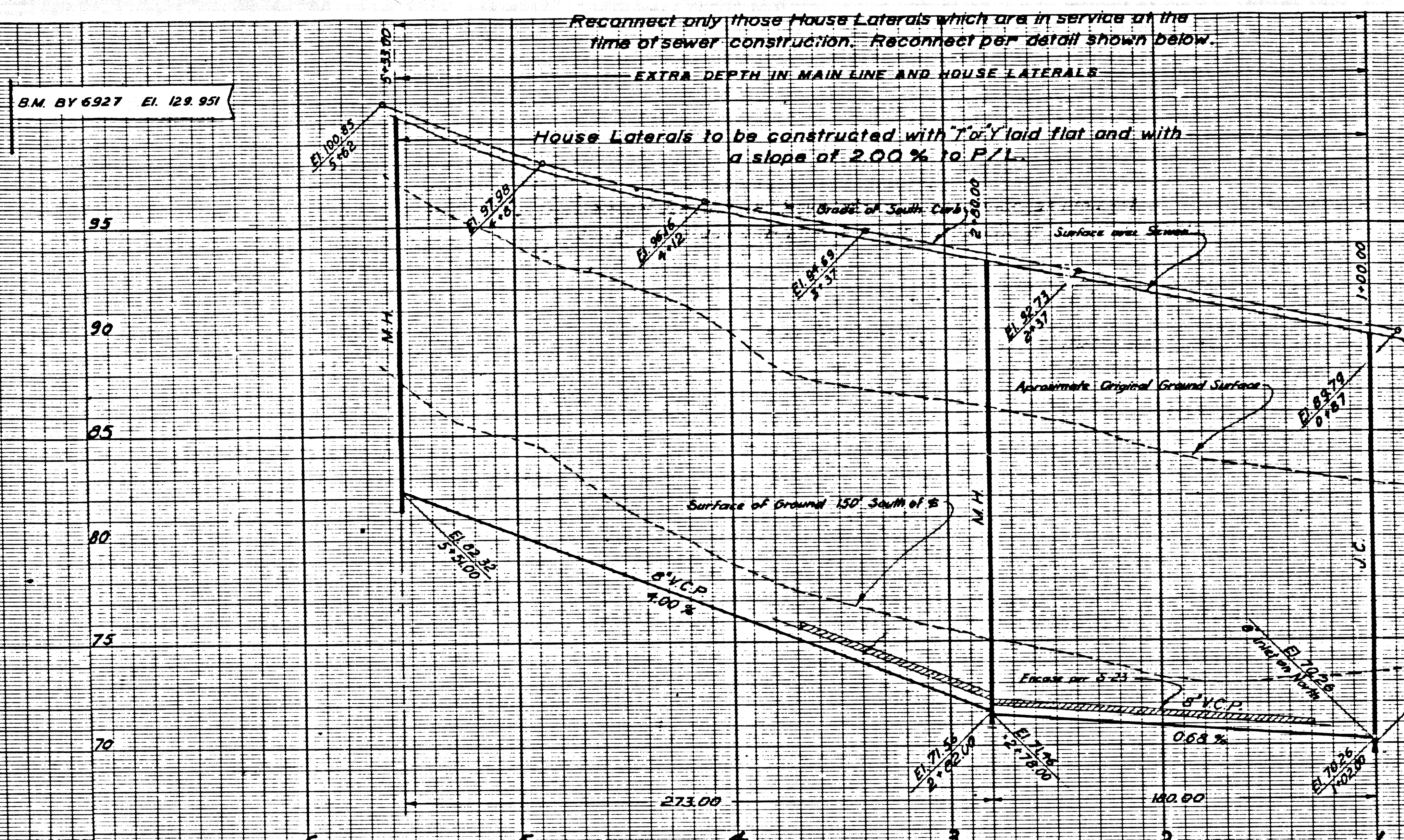

40806

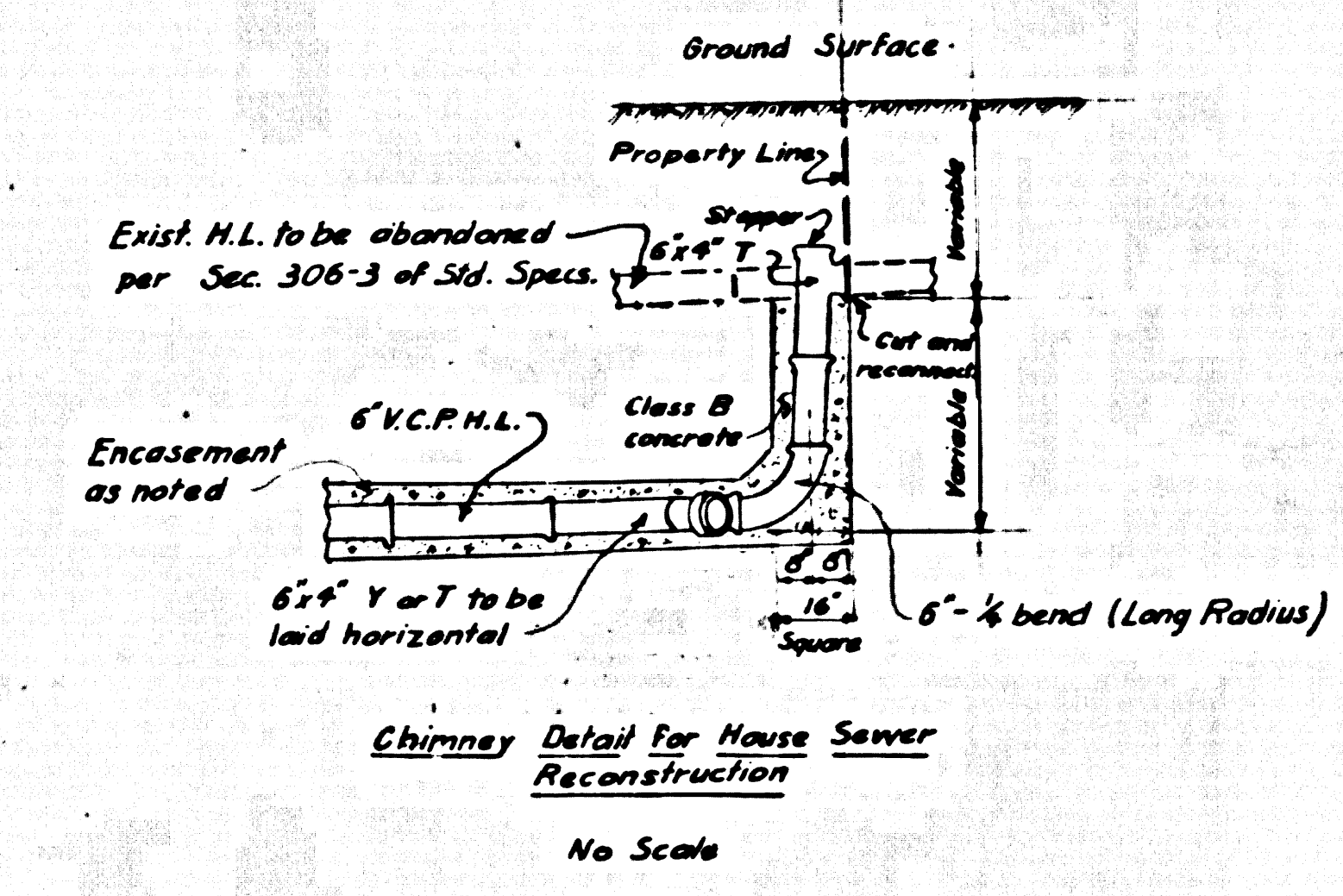
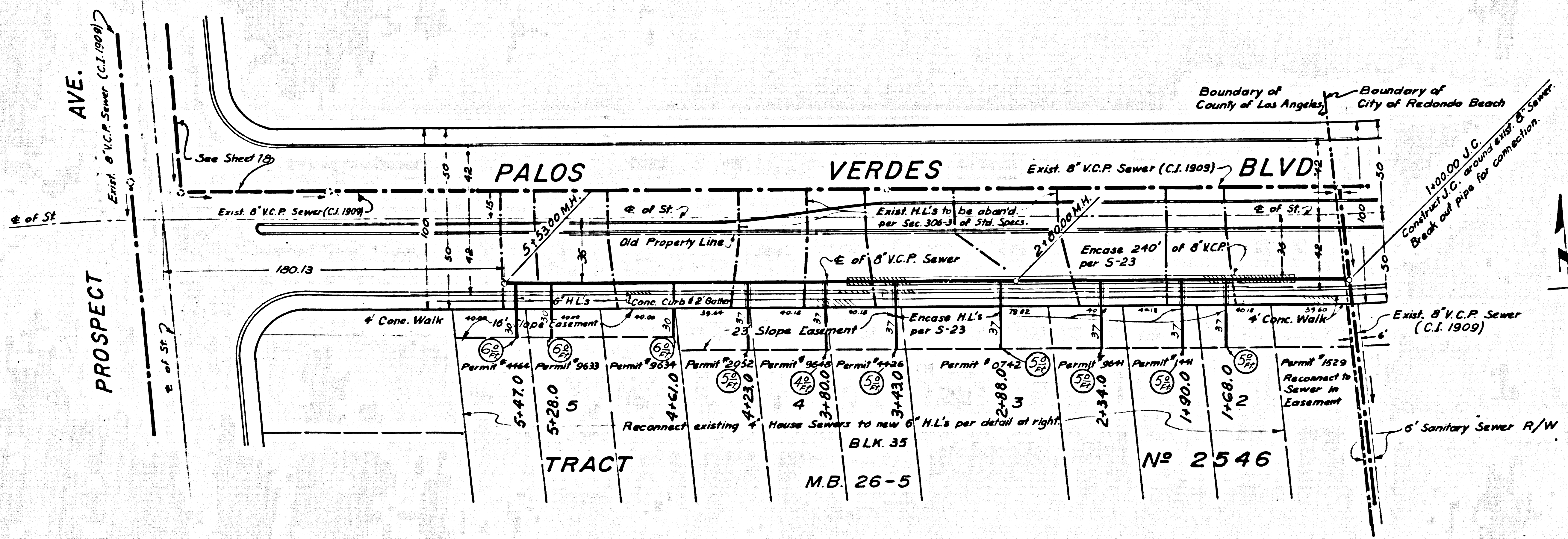

PROJECT ENGINEER
 C.E. No.
 DESIGNER
 CHECKER
 REFERENCES

LOS ANGELES COUNTY ROAD DEPARTMENT			
HIGHWAY DIVISION		JOB NAME LIMITS	
DATE	BY	JOB NO.	SHEET 20 OF SHTS.
REVISIONS		SCALE HORIZ. 1" = 40' VERT. 1" = 4'	DWG. NO.