

PROFILE SCALE:

HORIZ. 1" = 40'

VERT. 1" = 4'

B.M. 216 EL. 4178 F.B. 333-10
LAS TUNAS & N CHARLOTTE AVE. NE. COR.
BY SPK IN CB 22' E OF E. END C.R.

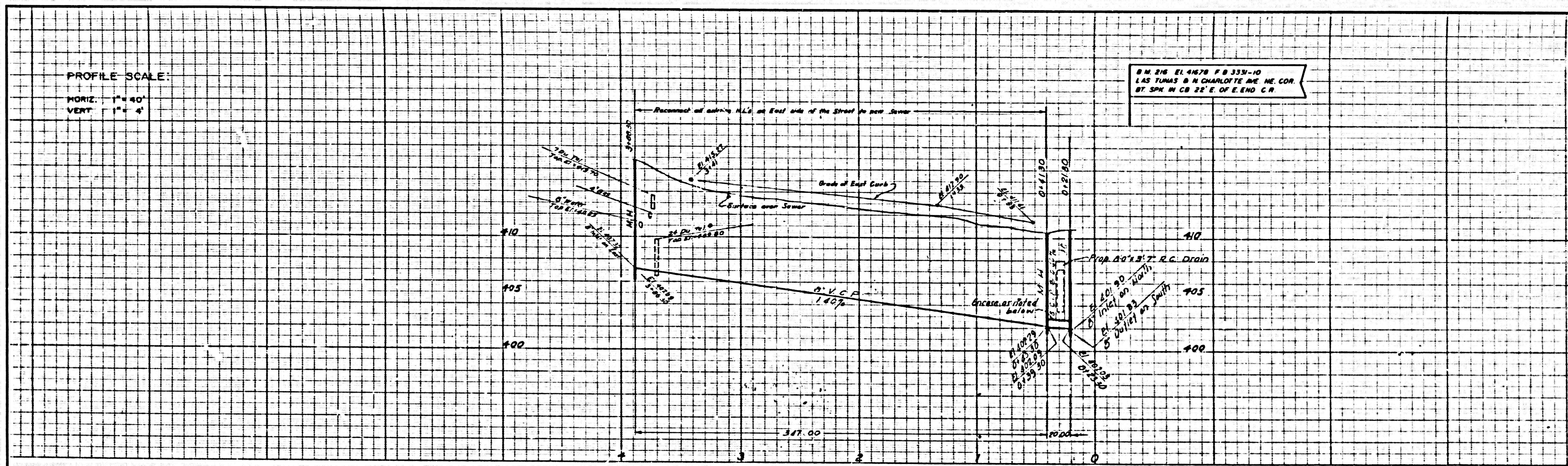

GENERAL SEWER NOTES

- Sanitary Sewer shall be constructed according to Standard Specifications dated May 25, 1962, as revised, on file in the Office of the County Engineer & shall be prosecuted only in the presence of the County Engineer.
- For legend see Standard Plan S-1.
- Use extra strength vitrified clay pipe (except as noted).
- Use mechanical compression joints for all vitrified clay pipe sewers per Sections 36, 48, & 49 of Standard Sewer Specifications.
- All structures shall be brick manholes per S-3.
- Use standard manhole frames & covers per Standard Plan S-15.
- Use formula No. 2 Section 54 of Standard Sewer Specifications, to compute allowable leakage.
- Existing service to be maintained at all times.
- Resurface trenches within paved area of streets per Section 69 of Standard Sewer Specifications.
- Abandoned portions of house laterals shall be sealed per Section 60 of Standard Sewer Specifications.
- The Contractor shall notify the Coroner's Division by telephone, 629-4747, Ext. 81551, at least 24 hours before starting any work under this project.
- No revisions shall be made in these plans without the approval of the County Engineer.
- Approval of the sewer plans for this project by the County of Los Angeles does not constitute a representation as to the accuracy of the location of, or the existence or non-existence of any underground utility pipe or structure within the limits of this project.

NO CONNECTIONS FOR THE DISPOSAL OF INDUSTRIAL WASTES SHALL BE MADE TO SEWERS SHOWN ON THESE DRAWINGS WITHOUT WRITTEN PERMISSION FROM THE CHIEF ENGINEER AND GENERAL MANAGER OF THE COUNTY SANITATION DISTRICTS.

* See General Notes, Sheet 2

NO CHARGE FOR CONNECTIONS

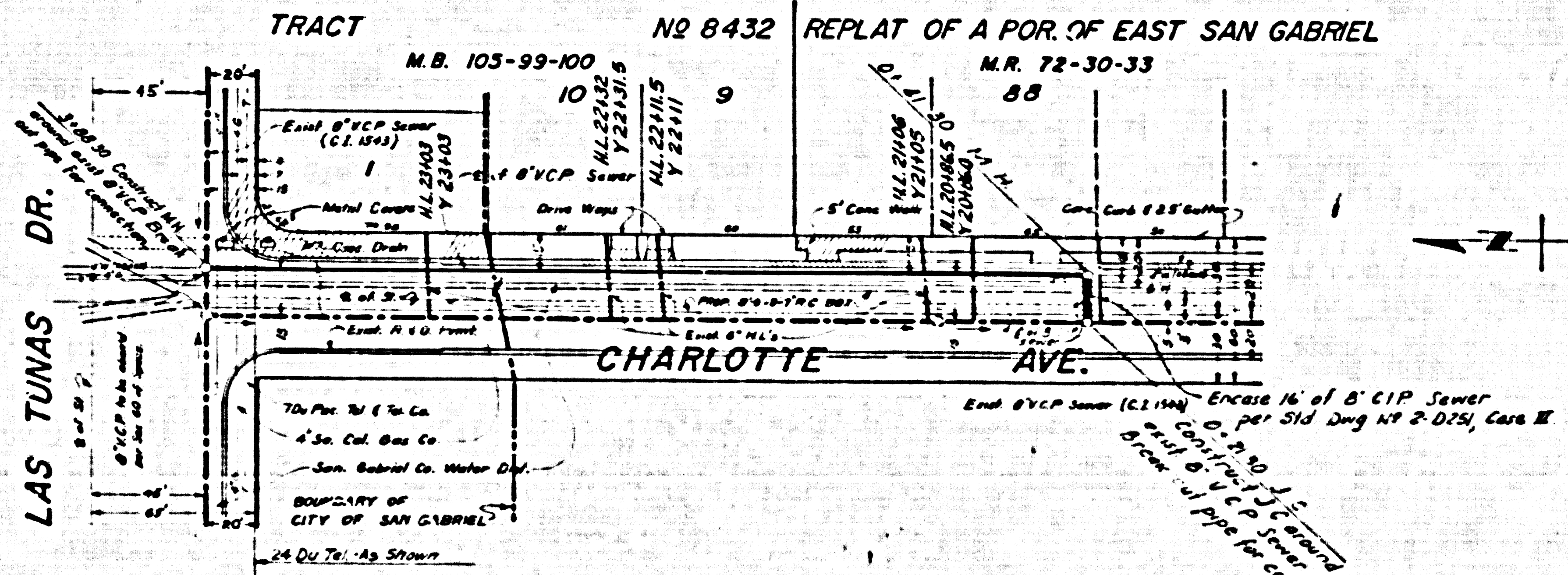

REVISIONS			
NO.	DATE	DESCRIPTION	BY

DATE	REVISION DESCRIPTION	BY
7-18-68	Added 1 M.H. and 60' to manhole	J. D. Parkhurst

APPROVED:
JOHN D. PARKHURST
CHIEF ENGINEER
CO. SAN. DIST. NO. 16

PREPARED BY
JOHN A. LAMBIE
CITY ENGINEER
P.C. 7916
RECOMMENDED BY

41910

P.C. 7916

1964 STORM DRAIN BOND ISSUE

LOS ANGELES COUNTY
FLOOD CONTROL DISTRICT

**CHARLOTTE AVE.
PROJECT NO. 705**

SANITARY SEWER RECONSTRUCTION PLAN
STA. 0+80.00 TO STA. 3+88.30

PLAN AND PROFILE

SCALE: DATE: DWG. NO. 364-705-DZ.12
SHEET 12 OF 13

P.C. 7916 (2D) PROJECT NO. 705