

B.M. S.D. 1944 E1.42520 F.B.3334-14
ALONDRA BLVD. & BROADWAY BLVD. S.E.
Cor. L & R.D. N & W in Cb. 25 ft E of E end C.R.

PROFILE SCALE

Horiz. 1" = 40'
Vert. 1" = 4'

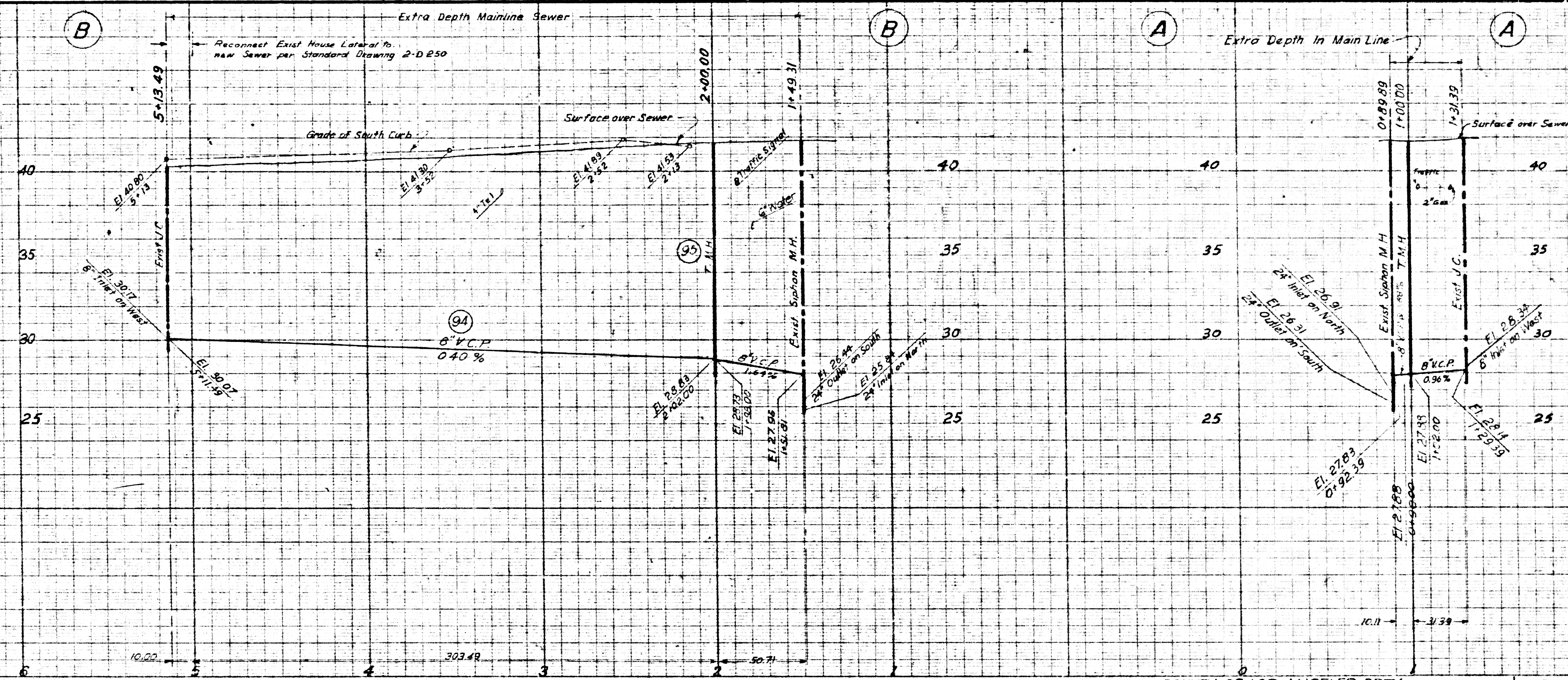

40793

GENERAL SEWER NOTES

- Sanitary Sewers shall be constructed in accordance with the Standard Specifications for Public Works Construction (hereinafter referred to as the Standard Specifications), Special Provisions and Standard Plans on file in the Office of the County Engineer.
- Unfired clay pipe joints shall be Type "D", "F" or "G", per Section 208-2 of Standard Specifications.
- "T" or "Y" branches may be used for connection to main line sewers.
- Sewer pipe and appurtenances shall be abandoned in accordance with Section 306-3 of Standard Specifications.
- Refer to Section 7-10, 4.1 of the Standard Specifications for Safety orders.
- Existing sewer services and flow shall be maintained at all times.
- The Contractor shall notify the Construction Division of the County Engineer by telephone 629-4747, Ext. 81551, at least 24 hours before starting any work under this contract.
- Work performed on County Sanitation District sewers shall be in accordance with that agency's Specifications and requirements.
- In addition to standards listed above, the following latest revised Standard Plans shall apply in the construction of this project: S-1, S-2, S-3, S-10, S-13, S-15, S-17, S-18, S-21, S-26, S-30 and S-33.
- All concrete cross gutters, curbs, gutters and driveways shall be tunneled or jacked per Los Angeles County Road Department requirements.

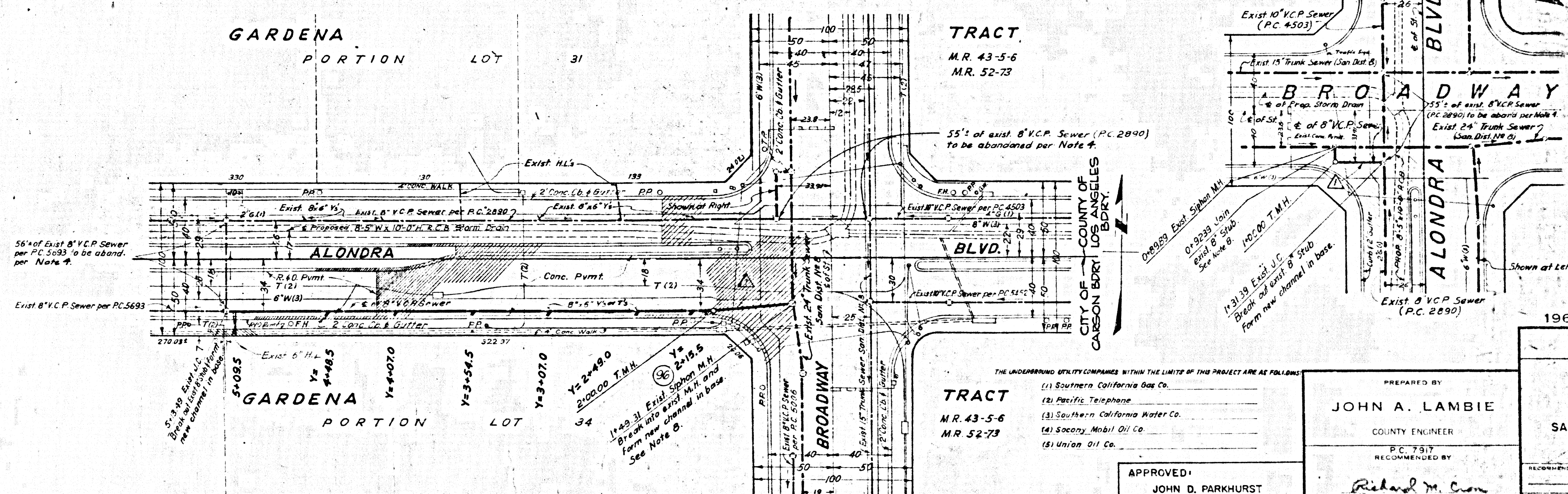

NO.	DATE	REVISIONS	APPROVED
1	10/28/68	Change Sewer alignment	<i>[Signature]</i>

TRACT
M.R. 43-5-6
M.R. 52-73

- THE UNDERPINNING SERVICES COMPANED WITHIN THE LIMITS OF THIS PROJECT ARE AS FOLLOWS:
- (1) Southern California Gas Co.
 - (2) Pacific Telephone
 - (3) Southern California Water Co.
 - (4) Socal, Mobil Oil Co.
 - (5) Union Oil Co.

APPROVED:
JOHN D. PARKHURST
CHIEF ENGINEER
CO. SAN. DIST. NO. 8

PREPARED BY
JOHN A. LAMBIE
COUNTY ENGINEER

1964 STORM DRAIN BOND ISSUE
LOS ANGELES COUNTY
FLOOD CONTROL DISTRICT
COUNTY
PROJECT NO. 1207
SANITARY SEWER RECONSTRUCTION
PLAN AND PROFILE

RECOMMENDED BY: *[Signature]*
APPROVED BY: *[Signature]*
SCALE: 1" = 40' HORIZ. 1" = 4' VERT.
DATE: DEC 68
DWG. NO. 354-1207-03.03

P.C. 7917 (S.D. PROJ. 1207)