

B.M. B.G.55 ELEV. 612.072
 L&N W. CB. 1/2 B.C.R. @ NW COR.
 ARROW HWY. & BEN LOMOND AVE.
 ± 70' N. & ± 30' W. C/L INT.
 SAN DIMAS QUAD. 19 65

SAN DIMAS BLDG. DIST. NO. 10

PROFILE ALIGNMENT AND GRADE OF P.C. 7926
 SANITARY SEWERS PAGE 1

CONSTRUCTED IN
 BEN LOMOND AVENUE

PRIVATE CONTRACT NO. 7926

W.S. 47
 1 SHEET, 2 PAGES
 DATE: SEPTEMBER 1967 39528

PREPARED BY THE OFFICES OF
 H. CLIFFORD THORN & ASSOCIATES
 CIVIL ENGINEERS & LAND SURVEYORS
 502 W. ALOSTA AVE., GLENORA, CALIF. ED. 30507
 REG. C. & NO. 10130

NOTE:
 GRADES TO WHICH THIS IMPROVEMENT IS TO BE CONSTRUCTED ARE SHOWN ON PLANS AND PROFILES. GRADE POINTS FOR TOP OF CURBS, CENTER LINE OF STREETS, OR CENTER LINE OF ALLEYS ARE SHOWN BY CIRCLES ON PROFILES. AT ALL POINTS BETWEEN DESIGNATED ELEVATIONS ARE IN FEET ABOVE U.S.C. & G.S. MEAN SEA LEVEL DATUM OF 1929.
 THE DRAWING AND THE DATA HEREON ARE HEREBY MADE A PART OF THE SPECIFICATIONS.
 WORK SHALL BE CONSTRUCTED ACCORDING TO STANDARD SPECIFICATIONS DATED 5-23-65 AS SET FORTH ON FILE IN THE OFFICE OF THE COUNTY ENGINEER.
 BEFORE WORK CAN BE STARTED, THE CONTRACTOR MUST OBTAIN A PERMIT TO EXCAVATE IN COUNTY STREETS FROM THE L.A. COUNTY ROAD DEPT., DISTRICT OFFICE NO. 1, AND PAY A FEE TO THE COUNTY ENGINEER, ROOM 300, COUNTY ENGINEERING BUILDING, CONSTRUCTION DIVISION AND HIGHWAY DEPT.
 APPROVAL OF THIS PLAN BY THE COUNTY OF LOS ANGELES DOES NOT CONSTITUTE A REPRESENTATION AS TO THE ACCURACY OF THE LOCATION OF OR THE EXISTENCE OR NON-EXISTENCE OF ANY UNDERGROUND UTILITY PIPE, OR STRUCTURE WITHIN THE LIMITS OF THE PROJECT. THIS NOTE APPLIES TO ALL PAGES.
 IF WORK IS TO BE DONE ON A STATE HIGHWAY, A PERMIT MUST BE OBTAINED FROM THE STATE OF CALIFORNIA, DIVISION OF HIGHWAYS, THE SOUTH SPRING STREET, LOS ANGELES, CALIFORNIA.

COUNTY OF LOS ANGELES, CALIFORNIA
 JOHN A. LAMBE, COUNTY ENGINEER J. D. PARKHURST, CHIEF ENGINEER
 APPROVED BY: *[Signature]* APPROVED BY: *[Signature]*
 SAN DIMAS REGIONAL ENGINEER OFFICE ENGINEER

CHECKED BY: *[Signature]* APPROVED BY: *[Signature]*
 REG. C. & NO. 10283 CITY ENGINEER RE 3366
 CITY OF GLENORA

J.N. 0368.65

- County Sanitation Districts shall be notified prior to the following so that required inspection can be made (Phone: 337-4025):
- (1) Commencement of construction of manhole on District trunk sewer.
 - (2) Breaking into existing manhole on District trunk sewer.
 - (3) Core drilling District trunk sewer.
 - (4) Construction of house connections to District trunk sewer.
 - (5) Acceptance of the project.

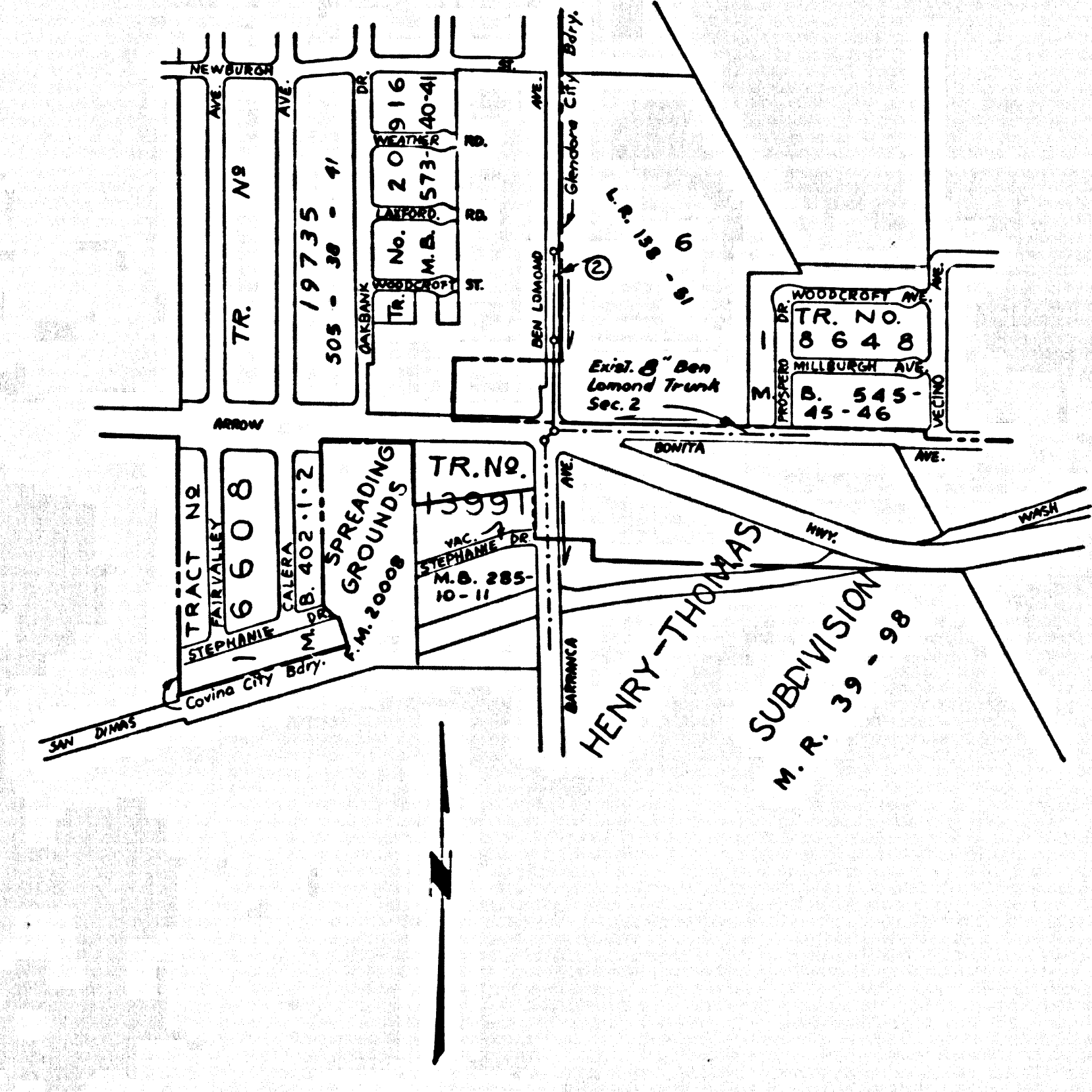

COLLECT CHARGES AS INDICATED
[Signature] 10-27-67

APPROVED BY
[Signature] 10-27-67
 INDUSTRIAL WASTE DIV. DATE

NO CONNECTIONS FOR THE DISPOSAL OF INDUSTRIAL WASTES SHALL BE MADE TO SEWERS SHOWN ON THESE DRAWINGS WITHOUT WRITTEN PERMISSION FROM THE CHIEF ENGINEER AND GENERAL MANAGER OF THE COUNTY SANITATION DISTRICTS.

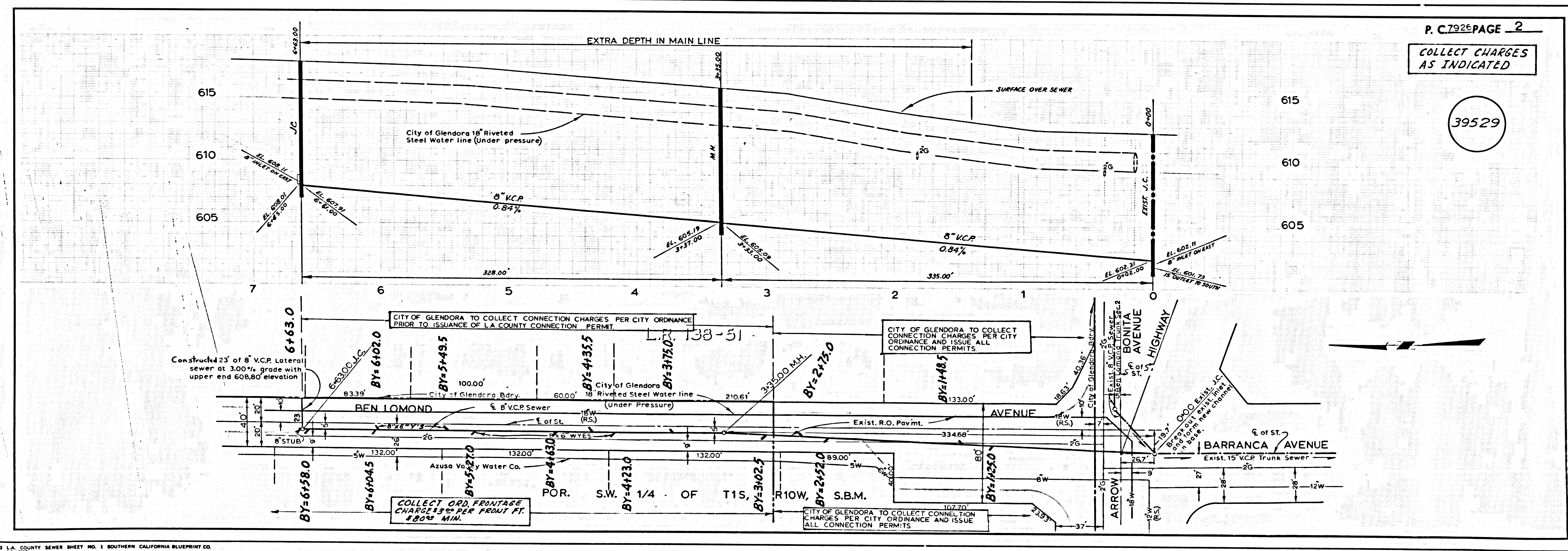

P.C. 7926 PAGE 2
 COLLECT CHARGES AS INDICATED
 39529