

B.M. 1746 ELEV. 390.96
 Rd. Mon. In Well B'n. On C.L. Int.
 Valley Blvd. + Hambledon Ave.
 (Covina Quad)
 BASELINE QUAD. 1965

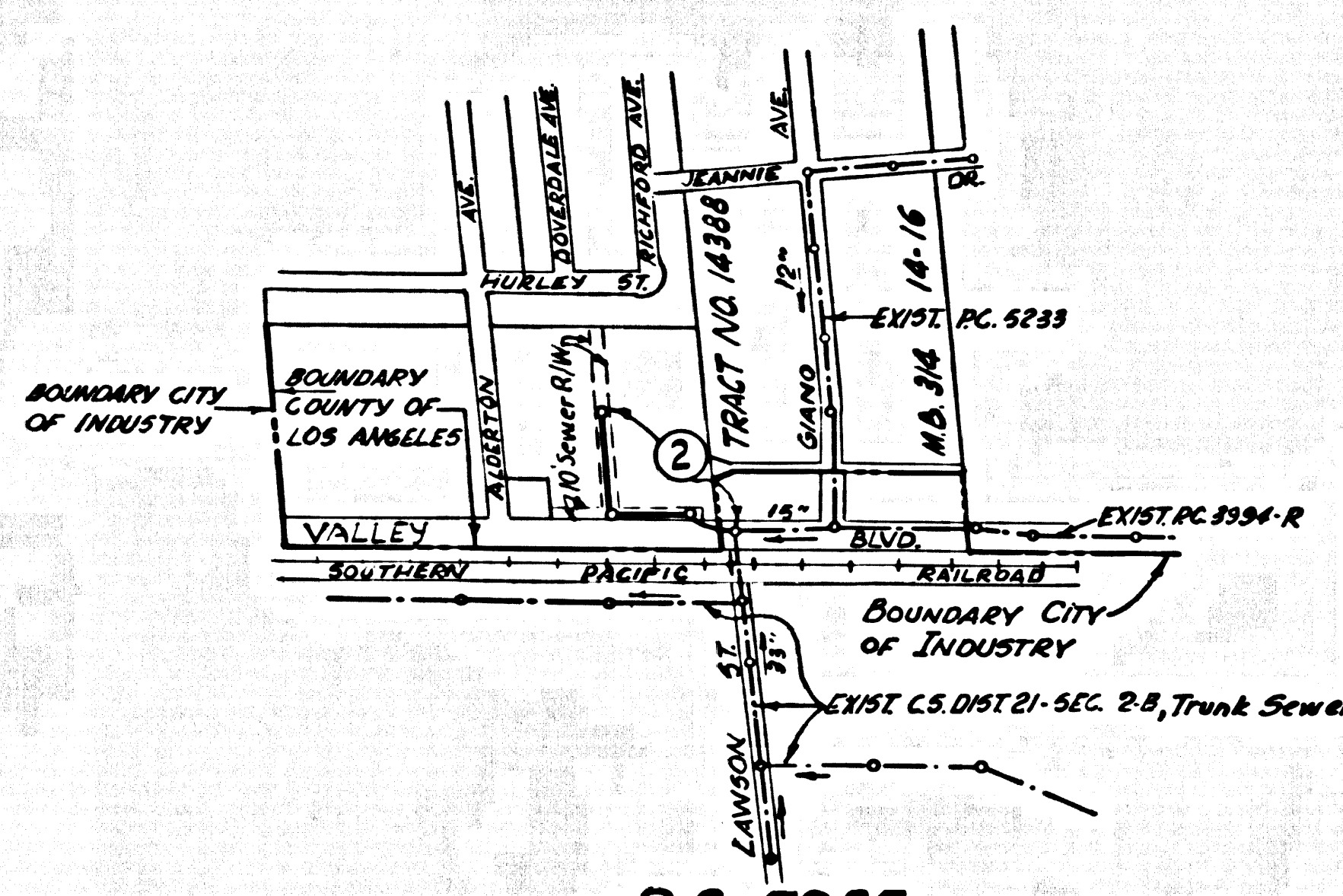

P.C. 7937
 INDEX MAP
 SCALE: 1"=600'

County Sanitation Districts shall be notified prior to the following so that required inspection can be made (Phone: 377-1025):

- (1) Commencement of construction of manhole on District trunk sewer.
- (2) Breaking into existing manhole on District trunk sewer.
- (3) Core drilling District trunk sewer.
- (4) Construction of house connections to District trunk sewer.
- (5) Acceptance of the project.

LA PUENTE BLDG. DIST. NO. 2

PROFILE, ALIGNMENT AND GRADE OF P.C. 7937
 SANITARY SEWERS PAGE 1

VALLEY BLVD.
 PRIVATE CONTRACT NO. 7937
 W.S. #38-C3
 1 SHEETS, 2 PAGES

SCALE: VERT. 1"=4' HORIZ. 1"=40'
 AUGUST 1967

PREPARED BY THE OFFICES OF
 NATIONAL ENGINEERING CO.

39450

W. E. JEFFERSON
 REG. C. E. NO. 5828
 FOR LEGEND SEE PLAN NO. S-1

- NOTES:
1. PROVIDE STAKES ON THE PROPERTY LINE OR PROPERTY LINES PRODUCED AT RIGHT ANGLES TO THE SEWER LINE AT THE CENTER LINE OF EACH MANHOLE.
 2. NO REPRESENTATIVE OF THE COUNTY ENGINEER WILL SURVEY OR LAY OUT ANY PORTION OF THE WORK.
 3. THE PRIVATE ENGINEER SHALL FURNISH THE COUNTY ENGINEER WITH GRADE SHEETS AND STATIONING FOR ALL HOUSE LATERALS AND "T" BRANCHES AND SHALL PROVIDE STAKES FOR THEM AT THEIR PROPER LOCATIONS WITH STATIONING PLAINLY MARKED. ALL HOUSE LATERALS SHALL BE CONSTRUCTED IN A STRAIGHT ALIGNMENT AT RIGHT ANGLES FROM THE MAIN LINE SEWER EXCEPT AS SHOWN ON THE PLANS. HOUSE LATERALS FROM CHIMNEYS SHALL NOT HAVE AN ANGLE OF LESS THAN 45° WITH THE MAIN LINE SEWER. ANY CHANGE IN ALIGNMENT SHALL BE REQUESTED IN WRITING BY THE PRIVATE ENGINEER.
 4. THE PRIVATE ENGINEER SHALL FURNISH THE HOUSE LATERAL DEPTH AT THE PROPERTY LINE BELOW THE TOP OF CURB ELEVATION FOR EACH HOUSE LATERAL ON THE GRADE SHEET.
 5. NO REVISIONS SHALL BE MADE IN THESE PLANS WITHOUT THE APPROVAL OF THE COUNTY ENGINEER.
 6. THE CONTRACTOR SHALL NOTIFY THE CONSTRUCTION DIVISION BY TELEPHONE, MADISON 9-4747, EXT. 8158, AT LEAST TWENTY-FOUR HOURS BEFORE STARTING ANY WORK UNDER THIS CONTRACT.
 7. MANHOLES SHALL BE 8" DIA. CONCRETE RINGS WITH 12" DIA. CONCRETE COVERS PER S-23, TWO FEET ON EACH SIDE FROM THE POINT OF INTERFERENCE.
 8. USE STANDARD MANHOLE FRAMES AND COVERS, S-14.
 9. MANHOLE TOPS IN UNIMPROVED RIGHTS-OF-WAY TO BE SIX INCHES ABOVE FINISHED GRADE.
 10. USE EXTRA STRENGTH PIPE. ALL PIPE IS STANDARD DEPTH EXCEPT AS NOTED.
 11. USE MECHANICAL COMPRESSION JOINTS FOR ALL V.C.P. JOINTS PER SPEC'S, SECS. 34, 40 & 41.
 12. IF A POWER POLE IS WITHIN THREE FEET OF THE SEWER, THE SEWER SHALL BE ENCASED, PER S-23, TWO FEET ON EACH SIDE FROM THE POINT OF INTERFERENCE.
 13. IF DURING THE COURSE OF CONSTRUCTION IT IS DETERMINED THAT THERE IS LESS THAN FOUR FEET OF COVER OVER THE TOP OF A MAIN LINE OR HOUSE LATERAL V.C.P. SEWER WHICH IS NOT INDICATED ON THE PLANS, THE PIPE SHALL BE ENCASED PER S-23, UNLESS OTHERWISE APPROVED BY THE COUNTY ENGINEER.
 14. HOUSE LATERALS TO BE CONSTRUCTED WITH INVERTS AT PROPERTY LINE 6 FEET BELOW CURB GRADE EXCEPT AS NOTED.
 15. RESURFACE ALL TRENCHES WITHIN PAVED AREAS TO MEET L.A. COUNTY ROAD DEPT. OR CALIFORNIA STATE HIGHWAY REQUIREMENTS IN ACCORDANCE WITH PERMITS.
 16. FOR HIGHWAY SAFETY TEST USE FORMULA NO. 2, SPEC'S, SEC. 34.
 17. ALL STATE AND LOCAL TRENCH SAFETY ORDERS WILL BE STRICTLY ENFORCED.
 18. All Structures shall be either brick manholes per S-3 or precast concrete manholes per S-5 or S-6, except as noted.
 19. ALL JOINTS BETWEEN CAST IRON PIPE AND WITRIFIED CLAY PIPE SHALL BE MADE WITH A RUBBER SLEEVE JOINT (WITH HOOP IF NECESSARY) PER STANDARD SPECIFICATIONS, SECTION 36, OR APPROVED EQUAL.
 20. THE CONTRACTOR SHALL SECURE A PERMIT FOR STREET EXCAVATION FROM THE CITY ENGINEER'S OFFICE PRIOR TO COMMENCING CONSTRUCTION IN CITY STREETS AND COMPLY WITH ALL CONDITIONS.

COLLECT CHARGES AS INDICATED
 L. Payne 10-16-67

NO CONNECTIONS FOR THE DISPOSAL OF INDUSTRIAL WASTES SHALL BE MADE TO SEWERS SHOWN ON THESE DRAWINGS WITHOUT WRITTEN PERMISSION FROM THE CHIEF ENGINEER AND GENERAL MANAGER OF THE COUNTY SANITATION DISTRICTS.

REVIEWED:
 Joseph B. Grammel 10-16-67
 Industrial Waste Division

COUNTY OF LOS ANGELES, CALIFORNIA
 JOHN A. LAMBIE, COUNTY ENGINEER J. D. PARKHURST, CHIEF ENGINEER
 CO. SAN. DIST. NO. 1
 APPROVED BY: [Signature] OFFICE ENGINEER

CHECKED BY: [Signature] 10-16-67
 MR. CL. NO. 12483

CITY OF INDUSTRY
 APPROVED: Robert P. Roper 10-19-67
 CITY MANAGER I.N. 0368.66

