

T.B.M. 1, ELEV 3812.33 RDLB 568-25  
 32 1/2' cor. Old Garman School Rd. former  
 Hwy. 99, about 150' SW, 424' ELY of the  
 approx. centerline intersection of the above  
 LIEBRE QUAD. 1965

THE FOLLOWING COUNTY ENGINEER STANDARD PLANS APPLY TO THIS PROJECT

LESSON	3-1
MINIMUM EXCAVATION SAFETY REQUIREMENTS	3-2
BRICK MANHOLE	3-3
BRICK DROP MANHOLE	3-4
NON REINFORCED PRECAST CONCRETE MANHOLE	3-5
REINFORCED PRECAST CONCRETE MANHOLE	3-6
MANHOLE FRAME AND COVER	3-7
STANDARD MANHOLE SET	3-7
BEDDING FOR SEWER PIPE	3-7
PIPE SUPPORT	3-8
ALLOWABLE TRENCH WIDTHS	3-33

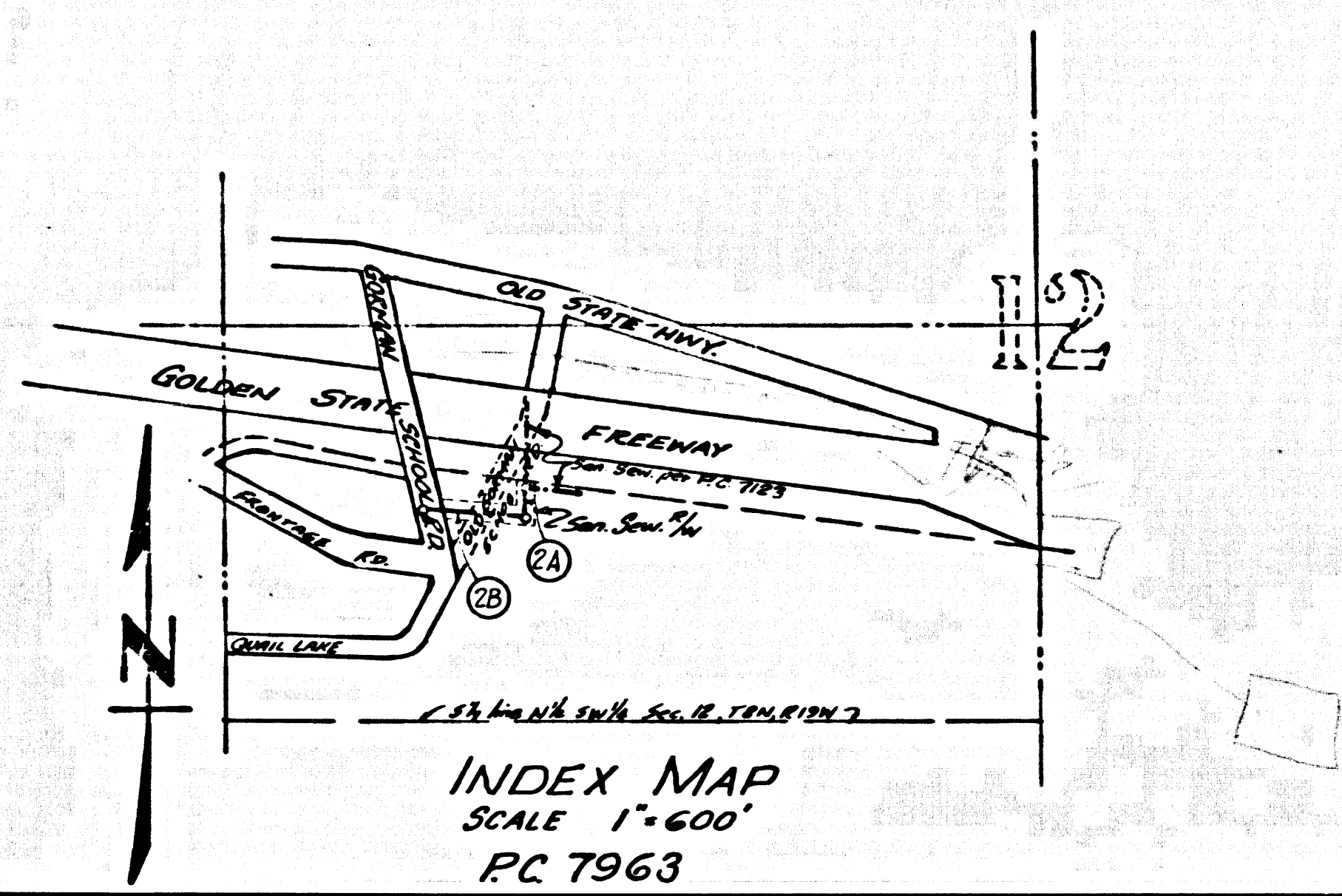

LANCASTER BLDG. DIST. NO. 8

PROFILE ALIGNMENT AND GRADE OF P.C. 7963  
 SANITARY SEWERS PAGE 1  
 TO BE CONSTRUCTED

GULF OIL SEWER  
 PRIVATE CONTRACT NO. 7963

W.S. 17  
 1 SHEETS; 2 PAGES

SCALE: VERT. 1"=4'  
 HORIZ. 1"=40'  
 FEBRUARY, 1968  
 PREPARED IN THE OFFICES OF  
 TRI-STATE ENGINEERING CO., 615-3a Raymond Ave.,  
 Fullerton, California 92621 714-871-9510  
 BY: *Thomas L. Sullivan*  
 REG. C. E. NO. 18827

39962

FOR LEGEND SEE PLAN NO. S-1

- NOTES:
1. PROVIDE STAKES ON THE PROPERTY LINE OR PROPERTY LINES PRODUCED AT RIGHT ANGLES TO THE SEWER LINE AT THE CENTER LINE OF EACH MANHOLE.
  2. NO REPRESENTATIVE OF THE COUNTY ENGINEER WILL SURVEY OR LAY OUT ANY PORTION OF THE WORK.
  3. THE PRIVATE ENGINEER SHALL FURNISH THE COUNTY ENGINEER WITH GRADE SHEETS AND STATIONING FOR ALL HOUSE LATERALS AND Y BRANCHES AND SHALL PROVIDE STAKES FOR THEM AT THEIR PROPER LOCATIONS WITH STATIONING PLAINLY MARKED. ALL HOUSE LATERALS SHALL BE CONSTRUCTED IN A STRAIGHT ALIGNMENT AT RIGHT ANGLES FROM THE MAINLINE SEWER ON THE PLANS. ANY CHANGE IN ALIGNMENT SHALL BE REQUESTED IN WRITING BY THE PRIVATE ENGINEER.
  4. THE PRIVATE ENGINEER SHALL FURNISH THE HOUSE LATERAL DEPTH AT THE PROPERTY LINE BELOW THE TOP OF CURB ELEVATION FOR EACH HOUSE LATERAL ON THE GRADE SHEET.
  5. NO REVISIONS SHALL BE MADE IN THESE PLANS WITHOUT THE APPROVAL OF THE COUNTY ENGINEER.
  6. Y BRANCHES MAY BE USED FOR CONNECTIONS TO MAINLINE SEWERS.
  7. USE EXTRA STRENGTH PIPE. ALL PIPE IS STANDARD DEPTH.
  8. VITRIFIED CLAY PIPE JOINTS SHALL BE TYPE "D", "F" OR "G" PER STAND. SPEC. SEC. 208-2.
  9. RESURFACE ALL TRENCH WITHIN PAVED AREA TO MEET L.A. COUNTY ROAD DEPT. OR CALIF. STATE HIGHWAY REQUIREMENTS IN ACCORDANCE WITH PERMITS.
  10. IF A POWER POLE IS WITHIN 3 FEET OF THE SEWER, THE SEWER SHALL BE ENCASED PER S-3 TWO FEET ON EACH SIDE FROM THE HOUSE LATERALS TO BE CONSTRUCTED WITH INTENTS AT PROPERTY LINE 6 FEET BELOW CURB GRADE EXCEPT AS NOTED.
  11. ALL STRUCTURES SHALL BE BRICK MANHOLES PER S-3 OR PRECAST CONCRETE MANHOLES PER S-5 TO S-6 EXCEPT AS NOTED.
  12. SEWERS TO BE TESTED FOR LEAKAGE PER SECTION 206.2.9.7 STAND. SPECS.
  13. MANHOLE TOPS IN UNIMPROVED RIGHTS-OF-WAY TO BE SIX INCHES ABOVE FINISHED GRADE.
  14. THE CONTRACTOR SHALL NOTIFY THE CONSTRUCTION & STORM DRAIN DIVISION BY TELEPHONE, MADISON 9-470, EXT. 842, AT LEAST TWENTYFOUR HOURS BEFORE STARTING ANY WORK UNDER THIS CONTRACT.
  15. IF DURING THE COURSE OF CONSTRUCTION IT IS DETERMINED THAT THERE IS LESS THAN FOUR FEET OF COVER OVER THE TOP OF A MAINLINE OR HOUSE LATERAL 12" DIA. SEWER WHICH IS NOT INDICATED ON THE PLANS, THE PIPE SHALL BE ENCASED PER S-3.
  16. ALL STATE AND LOCAL TRENCH SAFETY ORDERS SHALL BE STRICTLY ENFORCED.
  17. ALL JOINTS BETWEEN CAST IRON PIPE AND VITRIFIED CLAY PIPE SHALL BE MADE WITH A RUBBER BELLEVUE JOINT, TYPE "C" OR "D" (WHICH BEHINDS IF NECESSARY) PER STAND. SPEC. SEC. 208-2.

NOTE:  
 GRADES TO WHICH THIS IMPROVEMENT IS TO BE CONSTRUCTED ARE SHOWN ON PLANS AND PROFILES. GRADE POINTS FOR TOP OF CURB, CENTER LINE OF STREETS OR CENTER LINE OF ALLEYS ARE SHOWN BY CIRCLES ON PROFILES. AT ALL POINTS BETWEEN DESIGNATED POINTS THE GRADE SHALL BE ESTABLISHED SO AS TO CONFORM TO A STRAIGHT LINE DRAWN BETWEEN SAID DESIGNATED POINTS.  
 ELEVATIONS ARE IN FEET ABOVE U.S. & G.S. SEA LEVEL DATUM OF 1929.  
 THIS DRAWING AND THE DATA HEREON ARE HEREBY MADE A PART OF THE SPECIFICATIONS.  
 BEFORE WORK CAN BE STARTED, THE CONTRACTOR MUST OBTAIN A PERMIT TO EXCAVATE IN COUNTY STREETS FROM THE L.A. COUNTY ROAD DEPT., DISTRICT OFFICE NO. 25, AND MAKE A DEPOSIT WITH THE COUNTY ENGINEER ROOM RECORD PLANS.  
 APPROVAL OF THIS PLAN BY THE COUNTY OF LOS ANGELES DOES NOT CONSTITUTE A REPRESENTATION AS TO THE ACCURACY OF THE LOCATION OF OR THE EXISTENCE OR NON-EXISTENCE OF ANY UNDERGROUND UTILITY PIPE, OR STRUCTURE WITHIN THE LIMITS OF THIS PROJECT. THIS NOTE APPLIES TO ALL PAGES.  
 IF WORK IS TO BE DONE IN A STATE HIGHWAY, A PERMIT MUST BE OBTAINED FROM THE STATE OF CALIFORNIA, DIVISION OF HIGHWAYS, 128 SOUTH SPRING STREET.

APPROVED BY *John A. Lambie*  
 REGIONAL ENGINEER  
 CHECKED BY *Richard K. Kopyevsky* 5/14/68  
 OFFICE OF COUNTY ENGINEER, REG. C. E. NO. 16742

COLLECT CHARGES  
 AS INDICATED  
*John A. Lambie*

J.N. 0368.77

P.C. 7963 PAGE 2

NO CHARGE  
 FOR CONNECTIONS

39963

