

B.M. BY 268 ELEV. 73.475
 4.5 IN IP WITH 1 1/2 IN BACK W.K. ON
 S.E. COR. PARAMOUNT BLVD. &
 ROSECRAUS AVE 2 1/4 FT. S. C/L 50 FT. S.E.
 C/L INT MKD. (LAC 52)
 NORWALK QUAD. 19 65

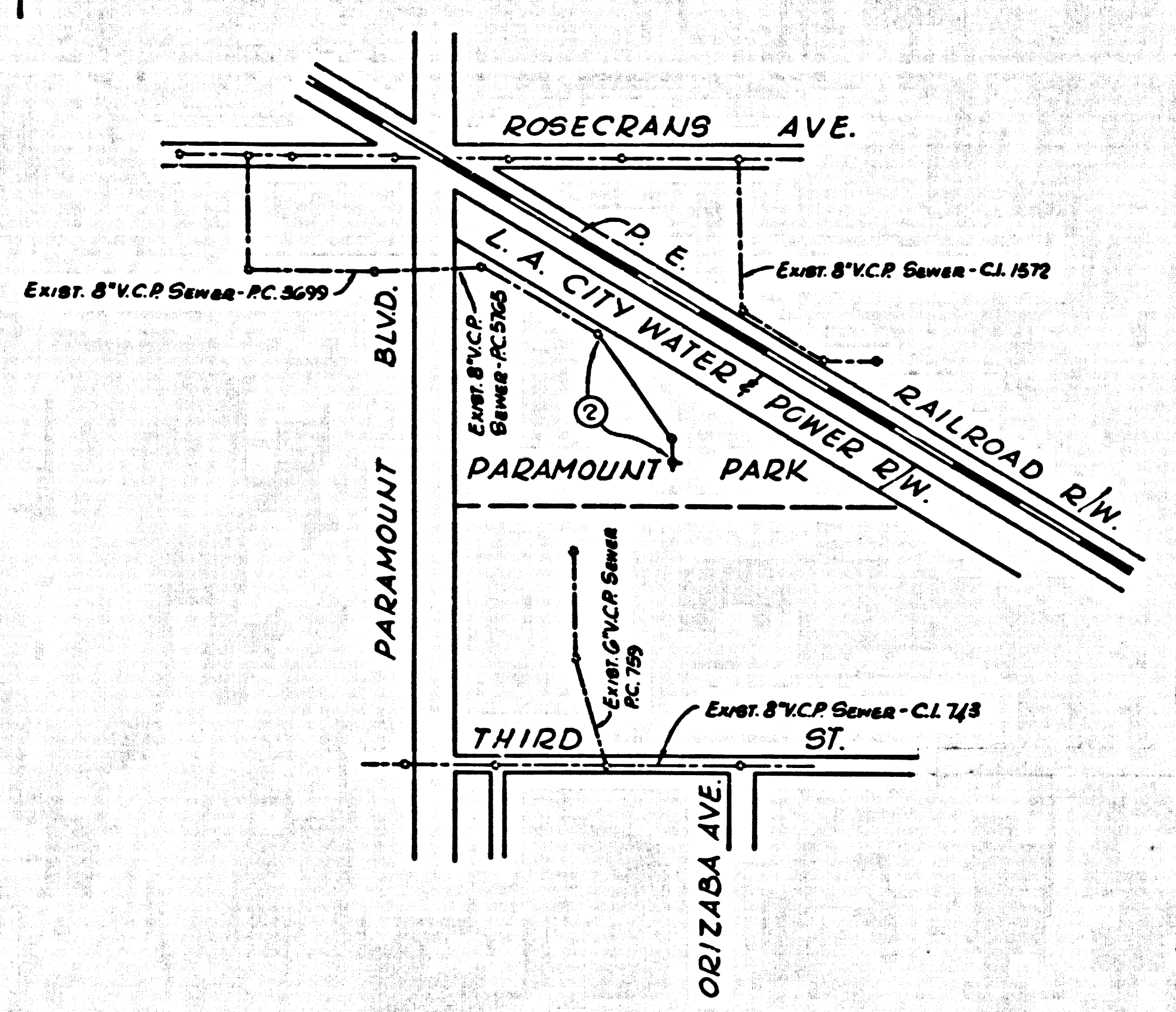

INDEX MAP
 SCALE: 1"=400'
 P.C. 7973

PARAMOUNT BLDG. DIST. NO. 4.04

PROFILE, ALIGNMENT AND GRADE OF
SANITARY SEWERS PAGE 1
 TO BE CONSTRUCTED IN

PARAMOUNT PARK
 PRIVATE CONTRACT NO. 7973

W.S. 52
 1 SHEET 2 PAGES
 SCALE: HORIZ. 1"=40' VERT. 1"=4'
 NOV. 1967
 PREPARED IN THE OFFICES OF
NATIONAL ENGINEERING CO.
 18722 ABBEY ST. - INDUSTRY, CALIF.
 REG. C.E. NO. 5328
 FOR LEGEND SEE PLAN NO. S-1

39477

- NOTES:
- PROVIDE STAKES ON THE PROPERTY LINE OR PROPERTY LINES PRODUCED AT RIGHT ANGLES TO THE SEWER LINE AT THE CENTER LINE OF EACH MANHOLE.
 - NO REPRESENTATIVE OF THE CITY ENGINEER WILL SURVEY OR LAY OUT ANY PORTION OF THE WORK.
 - THE PRIVATE ENGINEER SHALL FURNISH THE CITY ENGINEER WITH GRADE SHEETS AND STATIONINGS FOR ALL HOUSE LATERALS AND "Y" BRANCHES AND SHALL PROVIDE STAKES FOR THEM AT THEIR PROPER LOCATIONS WITH STATIONING PLAINLY MARKED.
 - THE PRIVATE ENGINEER SHALL FURNISH THE HOUSE LATERAL SEPTA AT THE PROPERTY LINE BELOW THE TOP OF CURB ELEVATION FOR EACH HOUSE LATERAL ON THE GRADE SHEET.
 - NO REVISIONS SHALL BE MADE IN THESE PLANS WITHOUT THE APPROVAL OF THE CITY ENGINEER.
 - THE CONTRACTOR SHALL NOTIFY THE CONSTRUCTION DIVISION BY TELEPHONE, MARSHEN 9-4747, EXT. 2158, AT LEAST TWENTY-FOUR HOURS BEFORE STARTING ANY WORK UNDER THIS CONTRACT.
 - MANHOLES SHALL BE BRICK SEWER STRUCTURES PER S.E. SPEC. SEC. 54.
 - USE STANDARD MANHOLE FRAMES AND COVERS, S.I.E. DESIGN-10-11000.
 - USE EXTRA FIBREGLASS PIPE, 18" DIA. JOINTS PER S.P.C.S. SECT. 24, 48 & 49.
 - USE MECHANICAL COMPRESSION JOINTS FOR ALL V.C.P. JOINTS PER S.P.C.S. SECT. 24, 48 & 49.
 - IF A POWER POLE IS WITHIN THREE FEET OF THE SEWER, THE SEWER SHALL BE ENCASED, PER S-25, TWO FEET ON EACH SIDE FROM THE POINT OF INTERFERENCE.
 - IF DURING THE COURSE OF CONSTRUCTION IT IS DETERMINED THAT THERE IS LESS THAN FOUR FEET OF COVER OVER THE TOP OF A MAIN LINE OR HOUSE LATERAL V.C.P. SEWER WHICH IS NOT INDICATED ON THE PLANS, THE PIPE SHALL BE ENCASED PER S-25, UNLESS OTHERWISE APPROVED BY THE CITY ENGINEER.
 - HOUSE LATERAL TO BE CONSTRUCTED AS SHOWN ON PLAN.
 - RESURFACE ALL TRENCHES WITHIN PAVED AREAS TO MEET L.A. COUNTY ROAD DEPT. OR CALIFORNIA STATE HIGHWAY REQUIREMENTS IN ACCORDANCE WITH PLANS.
 - FOR ALLOWABLE DAMAGE TEST USE FORMULA NO. 2, S.P.C.S., SEC. 54.
 - ALL STATE AND LOCAL TRENCH SAFETY ORDERS WILL BE STRICTLY ENFORCED.

REVISION #1 12-13-67
 Revised alignment of 8" V.C.P. Sewer from Sta. 2100 to Sta. 5176
 4' feet Southwesterly
 APPROVED: *Orville E. McCollum* 12/15/67
 Office of City Engineer R.E. No. 15971

NO CONNECTIONS FOR THE DISPOSAL OF INDUSTRIAL WASTES SHALL BE MADE TO SEWERS SHOWN ON THESE DRAWINGS WITHOUT WRITTEN PERMISSION FROM THE CHIEF ENGINEER AND GENERAL MANAGER OF THE COUNTY SANITATION DISTRICTS.

REVIEWED BY INDUSTRIAL WASTE BY: *J.C. Parker*

NO CHARGE FOR CONNECTIONS
 Reason: O. 2 Lines 11-6-67.

County Sanitation Districts shall be notified prior to the following so that required inspection can be made (Phone: 636-3097):

- Commencement of construction of manholes on District trunk sewer.
- Breaking into existing manhole on District sewer.
- Core setting District trunk sewer.
- Construction of house connections to District trunk sewer.
- Acceptance of the project.

NOTES:
 SEWERS TO WHICH THIS IMPROVEMENT IS TO BE CONSTRUCTED ARE SHOWN ON PLANS AND PROFILES. GRADE POINTS FOR TOP OF CURB, CENTER LINE OF STREETS, OR CENTER LINE OF ALLEYS ARE SHOWN BY CIRCLES ON PROFILES. AT ALL POINTS BETWEEN DESIGNATED POINTS THE GRADE SHALL BE ESTABLISHED SO AS TO CONFORM TO A STRAIGHT LINE BETWEEN SAID DESIGNATED POINTS.
 ELEVATIONS ARE IN FEET ABOVE U.S.C. & G.S. MEAN LEVEL, BATHING OF 1929.
 THE DRAWINGS AND THE DATA HEREON ARE HEREBY MADE A PART OF THE SPECIFICATIONS. AMENDED WORK SHALL BE CONSTRUCTED ACCORDING TO SPECIFICATIONS DATED MAY 25, 1962 AS A - ON FILE IN THE OFFICE OF THE CITY ENGINEER AND SHALL BE PROTECTED ONLY BY THE PRESENCE OF THE CITY ENGINEER OR HIS ASSISTANT. NO WORK SHALL BE STARTED UNTIL THE CONTRACTOR HAS OBTAINED A CONSTRUCTION INSPECTION FROM THE CITY ENGINEER, 3957 E. FLOWER STREET, GLEN PLANO, CALIF.

APPROVAL OF THIS PLAN BY THE CITY OF PARAMOUNT DOES NOT CONSTITUTE A REPRESENTATION AS TO THE ACCURACY OF THE LOCATION OR OF THE EXISTENCE OR NON-EXISTENCE OF ANY UNDERGROUND UTILITY PIPE, OR STRUCTURE WITHIN THE LIMITS OF THE PROJECT. THIS NOTE APPLIES TO ALL PAGES.
 IF WORK IS TO BE DONE IN A STATE HIGHWAY, A PERMIT MUST BE OBTAINED FROM THE STATE OF CALIFORNIA, DIVISION OF HIGHWAYS, 120 SOUTH SPRING STREET, LOS ANGELES, CALIFORNIA.

CITY OF PARAMOUNT, CALIFORNIA
 JOHN A. LAMBE, CITY ENGINEER J. D. PARKER, CHIEF ENGINEER
 CO. SAN. DIST. NO. 2
 APPROVED BY: *Orville E. McCollum* APPROVED BY: *J. D. Parker*
 LOS ANGELES REGIONAL ENGINEER OFFICE ENGINEER

CHECKED BY: *Orville E. McCollum* 1/4/67
 REG. C.E. NO. 15931

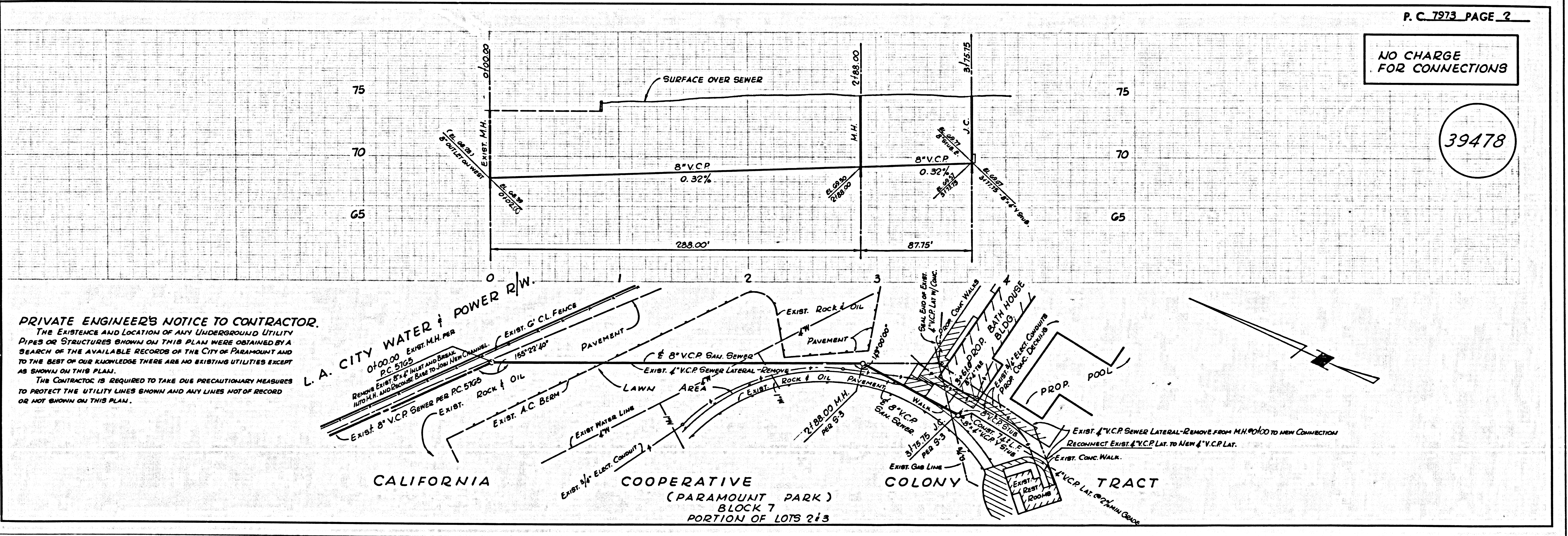

NO CHARGE FOR CONNECTIONS

39478

PRIVATE ENGINEER'S NOTICE TO CONTRACTOR.
 THE EXISTENCE AND LOCATION OF ANY UNDERGROUND UTILITY PIPES OR STRUCTURES SHOWN ON THIS PLAN WERE OBTAINED BY A SEARCH OF THE AVAILABLE RECORDS OF THE CITY OF PARAMOUNT AND TO THE BEST OF OUR KNOWLEDGE THERE ARE NO EXISTING UTILITIES EXCEPT AS SHOWN ON THIS PLAN.
 THE CONTRACTOR IS REQUIRED TO TAKE DUE PRECAUTIONARY MEASURES TO PROTECT THE UTILITY LINES SHOWN AND ANY LINES NOT OF RECORD OR NOT SHOWN ON THIS PLAN.

