

B.M. BY 6625 ELEV. 282.240
 RD BM Tag E. curb N. B.C.R. at N.E.
 cor. San Gabriel Blvd & Graves Ave 60'.
 N. 40' E. approx. E. int.
 Whittier QUAD. 1965.

CITY OF ROSEMEAD BLDG. DIST. NO. 5.07

PROFILE ALIGNMENT AND GRADE OF P.C. 7993
 SANITARY SEWERS PAGE 1
 TO BE CONSTRUCTED IN

TRACT NO. 19922
 PRIVATE CONTRACT NO. 7993

W.S. 38, D-1
 1 SHEETS, 2 PAGES
 SCALE: VERT. 1"=4'
 HORIZ. 1"=40'
 MARCH, 1968
 39745
 PREPARED IN THE OFFICES OF
ABELL & COUGHLIN ENGINEERS
 JOHN B. ABELL REG. C.E. NO. 3070
 FOR LEGEND SEE PLAN NO. S-1

THE FOLLOWING CITY ENGINEER STANDARD PLANS APPLY TO THIS PROJECT:

LEAKS	5-1
MINIMUM EXCAVATION SAFETY REQUIREMENTS	5-2
BRICK MANHOLE	5-3
ROOF REINFORCED PRECAST CONCRETE MANHOLE	5-4
REINFORCED PRECAST CONCRETE MANHOLE	5-5
MANHOLE FRAME AND COVER	5-6
MANHOLE STEP	5-7
REINFORCING FOR SEWER PIPE	5-8
CRAWLING AND ENCASING	5-9
ALLOWABLE TRENCH WIDTHS	5-10
WYE OF TEE SUPPORT	5-11

- NOTES:
- PROVIDE STAKES ON THE PROPERTY LINE OR PROPERTY LINES PRODUCED AT RIGHT ANGLES TO THE SEWER LINE AT THE CENTER LINE OF EACH MANHOLE.
 - NO REPRESENTATIVE OF THE CITY ENGINEER WILL SURVEY OR LAY OUT ANY PORTION OF THE WORK.
 - THE PRIVATE ENGINEER SHALL FURNISH THE CITY ENGINEER WITH GRADE SHEETS AND STATIONING FOR ALL HOUSE LATERALS AND TRUNKS AND SHALL PROVIDE STAKES FOR THEM AT THESE PROPER LOCATIONS WITH STATIONING PLAINLY MARKED. ALL HOUSE LATERALS SHALL BE CONSTRUCTED IN A STRAIGHT ALIGNMENT AT RIGHT ANGLES FROM THE MAIN LINE SEWER EXCEPT AS SHOWN ON THE PLANS. HOUSE LATERALS FROM CHIMNEYS SHALL NOT HAVE AN ANGLE OF LESS THAN 45° WITH THE MAIN LINE SEWER. ANY CHANGE IN ALIGNMENT SHALL BE REQUESTED IN WRITING BY THE PRIVATE ENGINEER.
 - THE PRIVATE ENGINEER SHALL FURNISH THE HOUSE LATERAL DEPTH AT THE PROPERTY LINE BELOW THE TOP OF CURB ELEVATION FOR EACH HOUSE LATERAL ON THE GRADE SHEET.
 - NO REVISIONS SHALL BE MADE IN THESE PLANS WITHOUT THE APPROVAL OF THE CITY ENGINEER.
 - THE CONTRACTOR SHALL NOTIFY THE CONSTRUCTION DIVISION BY TELEPHONE, MADISON 9-4747, EXT. 8158, AT LEAST TWENTY-FOUR HOURS BEFORE STARTING ANY WORK UNDER THIS CONTRACT.
 - ALL STRUCTURES SHALL BE EITHER BRICK MANHOLES PER 5-3 OR PRE-CAST CONCRETE MANHOLES PER 5-4 OR 5-5, EXCEPT AS NOTED.
 - USE STANDARD MANHOLE FRAMES AND COVERS, 5-18, EXCEPT AS NOTED.
 - MANHOLE TOPS IN UNIMPROVED RIGHTS-OF-WAY TO BE SIX INCHES ABOVE FINISHED GRADE.
 - USE EXTRA STRENGTH PIPE. ALL PIPE IS STANDARD DEPTH EXCEPT AS NOTED.
 - WITHEDED CLAY PIPE JOINTS SHALL BE TYPE "D", "E", OR "F" PER STANDARD SPECIFICATIONS SECTION 208-2.
 - "TIE" BRANCHES MAY BE USED INSTEAD OF "WYE" BRANCHES IN ALL LOCATIONS EXCEPT AS NOTED.
 - IF A POWER POLE IS WITHIN THREE FEET OF THE SEWER, THE SEWER SHALL BE ENCASED, PER 5-23, TWO FEET ON EITHER SIDE FROM THE POINT OF INTERFERENCE.
 - IF DURING THE COURSE OF CONSTRUCTION IT IS DETERMINED THAT THERE IS LESS THAN FOUR FEET OF COVER OVER THE TOP OF A MAIN LINE OR HOUSE LATERAL V.C.P. SEWER WHICH IS NOT INDICATED ON THE PLANS, THE PIPE SHALL BE ENCASED PER 5-23 UNLESS OTHERWISE APPROVED BY THE CITY ENGINEER.
 - HOUSE LATERALS TO BE CONSTRUCTED WITH INVERTS AT PROPERTY LINE... FEET BELOW CURB GRADE EXCEPT AS NOTED.
 - RESURFACE ALL TRENCHES WITHIN PAVED AREAS TO MEET L.A. COUNTY ROAD DEPT. OR CALIFORNIA STATE HIGHWAY REQUIREMENTS IN ACCORDANCE WITH PERMITS.
 - SEWERS TO BE TESTED FOR LEAKAGE PER SECTION 208-2.5.7 STANDARD SPECIFICATIONS.
 - ALL STATE AND LOCAL TRENCH SAFETY DEPARTS WILL BE STRICTLY ENFORCED.
 - FIGURES IN CIRCLES AT END OF HOUSE LATERALS INDICATE HOUSE LATERALS SHALL BE CONSTRUCTED WITH 1/2" RISE PER FOOT TO PROPERTY LINE.
 - ALL JOINTS BETWEEN CAST IRON PIPE AND WITHEDED CLAY PIPE SHALL BE MADE WITH A RUBBER SLEEVE JOINT, TYPE "C" OR "D" (WITH BUSHING IF NECESSARY) PER STANDARD SPECIFICATIONS, SECTION 208-2.
 - NOTE: THE CONTRACTOR SHALL NOTIFY MR. CHRISTIANSEN OF THE METROPOLITAN WATER DISTRICT, PHONE 426-4222, EXT. 418, AT LEAST 48 HOURS PRIOR TO ANY WORK IN THE VICINITY OF THE DISTRICT'S 72" PIPELINE IN GRAVES AVENUE.

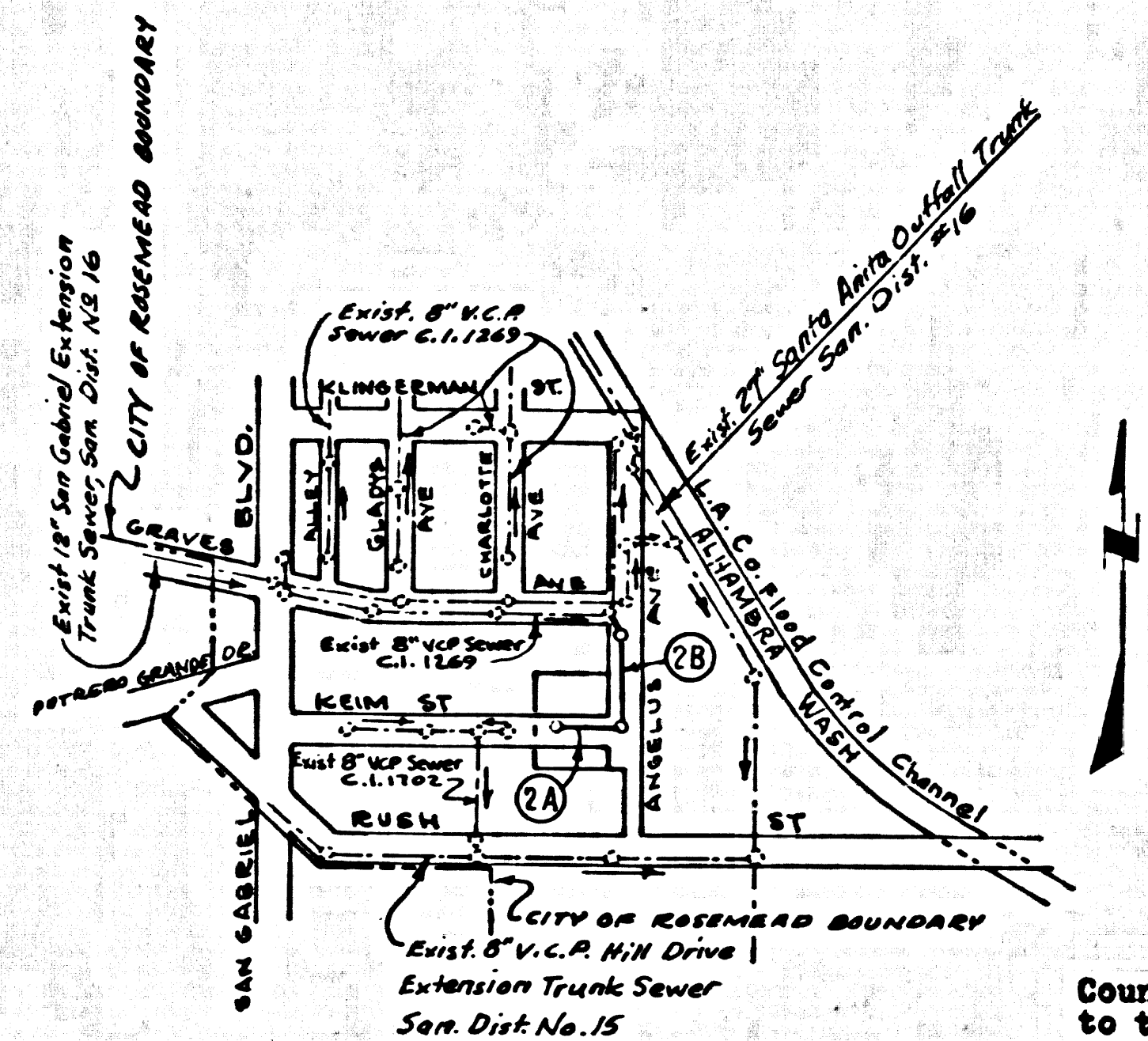

INDEX MAP
 SCALE: 1"=600'
 P.C. 7993

County Sanitation Districts shall be notified prior to the following so that required inspection can be made (Phone: 337-1026)

- Commencement of construction of manhole on District trunk sewer.
- Breaking into existing manhole on District trunk sewer.
- Core drilling District trunk sewer.
- Construction of house connections to District trunk sewer.
- Acceptance of the project.

COLLECT CHARGES AS INDICATED

NO CONNECTIONS FOR THE DISPOSAL OF INDUSTRIAL WASTES SHALL BE MADE TO SEWERS SHOWN ON THESE DRAWINGS WITHOUT WRITTEN PERMISSION FROM THE CHIEF ENGINEER AND GENERAL MANAGER OF THE COUNTY SANITATION DISTRICTS.

CITY OF ROSEMEAD, CALIFORNIA
 JOHN A. LAMBE, CITY ENGINEER
 APPROVED BY: *Edmond W. Kuegel* REGIONAL ENGINEER
 J. D. PARKHURST, CHIEF ENGINEER
 APPROVED BY: *J. D. Parkhurst* OFFICE ENGINEER

CHECKED BY: *John B. Abell*
 3-5-68 REG. C.E. NO. 7862

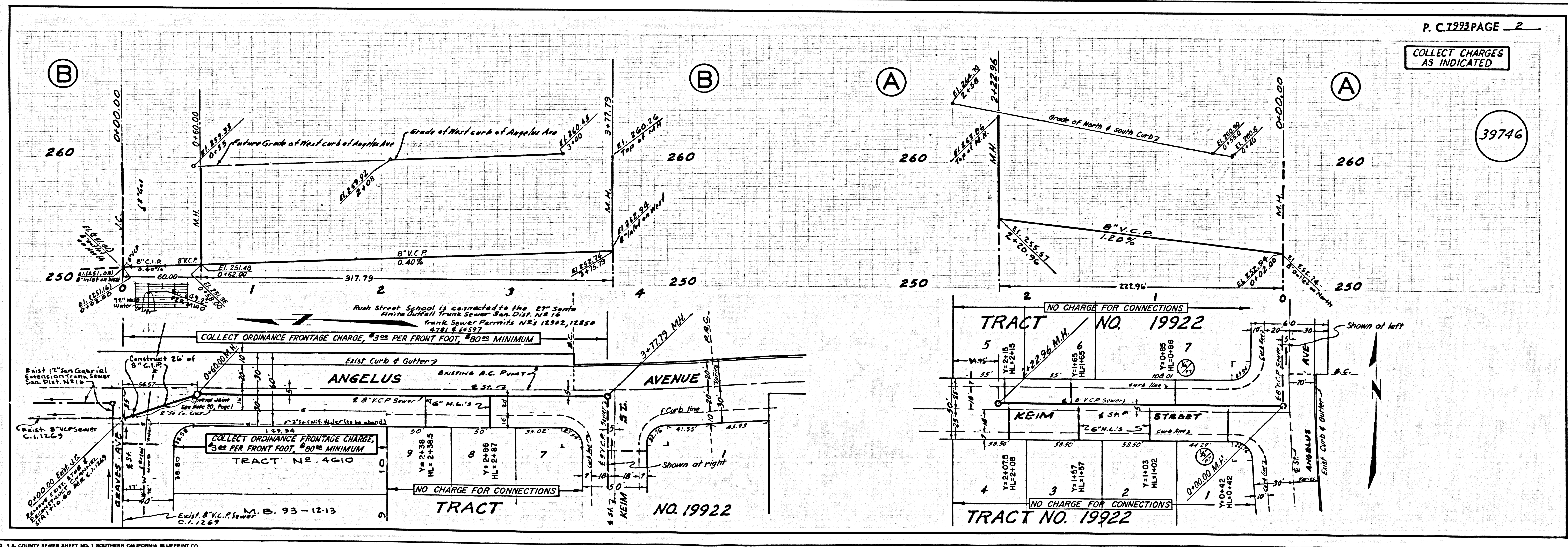

P.C. 7993 PAGE 2

COLLECT CHARGES AS INDICATED

39746