

B.M. S.D. # 2138 ELEV. 153.033  
 BOAT SPIKE IN WEST CURB TUBEWAY  
 AVENUE APPROX 535 FEET S/O &  
 SMITHWAY ST. & ABOUT 5 FEET N/O A.F.H.  
 F.D. 2524-30

NO CONNECTIONS FOR THE DISPOSAL OF  
 INDUSTRIAL WASTES SHALL BE MADE TO  
 SEWERS SHOWN ON THESE DRAWINGS  
 WITHOUT WRITTEN PERMISSION FROM THE  
 CHIEF ENGINEER AND GENERAL MANAGER  
 OF THE COUNTY SANITATION DISTRICTS.

- County Sanitation Districts shall be notified prior  
 to the following so that required inspection can be  
 made (Phone \_\_\_\_\_)
- (1) Commencement of construction of manhole on District trunk sewer.
  - (2) Breaking into existing manhole on District trunk sewer.
  - (3) Core drilling District trunk sewer.
  - (4) Construction of house connections to District trunk sewer.
  - (5) Acceptance of the project.

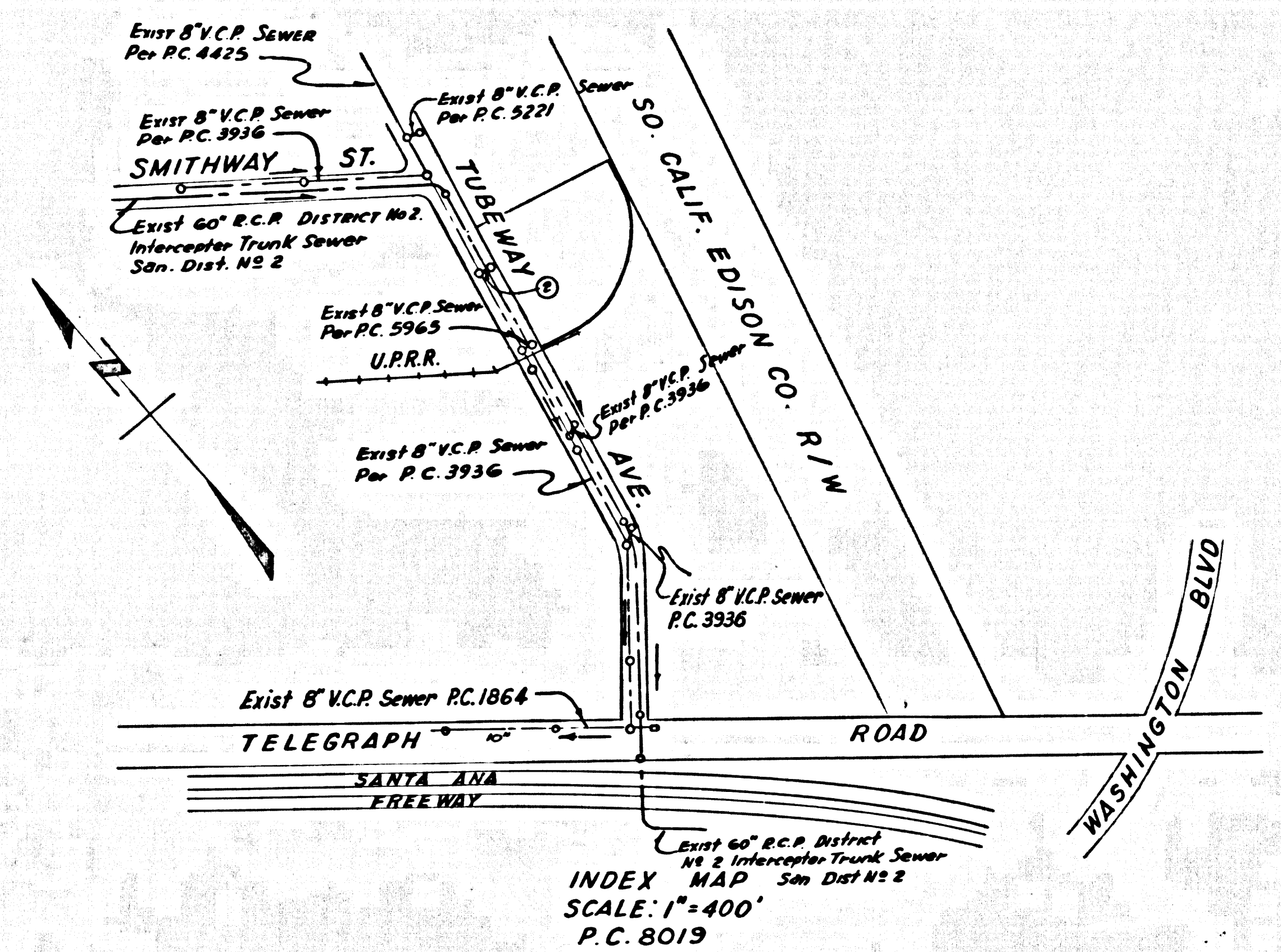

INDEX MAP  
 SCALE: 1" = 400'  
 P.C. 8019

COMMERCE BLDG. DIST. NO. 6.01

- NOTES
1. PROVIDE STAKES ON THE PROPERTY LINE OR PROPERTY LINES PRODUCED AT RIGHT ANGLES TO THE SEWER LINE AT THE CENTER LINE OF EACH MANHOLE.
  2. NO REPRESENTATIVE OF THE CITY ENGINEER WILL SURVEY OR LAY OUT ANY PORTION OF THE WORK.
  3. THE PRIVATE ENGINEER SHALL FURNISH THE CITY ENGINEER WITH GRADE SHEETS AND STATIONING FOR ALL HOUSE LATERALS AND "T" OR "Y" BRANCHES AND SHALL PROVIDE STAKES FOR THESE AT THEIR PROPER LOCATIONS WITH STATIONING PLAINLY MARKED. ALL HOUSE LATERALS SHALL BE CONSTRUCTED IN A STRAIGHT ALIGNMENT AT RIGHT ANGLES FROM THE MAIN LINE SEWER EXCEPT AS SHOWN ON THE PLANS. HOUSE LATERALS FROM CHIMNEYS SHALL NOT HAVE AN ANGLE OF LESS THAN 45° WITH THE MAIN LINE SEWER. ANY CHANGE IN ALIGNMENT SHALL BE REQUESTED IN WRITING BY THE PRIVATE ENGINEER.
  4. THE PRIVATE ENGINEER SHALL FURNISH THE HOUSE LATERAL DEPTH AT THE PROPERTY LINE BELOW THE TOP OF CURB ELEVATION FOR EACH HOUSE LATERAL ON THE GRADE SHEET.
  5. NO REVISIONS SHALL BE MADE IN THESE PLANS WITHOUT THE APPROVAL OF THE CITY ENGINEER.
  6. THE CONTRACTOR SHALL NOTIFY THE CONSTRUCTION DIVISION BY TELEPHONE, MADISON 9-487, EXT. 8151, AT LEAST TWENTY-FOUR HOURS BEFORE STARTING ANY WORK UNDER THE CONTRACT.
  7. ALL STRUCTURES SHALL BE EITHER BRICK MANHOLES PER S-3 OR PRECAST CONCRETE MANHOLES PER S-3 OR S-6, EXCEPT AS NOTED.
  8. "T" OR "Y" BRANCHES MAY BE USED FOR CONNECTIONS TO MAINLINE SEWERS EXCEPT AS NOTED.
  9. MANHOLE TOPS IN UNIMPROVED RIGHTS-OF-WAY TO BE 24 INCHES ABOVE FINISHED GRADE.
  10. USE EXTRA STRENGTH PIPE. ALL PIPE IS STANDARD DEPTH EXCEPT AS NOTED.
  11. VITRIFIED CLAY PIPE JOINTS SHALL BE TYPE "C" OR "D" PER STD. SPEC. SEC. 505 - 2.
  12. IF A POWER POLE IS WITHIN THREE FEET OF THE SEWER, THE SEWER SHALL BE ENCASED PER S-23, TWO FEET ON EACH SIDE FROM THE POINT OF INTERFERENCE.
  13. IF DURING THE COURSE OF CONSTRUCTION IT IS DETERMINED THAT THERE IS LESS THAN FOUR FEET OF COVER OVER THE TOP OF A MAIN LINE OR HOUSE LATERAL V.C.P. SEWER WHICH IS NOT INDICATED ON THE PLANS, THE PIPE SHALL BE ENCASED PER S-23, UNLESS OTHERWISE APPROVED BY THE CITY ENGINEER.
  14. HOUSE LATERALS TO BE CONSTRUCTED WITH INVERTS AT PROPERTY LINE 6 FEET BELOW CURB GRADE EXCEPT AS NOTED.
  15. RESURFACE ALL TRENCHES WITHIN PAVED AREAS TO MEET L.A. COUNTY ROAD DEPT. OR CALIFORNIA STATE HIGHWAY REQUIREMENTS IN ACCORDANCE WITH PERMITS.
  16. SEWERS TO BE TESTED FOR LEAKAGE PER SECTION 306-2.5.7 STANDARD SPECIFICATIONS.
  17. ALL STATE AND LOCAL TRENCH SAFETY ORDERS WILL BE STRICTLY ENFORCED.
  18. ALL JOINTS BETWEEN CAST IRON PIPE AND VITRIFIED CLAY PIPE SHALL BE MADE WITH A RUBBER BLEEVE JOINT, TYPE "C" OR "D" (WITH BUSHING IF NECESSARY) PER STANDARD SPECIFICATIONS, SECTION 505 - 2.
  19. SEWER PIPE BEDDING SHALL CONFORM TO S-9.
- THE FOLLOWING CITY ENGINEER STANDARD PLANS APPLY TO THIS PROJECT:

LEGEND	S-1
MINIMUM EXCAVATION SAFETY REQUIREMENTS	S-2
BRICK MANHOLE	S-3
NON-REINFORCED PRECAST CONCRETE MANHOLE	S-4
REINFORCED PRECAST CONCRETE MANHOLE	S-5
MANHOLE FRAME AND COVER	S-6
MANHOLE STEP	S-7
RECORDS FOR SEWER PIPE	S-8
CHASING AND ENCASEMENT	S-23
W/E ON THE SURF	S-24
ALLOWABLE TRENCH WIDTHS	S-25

COLLECT CHARGES  
 AS INDICATED

PROFILE, ALIGNMENT AND GRADE OF  
 SANITARY SEWERS PAGE 1

TUBEWAY AVENUE CROSSING  
 PRIVATE CONTRACT NO. 8019

W.S. 36, B-4  
 1 SHEETS, 2 PAGES

SCALE: HORIZ. 1" = 40' VERT. 1" = 4'  
 FEBRUARY, 1968

PREPARED IN THE OFFICES OF  
 THOMSEN ENGINEERING, INC.

FOR LEGEND SEE PLAN NO. S-1

NOTE:  
 GRADES TO WHICH THIS IMPROVEMENT IS TO BE CONSTRUCTED ARE SHOWN ON PLANS AND PROFILES. GRADE POINTS FOR TOP OF CURBS, CENTER LINE OF STREETS, OR CENTER LINE OF ALLEYS ARE SHOWN BY CIRCLES ON PROFILES. AT ALL POINTS BETWEEN DESIGNATED POINTS THE GRADE SHALL BE ESTABLISHED SO AS TO CONFORM TO A STRAIGHT LINE DRAWN BETWEEN SAID DESIGNATED POINTS. ELEVATIONS ARE IN FEET ABOVE U.S.C. & G.S. SEA LEVEL DATUM OF 1929.  
 THIS DRAWING AND THE DATA HEREON ARE HEREBY MADE A PART OF THE SPECIFICATIONS.  
 BEFORE WORK CAN BE STARTED, THE CONTRACTOR MUST OBTAIN A PERMIT TO EXCAVATE IN CITY STREETS FROM THE L.A. COUNTY ROAD DEPT., DISTRICT OFFICE NO. 1, AND MAKE A DEPOSIT WITH THE CITY OF COMMERCE, 2345 COMMERCE BLVD., CITY OF COMMERCE, CALIFORNIA, \$100.00 TO COVER THE COST OF CONSTRUCTION INSPECTION AND RECORD PLANS.  
 APPROVAL OF THIS PLAN BY THE CITY OF COMMERCE DOES NOT CONSTITUTE A REPRESENTATION AS TO THE ACCURACY OF THE LOCATION OF OR THE EXISTENCE OR NON-EXISTENCE OF ANY UNDERGROUND UTILITY PIPE, OR STRUCTURE WITHIN THE LIMITS OF THE PROJECT. THIS NOTE APPLIES TO ALL PAGES.  
 IF WORK IS TO BE DONE IN A STATE HIGHWAY, A PERMIT MUST BE OBTAINED FROM THE STATE OF CALIFORNIA, DIVISION OF HIGHWAYS, 130 SOUTH SPRING STREET, LOS ANGELES, CALIFORNIA.

CITY OF COMMERCE, CALIFORNIA  
 JOHN A. LAMBIE, CITY ENGINEER J. D. PARKHURST, CHIEF ENGINEER  
 CO. SEAL 54111072

APPROVED BY: *Edwin W. Keigel* REGIONAL ENGINEER APPROVED BY: *John A. Lambie* OFFICE ENGINEER  
 CHECKED BY: *John A. Lambie* M.C. NO. 1872

39663

P. C. 8019 PAGE 2

NO CHARGE FOR CONNECTION

39664

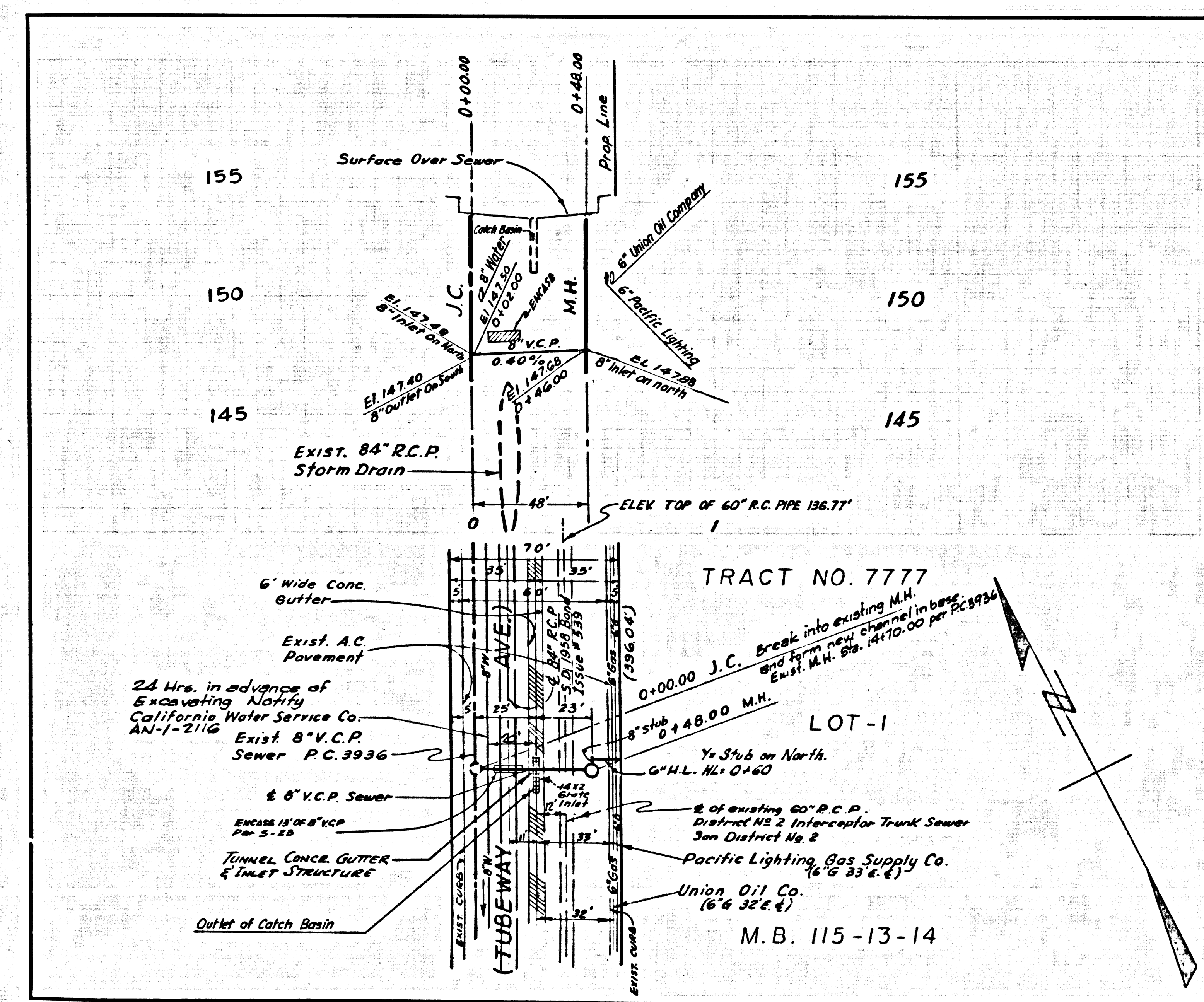

TRACT NO. 7777  
 LOT-1  
 M.B. 115-13-14

24 hrs. in advance of excavating notify California Water Service Co. AN-1-2116  
 Exist. 8" V.C.P. Sewer P.C. 3936  
 6" V.C.P. Sewer  
 ENCASE 18" 8" V.C.P. PER S-23  
 TUNNEL CONC. GUTTER & TRAP STRUCTURE  
 Outlet of Catch Basin

6" Wide Conc. Gutter  
 Exist. A.C. Pavement  
 Break into existing M.H. 8" V.C.P. Sewer P.C. 3936  
 0+00.00 J.C. Break into existing M.H. 8" V.C.P. Sewer P.C. 3936  
 8" V.C.P. Sewer P.C. 3936  
 1/2 3/4 on North  
 6" H.L. N6 0+60  
 6" of existing 60" R.C.P. District No. 2 Interceptor Trunk Sewer San District No. 2  
 Pacific Lighting Gas Supply Co. 16 1/2 23 1/2 4 1/2  
 Union Oil Co. (6 1/2 32 1/2 4 1/2)