

B.M. BY 760 ELEV. 30.101
 L&T. ON SOUTH CURB OF CARSON ST. 40' 50" 1/4 34' EAST OF W. CURB OF CLARETTA AVE. PROD. #1 W/O CURB ARTESIA QUAD. 1965 ADJ.

- County Sanitation Districts shall be notified prior to the following so that required inspection can be made (Phone No. 639-7177)
- (1) Commencement of construction of manhole on District trunk sewer.
 - (2) Breaking into existing manhole on District trunk sewer.
 - (3) Core Sampling District trunk sewer.
 - (4) Construction of house connections to District trunk sewer.
 - (5) Acceptance of the project.

NO CONNECTIONS FOR THE DISPOSAL OF INDUSTRIAL WASTES SHALL BE MADE TO SEWERS SHOWN ON THESE DRAWINGS WITHOUT WRITTEN PERMISSION FROM THE CHIEF ENGINEER AND GENERAL MANAGER OF THE COUNTY SANITATION DISTRICTS.

THE FOLLOWING CITY ENGINEER STANDARD PLANS APPLY TO THIS PROJECT.

LEGEND --	S-1
MINIMUM EXCAVATION SAFETY REQUIREMENTS	S-2
BRICK MANHOLE	S-3
NON-REINFORCED PRECAST CONCRETE MANHOLE	S-5
REINFORCED PRECAST CONCRETE MANHOLE	S-6
MANHOLE FRAME AND COVER	S-15
STANDARD MANHOLE STEP	S-17
BEDDING FOR SEWER PIPE	S-21
WYE SUPPORT	S-26
SADDLES	S-28
ALLOWABLE TRENCH WIDTHS	S-33

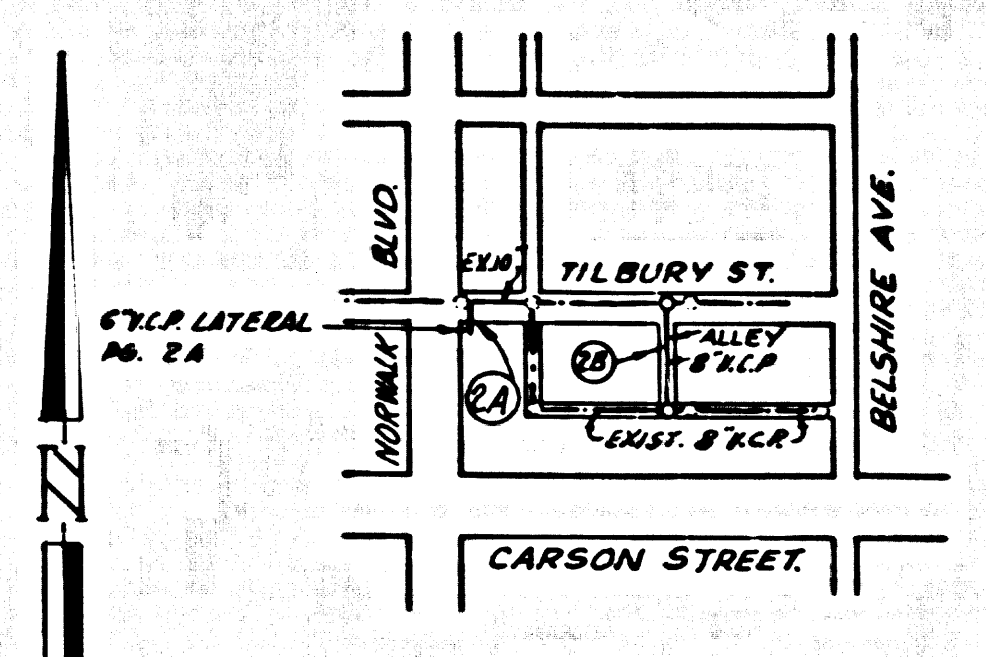

INDEX MAP
 SCALE: 1"=400'
 1st. ALLEY EAST OF NORWALK BLVD.
 P.C. NO. 8029

DO NOT ISSUE HOUSE CONNECTION PERMITS TO THE SEWER SHOWN ON PAGE 2B UNTIL THE ALLEY HAS BEEN DEDICATED.

HAWAIIAN GARDENS BLDG. DIST. NO. 4.03

- NOTES:
1. PROVIDE STAKES ON THE PROPERTY LINE OR PROPERTY LINES PRODUCED AT RIGHT ANGLES TO THE SEWER LINE AT THE CENTER LINE OF EACH MANHOLE.
 2. NO REPRESENTATIVE OF THE CITY ENGINEER WILL SURVEY OR LAY OUT ANY PORTION OF THE WORK.
 3. THE PRIVATE ENGINEER SHALL FURNISH THE CITY ENGINEER WITH GRADE SHEETS AND STATIONING FOR ALL HOUSE LATERALS AND "T" OR "Y" BRANCHES AND SHALL PROVIDE STAKES FOR THEM AT THEIR PROPER LOCATIONS WITH STATIONING PLAINLY MARKED. ALL HOUSE LATERALS SHALL BE CONSTRUCTED IN A STRAIGHT ALIGNMENT AT RIGHT ANGLES FROM THE MAIN LINE SEWER EXCEPT AS SHOWN ON THE PLANS. ANY CHANGE IN ALIGNMENT SHALL BE REQUESTED IN WRITING BY THE PRIVATE ENGINEER.
 - 4.
 5. NO DIVERSIONS SHALL BE MADE IN THESE PLANS WITHOUT THE APPROVAL OF THE CITY ENGINEER.
 6. THE CONTRACTOR SHALL NOTIFY THE CONSTRUCTION DIVISION BY TELEPHONE, MANSION 4-4747, EXT. 81581, AT LEAST TWENTY-FOUR HOURS BEFORE STARTING ANY WORK UNDER THIS CONTRACT.
 7. MANHOLES SHALL BE EITHER BRICK SEWER PER S-3 OR PRECAST CONCRETE MANHOLES PER S-5 OR S-6.
 8. "T" OR "Y" BRANCHES MAY BE USED FOR CONNECTIONS TO MAIN LINE SEWER.
 9. MANHOLE TOPS TO BE AT FINISHED GRADE.
 10. USE EXTRA STRENGTH PIPE. ALL PIPE IS STANDARD DEPTH.
 11. VITRIFIED CLAY PIPE JOINTS SHALL BE TYPE "D", "T" OR "E" PER STD. SPEC. SEE 808-2.
 12. IF A HOUSE HOLE IS WITHIN THREE FEET OF THE SEWER, THE SEWER SHALL BE ENCASED, PER S-25, TWO FEET ON EACH SIDE FROM THE POINT OF INTERFERENCE.
 13. IF DURING THE COURSE OF CONSTRUCTION IT IS DETERMINED THAT THERE IS LESS THAN FOUR FEET OF COVER OVER THE TOP OF A MAIN LINE OR HOUSE LATERAL V.C.P. SEWER WHICH IS NOT INDICATED ON THE PLANS, THE PIPE SHALL BE ENCASED PER S-25, UNLESS OTHERWISE APPROVED BY THE CITY ENGINEER.
 14. HOUSE LATERALS TO BE CONSTRUCTED WITH A 1/4" RISE PER FT. TO THE PROPERTY LINE.
 15. RESURFACE ALL TRENCHES WITHIN PAVED AREAS TO MEET L.A. COUNTY ROAD DEPT. OR CALIFORNIA STATE HIGHWAY REQUIREMENTS IN ACCORDANCE WITH PERMITS.
 16. SEWERS TO BE TESTED FOR LEAKAGE PER SECTION 306-2.3.7 OF STANDARD SPECIFICATIONS.
 17. ALL STATE AND LOCAL TRENCH SAFETY ORDERS WILL BE STRICTLY ENFORCED.
 18. ABANDON MANHOLE PER STD. SPECS., SEC. 306-3, THE UPPER PORTION (2 FEET) IS TO BE REMOVED.

PROFILE, ALIGNMENT AND GRADE OF
 SANITARY SEWERS PAGE 1

TO BE CONSTRUCTED IN
 1st. ALLEY EAST OF NORWALK BLVD.

PRIVATE CONTRACT NO. 8029

W.S. 31
 1 SHEET 2 PAGES
 SCALE: VERT. 1"=4' HORIZ. 1"=40'
 February 15, 1968

PREPARED IN THE OFFICES OF
 WILL DAN ENGINEERS ASSOCIATES
 CONSULTING ENGINEERS
 125 S. CLAUDINA ST. ANAHEIM CALIF.
 New N. Reed
 REG. C. E. NO. 12288

40650

FOR LEGEND SEE PLAN NO. S-1

NOTES:
 GRACES TO WHICH THIS IMPROVEMENT IS TO BE CONSTRUCTED ARE SHOWN ON PLANS AND PROFILE. GRADE POINTS FOR TOP OF CURBS, CENTER LINE OF STREETS, OR CENTER LINE OF ALLEYS ARE SHOWN BY CIRCLES ON PROFILES. AT ALL POINTS BETWEEN DESIGNATED POINTS THE GRADE SHALL BE ESTABLISHED SO AS TO CONFORM TO A STRAIGHT LINE DRAWN BETWEEN SAID DESIGNATED POINTS. ELEVATIONS ARE IN FEET ABOVE U.S.C. & G.S. MEAN SEA LEVEL. BASIS OF 1929. THE DRAWINGS AND THE DATA HEREON ARE HEREBY MADE A PART OF THE SPECIFICATIONS. (ENGINEER'S SPECIAL PROVISIONS) WORK SHALL BE CONSTRUCTED ACCORDING TO STANDARD SPECIFICATIONS FOR PUBLIC WORKS CONSTRUCTION AND CITY ENGINEER'S SPECIAL PROVISIONS. THE CONTRACTOR SHALL BE RESPONSIBLE FOR OBTAINING ALL NECESSARY PERMITS FROM THE L.A. COUNTY ROAD DEPT., DISTRICT OFFICE NO. 1, AND MAKE DEPOSIT WITH THE CITY OF HAWAIIAN GARDENS 12134 EAST TILBURY STREET. APPROVAL OF THIS PLAN BY THE CITY OF HAWAIIAN GARDENS DOES NOT CONSTITUTE A REPRESENTATION AS TO THE ACCURACY OF THE LOCATION OR OF THE EXISTENCE OR NON-EXISTENCE OF ANY UNDISCOVERED UTILITY PIPE, OR STRUCTURE WITHIN THE LIMITS OF THIS PROJECT. THIS NOTE APPLIES TO ALL PAGES. IF WORK IS TO BE DONE IN A STATE HIGHWAY, A PERMIT MUST BE OBTAINED FROM THE STATE OF CALIFORNIA, DIVISION OF HIGHWAYS, 120 SOUTH SPRING STREET, LOS ANGELES, CALIFORNIA.

CITY OF HAWAIIAN GARDENS, CALIFORNIA
 JOHN A. LAMBIE, CITY ENGINEER J. D. PARSHURST, CHIEF ENGINEER
 APPROVED BY: [Signature] REGIONAL ENGINEER APPROVED BY: [Signature] OFFICE ENGINEER

CHECKED BY: [Signature] 3/24/68
 REG. C. E. NO. 13731

COLLECT CHARGES AS INDICATED

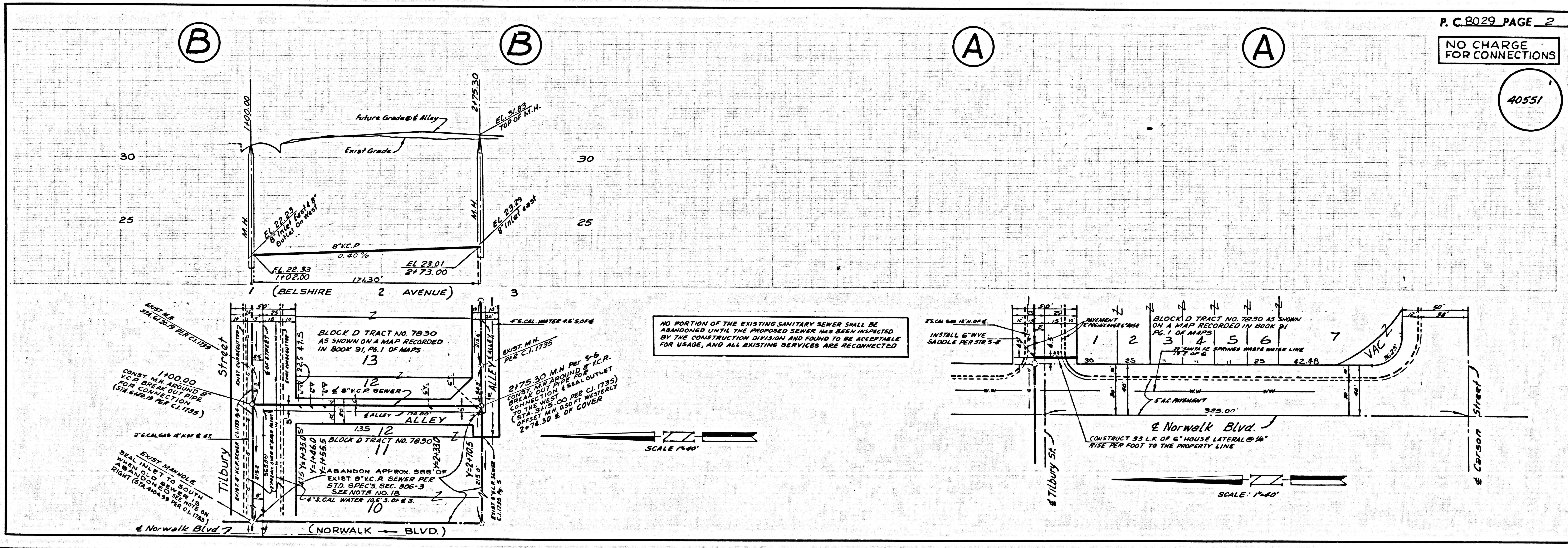

P. C. 8029 PAGE 2
 NO CHARGE FOR CONNECTIONS

40551