

B.M. SY-3093-A ELEV. 42.810  
 49 Spk. of L.W.C.B. Marino Avenue  
 1/4 Sec. 4, T. 11 N., R. 12 W., S. 4  
 So. of end of curb  
 GARDENA QUAD. 1955

**REVISIONS**  
 6/20/68 Eliminated sewer line from 244th Street  
 6/20/68 Changed design on Marabella Avenue  
 Added outlet sewer in R/W between  
 Marabella Ave & Neptune Ave - pg 2B

**APPROVED**  
 [Signature]  
 1/1/68

**CITY OF CARSON BLDG. DIST. NO. 12.05**

PROFILE, ALIGNMENT AND GRADE OF  
**SANITARY SEWERS PAGE 1**  
 TO BE CONSTRUCTED IN

**TRACT No 24836**  
**PRIVATE CONTRACT NO. 8038**

W.S. 28  
 2 SHEETS, 4 PAGES  
 SCALE: VERT. 1" = 4' HORIZ. 1" = 40'  
 PREPARED IN THE OFFICES OF  
**E.L. PEARSON AND ASSOCIATES**  
 [Signature]  
 REG. C.E. NO. 12837

40033

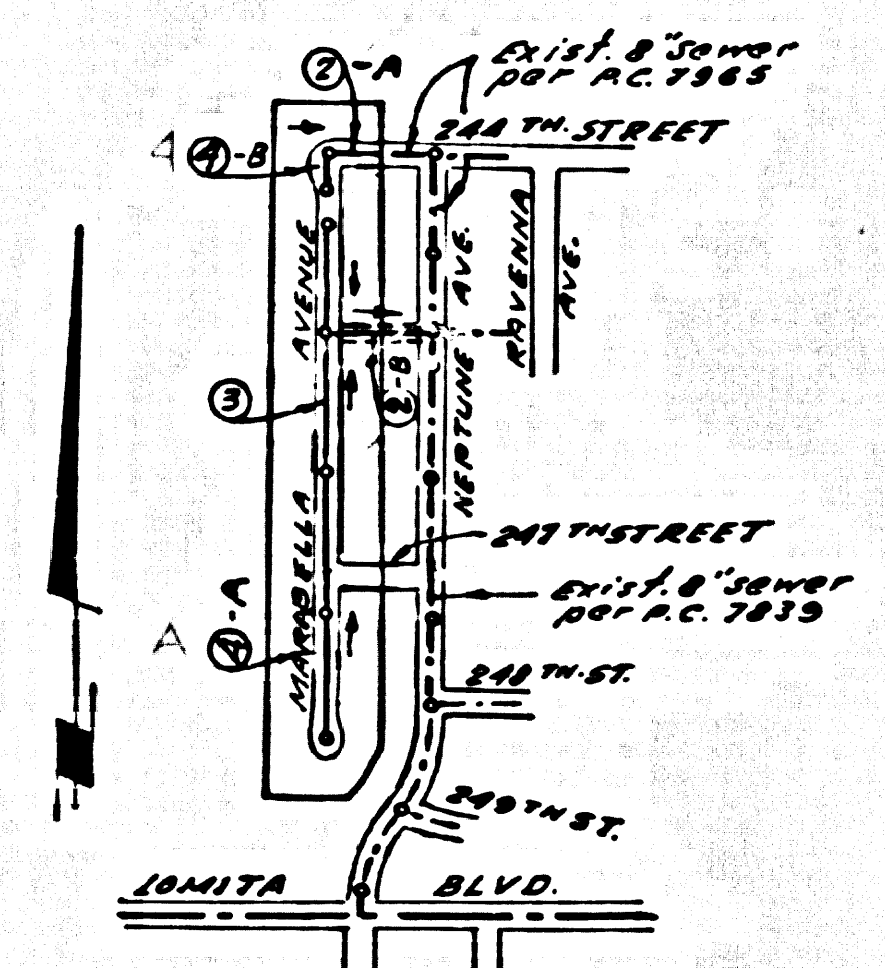

**INDEX MAP**  
**TRACT No 24836**  
**R.C. 8038**  
 Scale 1" = 400'

City of Sanitation Districts shall be notified prior to the following to that required inspection can be made (Phone NE. 63097)  
 (X) Commencement of construction of manholes on District trunk sewer.  
 (X) Breaking into existing manhole on District trunk sewer.  
 (X) Core drilling of existing trunk sewer.  
 (X) Construction of house connections to District trunk sewer.  
 (8) Acceptance of the project.

THE FOLLOWING CITY ENGINEER STANDARD PLANS APPLY TO THIS PROJECT

Legend	Page
Minimum Excavation Safety Requirements	5-1
Brick Manhole	5-2
Non-Reinforced Precast Concrete Manhole	5-3
Reinforced Precast Concrete Manhole	5-5
Manhole Frame and Cover	5-6
Manhole Stop	5-15
Bedding for Sewer Pipe	5-17
Grading and Encasement	5-21
Wye or Tee Support	5-23
Allowable Trench Width	5-23

- NOTES**
1. PROFILE STAKES ON THE PROPERTY LINE OR PROPERTY LINES PRODUCED AT RIGHT ANGLES TO THE SEWER LINE AT THE CENTER LINE OF EACH MANHOLE.
  2. NO REPRESENTATIVE OF THE CITY ENGINEER WILL SURVEY OR LAY OUT ANY PORTION OF THE WORK.
  3. THE PRIVATE ENGINEER SHALL FURNISH THE CITY ENGINEER WITH GRADE SHEETS AND STATIONING FOR ALL HOUSE LATERALS, 4" OR 6" BRANCHES AND SHALL PROVIDE STAKES FOR THEM AT THEIR PROPER LOCATIONS WITH STATIONING PLAINLY MARKED. ALL HOUSE LATERALS SHALL BE CONSTRUCTED IN A STRAIGHT ALIGNMENT AT RIGHT ANGLES FROM THE MAIN LINE SEWER EXCEPT AS SHOWN ON THE PLANS. HOUSE LATERALS FROM CHIMNEYS SHALL NOT HAVE AN ANGLE OF LESS THAN 45° WITH THE MAIN LINE SEWER. ANY CHANGES IN ALIGNMENT SHALL BE REQUESTED IN WRITING BY THE PRIVATE ENGINEER.
  4. THE PRIVATE ENGINEER SHALL FURNISH THE HOUSE LATERAL DEPTH AT THE PROPERTY LINE BELOW THE TOP OF CURB ELEVATION FOR EACH HOUSE LATERAL ON THE GRADE SHEET.
  5. NO REVISIONS SHALL BE MADE IN THESE PLANS WITHOUT THE APPROVAL OF THE CITY ENGINEER.
  6. THE CONTRACTOR SHALL NOTIFY THE CONSTRUCTION DIVISION BY TELEPHONE, MADISON 9-0700, EXT. 8158, AT LEAST TWENTY-FOUR HOURS BEFORE STARTING ANY WORK UNDER THIS CONTRACT.
  7. MANHOLES SHALL BE BRICK STRUCTURES PER 8-4 or precast concrete manholes per 5-5 or 5-6.
  8. USE STANDARD MANHOLE FRAMES AND COVERS, 5-11, EXCEPT AS NOTED.
  9. MANHOLE TOPS IN UNIMPROVED RIGHTS-OF-WAY TO BE SIX INCHES ABOVE FINISHED GRADE.
  10. USE EXTRA STRENGTH PIPE ALL PIPE IS STANDARD DEPTH EXCEPT AS NOTED.
  11. *Victrolite clay pipe joints shall be Type "D", 7" or 8" per Std. Spec. Section 208-2.*
  12. IF A POWER POLE IS WITHIN THREE FEET OF THE SEWER, THE SEWER SHALL BE ENCASED PER 5-23, TWO FEET ON EACH SIDE FROM THE POINT OF INTERFERENCE.
  13. IF DURING THE COURSE OF CONSTRUCTION IT IS DETERMINED THAT THERE IS LESS THAN FOUR FEET OF COVER OVER THE TOP OF A MAIN LINE OR HOUSE LATERAL V.C.P. SEWER WHICH IS NOT INDICATED ON THE PLANS, THE PIPE SHALL BE ENCASED PER 5-23, UNLESS OTHERWISE APPROVED BY THE CITY ENGINEER.
  14. HOUSE LATERALS TO BE CONSTRUCTED WITH INVERTS AT PROPERTY LINE A FEET BELOW CURB GRADE EXCEPT AS NOTED.
  15. REINFORCE ALL TRENCHES WITHIN PAVED AREAS TO MEET L.A. COUNTY ROAD DEPT. OR CALIFORNIA STATE HIGHWAY REQUIREMENTS IN ACCORDANCE WITH PERMITS.
  16. *Sewers to be tested for leakage per Section 206-2, 2, 3, 7 Std. Spec's*
  17. ALL STATE AND LOCAL TRENCH SAFETY ORDERS WILL BE STRICTLY ENFORCED.
  18. 7" Branches may be used in place of 6" branches, except as noted.
  19. *SPECIAL BACKFILL IN DESIGNATED AREAS*  
 (a) Backfill trench & replace with earth removed as to maintain the original finished grades & slopes shown on the grading plan prepared for this project by the Building & Safety Division.  
 (b) All backfill & earth replaced shall be compacted to a minimum of 90% density per A.S.T.M. standard method of test density as modified acceptable certification of soils, compaction shall be submitted to the construction division.

NO CONNECTIONS FOR THE DISPOSAL OF INDUSTRIAL WASTES SHALL BE MADE TO SEWERS SHOWN ON THESE DRAWINGS WITHOUT WRITTEN PERMISSION FROM THE CHIEF ENGINEER AND GENERAL MANAGER OF THE COUNTY SANITATION DISTRICTS.

**NOTICE TO CONTRACTOR**  
 The existence and location of any underground utility pipes or structures shown on these plans is obtained by a search of the available records. To the best of my knowledge there are no existing utilities shown as shown on these plans. The contractor is required to take due precautionary measures to protect the utility lines shown and any other lines not of record or not shown on these plans.  
 [Signature]  
 REG. C.E. NO. 12837

**COLLECT CHARGES AS INDICATED**

ISSUE NO HOUSE CONNECTION PERMITS UNTIL R/W IS RECORDED

**NOTES**  
 GRADES TO WHICH THE IMPROVEMENT IS TO BE CONSTRUCTED ARE SHOWN ON PLANS AND PROFILES. GRADE POINTS FOR TOP OF CURB, CENTER LINE OF STREETS, ON CENTER LINE OF ALLEYS ARE SHOWN BY CIRCLES ON PROFILES. AT ALL POINTS BETWEEN DESIGNATED POINTS THE GRADE SHALL BE ESTABLISHED SO AS TO CONFORM TO A STRAIGHT LINE DRAWN BETWEEN SAID DESIGNATED POINTS. THE DRAWING AND THE DATA HEREON ARE HEREBY MADE A PART OF THE SPECIFICATIONS.  
 WORK SHALL BE CONSTRUCTED ACCORDING TO STANDARD SPECIFICATIONS for public work construction of CITY ENGINEER. BEFORE WORK CAN BE STARTED, THE CONTRACTOR MUST OBTAIN A PERMIT TO EXCAVATE IN CITY STREETS FROM THE L.A. COUNTY ROAD DEPT., DISTRICT OFFICE NO. 35 AND PAY A FEE TO THE CITY ENGINEER, ROOM 300, COUNTY ENGINEERING BUILDING, 300 WEST SECOND STREET OR PERMIT SERVICES-CENTINELA SQUARE. REGIONAL OFFICE, MANHOLE TO COVER IS AT THE COST OF THE CONTRACTOR UNLESS OTHERWISE INDICATED.  
 APPROVAL OF THIS PLAN BY THE CITY OF CARSON DOES NOT CONSTITUTE A REPRESENTATION AS TO THE ACCURACY OF THE LOCATION OF OR THE EXISTENCE OR NON-EXISTENCE OF ANY UNDERGROUND UTILITY PIPE, OR STRUCTURE WITHIN THE LIMITS OF THIS PROJECT. THIS NOTE APPLIES TO ALL PAGES.  
 IF WORK IS TO BE DONE IN A STATE HIGHWAY, A PERMIT MUST BE OBTAINED FROM THE STATE OF CALIFORNIA, DIVISION OF HIGHWAYS, 126 SOUTH SPRING STREET, LOS ANGELES, CALIFORNIA.

**CITY OF CARSON, CALIFORNIA**  
 JOHN A. LAMBIE, CITY ENGINEER  
 I. D. PARKHURST, CHIEF ENGINEER  
 APPROVED BY: [Signature]  
 APPROVED BY: [Signature]  
 REGIONAL ENGINEER OFFICE ENGINEER

CHECKED BY: [Signature]  
 REG. C.E. NO. 12837

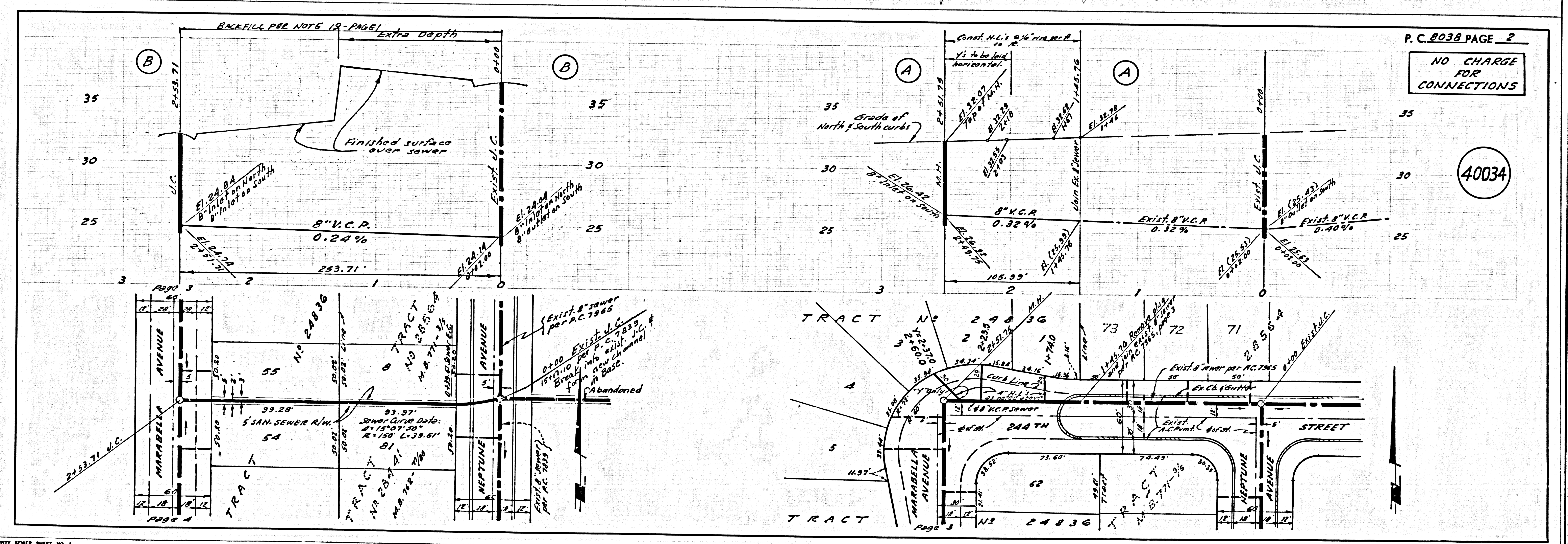

**NO CHARGE FOR CONNECTIONS**

40034