

B.M. BY 7107 ELEV. 48.659
 L & T. E. curb at B.C.R. at S.E. corner
 Paramount Blvd. & Candlewood St.
 66 ft. x S. & 40 ft. x E. of d. int.
 BASELINE QUAD. 19 65
 (BELLFLOWER QUAD)

REVISION NO. 2
 Changed 8" V.C.P. to 12" V.C.P. 5'
 and 8" S.P.C. to 12" S.P.C. 12/4/68
 APPROVED: *Quail E. McColl*
 Office of the County Engineer

LAKWOOD BLDG. DIST. NO. 401

PROFILE, ALIGNMENT AND GRADE OF
SANITARY SEWERS PAGE 1
 TO BE CONSTRUCTED IN
TRACT NO. 28176
 AND IN SANITARY SEWER R/W

PRIVATE CONTRACT NO. 8053

W.S. 30
 3 SHEETS, 6 PAGES

SCALE: VERT. 1" = 4'
 HORIZ. 1" = 40'
 MARCH, 1968

PREPARED IN THE OFFICES OF
H. M. Scott & Associates, Inc.

REG. C. E. NO. 16422

FOR LEGEND SEE PLAN NO. S-1

- NOTES:
- PROVIDE STAKES ON THE PROPERTY LINE OR PROPERTY LINES PRODUCED AT RIGHT ANGLES TO THE SEWER LINE AT THE CENTER LINE OF EACH MANHOLE.
 - NO REPRESENTATIVE OF THE COUNTY ENGINEER WILL SURVEY OR LAY OUT ANY PORTION OF THE WORK.
 - THE PRIVATE ENGINEER SHALL FURNISH THE COUNTY ENGINEER WITH GRADE SHEETS AND STATIONING FOR ALL HOUSE LATERALS, 3" OR 4" BRANCHES AND SHALL PROVIDE STAKES FOR THEM AT THEIR PROPER LOCATIONS WITH STATIONING PLAINLY MARKED. ALL HOUSE LATERALS SHALL BE CONSTRUCTED IN A STRAIGHT ALIGNMENT AT RIGHT ANGLES FROM THE MAIN LINE SEWER EXCEPT AS SHOWN ON THE PLANS. HOUSE LATERALS FROM CHIMNEYS SHALL NOT HAVE AN ANGLE OF LESS THAN 45° WITH THE MAIN LINE SEWER. ANY CHANGE IN ALIGNMENT SHALL BE REQUESTED IN WRITING BY THE PRIVATE ENGINEER.
 - THE PRIVATE ENGINEER SHALL FURNISH THE HOUSE LATERAL DEPTH AT THE PROPERTY LINE BELOW THE TOP OF CURB ELEVATION FOR EACH HOUSE LATERAL ON THE GRAB SHEET.
 - NO REVISIONS SHALL BE MADE IN THESE PLANS WITHOUT THE APPROVAL OF THE COUNTY ENGINEER.
 - THE CONTRACTOR SHALL NOTIFY THE CONSTRUCTION DIVISION BY TELEPHONE, MADISON 9-402, EXT. 81221, AT LEAST TWENTY-FOUR HOURS BEFORE STARTING ANY WORK UNDER THE CONTRACT.
 - MANHOLES SHALL BE CONSTRUCTED AS SHOWN ON PLANS.
 - USE MANHOLE FRAMES AND COVERS, AS SHOWN ON PLANS.
 - MANHOLES TOPS IN UNIMPROVED RIGHTS-OF-WAY TO BE SIX INCHES ABOVE FINISHED GRADE, EXCEPT AS SHOWN ON PLANS.
 - USE STEEL STRUTTING PIPE, ALL PIPE IS STANDARD WITH EXCEPT AS NOTED.
 - VITRIFIED CLAY PIPE JOINTS SHALL BE TYPE "D" WITH 2" STEEL SHOE, S.P.C. SEC. 208-B.
 - IF A POWER POLE IS WITHIN THREE FEET OF THE SEWER, THE SEWER SHALL BE ENCASED, PER S-22, TWO FEET ON EACH SIDE FROM THE POINT OF INTERFERENCE.
 - IF DURING THE COURSE OF CONSTRUCTION IT IS DETERMINED THAT THERE IS LESS THAN FOUR FEET OF COVER OVER THE TOP OF A MAIN LINE OR HOUSE LATERAL V.C.P. SEWER WHICH IS NOT INDICATED ON THE PLANS, THE PIPE SHALL BE ENCASED PER S-22, UNLESS OTHERWISE APPROVED BY THE COUNTY ENGINEER.
 - HOUSE LATERALS TO BE CONSTRUCTED WITH 6" RISE PER FOOT TO THE PROPERTY LINE.
 - REINFORCE ALL TRENCHES WITHIN PAVED AREAS TO MEET L.A. COUNTY ROAD DEPT. OR CALIFORNIA STATE HIGHWAY REQUIREMENTS IN ACCORDANCE WITH PERMITS.
 - SEWERS TO BE TESTED FOR LEAKAGE PER SECTION 906-2.3.7 STANDARD SPECIFICATIONS.
 - REFER TO SECTION 7-10-4.1 OF THE STANDARD SPECIFICATIONS, REGARDING SAFETY SIGNALS.
 - SPECIAL BACKFILLS IN DESIGNATED AREAS:
 (a) BACKFILL TRENCH AND BENCHES OTHER THAN REMOVED SO AS TO ACQUIRE THE NATURAL OR FINISHED GRADES AND SLOPES SHOWN ON THE GRADING PLAN APPROVED FOR THIS TRACT BY THE PUBLIC WORKS DIVISION.
 (b) ALL BACKFILL AND EARTH REPLACES SHALL BE COMPACTED TO A MINIMUM OF 90% OF MAXIMUM DENSITY PER A S.T.H. STANDARD METHOD OF TEST D 155-57 AS MODIFIED, ACCEPTABLE CERTIFICATION OF SUCH COMPACTION SHALL BE SUBMITTED TO THE CONSTRUCTION DIVISION.
 (c) ALL JOINTS BETWEEN CAST IRON PIPE AND VITRIFIED CLAY PIPE SHALL BE MADE WITH A RUBBER SLEEVE JOINT, TYPE "C" OR "D" (WITH BUSHING IF NECESSARY) PER STANDARD SPECIFICATIONS SECTION 208-B-2.

REVISION NO. 3 Nov 26, 1968
 Construct five (5) house laterals (each being 25' in length) to serve lots 1-5 of proposed tract N/A 29395. These laterals to be constructed of 8" V.C.P. per foot and are to be encased per S-23 as shown on page 3.

APPROVED: *Quail E. McColl*
 Office of the County Engineer R.E. No. 15931

REVISION NO. 1 July 8, 1968
 1. Changed 8" V.C.P. manhole to 12" V.C.P. from Sta. 1+02.10 to Sta. 2+04.21 on Page 2.
 2. Changed all 38" steel casing to 48" on page 2.
 3. Changed 8" stub of Sta. 5+16.31 to 10" stub on Page 2.
 4. Changed 8" V.C.P. manhole to 8" C.I.P. from Sta. 19+30.31 to Sta. 19+60.31 on Page 3.
 5. Added 8" stub to east side of J.C. of Sta. 19+45.31 on Page 3.

APPROVED: *Quail E. McColl*
 Office of the County Engineer R.E. No. 15931

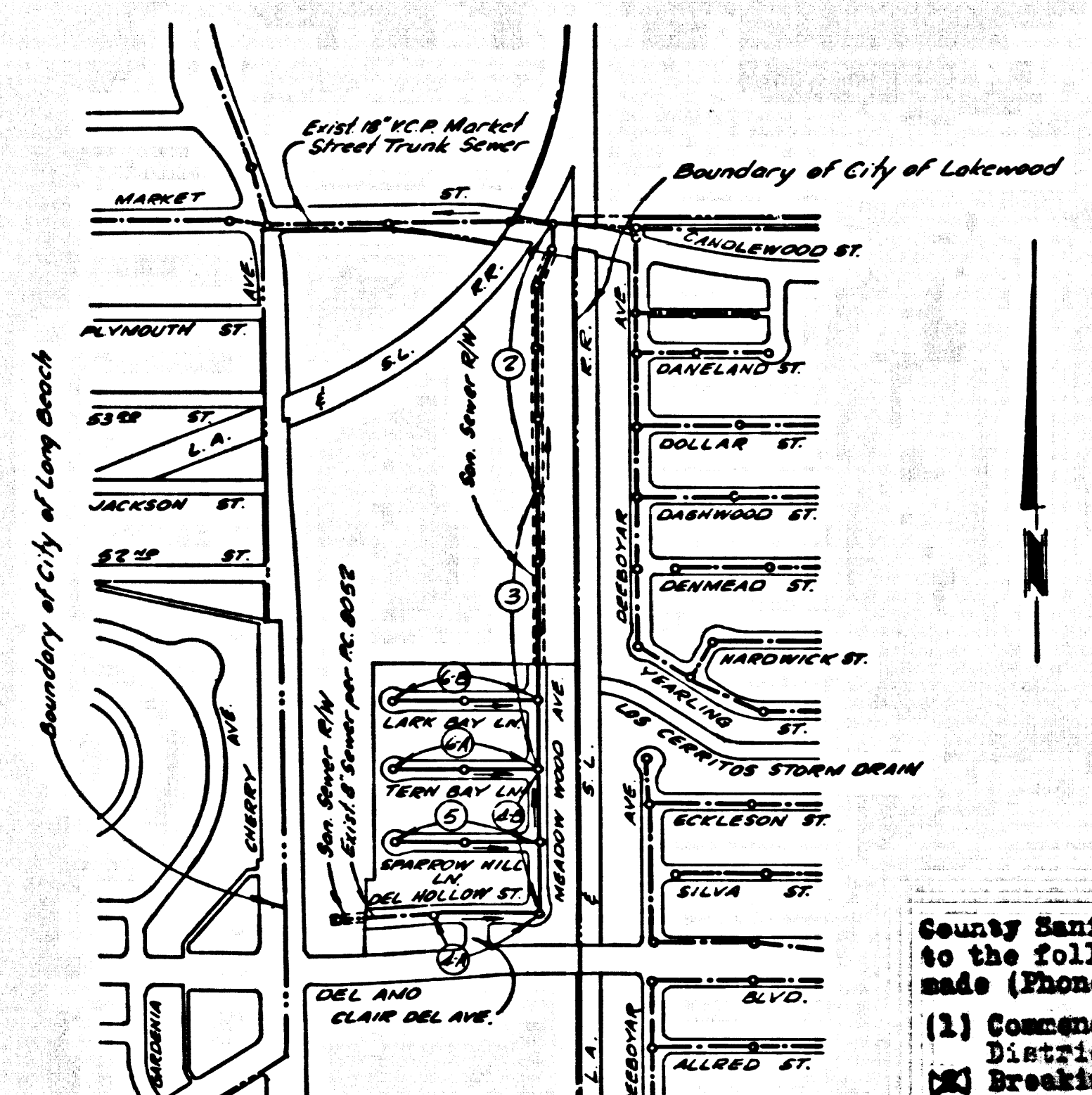

- THE FOLLOWING COUNTY ENGINEER STANDARD PLANS APPLY TO THIS PROJECT
- S-1 LEGEND
 - S-2 MINIMUM EXCAVATION SAFETY REQUIREMENTS
 - S-3 BRICK MANHOLE
 - S-4 30" REINFORCED PRECAST CONCRETE MANHOLE
 - S-5 REINFORCED PRECAST CONCRETE MANHOLE
 - S-6 RECTANGULAR SHALLOW MANHOLE
 - S-7 24" MANHOLE BASE
 - S-8 MANHOLE FRAME AND COVER
 - S-9 24" STANDARD MANHOLE STEPS
 - S-10 BRICKING AND SEWER PIPE
 - S-11 SPECIAL SUPPORT PROTECTION
 - S-12 SPECIAL SUPPORT PROTECTION
 - S-13 STOPPER
 - S-14 PRECAST CONCRETE SHALLOW MANHOLE
 - S-15 ALLOWABLE TRENCH WIDTHS
 - S-16 RECTANGULAR MANHOLE FRAME & COVER

County Sanitation Districts shall be notified prior to the following so that required inspection can be made (Phone NE 63077)

- Commencement of construction of manhole and District trunk sewer.
- Breaking into existing manhole on District trunk sewer.
- Core drilling District trunk sewer.
- Construction of house connections to District trunk sewer.
- Acceptance of the project.

NO CORRECTIONS FOR THE DISPOSAL OF INDUSTRIAL WASTES SHALL BE MADE TO SEWERS SHOWN ON THESE DRAWINGS WITHOUT WRITTEN PERMISSION FROM THE CHIEF ENGINEER AND GENERAL MANAGER OF THE COUNTY SANITATION DISTRICTS.

COLLECT CHARGES AS INDICATED

NOTICE TO CONTRACTOR

The existence and location of any underground utility lines or structures shown on these plans are obtained by a search of the available records to the best of the knowledge there are no existing utilities except as shown on these plans. The contractor is required to take due precautionary measures to protect the utility lines shown and any other lines not of record or not shown on these plans.

COUNTY OF LOS ANGELES, CALIFORNIA
 JOHN A. LAMBE, COUNTY ENGINEER J. D. PARKHURST, CHIEF ENGINEER
 CO. SAN. DIST. NO. 3
 APPROVED BY: *John A. Lambe* APPROVED BY: *J. D. Parkhurst*
 REGIONAL ENGINEER, DATE 5-24-68 OFFICE ENGINEER

CHECKED BY: *Quail E. McColl*
 REG. C.E. NO. 15931, DATE 4/16/68

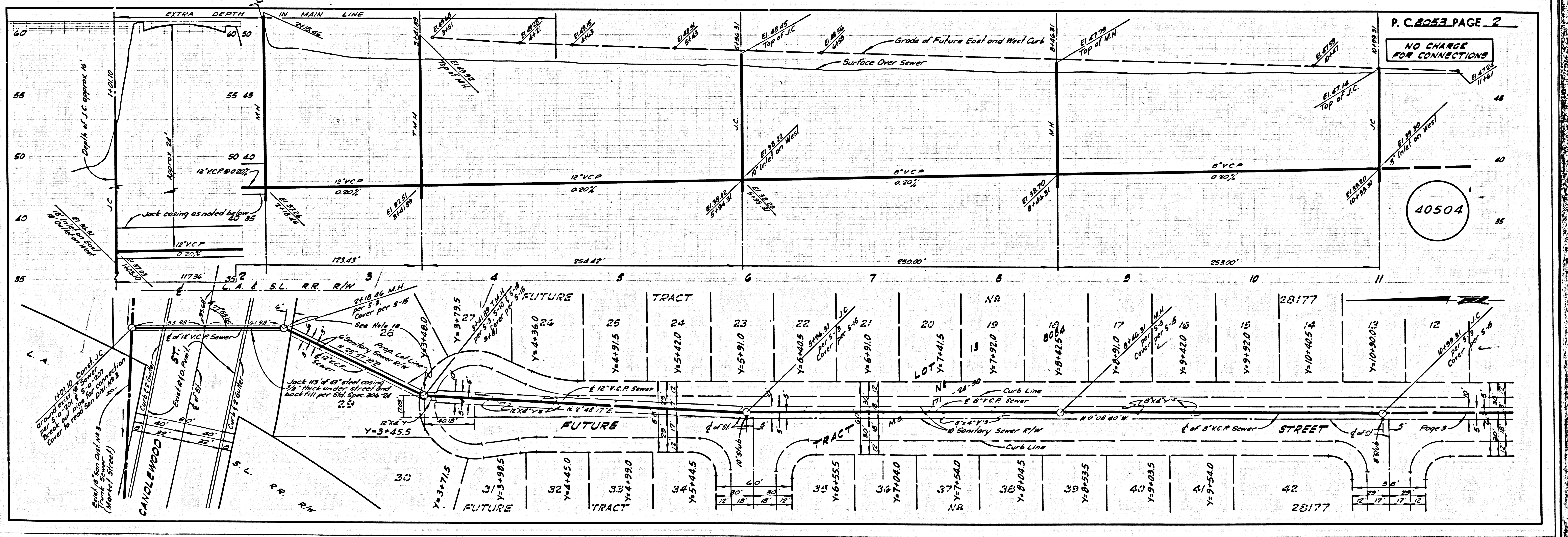

P. C. 8053 PAGE 2
 NO CHARGE FOR CONNECTIONS

40504

