

B.M. 65-9 ELEV. 261.620
 VENTURA BOULEVARD, ABOUT 71/2 MILES WESTERLY OF CORNELL
 ROAD AT BRIDGE # 23 OVER THE EAST BOUND DITCHWAY
 BARREL OF THE BLVD. IN THE NORTHEAST CORNER, A COUNTY
 ENGINEER SHALL CAP STAMPED "S.M. 65-9 RE 3883 1963."
 FD. 2896-38 QUAD. 1964.

LAS VIRGENES MUNICIPAL WATER DISTRICT STANDARD TEST NOTES

1. INFILTRATION AND LEAKAGE TEST METHOD USED FOR TESTING SHALL BE THE SAME AS LOS ANGELES COUNTY EXCEPT THE FORMULA TO BE USED AS FOLLOWS:
 0.033 GALLONS/MINUTE/INCH OF DIAMETER/1000 FEET
 OR
 250 GALLONS (DAY) INCH OF DIAMETER /MILE
2. MANHOLE LEAKAGE TESTS: AT THE DISCRETION OF THE DISTRICT'S REPRESENTATIVE ONE MANHOLE OUT OF EVERY TEN MANHOLES, AND A MINIMUM OF TWO SHALL BE FILLED WITH WATER AND AFTER THREE HOURS SHALL BE CHECKED FOR LEAKAGE, WITH NO DROP IN 181/2".
3. AVE TESTING: WHERE THE DIFFERENCE IN ELEVATION BETWEEN THE INVERT OF THE LOWER STRUCTURE AND THE INVERT OF THE LOWER STRUCTURE IS MORE THAN 3/4 FEET (6") AN AVE TEST SHALL BE MADE.
 THE TIME TAKEN TO LOSE ONE (1) POUND PER SQUARE INCH GRADE PRESSURE FROM THREE (3) POUNDS PER SQUARE INCH GRADE PRESSURE TO TWO (2) POUNDS PER SQUARE INCH GRADE PRESSURE SHALL NOT BE LESS THAN THOSE SHOWN BY THE FOLLOWING TABLE:

MAIN PIPE DIAMETER	MINIMUM TIME LOSE
6" - 16"	1 MINUTE
18" - 20"	2 MINUTE
21" - 30"	3 MINUTE
33" - 36"	4 MINUTE

IF THE TIME IS LESS THAN LISTED IN THE TABLE ABOVE, THE CONTRACTOR SHALL MAKE SUCH REPAIRS AS ARE NECESSARY TO ELIMINATE THE EXCESSIVE LEAKAGE.
 * THE CONTRACTOR SHALL NOTIFY THE L.V.M.W.D. 48 HOURS PRIOR TO COMMENCING WORK. AREA CODE 215-889-0400.

- THE FOLLOWING COUNTY ENGINEER STANDARD PLANS APPLY TO THIS PROJECT:
- | | |
|---|------|
| LEGEND | 5-1 |
| MINIMUM EXCAVATION SAFETY REQUIREMENTS | 5-2 |
| BRICK MANHOLE | 5-3 |
| NON-REINFORCED PRECAST CONCRETE MANHOLE | 5-5 |
| REINFORCED PRECAST CONCRETE MANHOLE | 5-6 |
| MANHOLE FRAME AND COVER | 5-15 |
| MANHOLE STEP | 5-17 |
| ADDING FOR SEWER AVE | 5-21 |
| CRADLING AND ENCASMENT | 5-22 |
| WVE OR TEE SUPPORT | 5-26 |
| ALLOWABLE TRENCH WIDTHS | 5-28 |

DOUBLE SCALE CALABASAS BLDG. DIST. NO. 9.1

- NOTE:
1. PROVIDE STAKES ON THE PROPERTY LINE OR PROPERTY LINES PRODUCED AT RIGHT ANGLES TO THE SEWER LINE AT THE CENTER LINE OF EACH MANHOLE.
 2. NO REPRESENTATIVE OF THE COUNTY ENGINEER WILL SIGN OFF ON ANY PORTION OF THE WORK.
 3. THE PRIVATE ENGINEER SHALL FURNISH THE COUNTY ENGINEER WITH GRADE SHEETS AND STATIONING FOR ALL HOUSE LATERALS AND "T" OR "Y" BRANCHES AND SHALL PROVIDE STAKES FOR THEM AT THEIR PROPER LOCATIONS WITH STATIONING PLAINLY MARKED. ALL HOUSE LATERALS SHALL BE CONSTRUCTED IN A STRAIGHT ALIGNMENT AT RIGHT ANGLES FROM THE MAIN LINE SEWER EXCEPT AS SHOWN ON THE PLANS. HOUSE LATERALS FROM CHIMNEYS SHALL NOT HAVE AN ANGLE OF LESS THAN 45° WITH THE MAIN LINE SEWER. ANY CHANGE IN ALIGNMENT SHALL BE REQUESTED IN WRITING BY THE PRIVATE ENGINEER.
 4. THE PRIVATE ENGINEER SHALL FURNISH THE HOUSE LATERAL DEPTH AT THE PROPERTY LINE BELOW THE TOP OF CURB ELEVATION FOR EACH HOUSE LATERAL ON THE GRADE SHEET.
 5. NO REVISIONS SHALL BE MADE IN THESE PLANS WITHOUT THE APPROVAL OF THE COUNTY ENGINEER.
 6. THE CONTRACTOR SHALL NOTIFY THE CONSTRUCTION DIVISION BY TELEPHONE, MARSHON 9-47, EXT. 81551, AT LEAST TWENTY-FOUR HOURS BEFORE STATING ANY WORK UNDER THIS CONTRACT.
 7. ALL STRUCTURES SHALL BE EITHER BRICK MANHOLES PER 5-3 OR PRECAST CONCRETE MANHOLES PER 5-5 OR 5-6, EXCEPT AS NOTED.
 8. "T" OR "Y" BRANCHES SHALL BE USED FOR CONNECTIONS TO EXISTING LATERALS EXCEPT AS NOTED.
 9. MANHOLE TOPS IN UNIMPROVED RIGHTS-OF-WAY TO BE SIX INCHES ABOVE FINISHED GRADE.
 10. USE EXTRA STRENGTH PIPE. ALL PIPE IS STANDARD DEPTH EXCEPT AS NOTED.
 11. *Unreinforced clay pipe joints shall be type 27, 27" or 24" and shall have 2" or 2 1/2" gaskets.*
 12. IF A POWER POLE IS WITHIN THREE FEET OF THE SEWER, THE SEWER SHALL BE ENCASED, PER 5-23, TWO FEET ON EACH SIDE FROM THE POINT OF INTERFERENCE.
 13. IF DURING THE COURSE OF CONSTRUCTION IT IS DETERMINED THAT THERE IS LESS THAN FOUR FEET OF COVER OVER THE TOP OF A MAIN LINE OR HOUSE LATERAL V.C.P. SEWER WHICH IS NOT INDICATED ON THE PLANS, THE PIPE SHALL BE ENCASED PER 5-23, UNLESS OTHERWISE APPROVED BY THE COUNTY ENGINEER.
 14. HOUSE LATERALS TO BE CONSTRUCTED WITH INVERTS AT PROPERTY LINE 4 FEET BELOW CURB GRADE EXCEPT AS NOTED.
 15. RESURFACE ALL TRENCHES WITHIN PAVED AREAS TO MEET L.A. COUNTY ROAD DEPT. OR CALIFORNIA STATE HIGHWAY REQUIREMENTS IN ACCORDANCE WITH PERMITS.
 16. ALL STATE AND LOCAL TRENCH SAFETY ORDERS WILL BE STRICTLY ENFORCED.
 17. SPECIAL BACKFILL IN DESIGNATED AREAS.
 18. BACKFILL TRENCH AND REPLACE OTHER EARTH REMOVED SO AS TO ACHIEVE THE NATURAL OR FINISHED GRADES AND SLOPES SHOWN ON THE GRADING PLAN APPROVED FOR THIS TRACT BY THE BUILDING AND SAFETY DIVISION.
 19. ALL BACKFILL AND BATH REPLACED SHALL BE COMPACTED TO A MINIMUM OF 90% OF MAXIMUM DENSITY PER A S.T.M. STANDARD METHOD OF TEST BAK-57 AS MODIFIED. ACCEPTABLE CERTIFICATION OF SUCH COMPACTION SHALL BE SUBMITTED TO THE CONSTRUCTION DIVISION.

COLLECT CHARGES AS INDICATED
 Robert C. Niles

PROFILE ALIGNMENT AND GRADE OF
 SANITARY SEWERS P.C. 8058
 TO SERVE PAGE 1
 WHIZIN'S CORNER

PRIVATE CONTRACT NO. 8058

W.S. 90-2A
 1 SHEETS; 2 PAGES

SCALE: VERT. 1"=6'
 HORIZ. 1"=40'

APRIL, 1968
 PREPARED IN THE OFFICES OF
 VALCON INC.
 1429 THOUSAND OAKS BLVD., THOUSAND OAKS, CALIF.
 TEL. 213-893-6833

39907

BY: *Robert C. Niles*
 REG. C. E. NO. 13696

FOR LEGEND SEE PLAN NO. S-1

NOTE:
 GRADES TO WHICH THIS IMPROVEMENT IS TO BE CONSTRUCTED ARE SHOWN ON PLANS AND PROFILES. GRADE POINTS FOR TOP OF CURBS, CENTER LINE OF STREETS, OR CENTER LINE OF ALLEYS ARE SHOWN BY CIRCLES ON PROFILES AT ALL POINTS BETWEEN DESIGNATED POINTS. THE GRADE SHALL BE ESTABLISHED SO AS TO CONFORM TO A STRAIGHT LINE DRAWN BETWEEN SAID DESIGNATED POINTS. ELEVATIONS ARE IN FEET ABOVE U.S.C. & G.S. SEA LEVEL DATUM OF 1929.
 THIS DRAWING AND THE DATA HEREON ARE HEREBY MADE A PART OF THE SPECIFICATIONS FOR PUBLIC WORKS CONSTRUCTION AND SHALL BE CONSIDERED AS SUCH. ALL REVISIONS AND CHANGES SHALL BE MADE BY THE COUNTY ENGINEER'S OFFICE. NO WORK SHALL BE STARTED WITHOUT THE PRESENCE OF THE COUNTY ENGINEER.
 BEFORE WORK CAN BE STARTED, THE CONTRACTOR MUST OBTAIN A PERMIT TO EXCAVATE IN COUNTY STREETS FROM THE L.A. COUNTY ROAD DEPT., DISTRICT OFFICE NO. 10, AND PAY A FEE TO THE COUNTY ENGINEER, ROOM 330, COUNTY ENGINEERING BUILDING, 100 WEST SECOND STREET, LOS ANGELES, CALIFORNIA.
 APPROVAL OF THIS PLAN BY THE COUNTY OF LOS ANGELES DOES NOT CONSTITUTE A REPRESENTATION AS TO THE ACCURACY OF THE LOCATION OF OR THE EXISTENCE OR NON-EXISTENCE OF ANY UNDERGROUND UTILITY PIPE, OR STRUCTURE WITHIN THE LIMITS OF THIS PROJECT. THIS NOTE APPLIES TO ALL PAGES.
 IF WORK IS TO BE DONE IN A STATE HIGHWAY, A PERMIT MUST BE OBTAINED FROM THE STATE OF CALIFORNIA, DIVISION OF HIGHWAYS, 1600 SPRING STREET, LOS ANGELES, CALIFORNIA.

COUNTY OF LOS ANGELES, CALIFORNIA
 JOHN A. LAMBIE, COUNTY ENGINEER LAS VIRGENES MUNICIPAL WATER DISTRICT
 APPROVED BY: *Robert C. Niles* Regional Engineer Date: 4/1/68
 APPROVED BY: *W. Stokes* Chief Engineer Date: 4/1/68
 CHECKED BY: *W. D. Dine* 4-30-68
 REG. CE NO. 7426 Date: _____
 J. N. 0369.08

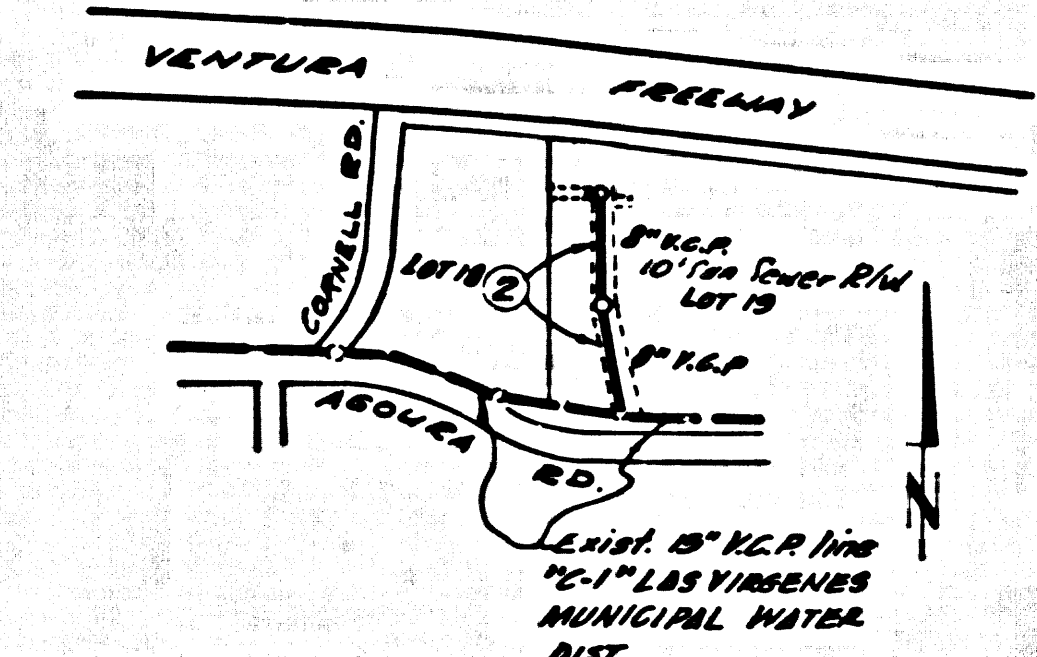

INDEX MAP
 SCALE 1"=600'
 P.C. 8058

