

B.M. 562061 ELEV. 712.998  
 RD. B.M. TAG IN CONC. WALK  
 AROUND FOUNTAIN S.E. OF N.  
 EDGE 176 ELY 161 SLY & INT. BREA  
 CANYON ROAD 4 DIAMOND BAR BLVD.  
 OTTERBEIN QUAD. 19 55

- County Sanitation Districts shall be notified prior to the following so that required inspection can be made (Phone EA 71025)
- (1) Commencement of construction of manhole on District trunk sewer.
  - (2) Breaking into existing manhole on District trunk sewer.
  - (3) Co. drilling District trunk sewer.
  - (4) Construction of house connections to District trunk sewer.
  - (5) Acceptance of the project.

NO CONNECTIONS FOR THE DISPOSAL OF INDUSTRIAL WASTES SHALL BE MADE TO SEWERS SHOWN ON THESE DRAWINGS WITHOUT WRITTEN PERMISSION FROM THE CHIEF ENGINEER AND GENERAL MANAGER OF THE COUNTY SANITATION DISTRICTS

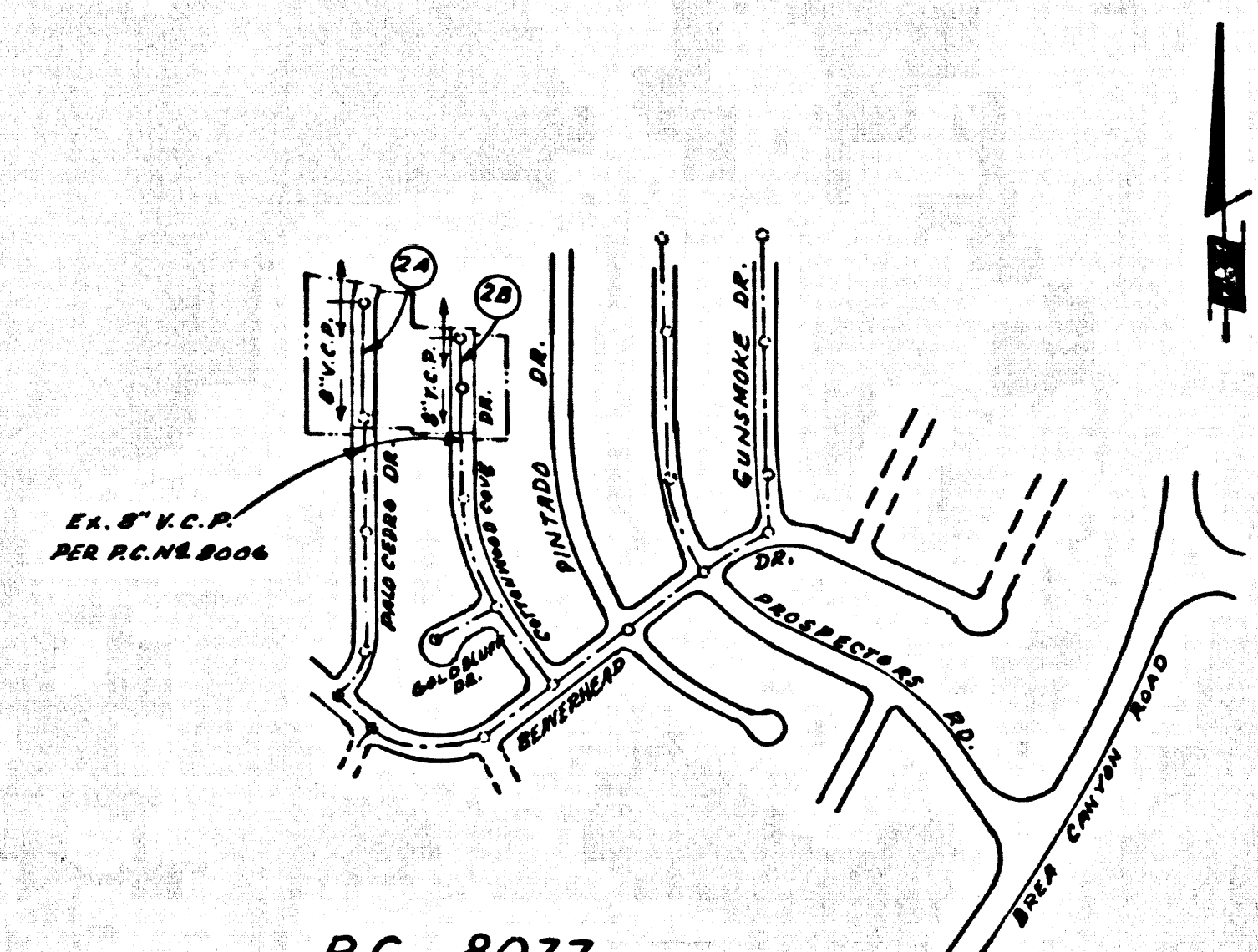

P.C. 8077  
 INDEX MAP  
 TRACT No. 27836  
 SCALE: 1"=60'

SAN DIMAS BLDG. DIST. NO. 10

PROFILE ALIGNMENT AND GRADE OF P.C. 8077  
 SANITARY SEWERS PAGE 1  
 CONSTRUCTED IN

TRACT No. 27836  
 PRIVATE CONTRACT NO. 8077

W.S. 39 C 2  
 1 SHEET OF 2 PAGES  
 SCALE: 1"=10' JUNE, 1968

PREPARED IN THE OFFICES OF  
 KEMMERER ENGR. CO. INC.  
 6705 S. PAINTER, WHITTIER, CALIF.  
 BY: Robert R. Flores  
 REG. C. E. NO. 11249

40785

- NOTE:
1. PROFILE STAKES ON THE PROPERTY LINE OR PROPERTY LINES PRODUCED AT RIGHT ANGLES TO THE SEWER LINE AT THE CENTER LINE OF EACH MANHOLE.
  2. NO REPRESENTATIVE OF THE COUNTY ENGINEER WILL SURVEY OR LAY OUT ANY PORTION OF THE WORK.
  3. THE PRIVATE ENGINEER SHALL FURNISH THE COUNTY ENGINEER WITH GRADE SHEETS AND STATIONING FOR ALL HOUSE LATERALS AND "Y" BRANCHES AND SHALL PROVIDE STAKES FOR THEM AT THEIR PROPER LOCATIONS WITH STATIONING PLAINLY MARKED. ALL HOUSE LATERALS SHALL BE CONSTRUCTED IN A STRAIGHT ALIGNMENT AT RIGHT ANGLES FROM THE MAIN LINE SEWER EXCEPT AS SHOWN ON THE PLANS. HOUSE LATERALS FROM CHIMNEYS SHALL NOT HAVE AN ANGLE OF LESS THAN 45° WITH THE MAIN LINE SEWER. ANY CHANGE IN ALIGNMENT SHALL BE REQUESTED BY WRITING BY THE PRIVATE ENGINEER.
  4. THE PRIVATE ENGINEER SHALL FURNISH THE HOUSE LATERAL DEPTH AT THE PROPERTY LINE BELOW THE TOP OF CURB ELEVATION FOR EACH HOUSE LATERAL ON THE GRADE SHEET.
  5. NO REVISIONS SHALL BE MADE IN THESE PLANS WITHOUT THE APPROVAL OF THE COUNTY ENGINEER.
  6. THE CONTRACTOR SHALL NOTIFY THE CONSTRUCTION DIVISION BY TELEPHONE, MADISON 9-67, EXT. 8152, AT LEAST TWENTY-FOUR HOURS BEFORE STARTING ANY WORK UNDER THE CONTRACT.
  7. ALL STRUCTURES SHALL BE EITHER BRICK MANHOLES PER S-3 OR PRECAST CONCRETE MANHOLES PER S-2 OR S-6 EXCEPT AS NOTED.
  8. 6" TO 12" MANHOLES MAY BE USED FOR CONNECTIONS TO MAIN LINE SEWERS EXCEPT AS NOTED.
  9. MANHOLE TOPS IN UNIMPROVED AREAS OR HAY TO BE SIX INCHES ABOVE FINISH GRADE.
  10. USE EXTRA STRENGTH PIPE, ALL PIPE IS STANDARD DEPTH.
  11. VITRIFIED CLAY PIPE JOINT SHALL BE TYPE "D", 15" OR 18" PER STD. SPEC. SEC. 208-9.
  12. IF A POWER POLE IS WITHIN THREE FEET OF THE SEWER, THE SEWER SHALL BE ENCASED, PER S-11, TWO FEET ON EACH SIDE FROM THE POINT OF INTERFERENCE.
  13. IF DURING THE COURSE OF CONSTRUCTION IT IS DETERMINED THAT THERE IS LESS THAN FOUR FEET OF COVER OVER THE TOP OF A MAIN LINE OR HOUSE LATERAL, V.C.P. SEWER WHICH IS NOT INDICATED ON THE PLANS, THE PIPE SHALL BE ENCASED PER S-23, UNLESS OTHERWISE APPROVED BY THE COUNTY ENGINEER.
  14. HOUSE LATERALS TO BE CONSTRUCTED WITH INVERTS AT PROPERTY LINE. 5' MIN. FREE BELOW CURB GRADE EXCEPT AS NOTED.
  15. REPAIR ALL TRENCHES WITHIN PAVED AREAS TO MEET L.A. COUNTY ROAD DEPT. OR CALIFORNIA STATE HIGHWAY REQUIREMENTS IN ACCORDANCE WITH PERMITS.
  16. SEWERS TO BE TESTED FOR LEAKAGE PER SEC. 306-2.3.7 STANDARD SPECIFICATIONS.
  17. REFER TO SECTION 7-NO. 6.1 OF THE STANDARD SPECIFICATIONS, REGARDING SAFETY ORANGE.
  18. SPECIAL BACKFILL DESIGNATED AREAS:  
 (A) BACKFILL TRENCH AND MANHOLE: OTHER EARTH REMOVED SO AS TO ACHIEVE THE ARTIFICIAL OR FINISH GRADES AND SLOPES SHOWN ON THE GRADING PLAN APPROVED FOR THIS TRACT BY THE PLANNING AND SAFETY DIVISION.  
 (B) ALL BACKFILL AND BATHS DELIVERED SHALL BE COMPACTED TO A MINIMUM OF 90% OF MAXIMUM DENSITY PER A.S.T.M. STANDARD METHOD OF TEST D 99-57T AS MODIFIED, ACCORDING TO CERTIFICATION OR SUCH COMPACTION SHALL BE SUBMITTED TO THE CONSTRUCTION DIVISION.  
 (C) JOINTS BETWEEN CAST-IRON PIPE AND VITRIFIED CLAY PIPE SHALL BE MADE WITH A RUBBER SLIPER JOINT, TYPE "C" OR "D" (WITH RUBBER IF NECESSARY) PER STANDARD SPECIFICATIONS, SECTION 208-9.

NOTE:  
 GRADES TO WHICH THIS IMPROVEMENT IS TO BE CONSTRUCTED ARE SHOWN ON PLANS AND PROFILE. GRADE POINTS FOR TOP OF CURB, CENTER LINE OF STREETS, OR CENTER LINE OF ALLEYS ARE SHOWN BY CIRCLES ON PROFILES. AT ALL POINTS BETWEEN DESIGNATED POINTS THE GRADE SHALL BE ESTABLISHED SO AS TO CONFORM TO A STRAIGHT LINE DRAWN BETWEEN SAID DESIGNATED POINTS. ELEVATIONS ARE IN FEET ABOVE U.S.C. & G.S. SEA LEVEL DATUM OF 1929.  
 THIS DRAWING AND THE DATA HEREON ARE HEREBY MADE A PART OF THE SPECIFICATIONS.  
 WORK SHALL BE CONSTRUCTED ACCORDING TO STANDARD SPECIFICATIONS FOR PUBLIC WORKS AND RELATED SPEC. PERMITS AND BUREAU OF PUBLIC WORKS AND SHALL BE PRODUCED AT THE OFFICE OF THE COUNTY ENGINEER.  
 BEFORE WORK CAN BE STARTED, THE CONTRACTOR MUST OBTAIN A PERMIT TO EXCAVATE IN COUNTY STREETS FROM THE L.A. COUNTY ROAD DEPT. DISTRICT OFFICE AND A PERMIT TO THE COUNTY ENGINEER, ROOM 202, COUNTY ENGINEERING BUILDING, 100 WEST SECOND STREET OR CIVIL ENGINEER, 1111 S. GATEWAY BLVD., REGIONAL OFFICE, SUFFICIENT TO COVER THE COST OF CONSTRUCTION INSPECTION AND RECORD PLANS.  
 APPROVAL OF THIS PLAN BY THE COUNTY OF LOS ANGELES DOES NOT CONSTITUTE A REPRESENTATION AS TO THE ACCURACY OF THE LOCATION OF OR THE EXISTENCE OR NON-EXISTENCE OF ANY UNDERGROUND UTILITY PIPE, OR STRUCTURE WITHIN THE LIMITS OF THIS PROJECT. THIS NOTE APPLIES TO ALL PAGES.  
 IF WORK IS TO BE DONE IN A STATE HIGHWAY, A PERMIT MUST BE OBTAINED FROM THE STATE OF CALIFORNIA, DIVISION OF HIGHWAYS, 120 SOUTH SPRING STREET, LOS ANGELES, CALIFORNIA.

COUNTY OF LOS ANGELES, CALIFORNIA  
 JOHN A. LAMBIE, COUNTY ENGINEER J. D. PARKHURST, CHIEF ENGINEER  
 CO. SAN. DIST. NO. 10  
 APPROVED BY: [Signature] SAN DIMAS REGIONAL ENGINEER APPROVED BY: [Signature] OFFICE ENGINEER

CHECKED BY: [Signature] 8-9-68  
 REG. C.E. NO. 112223

COLLECT CHARGES AS INDICATED

LEGEND	CHARGE
MINIMUM PUBLIC SAFETY REQUIREMENTS	5-1
BRICK MANHOLE	5-3
NON-REINFORCED PRECAST CONCRETE MANHOLE	5-5
REINFORCED PRECAST CONCRETE MANHOLE	5-6
MANHOLE FRAME AND COVER	5-15
MANHOLE STEP	5-17
BE DOING FOR SEWER PIPE	5-21
CURB AND ENCASEMENT	5-23
WYE OR TEE SUPPORT	5-36
ALLOWABLE TRENCH WIDTHS	5-39

J.N. 0250.02

