

B.M. S.I. 642 ELEV. 1262.071  
 RD. DEPT. B.M. TAG N. SIDE CONC. BASE AT N.E. COR. EDISON  
 HIGH TENSION TOWER # N37-3N3-3 335 FT. S. E. LYONS  
 AVE. 9 1/2 30 FT. E. WILEY CANYON RD.  
 NEWHALL QUAD. 19 58

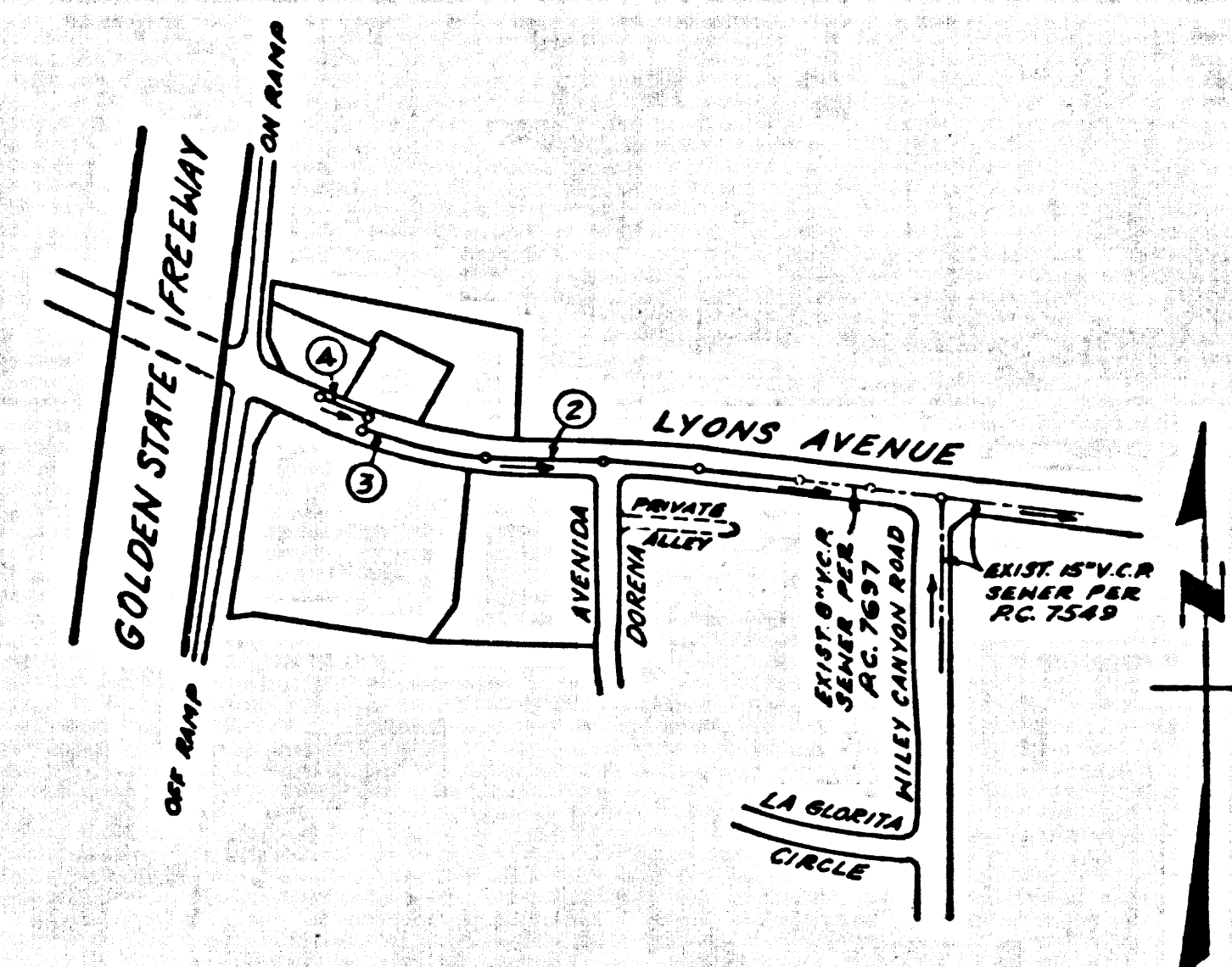

INDEX MAP  
 SCALE 1" = 600'

NO CONNECTIONS FOR THE DISPOSAL OF INDUSTRIAL WASTES SHALL BE MADE TO SEWERS SHOWN ON THESE DRAWINGS WITHOUT WRITTEN PERMISSION FROM THE CHIEF ENGINEER AND GENERAL MANAGER OF THE COUNTY SANITATION DISTRICTS.

County Sanitation Districts shall be notified prior to the following so that required inspection can be made (Phone 587-7025):  
 (1) Commencement of construction of manhole on District trunk sewer.  
 (2) Breaking into existing manhole on District trunk sewer.  
 (3) Core drilling District trunk sewer.  
 (4) Construction of house connections to District trunk sewer.  
 (5) Acceptance of the project.

NOTE: IT SHALL BE THE RESPONSIBILITY OF THE CONTRACTOR TO ASCERTAIN AND VERIFY THE TRUE LOCATION OF UNDERGROUND PIPES OR STRUCTURES PRIOR TO THE START OF CONSTRUCTION AND TO LOCATE AND PROTECT UTILITY LINES AND STRUCTURES WHETHER SHOWN OR NOT.

NEWHALL BLDG. DIST. NO. 8.2

- NOTES:
- PROVIDE STAKES ON THE PROPERTY LINE OR PROPERTY LINES PRODUCED AT RIGHT ANGLES TO THE SEWER LINE AT THE CENTER LINE OF EACH MANHOLE.
  - NO REPRESENTATIVE OF THE COUNTY ENGINEER WILL SURVEY OR LAY OUT ANY PORTION OF THE WORK.
  - THE PRIVATE ENGINEER SHALL FURNISH THE COUNTY ENGINEER WITH GRADE SHEETS AND STATIONING FOR ALL HOUSE LATERALS AND "T" OR "Y" BRANCHES AND SHALL PROVIDE STAKES FOR THEM AT THEIR PROPER LOCATIONS WITH STATIONING PLAINLY MARKED. ALL HOUSE LATERALS SHALL BE CONSTRUCTED IN A STRAIGHT ALIGNMENT AT RIGHT ANGLES FROM THE MAIN LINE SEWER EXCEPT AS SHOWN ON THE PLANS. HOUSE LATERALS FROM CHIMNEYS SHALL NOT HAVE AN ANGLE OF LESS THAN 45° WITH THE MAIN LINE SEWER. ANY CHANGE IN ALIGNMENT SHALL BE REQUESTED IN WRITING BY THE PRIVATE ENGINEER.
  - THE PRIVATE ENGINEER SHALL FURNISH THE HOUSE LATERAL DEPTH BELOW THE TOP OF CURB ELEVATION OR GROUND, AS SHOWN FOR EACH HOUSE LATERAL ON THE GRADE SHEET.
  - NO REVISIONS SHALL BE MADE IN THESE PLANS WITHOUT THE APPROVAL OF THE COUNTY ENGINEER.
  - THE CONTRACTOR SHALL NOTIFY THE CONSTRUCTION DIVISION BY TELEPHONE, 615-3000, EXT. 8151, AT LEAST TWENTY-FOUR HOURS BEFORE STARTING ANY WORK UNDER THIS CONTRACT.
  - ALL STRUCTURES SHALL BE EITHER BRICK MANHOLES PER S-1 OR PRECAST CONCRETE MANHOLES PER S-3 OR S-4, EXCEPT AS NOTED.
  - "T" OR "Y" BRANCHES MAY BE USED FOR CONNECTIONS TO MAINLINE SEWERS EXCEPT AS NOTED.
  - MANHOLE-FORMS-IN-SPRING-BOARDS-OF-24" TO 48" DEEP SHALL BE USED UNLESS OTHERWISE SHOWN.
  - USE EXTRA STRENGTH PIPE. ALL PIPE IS STANDARD DEPTH.
  - UNGRAVELLED CLAY PIPE JOINTS SHALL BE TYPE "D" PER STD. SPEC. SECT. 208-2.
  - IF A POWER POLE IS WITHIN THREE FEET OF THE SEWER, THE SEWER SHALL BE ENCASED, PER S-23, TWO FEET ON EACH SIDE FROM THE POINT OF INTERFERENCE.
  - IF DURING THE COURSE OF CONSTRUCTION IT IS DETERMINED THAT THERE IS LESS THAN FOUR FEET OF COVER OVER THE TOP OF A MAIN LINE OR HOUSE LATERAL V.C.P. SEWER WHICH IS NOT INDICATED ON THE PLANS, THE PIPE SHALL BE ENCASED PER S-23, UNLESS OTHERWISE APPROVED BY THE COUNTY ENGINEER.
  - HOUSE LATERALS TO BE CONSTRUCTED WITH A RISE OF 1/4 INCH PER FOOT TO THE PROPERTY LINE EXCEPT AS SHOWN.
  - RESURFACE ALL TRENCHES WITHIN PAVED AREAS TO MEET L.A. COUNTY ROAD DEPT. OR CALIFORNIA STATE HIGHWAY REQUIREMENTS IN ACCORDANCE WITH PERMITS.
  - SEWERS TO BE TESTED FOR LEAKAGE PER SECTION 306.3.2.2 UNIFORM STANDARD SPECIFICATIONS.
  - REFER TO SECTION 7-10.6.1 OF THE STANDARD SPECIFICATIONS REGARDING SAFETY ORDERS.
  - SPECIAL BACKFILL IN DESIGNATED AREAS:  
 (a) BACKFILL TRENCH AND REPLACE OTHER EARTH REMOVED SO AS TO ACHIEVE THE NATURAL OR FINISHED GRADES AND SLOPES SHOWN ON THE GRADING PLAN APPROVED FOR THIS TRACT BY THE BUILDING AND SAFETY DIVISION.  
 (b) ALL BACKFILL AND EARTH REPLACED SHALL BE COMPACTED TO A MINIMUM OF 90% OF MAXIMUM DENSITY PER A.S.T.M. STANDARDS AND METHOD OF TEST SHOWN AS MODIFIED. ACCURATE CERTIFICATION OF SUCH COMPACTION SHALL BE SUBMITTED TO THE CONSTRUCTION DIVISION.
  - SEWER PIPE BEDDING SHALL CONFORM TO S-21.

THE FOLLOWING COUNTY ENGINEER STANDARD PLANS APPLY TO THIS PROJECT

LEGEND	S-1
MINIMUM EXCAVATION SAFETY REQUIREMENTS	S-2
BRICK MANHOLES	S-3
NON REINFORCED PRECAST CONCRETE MANHOLES	S-4
MANHOLE FRAME AND COVER	S-5
REINFORCED PRECAST CONCRETE MANHOLES	S-6
MANHOLE STEP	S-7
BEDDING FOR SEWER PIPE	S-8
GRADING AND ENCASEMENT	S-9
WYE OF TEE SUPPORT	S-10
ALLOWABLE TRENCH WIDTH	S-11

PROFILE ALIGNMENT AND GRADE OF  
 SANITARY SEWERS  
 CONSTRUCTED IN  
 LYONS AVENUE

PRIVATE CONTRACT NO. 8087

W.S. 63  
 SHEETS: 4 PAGES

SCALE: VERT. 1" = 4'  
 HORIZ. 1" = 40'

MAY 1968  
 PREPARED IN THE OFFICES OF  
 TRI-STATE ENGINEERING COMPANY

REG. C. E. NO. 12307

FOR LEGEND SEE PLAN NO. S-1

NOTE:  
 GRADES TO WHICH THE IMPROVEMENT IS TO BE CONSTRUCTED ARE SHOWN ON PLANS AND PROFILE. GRADE POINTS FOR TOP OF CURBS, CENTER LINE OF STREETS, OR CENTER LINE OF ALLEYS ARE SHOWN BY CIRCLES ON PROFILES. AT ALL POINTS BETWEEN DESIGNATED POINTS THE GRADE SHALL BE ESTABLISHED SO AS TO CONFORM TO A STRAIGHT LINE DRAWN BETWEEN SAID DESIGNATED POINTS. ELEVATIONS ARE IN FEET ABOVE U.S.C. & G.S. MEAN SEA LEVEL DATUM OF 1929.  
 THIS DRAWING AND ALL DATA HEREON ARE HEREBY MADE A PART OF THE SPECIFICATIONS.  
 WORK SHALL BE CONSTRUCTED ACCORDING TO STANDARD SPECIFICATIONS FOR PUBLIC WORKS CONSTRUCTION AND THE PRESENCE OF THE COUNTY ENGINEER.  
 BEFORE WORK CAN BE STARTED, THE CONTRACTOR MUST OBTAIN A PERMIT TO EXCAVATE IN COUNTY STREETS FROM THE L.A. COUNTY ROAD DEPT., DISTRICT OFFICE NO. 100, AND PAY A FEE TO THE COUNTY ENGINEER, ROOM 300, COUNTY ENGINEERING BUILDING, 100 WEST SECOND STREET, LOS ANGELES, CALIFORNIA.  
 APPROVAL OF THIS PLAN BY THE COUNTY OF LOS ANGELES DOES NOT CONSTITUTE A REPRESENTATION AS TO THE ACCURACY OF THE LOCATION OF OR THE EXISTENCE OR NON-EXISTENCE OF ANY UNDERGROUND UTILITY PIPE, OR STRUCTURE WITHIN THE LIMITS OF THIS PROJECT. THIS NOTE APPLIES TO ALL PAGES.  
 IF WORK IS TO BE DONE ON A STATE HIGHWAY, A PERMIT MUST BE OBTAINED FROM THE STATE OF CALIFORNIA, DIVISION OF HIGHWAYS, 120 SOUTH SPRING STREET, LOS ANGELES, CALIFORNIA.

COUNTY OF LOS ANGELES, CALIFORNIA  
 JOHN A. LAMBE, COUNTY ENGINEER  
 APPROVED BY: [Signature]  
 REGIONAL ENGINEER

J. D. PARKHURST, CHIEF ENGINEER  
 APPROVED BY: [Signature]  
 OFFICE ENGINEER

CHECKED BY: [Signature]  
 REG. C.E. NO. 2456

J.N. 0369.20

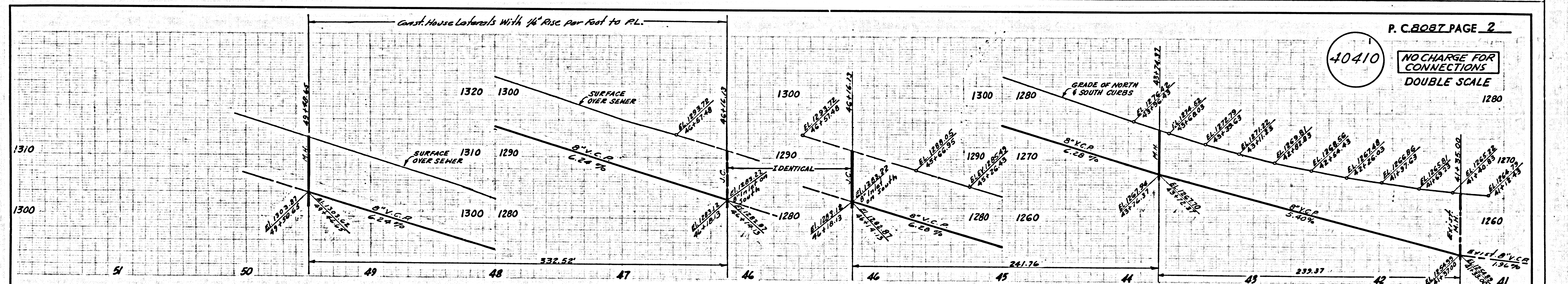

P.C. 8087 PAGE 2  
 40410  
 NO CHARGE FOR CONNECTIONS  
 DOUBLE SCALE

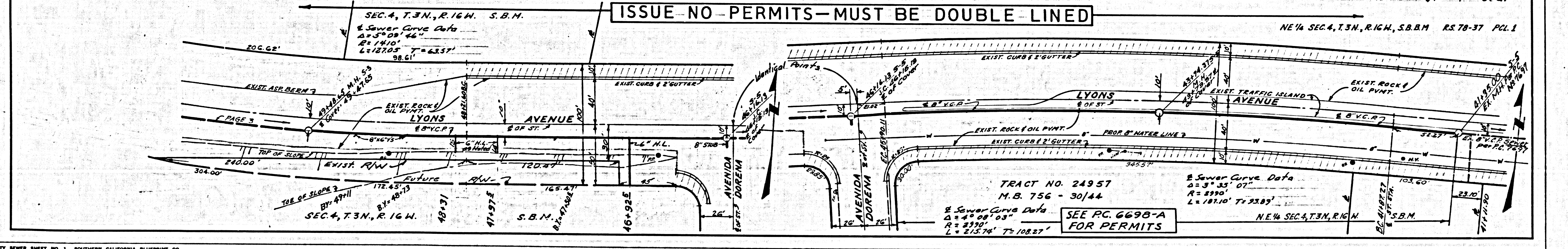

NO CHARGE FOR CONNECTIONS  
DOUBLE SCALE

40411

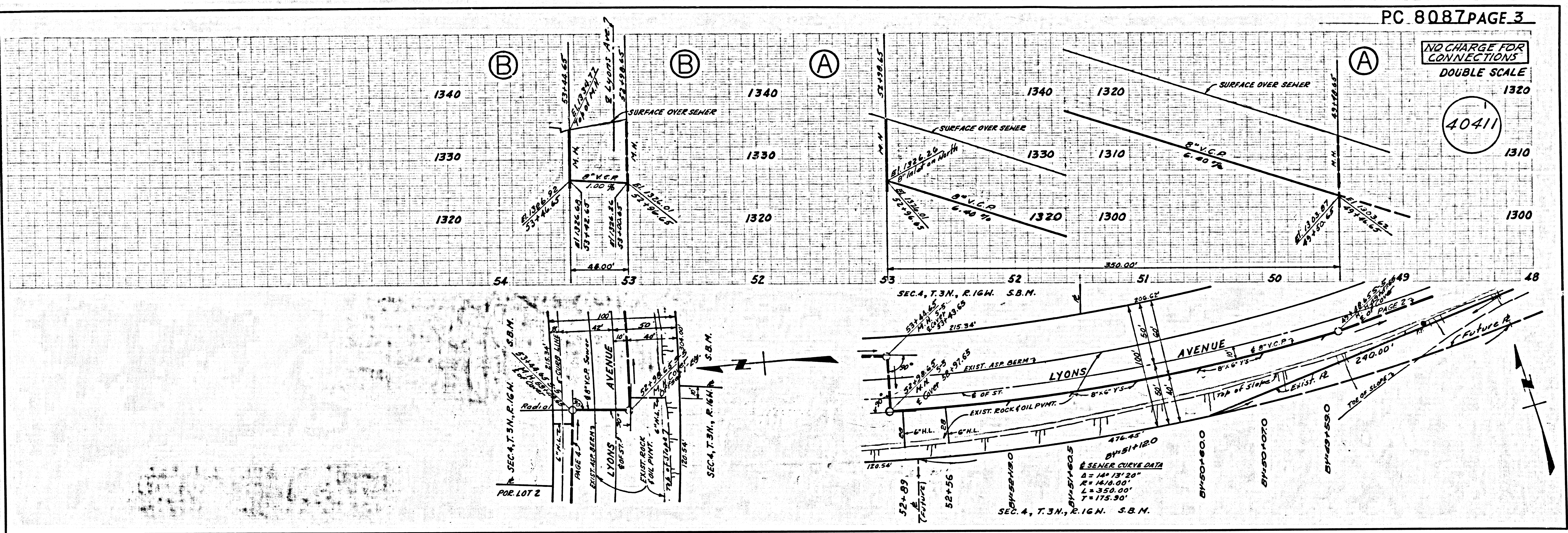

NO CHARGE FOR CONNECTIONS  
DOUBLE SCALE

40412

