

B.M. BY 5203 ELEV. 333.938  
 Co. Rd. Dept.  
 L.A. B.N. N. 03, 1 FT. W. B.C.R. @  
 N.W. COR. FEDERAL OR A STREET  
 W. RIVERA QUAD. 19 65

THE FOLLOWING COUNTY ENGINEER'S STANDARD PLANS APPLY TO THIS PROJECT

Legend	S-1
Min. Public Safety Requirements	S-2
Brick Manhole	S-3
Non Reinforced Precast Concrete Manhole	S-4
Reinforced Precast Concrete Manhole	S-5
Manhole Frame and Cover	S-6
Manhole Step	S-7
Building for Sewer Pipe	S-21
Cracking and Easement	S-23
Two or Two Support	S-28
Allowable Trench Widths	S-33

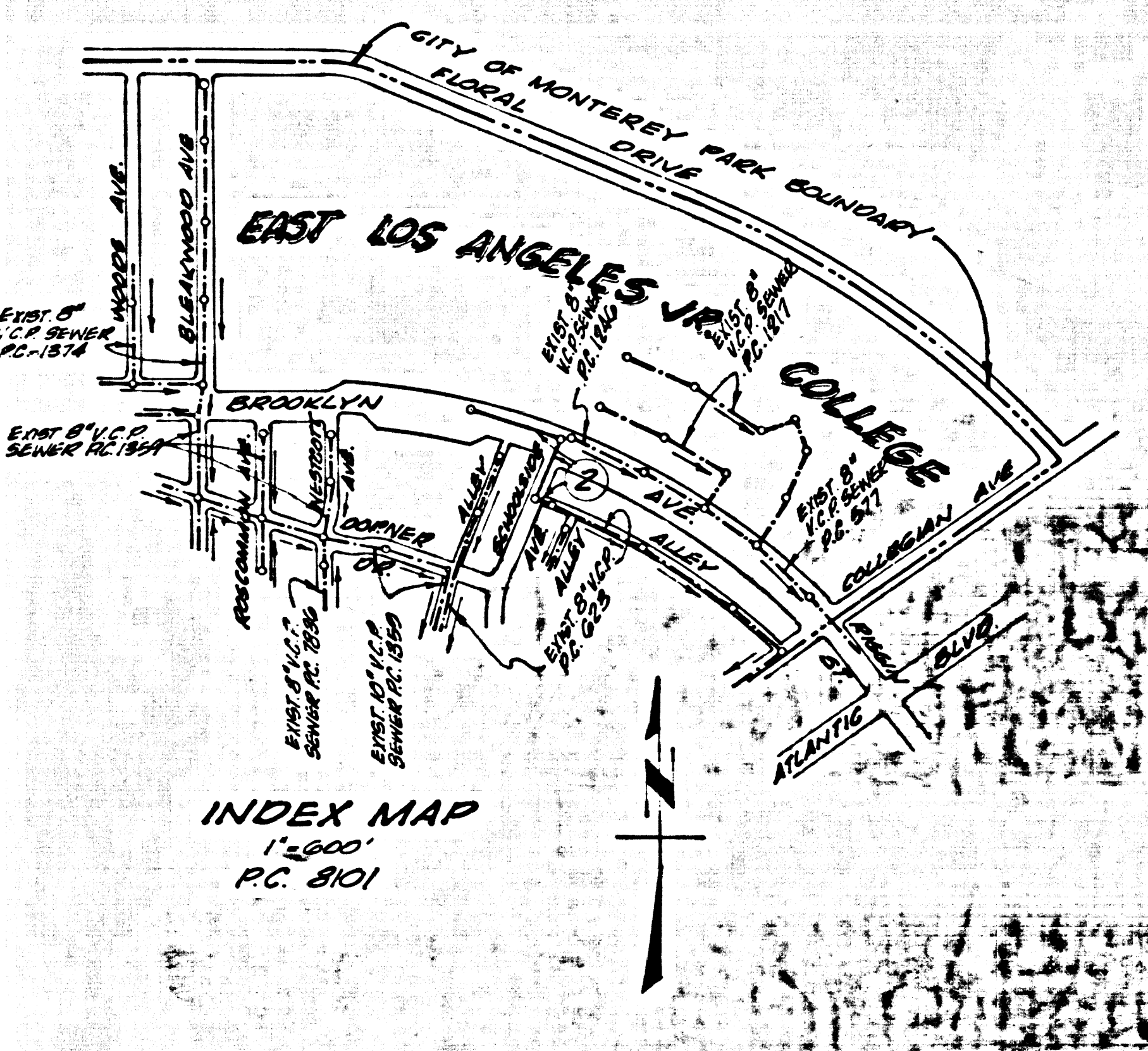

NOTES: (CONTINUED FROM RIGHT HEREON)

22. ALL STATE AND LOCAL TRENCH SAFETY ORDINANCES WILL BE STRICTLY ENFORCED.

23. INDEPTHS IN EXISTING AT ENDS OF HOUSE LATERALS INDICATE 1/4" SHALL BE Laid AND CONTROL AND HOUSE LATERALS SHALL BE CONSTRUCTED WITH 1/4" RISE PER FOOT TO PROPERTY LINE.

24. THE LOCATION OF ALL UTILITIES INDICATED ON THESE DRAWINGS ARE TAKEN FROM EXISTING PUBLIC AND UTILITY COMPANY RECORDS. IT SHALL BE THE SOLE RESPONSIBILITY OF THE CONTRACTOR TO DETERMINE THE EXACT LOCATION AND ELEVATION OF ALL EXISTING UTILITIES AND FACILITIES AND ALSO INDICATE ANY ADDITIONAL UTILITIES AND FACILITIES OTHER THAN THOSE SHOWN ON THE DRAWINGS. THE CONTRACTOR SHALL BE RESPONSIBLE FOR TAKING APPROPRIATE MEASURES TO PROTECT AND EXISTING UTILITIES AND/OR FACILITIES FROM DAMAGE IN ACCORDANCE WITH THE GOVERNMENT AGENCY HAVING JURISDICTION AND/OR THE UTILITY COMPANY INVOLVED.

25. All Permitted structures shall be notified prior to the following as they require inspection and be made (Phone)

(1) Scheduling of construction of curbs on District trunk sewer.

(2) Scheduling of existing curbs on District trunk sewer.

(3) Scheduling of existing curbs on District trunk sewer.

(4) Scheduling of house connections to District trunk sewer.

(5) Acceptance of the project.

NO CHARGES FOR THE REVISIONS IN THIS DRAWING. THE CONTRACTOR SHALL BE RESPONSIBLE FOR OBTAINING ALL NECESSARY PERMITS FROM THE COUNTY ENGINEER AND GENERAL MANAGER OF THE COUNTY PLANTATION DISTRICTS.

EAST LOS ANGELES BLDG. DIST. NO. 6

NOTE:

- HOUSE STAGES ON THE PROPERTY LINE OR PROPERTY LINES PRODUCED AT RIGHT ANGLES TO THE SEWER LINE AT THE CENTER LINE OF EACH MANHOLE.
- NO REPRESENTATIVE OF THE COUNTY ENGINEER WILL SURVEY OR LAY OUT ANY PORTION OF THE WORK.
- THE ENGINEER'S PLAN SHALL FURNISH THE COUNTY ENGINEER WITH GRADE SHEETS AND STATIONING FOR ALL HOUSE LATERALS AND "Y" BRANCHES AND SHALL PROVIDE STAKES FOR THEM AT THEIR PROPER LOCATIONS WITH STATIONING PLAINLY MARKED. ALL HOUSE LATERALS SHALL BE CONSTRUCTED IN A STRAIGHT ALIGNMENT AT RIGHT ANGLES FROM THE MAIN LINE SEWER EXCEPT AS SHOWN ON THE PLANS. HOUSE LATERALS FROM CHIMNEYS SHALL NOT HAVE AN ANGLE OF LESS THAN 45° WITH THE MAIN LINE SEWER. ANY CHANGE IN ALIGNMENT SHALL BE REQUESTED BY WRITING BY THE PRIVATE ENGINEER.
- THE PRIVATE ENGINEER SHALL FURNISH THE HOUSE LATERAL DEPTH AT THE PROPERTY LINE BELOW THE TOP OF CURB TWENTY-FOUR INCHES LATERAL ON THE GRADE SHEET.
- NO REVISIONS SHALL BE MADE IN THESE PLANS WITHOUT THE APPROVAL OF THE COUNTY ENGINEER.
- THE CONTRACTOR SHALL NOTIFY THE CONSTRUCTION DIVISION BY TELEPHONE, MADISON 9-4747, EXT. 8155, AT LEAST TWENTY-FOUR HOURS BEFORE STARTING ANY WORK UNDER THE CONTRACT.
- ALL STRUCTURES ARE PRECAST CONCRETE MANHOLES PER S-5 OR S-6.
- "Y" OR "T" BRANCHES MAY BE USED FOR CONNECTIONS TO MANHOLE SERVICES EXCEPT AS NOTED.
- MANHOLE TOPS IN UNIMPROVED RIGHTS OF WAY TO BE SIX INCHES ABOVE FINISHED GRADE.
- USE EXTRA STRENGTH PIPE ALL PIPE IS STANDARD DEPTH EXCEPT AS NOTED.
- INTERFED CLAY PIPE JOINTS SHALL BE TYPE "D", "E", OR "F" PER STANDARD SPECIFICATIONS SEC. 208.2.
- ALL JOINTS BETWEEN CAST IRON PIPE AND INTERFED CLAY PIPE SHALL BE MADE WITH A RUBBER GASKET JOINT, TYPE "C" OR "D", (WITH BUSHING IF NECESSARY) PER STANDARD SPECIFICATIONS SEC. 208.2.
- IF A POWER POLE IS WITHIN THREE FEET OF THE SEWER, THE SEWER SHALL BE ENCASED, PER S-25, TWO FEET ON EACH SIDE FROM THE POINT OF INTERFERENCE.
- IF DURING THE COURSE OF CONSTRUCTION IT IS DETERMINED THAT THERE IS LESS THAN FOUR FEET OF COVER OVER THE TOP OF A MAIN LINE OR HOUSE LATERAL V.C.P. SEWER WHICH IS NOT INDICATED ON THE PLANS, THE PIPE SHALL BE ENCASED PER S-25, UNLESS OTHERWISE APPROVED BY THE COUNTY ENGINEER.
- HOUSE LATERALS TO BE CONSTRUCTED WITH BRVETS AT PROPERTY LINE... FEET BELOW CURB GRADE EXCEPT AS NOTED.
- RESURFACE ALL TRENCHES WITHIN PAVED AREAS TO MEET L.A. COUNTY ROAD DEPT. OR CALIFORNIA STATE HIGHWAY REQUIREMENTS IN ACCORDANCE WITH PERMITS.
- CONFORM TO THE TRENCHING STANDARD PER SEC. 208-2.5, STANDARD SPECIFICATIONS.
- Between the hours of 8:30 A.M. & 5:30 P.M. a minimum of one (1) foot traffic lane in each direction in the main roadway of a residential street shall be maintained. All other streets shall be maintained in the same manner. In other words, the contractor shall be responsible for maintaining the roadway in the same manner as the public works department. If the contractor fails to do so, the public works department will be responsible for the operations of the permittees will be replaced at the permittees expense.
- During school hours the available parking space for traffic shall be maintained. During the month of the service road at the north side of Brooklyn Ave.
- All pavement or base removed during the course of construction shall be replaced with crushed aggregate base to the same thickness as existing of Type II A.C. to the same thickness as the existing pavement shall be, all per the STANDARD PUBLIC WORKS SPECIFICATIONS. (NOTES CONTINUED LEFT HEREON)

COLLECT CHARGES AS INDICATED

REVISION: JULY 25, 1968  
 HOUSE LATERAL WAS REVISED FROM 1/4" RISE PER FOOT TO 1/8" RISE PER FOOT.  
 APPROVED: [Signature] C.E. # 114  
 OFFICE OF COUNTY ENGINEER (R.E.S.)

PROFILE ALIGNMENT AND GRADE OF  
 SANITARY SEWERS  
 TO BE CONSTRUCTED IN

BROOKLYN AVENUE  
 PRIVATE CONTRACT NO. 8101

W.S. 86, B-2  
 1 SHEETS, 2 PAGES  
 SCALE: VERT. 1"=4'  
 HORIZ. 1"=40'  
 JULY, 1968  
 PREPARED IN THE OFFICES OF  
 SIDELCO  
 1125 N. GUY ST.  
 LOS ANGELES, CALIF.  
 BY: [Signature]  
 REG. C.E. NO. 14074  
 FOR LEGEND SEE PLAN NO. S-1

NOTE:  
 GRADES TO WHICH THIS IMPROVEMENT IS TO BE CONSTRUCTED ARE SHOWN ON PLANS AND PROFILES. GRADE POINTS FOR TOP OF CURBS, CENTER LINE OF STREETS, OR CENTER LINE OF ALLEYS ARE SHOWN BY CIRCLES ON PROFILES. AT ALL POINTS BETWEEN DESIGNATED POINTS THE GRADE SHALL BE ESTABLISHED SO AS TO CONFORM TO A STRAIGHT LINE DRAWN BETWEEN SAID DESIGNATED POINTS. ELEVATIONS ARE IN FEET ABOVE U.S.C. & G.S. SEA LEVEL UNLESS OTHERWISE NOTED.  
 THIS DRAWING AND THE DATA HEREON ARE HEREBY MADE A PART OF THE SPECIFICATIONS.  
 BEFORE WORK CAN BE STARTED, THE CONTRACTOR MUST OBTAIN A PERMIT TO EXCAVATE IN THE CITY OF LOS ANGELES FROM THE COUNTY ROAD DEPT., DISTRICT OFFICE NO. 1, AND PAY A FEE TO THE COUNTY ENGINEER, ROOM 300, COUNTY ENGINEERING BUILDING, 100 WEST SECOND STREET, LOS ANGELES, CALIF. REGIONAL OFFICE, SUBJECT TO COVER THE COST OF CONSTRUCTION INSPECTION AND RECORD PLANS.  
 APPROVAL OF THIS PLAN BY THE COUNTY OF LOS ANGELES DOES NOT CONSTITUTE A REPRESENTATION AS TO THE ACCURACY OF THE LOCATION OF OR THE EXISTENCE OR NON-EXISTENCE OF ANY UNDERGROUND UTILITY PIPE, OR STRUCTURE WITHIN THE LIMITS OF THIS PROJECT. THIS NOTE APPLIES TO ALL PAGES.  
 IF WORK IS TO BE DONE IN A STATE HIGHWAY, A PERMIT MUST BE OBTAINED FROM THE STATE OF CALIFORNIA, DIVISION OF HIGHWAYS, 120 SOUTH SPRING STREET, LOS ANGELES, CALIFORNIA.

COUNTY OF LOS ANGELES, CALIFORNIA  
 JOHN A. LAMBIE, COUNTY ENGINEER J. D. PARKHURST, CHIEF ENGINEER  
 CO. SAN. DIST. NO. 1-10-68  
 APPROVED BY: [Signature] APPROVED BY: [Signature]  
 REGIONAL ENGINEER OFFICE ENGINEER

CHECKED BY: [Signature] JULY 14, 1968  
 REG. C.E. NO. 3441  
 J.N. 0369.24

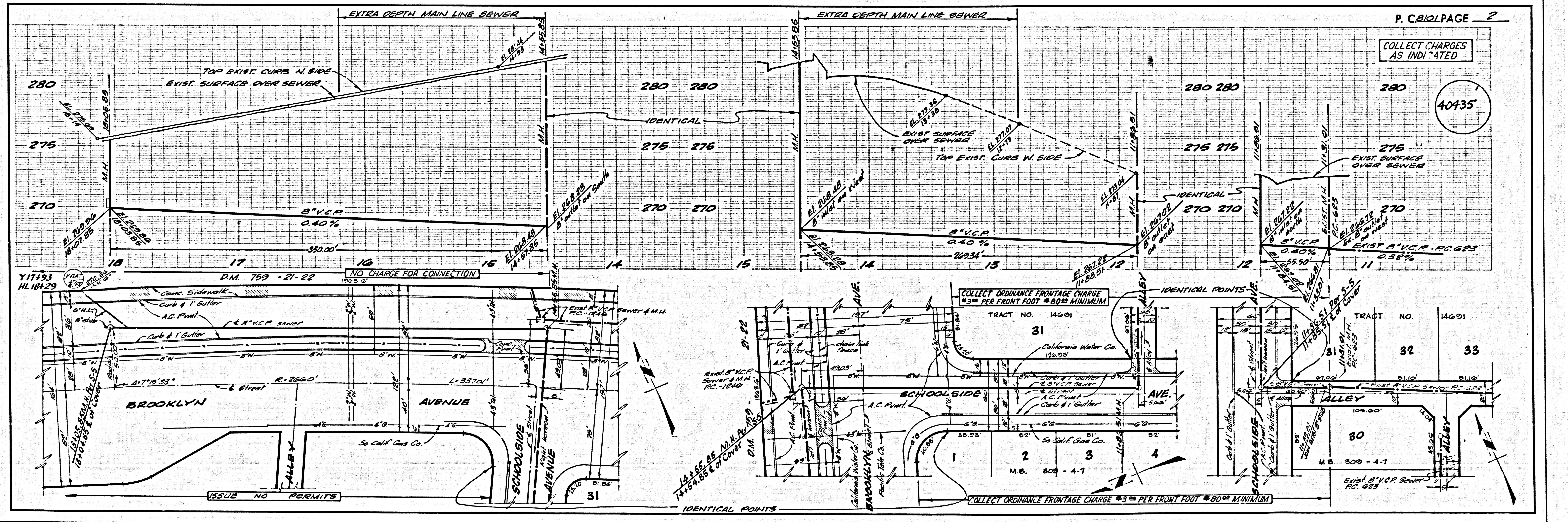

COLLECT CHARGES AS INDICATED

40435

COLLECT ORDINANCE FRONTAGE CHARGE \$3 PER FRONT FOOT \$80 MINIMUM

COLLECT ORDINANCE FRONTAGE CHARGE \$3 PER FRONT FOOT \$80 MINIMUM