

B.M. BY-4424 ELEV. 503.405
 MARKED BY 3433-3 36 589
 County Surveyor Cap Monument Flush
 with ground 132' Ely. & 38' Nly of 6 in. Silver
 Spur Rd. & Palos Verdes Dr. N., 225' Sly. wood nail fence
 PALOS VERDES QUAD. 1965 ADJ.

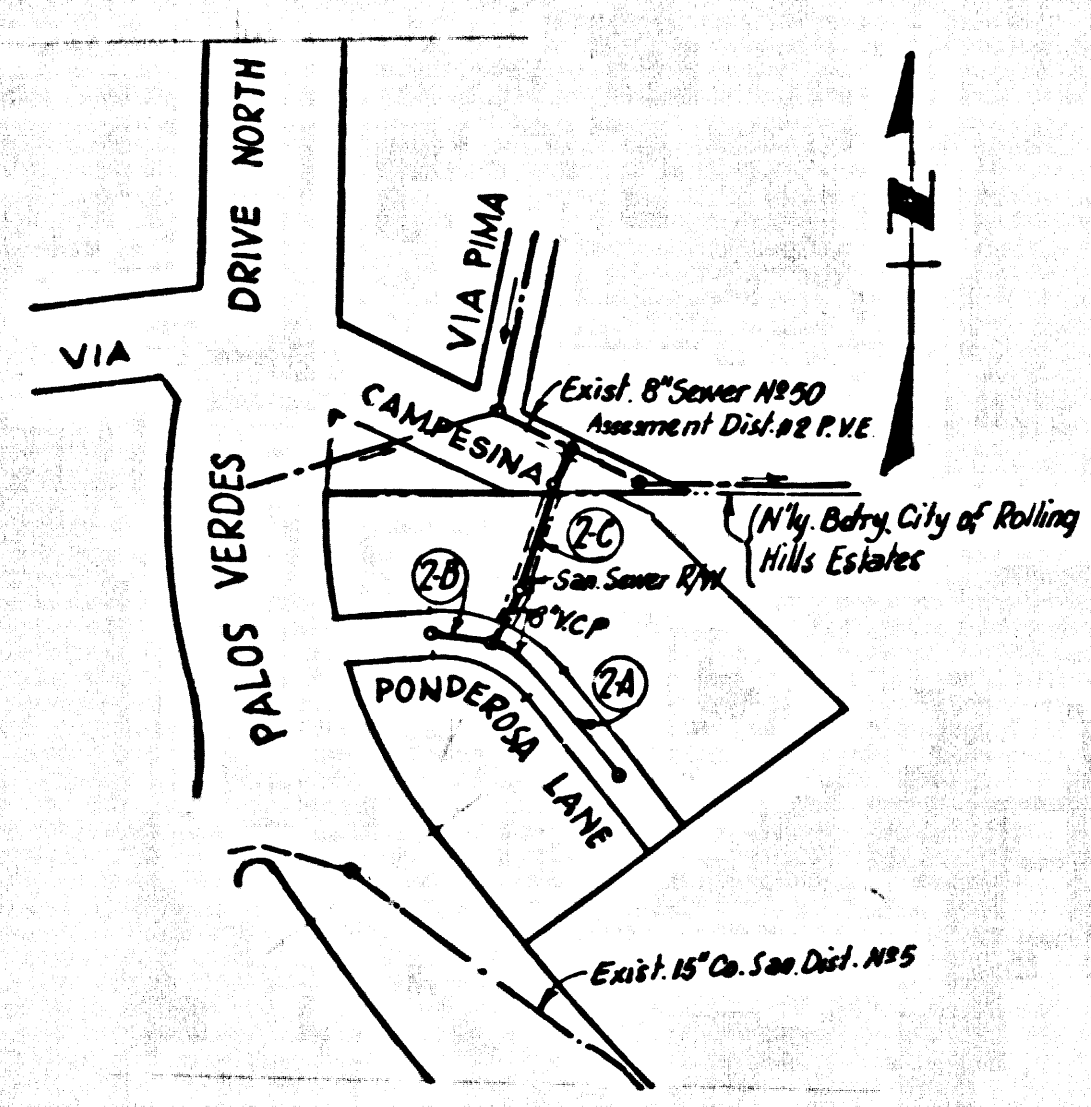

INDEX MAP
 P.C. NO. 8106
 SCALE 1"=300'

NO CONNECTIONS FOR THE DISPOSAL OF INDUSTRIAL WASTES SHALL BE MADE TO SEWERS SHOWN ON THESE DRAWINGS WITHOUT WRITTEN PERMISSION FROM THE CHIEF ENGINEER AND GENERAL MANAGER OF THE COUNTY SANITATION DISTRICTS.

County Sanitation Districts shall be contacted prior to the following so that required inspection can be made (Phone 800-8000 - 434-3097)
 Acceptance of the project.

DOUBLE SCALE
 CITY OF ROLLING HILLS ESTATES BLDG. DIST. NO. 12.03

PROFILE ALIGNMENT AND GRADE OF P.C. 8106
 SANITARY SEWERS PAGE 1
 TO BE CONSTRUCTED IN

TRACT N° 22919
 PRIVATE CONTRACT NO. 8106

W.S. 27
 1 SHEET OF 2 PAGES
 SCALE: VERT. 1"=5' HORIZ. 1"=40'
 JUNE, 1968
 PREPARED IN THE OFFICES OF
 SOUTH BAY ENGINEERING CORP.

by Raymond L. Douglas
 REG. C. E. NO. 7191
 FOR LEGEND SEE PLAN NO. S-6-64

40856

- NOTES:
1. PROVIDE STAKES ON THE PROPERTY LINE OR PROPERTY LINES PRODUCED AT RIGHT ANGLES TO THE SEWER LINE AT THE CENTER LINE OF EACH MANHOLE.
 2. NO REPRESENTATIVE OF THE CITY ENGINEER WILL SURVEY OR LAY OUT ANY PORTION OF THE WORK.
 3. THE PRIVATE ENGINEER SHALL FURNISH THE CITY ENGINEER WITH GRADE SHEETS AND STATIONING FOR ALL HOUSE LATERALS AND Y-BRANCHES AND SHALL PROVIDE STAKES FOR THEM AT THEIR PROPER LOCATIONS WITH STATIONING PLAINLY MARKED. ALL HOUSE LATERALS SHALL BE CONSTRUCTED AT A STRAIGHT ALIGNMENT AT RIGHT ANGLES FROM THE MAIN LINE SEWER EXCEPT AS SHOWN ON THE PLANS. HOUSE LATERALS FROM CHIMNEYS SHALL NOT HAVE AN ANGLE OF LESS THAN 45° WITH THE MAIN LINE SEWER. ANY CHANGE IN ALIGNMENT SHALL BE REQUESTED IN WRITING BY THE PRIVATE ENGINEER.
 4. THE PRIVATE ENGINEER SHALL FURNISH THE HOUSE LATERAL DEPTH AT THE PROPERTY LINE BELOW THE TOP OF CURB ELEVATION FOR EACH HOUSE LATERAL ON THE GRADE SHEET.
 5. NO REVISIONS SHALL BE MADE IN THESE PLANS WITHOUT THE APPROVAL OF THE CITY ENGINEER.
 6. THE CONTRACTOR SHALL NOTIFY THE CONSTRUCTION DIVISION BY TELEPHONE, MADISON 9-4747, EXT. 8151, AT LEAST TWENTY-FOUR HOURS BEFORE STARTING ANY WORK UNDER THIS CONTRACT.
 7. ALL STRUCTURES SHALL BE EITHER BRICK MANHOLES PER 8-3 OR PRECAST CONCRETE MANHOLES PER 5-5 OR 5-6, EXCEPT AS NOTED.
 8. USE STANDARD MANHOLE FRAMES AND COVERS, 2' 6", EXCEPT AS NOTED.
 9. MANHOLE TOPS IN UNIMPROVED RIGHTS-OF-WAY TO BE SIX INCHES ABOVE FINISHED GRADE.
 10. USE EXTRA STRENGTH PIPE. ALL PIPE IS STANDARD DEPTH EXCEPT AS NOTED.
 11. VERIFIED CLAY PIPE JOINTS SHALL BE TYPE "C" 3" OR 4" PER STANDARD SPECIFICATIONS SEC. 206-2.
 12. ALL STATE AND LOCAL SAFETY ORDERS SHALL BE STRICTLY ENFORCED PER STANDARD SPECIFICATIONS SECTION T-10 4.1
 13. IF A POWER POLE IS WITHIN THREE FEET OF THE SEWER, THE SEWER SHALL BE INCASED, PER 5-4-173, CASE III, TWO FEET ON EITHER SIDE FROM THE POINT OF INTERFERENCE.
 14. IF DURING THE COURSE OF CONSTRUCTION IT IS DETERMINED THAT THERE IS LESS THAN FOUR FEET OF COVER OVER THE TOP OF A MAIN LINE OR HOUSE LATERAL V.C.P. SEWER WHICH IS NOT INDICATED ON THE PLANS, THE PIPE SHALL BE INCASED PER 5-2.3 UNLESS OTHERWISE APPROVED BY THE COUNTY ENGINEER.
 15. HOUSE LATERALS TO BE CONSTRUCTED WITH INVERTS AT PROPERTY LINE, 6" ... FEET BELOW CURB GRADE EXCEPT AS NOTED.
 16. RESURFACE ALL TRENCHES WITHIN PAVED AREAS TO MEET "CITY" ROAD DEPT. OR CALIFORNIA STATE HIGHWAY REQUIREMENTS IN ACCORDANCE WITH PERMITS.
 17. SEWERS TO BE TESTED FOR LEAKAGE PER SECTION 306-3-3, STANDARD SPECIFICATIONS
 18. SPECIAL BACKFILL IN DESIGNATED AREAS:
 - (a) BACKFILL TRENCH AND REPLACE OTHER EARTH REMOVED SO AS TO ACHIEVE THE NATURAL OR FINISHED GRADE AND SLOPE SHOWN ON THE GRADE PLAN APPROVED FOR THIS TRACT BY THE BUILDING AND SAFETY DIVISION.
 - (b) ALL BACKFILL AND EARTH REPLACED SHALL BE COMPACTED TO A MINIMUM OF 90% OF MAXIMUM DENSITY PER A.S.T.M. STANDARD METHOD OF TEST D95, ST. AS MODIFIED. ACCEPTABLE CERTIFICATION OF SUCH COMPACTION SHALL BE SUBMITTED TO THE CONSTRUCTION DIVISION.
 19. THE FOLLOWING CITY ENGINEER STANDARD PLANS APPLY TO THIS PROJECT:

LEGEND	S-1
MINIMUM EXCAVATION SAFETY REQUIREMENTS	S-2
BRICK MANHOLE	S-3
NON-REINFORCED PRECAST CONC. MANHOLE	S-4
MANHOLE FRAME & COVER	S-15
MANHOLE STEP	S-17
BOXING FOR SEWER PIPE	S-21
ANCHOR BLOCK	S-24
PIPE END TEE SUPPORT	S-25
RAILROAD BOARD DETAIL	S-31
ALLOWABLE TRENCH WIDTHS	S-33
SPECIAL MANHOLE BASE	S-34

COLLECT CHARGES AS INDICATED

NOTES:
 GRADES TO WHICH THIS IMPROVEMENT IS TO BE CONSTRUCTED ARE SHOWN ON PLANS AND PROFILES. GRADE POINTS FOR TOP OF CURBS, CENTER LINE OF STREETS, OR CENTER LINE OF ALLEYS ARE SHOWN BY CIRCLES ON PROFILES. AT ALL POINTS BETWEEN DESIGNATED POINTS THE GRADE SHALL BE ESTABLISHED SO AS TO CONFORM TO A STRAIGHT LINE DRAWN BETWEEN SAID DESIGNATED POINTS. ELEVATIONS ARE IN FEET ABOVE U.S.C. & G.S. SEA LEVEL DATUM OF 1929. THE DRAWING AND DATA HEREON ARE HEREBY MADE A PART OF THE SPECIFICATIONS. WORK SHALL BE CONSTRUCTED ACCORDING TO STANDARD SPECIFICATIONS FOR PUBLIC WORKS CONSTRUCTION AND CITY ENGINEER SPECIAL PROVISIONS DATED FEB. 15, 1967. ALL PROVISIONS SHALL BE OBSERVED ONLY IN THE PRESENCE OF THE CITY ENGINEER. BEFORE WORK CAN BE STARTED, THE CONTRACTOR MUST OBTAIN A PERMIT TO EXCAVATE IN C.P.P. STREETS FROM THE L.A. COUNTY ROAD DEPT., DISTRICT OFFICE NO. 8, AND PAY A FEE TO THE CITY ENGINEER, INCHAP ROLLING HILLS COMM. ROLLING HILLS ESTATES, CALIFORNIA. APPROVAL OF THIS PLAN BY THE CITY OF ROLLING HILLS ESTATES DOES NOT CONSTITUTE A REPRESENTATION AS TO THE ACCURACY OF THE LOCATION OR THE EXISTENCE OR NON-EXISTENCE OF ANY UNDERGROUND UTILITY PIPE, OR STRUCTURE WITHIN THE LIMITS OF THIS PROJECT. THIS NOTE APPLIES TO ALL PAGES. IF WORK IS TO BE DONE IN A STATE HIGHWAY, A PERMIT MUST BE OBTAINED FROM THE STATE OF CALIFORNIA, DIVISION OF HIGHWAYS, 120 SOUTH SPRING STREET, LOS ANGELES, CALIFORNIA.

CITY OF ROLLING HILLS ESTATES, CALIFORNIA
 JOHN A. LAMBIE, CITY ENGINEER
 APPROVED BY: Robert W. Miller REGIONAL ENGINEER
 APPROVED BY: St. Paulhaus OFFICE ENGINEER
 PALOS VERDES ESTATES
 CHECKED BY: Bernard J. Valdez REG. C.E. NO. 10673
 APPROVED BY: Burn B. Johnson BURN B. JOHNSON, R.C.E. 4242

