

B.M. B.G. 2487 ELEV. 420.853 (1965 ADJ.)
 C.S. TAG - W. CURB - 1' N. B.C.R. AT N.W. CORNER
 OF HALLIBURTON RD. & STIMSON AVE 65' N. & 25'
 W. OF C/L INTERSECTION.
 OTTEKBEIN QUAD. 19 65

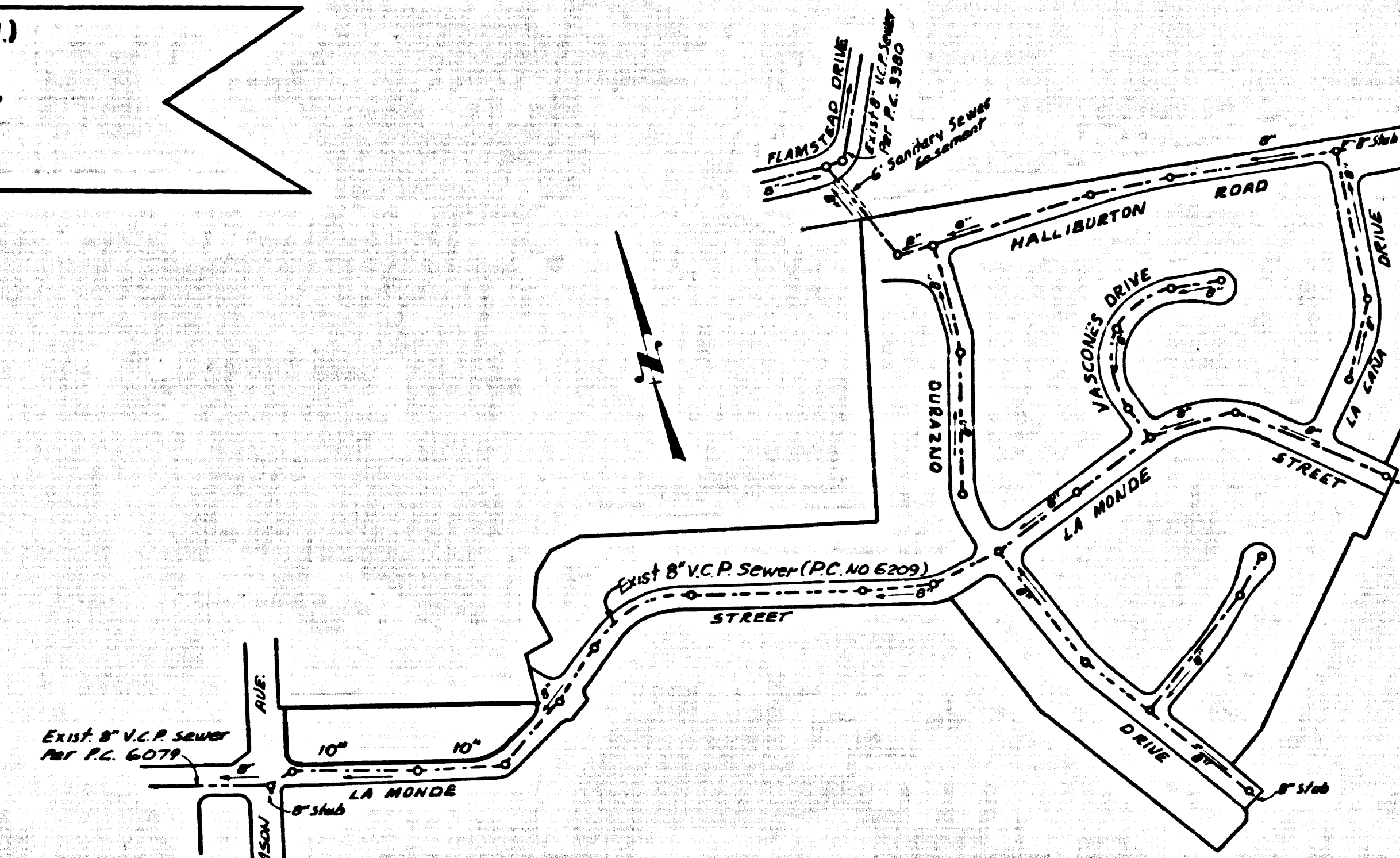

INDEX MAP
 TRACT No. 27767
 P.C. 8113
 SCALE: 1" = 300'

DOUBLE SCALE
 LA PUENTE BLDG. DIST. NO. 2

- NOTES:
- PROVIDE STAKES ON THE PROPERTY LINE OR PROPERTY LINES PRODUCED AT RIGHT ANGLES TO THE SEWER LINE AT THE CENTER LINE OF EACH MANHOLE.
 - NO REPRESENTATIVE OF THE COUNTY ENGINEER WILL SURVEY OR LAY OUT ANY PORTION OF THE WORK.
 - THE PRIVATE ENGINEER SHALL FURNISH THE COUNTY ENGINEER WITH GRADE SHEETS AND STATIONING FOR ALL HOUSE LATERALS AND "T" OR "Y" BRANCHES AND SHALL PROVIDE STAKES FOR THEM AT THEIR PROPER LOCATIONS WITH STATIONING PLAINLY MARKED. ALL HOUSE LATERALS SHALL BE CONSTRUCTED IN A STRAIGHT ALIGNMENT AT RIGHT ANGLES FROM THE MAIN LINE SEWER EXCEPT AS SHOWN ON THE PLANS. HOUSE LATERALS FROM CHIMNEYS SHALL NOT HAVE AN ANGLE OF LESS THAN 45° WITH THE MAIN LINE SEWER. ANY CHANGE IN ALIGNMENT SHALL BE REQUESTED IN WRITING BY THE PRIVATE ENGINEER.
 - THE PRIVATE ENGINEER SHALL FURNISH THE HOUSE LATERAL SEPTA AT THE PROPERTY LINE BELOW THE TOP OF CURB ELEVATION FOR EACH HOUSE LATERAL ON THE GRADE SHEET.
 - NO REVISIONS SHALL BE MADE IN THESE PLANS WITHOUT THE APPROVAL OF THE COUNTY ENGINEER.
 - THE CONTRACTOR SHALL NOTIFY THE CONSTRUCTION DIVISION BY TELEPHONE, MADISON 5-2747, EXT. 8158, AT LEAST TWENTY-FOUR HOURS BEFORE STARTING ANY WORK UNDER THIS CONTRACT.
 - ALL STRUCTURES SHALL BE EITHER BRICK, MANHOLES PER 5-3 OR PRECAST CONCRETE MANHOLES PER 5-3 OR 5-4, EXCEPT AS NOTED.
 - "T" OR "Y" BRANCHING MAY BE USED FOR CONNECTIONS TO MANHOLE SEWERS EXCEPT AS NOTED.
 - MANHOLE TOPS IN UNIMPROVED RIGHTS-OF-WAY TO BE SIX INCHES ABOVE FINISHED GRADE.
 - USE EXTRA STRENGTH PIPE. ALL PIPE IS STANDARD DEPTH EXCEPT AS NOTED.
 - VITRIFIED CLAY PIPE JOINTS SHALL BE TYPE "D" OR "E", OR "F" PER STD. SPEC. SEC. 508-2.
 - IF A POWER POLE IS WITHIN THREE FEET OF THE SEWER, THE SEWER SHALL BE ENCASED, PER 5-23, TWO FEET ON EACH SIDE FROM THE POINT OF INTERFERENCE.
 - IF DURING THE COURSE OF CONSTRUCTION IT IS DETERMINED THAT THERE IS LESS THAN FOUR FEET OF COVER OVER THE TOP OF A MAIN LINE OR HOUSE LATERAL V.C.P. SEWER WHICH IS NOT INDICATED ON THE PLANS, THE PIPE SHALL BE ENCASED PER 5-23, UNLESS OTHERWISE APPROVED BY THE COUNTY ENGINEER.
 - HOUSE LATERALS TO BE CONSTRUCTED WITH INVERTS AT PROPERTY LINE & FEET BELOW CURB GRADE EXCEPT AS NOTED.
 - RESURFACE ALL TRENCHES WITHIN PAVED AREAS TO MEET L.A. COUNTY ROAD DEPT. OR CALIFORNIA STATE HIGHWAY REQUIREMENTS IN ACCORDANCE WITH PERMITS.
 - SEWERS TO BE TESTED FOR LEAKAGE PER SECTION 506.3.7 UNIFORM STANDARD SPECIFICATIONS.
 - REFER TO SECTION 7-10, & 1. THE STANDARD SPECIFICATIONS REGARDING SAFETY ORDERS.
 - SPECIAL BACKFILL IN DESIGNATED AREAS.
 - IN BACKFILL TRENCH AND REPLACE OTHER EARTH REMOVED SO AS TO ACHIEVE THE NATURAL OR FINISHED GRADES AND SLOPES SHOWN ON THE GRADING PLAN APPROVED FOR THIS TRACT BY THE BUILDING AND SAFETY DIVISION.
 - ALL BACKFILL AND EARTH REPLACES SHALL BE COMPACTED TO A MINIMUM OF 90% OF MAXIMUM DENSITY PER A.S.T.M. STAND. AND METHOD OF TEST D95-57 AS MODIFIED. ACCEPTABLE CERTIFICATION OF SUCH COMPACTION SHALL BE SUBMITTED TO THE CONSTRUCTION DIVISION.
 - ALL JOINTS BETWEEN CAST IRON PIPE AND VITRIFIED CLAY PIPE SHALL BE MADE WITH A RUBBER SLAB JOINT TYPE "C" OR "D" (WITH GUNITE IN INTERJOINT) PER STANDARD SPECIFICATIONS, SECTION 508-2.
 - INDICATED HOUSE LATERALS TO BE CONSTRUCTED WITH 18" COVER AND 2' TO PROPERTY LINE.

- THE FOLLOWING COUNTY SUBMITTALS STANDARD PLANS APPLY TO THIS PROJECT:
- LEGEND: - - - - - 5-1
 MIN. PUBLIC SAFETY REQUIREMENTS - - - - - 5-2
 BIDDING FOR SEWER PIPE - - - - - 5-21
 CHALLENGE AND BACKSUPPORT - - - - - 5-23
 WYS OR TSS SUPPORT - - - - - 5-26
 ALLOWABLE TRENCH WIDTHS - - - - - 5-28

COLLECT TRENCH CHARGES
 AS INDICATED

PROFILE ALIGNMENT AND GRADE OF
 SANITARY SEWERS
 CONSTRUCTED IN

P.C. 8113
 PAGE 1

TRACT No. 27767
 PRIVATE CONTRACT NO. 8113

W.S. 38 A-4
 1 SHEETS; 2 PAGES
 SCALE: VERT. 1" = 8'
 HORIZ. 1" = 40'
 JUNE, 1968
 PREPARED IN THE OFFICES OF
 KEMMERER ENGINEERING CO. INC.
 6705 SOUTH PAINTER AVE., WHITTIER, CALIF.
 BY: Robert R. Flores
 ROBERT R. FLORES REG. C. E. NO. 11362

40342

FOR LEGEND SEE PLAN NO. 5-1

NOTE:
 GRADES TO WHICH THIS IMPROVEMENT IS TO BE CONSTRUCTED ARE SHOWN ON PLANS AND PROFILES. GRADE POINTS FOR TOP OF CURBS, CENTER LINE OF STREETS, OR CENTER LINE OF ALLEYS ARE SHOWN BY CIRCLES ON PROFILES. AT ALL POINTS BETWEEN DESIGNATED POINTS THE GRADE SHALL BE ESTABLISHED SO AS TO CONFORM TO A STRAIGHT LINE DRAWN BETWEEN SAID DESIGNATED POINTS. ELEVATIONS ARE IN FEET ABOVE U.S.C. & G.S. SEA LEVEL DATUM OF 1929.
 THIS DRAWING AND THE DATA HEREON ARE HEREBY MADE A PART OF THE SPECIFICATIONS.
 WORK SHALL BE CONSTRUCTED ACCORDING TO THE UNIFORM STANDARD SPECIFICATIONS FOR PUBLIC WORKS CONSTRUCTION AND COUNTY ENGINEER SPECIAL PROVISIONS DATED FEB. 12, 1968, AS REVISED, AND SHALL BE PROSECUTED ONLY IN THE PRESENCE OF THE COUNTY ENGINEER.
 BEFORE WORK CAN BE STARTED, THE CONTRACTOR MUST OBTAIN A PERMIT TO EXCAVATE IN COUNTY STREETS FROM THE L.A. COUNTY ROAD DEPT., DISTRICT OFFICE NO. _____ AND PAY A FEE TO THE COUNTY ENGINEER FROM THE COUNTY ENGINEERING BUDGET FOR WEST SECOND STREET ON 201' E. BOUTWELL AVE. SAN DIMAS REGIONAL OFFICE, SUFFICIENT TO COVER THE COST OF CONSTRUCTION INSPECTION AND RECORD PLANS.
 APPROVAL OF THIS PLAN BY THE COUNTY OF LOS ANGELES DOES NOT CONSTITUTE A REPRESENTATION AS TO THE ACCURACY OF THE LOCATION OR OF THE EXISTENCE OR NON-EXISTENCE OF ANY UNDERGROUND UTILITY PIPE, OR STRUCTURE WITHIN THE LIMITS OF THIS PROJECT. THIS NOTE APPLIES TO ALL PAGES.
 IF WORK IS TO BE DONE IN A STATE HIGHWAY, A PERMIT MUST BE OBTAINED FROM THE STATE OF CALIFORNIA, DIVISION OF HIGHWAYS, 130 SOUTH SPRING STREET, LOS ANGELES, CALIFORNIA.

COUNTY OF LOS ANGELES, CALIFORNIA
 JOHN A. LAMBIE, COUNTY ENGINEER

APPROVED BY: *B.T. Hocking*
 SAN DIMAS REGIONAL ENGINEER

CHECKED BY: *Wm. J. Lee* 6-28-68
 REG. C.E. NO. 12483

J.N. 0250.02

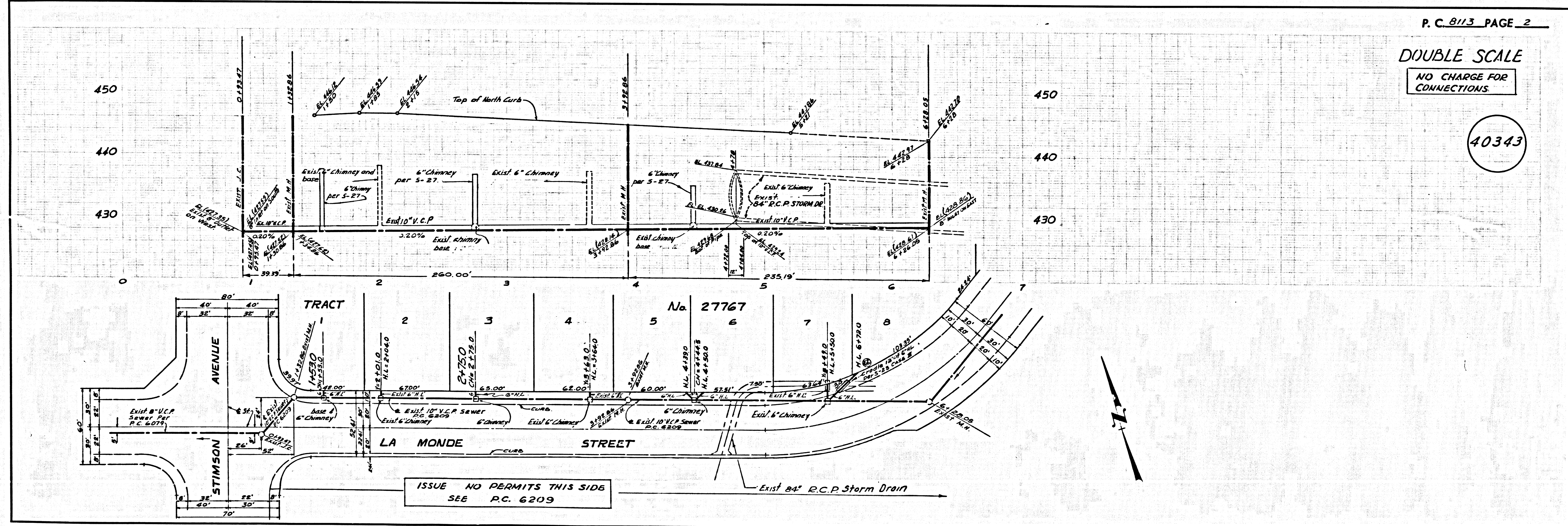

P.C. 8113 PAGE 2

DOUBLE SCALE
 NO CHARGE FOR
 CONNECTIONS

40343