

B.M. BY 5787 ELEV. 49.277
 U.S.C. & S.P.R. near N. end of S.P.R. Curb
 NW 1/4 of S.P.R. Tracts, 67' E. of
 Alameda St. & 450' S. of Int. Alameda
 St. & S.P.R. Med. (P.C. 8134)
 GARDENA QUAD. 19 62

THE FOLLOWING LATEST REVISED STANDARD PLANS ON FILE IN THE OFFICE OF COUNTY ENGINEER SHALL APPLY IN THE CONSTRUCTION OF THIS PROJECT.

LEGEND	
MINIMUM EXCAVATION SAFETY REQUIREMENTS	S-3
BRICK MANHOLE	S-3
NON-REINFORCED PRECAST CONCRETE MANHOLE	S-5
REINFORCED PRECAST CONCRETE MANHOLE	S-6
LARGE GAS TRAP MANHOLE BASE	S-11
MANHOLE FRAME AND COVER	S-15
STANDARD MANHOLE STEP	S-17
LARGE GAS TRAP	S-19
BEDDING FOR SEWER PIPE	S-21
WYE OR TEE SUPPORT	S-26
STOPPER	S-30
ALLOWABLE TRENCH WIDTHS	S-33
CRADLING AND ENCASEMENT	S-33
SPECIAL SUPPORT AND PROTECTION	S-32

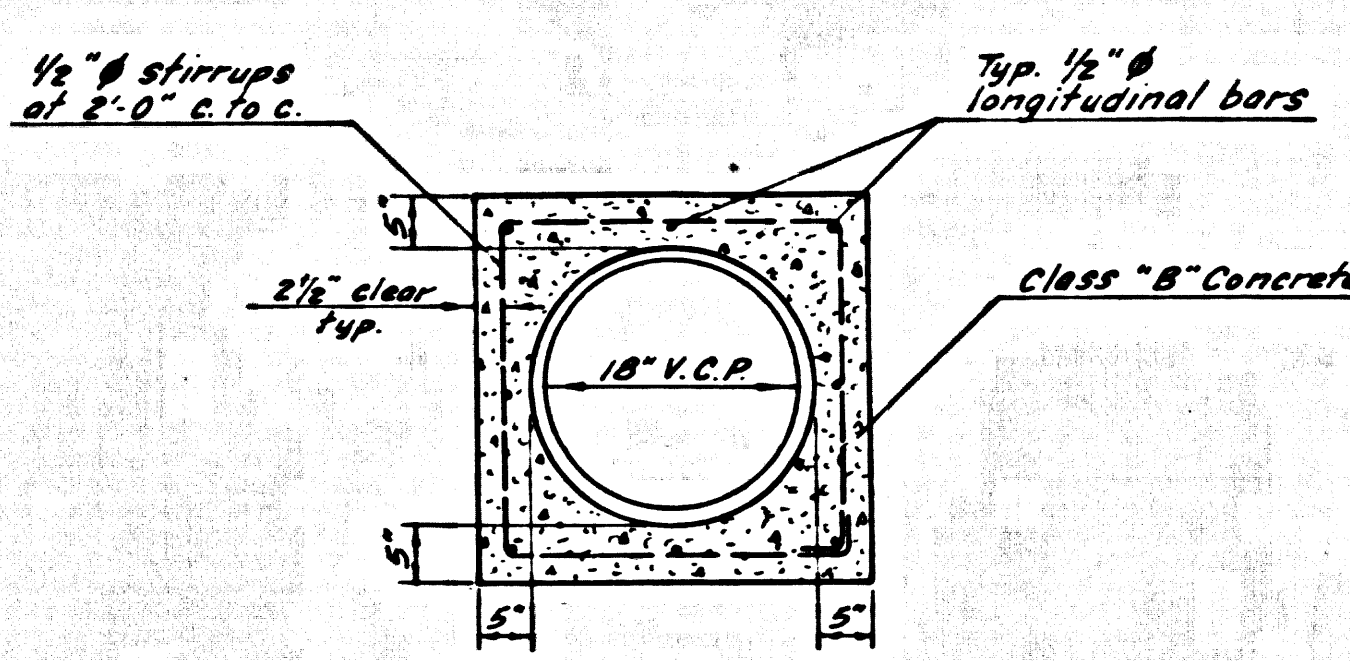

No connections for the disposal of industrial wastes shall be made to sewers shown on these drawings without written permission from the Chief Engineer and General Manager of the County Sanitation Districts.

County Sanitation Districts shall be notified prior to the following as that required inspection can be made (Phone 888-8888 or 888-8097):

Core Drilling District trunk sewer.

Acceptance of the project.

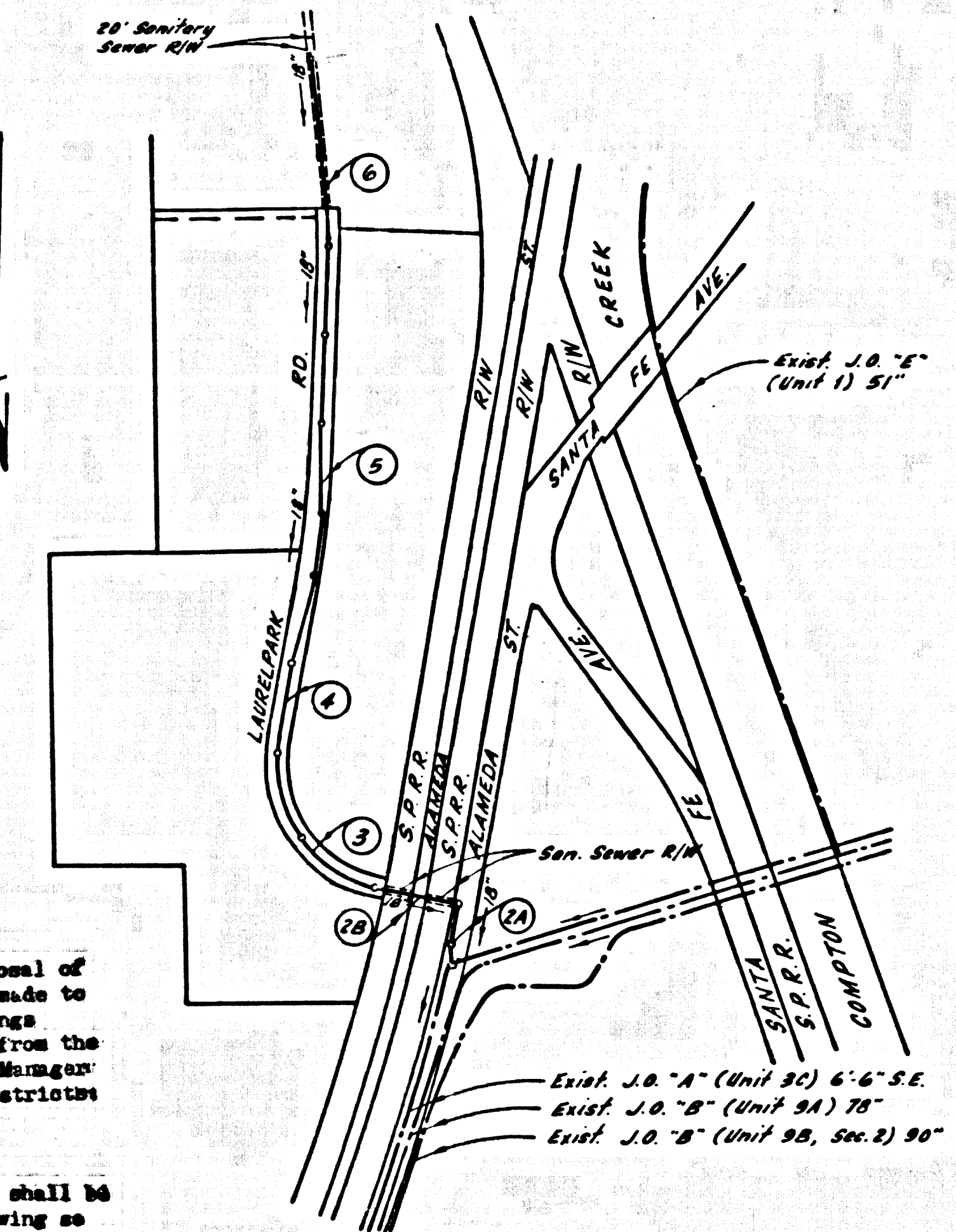

REVISION "1" 4-29-63
 CHANGE CURB FROM 30" DIA. - 1/2" THICK
 TO 45" DIA. - 5/8" THICK
 BY: [Signature] DATE: 4-29-63
 CHD BY: [Signature]

LENNOX BLDG. DIST. NO. 7

- NOTES:
1. PROVIDE STAKES ON THE PROPERTY LINE OR PROPERTY LINES PRODUCED AT RIGHT ANGLES TO THE SEWER LINE AT THE CENTER LINE OF EACH MANHOLE.
 2. THE REPRESENTATIVE OF THE COUNTY ENGINEER WILL SURVEY OR LAY OUT ANY PORTION OF THE WORK.
 3. THE PRIVATE ENGINEER SHALL FURNISH THE COUNTY ENGINEER WITH GRADE SHEETS AND STATIONING FOR ALL HOUSE LATERALS AND "DE-T" BRANCHES AND SHALL PROVIDE STAKES FOR THEM AT THEIR PROPER LOCATIONS WITH STATIONING PLAINLY MARKED. ALL HOUSE LATERALS SHALL BE CONSTRUCTED IN A STRAIGHT ALIGNMENT AT RIGHT ANGLES FROM THE MAIN LINE SEWER EXCEPT AS SHOWN ON THE PLANS. HOUSE LATERALS FROM CHIMNEYS SHALL NOT HAVE AN ANGLE OF LESS THAN 45° WITH THE MAIN LINE SEWER. ANY CHANGE IN ALIGNMENT SHALL BE REQUESTED IN WRITING BY THE PRIVATE ENGINEER.
 4. THE PRIVATE ENGINEER SHALL FURNISH THE HOUSE LATERAL DEPTH AT THE PROPERTY LINE BELOW THE TOP OF CURB ELEVATION FOR EACH HOUSE LATERAL ON THE GRADE SHEET.
 5. NO REVISIONS SHALL BE MADE IN THESE PLANS WITHOUT THE APPROVAL OF THE COUNTY ENGINEER.
 6. THE CONTRACTOR SHALL NOTIFY THE CONSTRUCTION DIVISION BY TELEPHONE, MADISON 9-270, EXT. 8139, AT LEAST TWENTY-FOUR HOURS BEFORE STARTING ANY WORK UNDER THIS CONTRACT.
 7. ALL STRUCTURES SHALL BE EITHER BRICK MANHOLES PER S-3 OR PRECAST CONCRETE MANHOLES PER S-5 OR S-6, EXCEPT AS NOTED.
 8. "T" OR "Y" BRANCHES MAY BE USED FOR CONNECTIONS TO MAINLINE SEWERS, EXCEPT AS NOTED.
 9. MANHOLE TOPS IN UNIMPROVED RIGHTS-OF-WAY TO BE SIX INCHES ABOVE FINISHED GRADE.
 10. USE EXTRA STRENGTH PIPE. ALL PIPE IS STANDARD DEPTH EXCEPT AS NOTED.
 11. V.C.P. JOINTS SHALL BE TYPE "D", "M", OR "B" PER STD. SPEC. SEC. 208-2.
 12. IF A POWER POLE IS WITHIN THREE FEET OF THE SEWER, THE SEWER SHALL BE ENCASED, PER S-23, TWO FEET ON EACH SIDE FROM THE POINT OF INTERFERENCE.
 13. IF DURING THE COURSE OF CONSTRUCTION IT IS DETERMINED THAT THERE IS LESS THAN FOUR FEET OF COVER OVER THE TOP OF A MAIN LINE OR HOUSE LATERAL V.C.P. SEWER WHICH IS NOT INDICATED ON THE PLANS, THE PIPE SHALL BE ENCASED PER S-23, UNLESS OTHERWISE APPROVED BY THE COUNTY ENGINEER.
 14. HOUSE LATERALS TO BE CONSTRUCTED WITH 1/2" RISE PER FOOT TO THE PROPERTY LINE.
 15. RESEAL ALL TRENCHES WITHIN PAVED AREAS TO MEET L.A. COUNTY ROAD DEPT. OR CALIFORNIA STATE HIGHWAY REQUIREMENTS IN ACCORDANCE WITH PERMITS.
 16. SEWERS TO BE TESTED FOR LEAKAGE PER SECTION 306-2.8.7 OF THE STANDARD SPEC.
 17. REFER TO SECTION 7-10.8.1 OF THE STANDARD SPECIFICATIONS, REGARDING SAFETY ARMS.
 18. ALL JOINTS BETWEEN DUCTILE IRON PIPE AND REINFORCED CLAY PIPE SHALL BE MADE WITH A RUBBER LEAK-PROOF JOINT TYPE "C" OR "D" (WITH BUSHING IF NECESSARY) PER STANDARD SPECIFICATIONS, SECTION 208-2.
 19. THE CONTRACTOR SHALL NOTIFY THE METROPOLITAN WATER DISTRICT'S WATER DISTRIBUTION ENGINEER (Rm. 115, 415 SOUTH MAIN ST., LOS ANGELES, CALIF. 90012) AT LEAST 48 HOURS PRIOR TO STARTING ANY WORK IN THE VICINITY OF METROPOLITAN WATER DIST. FACILITIES.
 20. THE CONTRACTOR SHALL NOTIFY SOUTHERN PACIFIC PIPE LINES, INC.'S DISTRICT SUPERINTENDENT (Rm. 115, 415 SOUTH MAIN ST., LOS ANGELES, CALIF. 90012) AT LEAST 48 HOURS PRIOR TO STARTING ANY WORK IN THE VICINITY OF SOUTHERN PACIFIC PIPE LINE FACILITIES.

COLLECT CHARGES AS INDICATED

NOTICE TO CONTRACTOR

The existence and location of any underground utility pipes or structures shown on these plans are obtained by a search of the available records. To the best of my knowledge there are no existing utilities except as shown on these plans. The contractor is required to take due precautionary measures to protect the utility lines shown and any other lines not of record or not shown on these plans.

[Signature] 8-8-63

PROFILE, ALIGNMENT AND GRADE OF P.C. 8134
 SANITARY SEWERS PAGE 1

TO BE CONSTRUCTED IN
 PARCEL MAP NO. 669
 AND
 RIGHTS OF WAY
 PRIVATE CONTRACT NO. 8134

W.S. 26
 3 SHEETS, 6 PAGES
 SCALE: HORIZ. 1"=40' VERT. 1"=4'
 AUGUST, 1963
 PREPARED IN THE OFFICES OF
H. M. SCOTT & ASSOCIATES, INC.
 By: [Signature] 9-13-63
 Robert K. Komacko REG. C. E. NO. 16222

FOR LEGEND SEE PLAN NO. S-1

NOTE:
 GRADES TO WHICH THIS IMPROVEMENT IS TO BE CONSTRUCTED ARE SHOWN ON PLANS AND PROFILE. GRADE POINTS FOR TOP OF CURBS, CENTER LINE OF STREETS, OR CENTER LINE OF ALLEYS ARE SHOWN BY CIRCLES ON PROFILES. AT ALL POINTS BETWEEN DESIGNATED POINTS THE GRADE SHALL BE ESTABLISHED SO AS TO CONFORM TO A STRAIGHT LINE BEHIND ANY PAVED DESIGNATED POINTS. ELEVATIONS ARE IN FEET ABOVE U.S.C. & G.S. SEA LEVEL DATUM OF 1929.

THIS DRAWING AND THE DATA HEREON ARE HEREBY MADE A PART OF THE SPECIFICATIONS. PARTS CONSTRUCTION AND COUNTY ENGINEER SPECIAL PROVISIONS DATED JUNE 8, 1963 AS REFERRED AND SHALL BE INDUCED BY ONLY IN THE PRESENCE OF THE COUNTY ENGINEER.

WORK SHALL BE CONSTRUCTED ACCORDING TO STANDARD SPECIFICATIONS FOR PUBLIC WORKS OF THE COUNTY OF LOS ANGELES, CALIFORNIA. THESE WORKS CAN BE STARTED, THE CONTRACTOR MUST OBTAIN A PERMIT TO EXCAVATE IN COUNTY STREETS FROM THE L.A. COUNTY ROAD DEPT., DISTRICT OFFICE NO. [] AND PAY A FEE TO THE COUNTY ENGINEER, ROOM 300, COUNTY ENGINEER'S BUILDING, 200 WEST SECOND STREET OR PALMS BRIDGE, CENTINELA VALLEY, REGIONAL OFFICE, SUFFICIENT TO COVER THE COST OF CONSTRUCTION INSPECTION AND RECORD PREPARATION AND TO THE ACCURACY OF THE LOCATION OF OR THE EXISTENCE OR NON-EXISTENCE OF ANY UNDERGROUND UTILITY PIPE, OR STRUCTURE WITHIN THE LIMITS OF THIS PROJECT. THIS NOTE APPLIES TO ALL PAGES.

IF WORK IS TO BE DONE IN A STATE HIGHWAY, A PERMIT MUST BE OBTAINED FROM THE STATE OF CALIFORNIA, DIVISION OF HIGHWAYS, 120 SOUTH SPRING STREET, LOS ANGELES, CALIFORNIA.

COUNTY OF LOS ANGELES, CALIFORNIA
 JOHN A. LAMBE, COUNTY ENGINEER J. D. PARKHURST, CHIEF ENGINEER
 CO. SAN. DIST. NO. 7 APPROVED BY: [Signature] OFFICE ENGINEER

CHECKED BY: [Signature] 1-30-69
 REG. C. E. NO. 10653

41417
 J.N. 0250.02

