

B.M. B.Y. 371 ELEV. 37.301  
 L. & T. N.W. COR. S.P.R.E. SIGNAL SWITCH BOX NO. 4572  
 75' S. OF E. DEL AMO BLVD. AND 55' E. OF  
 MAIN LINE OF S.P.R.E.  
GARDENA QUAD. 1965

No connections for the disposal of industrial wastes shall be made to sewers shown on these drawings without written permission from the Chief Engineer and General Manager of the County Sanitation Districts.

County Sanitation Districts shall be notified prior to the following so that required inspection can be made (Phone: 444-3885 - 636-3097)

Acceptance of the project.

**NOTICE TO CONTRACTORS**

THE EXISTENCE AND LOCATION OF ANY UNDERGROUND UTILITY PIPES OR STRUCTURES SHOWN ON THESE PLANS ARE OBTAINED BY A SEARCH OF THE AVAILABLE RECORDS TO THE BEST OF MY KNOWLEDGE. THERE ARE NO EXISTING UTILITIES EXCEPT AS SHOWN ON THESE PLANS.

THE CONTRACTOR IS REQUIRED TO TAKE DUE PRECAUTIONARY MEASURES TO PROTECT THE UTILITY LINES SHOWN AND ANY OTHER LINES NOT OF RECORD OR NOT SHOWN ON THESE PLANS.

Gary L. McCabe DATE 10-10-68  
 GARY L. MCCABE R.C.E. 14385

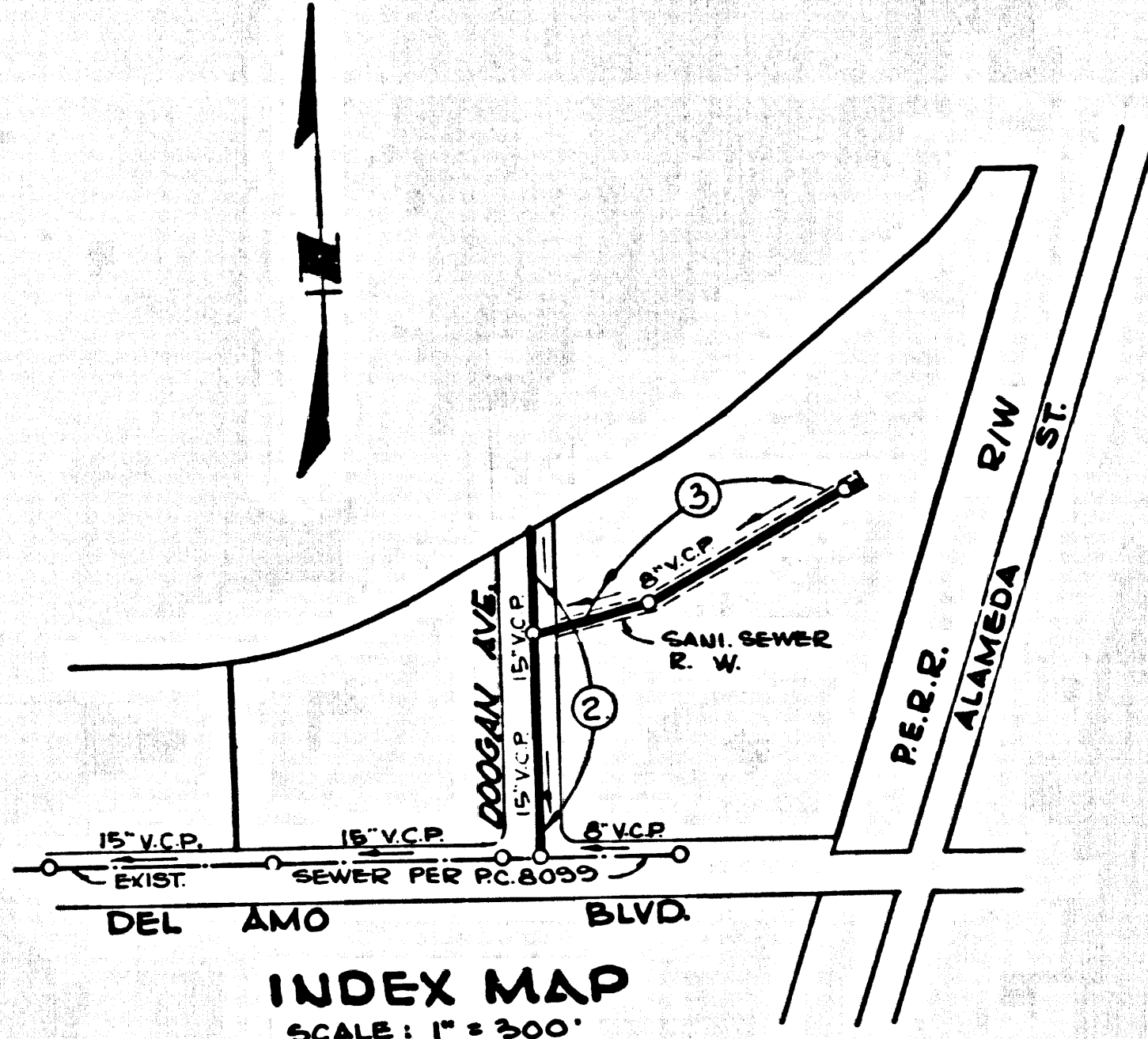

**INDEX MAP**  
 SCALE: 1" = 500'  
**PC. 8188**  
 NOTE: FIGURES IN CIRCLES INDICATE PAGE NUMBERS

NOTE:  
 PARCELS 1, 2, 3, 5 & 6 SERVED FROM  
 SEWER IN DEL AMO BLVD., R.C. 8099

**LENNOX BLDG. DIST. NO. 7**

- NOTES:
1. PROVIDE STAKES ON THE PROPERTY LINE OR PROPERTY LINES PRODUCED AT RIGHT ANGLES TO THE SEWER LINE AT THE CENTER LINE OF EACH MANHOLE.
  2. NO REPRESENTATIVE OF THE COUNTY ENGINEER WILL SURVEY OR LAY OUT ANY PORTION OF THE WORK.
  3. THE PRIVATE ENGINEER SHALL FURNISH THE COUNTY ENGINEER WITH GRADE SHEETS AND STATIONING FOR ALL HOUSE LATERALS AND 7" BRANCHES AND SHALL PROVIDE STAKES FOR THEM AT THEIR PROPER LOCATIONS WITH STATIONING PLAINLY MARKED. ALL HOUSE LATERALS SHALL BE CONSTRUCTED IN A STRAIGHT ALIGNMENT AT RIGHT ANGLES FROM THE MAIN LINE SEWER EXCEPT AS SHOWN ON THE PLANS. HOUSE LATERALS FROM CHIMNEYS SHALL NOT HAVE AN ANGLE OF LESS THAN 45° WITH THE MAIN LINE SEWER. ANY CHANGE IN ALIGNMENT SHALL BE REQUESTED IN WRITING BY THE PRIVATE ENGINEER.
  4. THE PRIVATE ENGINEER SHALL FURNISH THE HOUSE LATERAL DEPTH AT THE PROPERTY LINE BELOW THE TOP OF CURB ELEVATION FOR EACH HOUSE LATERAL ON THE GRADE SHEET.
  5. NO REVISIONS SHALL BE MADE IN THESE PLANS WITHOUT THE APPROVAL OF THE COUNTY ENGINEER.
  6. THE CONTRACTOR SHALL NOTIFY THE CONSTRUCTION DIVISION BY TELEPHONE, MADISON 9-4747, EXT. 81551, AT LEAST TWENTY-FOUR HOURS BEFORE STARTING ANY WORK UNDER THIS CONTRACT.
  7. ALL STRUCTURES SHALL BE EITHER BRICK MANHOLES PER S-3 OR PRECAST CONCRETE MANHOLES PER S-4 OR S-4, EXCEPT AS NOTED.
  8. USE STANDARD MANHOLE FRAMES AND COVERS, S-15, EXCEPT AS NOTED.
  9. MANHOLE TOPS IN UNIMPROVED RIGHTS-OF-WAY TO BE SIX INCHES ABOVE FINISHED GRADE.
  10. USE EXTRA STRENGTH PIPE. ALL PIPE IS STANDARD DEPTH EXCEPT AS NOTED.
  11. VITRIFIED CLAY PIPE JOINTS SHALL BE TYPE "D", "F", OR "G" PER STD. SPECS. SEC. 105-2.
  12. IF A POWER POLE IS WITHIN THREE FEET OF THE SEWER, THE SEWER SHALL BE ENCASED, PER S-23, TWO FEET ON EACH SIDE FROM THE POINT OF INTERFERENCE.
  13. IF DURING THE COURSE OF CONSTRUCTION IT IS DETERMINED THAT THERE IS LESS THAN FOUR FEET OF COVER OVER THE TOP OF A MAIN LINE OR HOUSE LATERAL V.C.P. SEWER WHICH IS NOT INDICATED ON THE PLANS, THE PIPE SHALL BE ENCASED PER S-23, UNLESS OTHERWISE APPROVED BY THE COUNTY ENGINEER.
  14. HOUSE LATERALS TO BE CONSTRUCTED WITH INVERTS AT PROPERTY LINE & FEET BELOW CURB GRADE EXCEPT AS NOTED.
  15. REVERSE ALL TRENCHES WITHIN WAVED AREAS TO MEET L.A. COUNTY ROAD DEPT. OR CALIFORNIA STATE HIGHWAY REQUIREMENTS IN ACCORDANCE WITH PERMITS.
  16. SEWERS TO BE TESTED FOR LEAKAGE PER SECTION 306-23.7 UNIFORM STANDARD SPECIFICATIONS.
  17. REFER TO SECTION 7-10.4.1 OF THE STANDARD SPECS., REGARDING SAFETY ORDERS.
  18. SPECIAL BACKFILL IN DESIGNATED AREAS:  
 (a) BACKFILL TRENCH AND REPLACE OTHER EARTH REMOVED SO AS TO ACHIEVE THE NATURAL OR FINISHED GRADES AND SLOPES SHOWN ON THE GRADING PLAN APPROVED FOR THIS TRACT BY THE BUILDING AND SAFETY DIVISION.  
 (b) ALL BACKFILL AND EARTH REPLACES SHALL BE COMPACTED TO A MINIMUM OF 90% OF MAXIMUM DENSITY PER A.S.T.M. STANDARD METHOD OF TEST D96 ST. AS MODIFIED. ACCEPTABLE CERTIFICATION OF SUCH COMPACTION SHALL BE SUBMITTED TO THE CONSTRUCTION DIVISION.  
 (c) ROAD GRADATIONS TO BE COMPLETED BEFORE SEWER CONSTRUCTION IS STARTED.
  19. THE FOLLOWING LATEST REVISED STANDARD PLANS SHOWN IN THE OFFICE OF THE COUNTY ENGINEER SHALL APPLY IN THE CONSTRUCTION OF THIS PROJECT:  
 (a) LEGEND  
 (b) MIN. EXCAV. SAFETY REQUIREMENTS  
 (c) BRICK MANHOLES  
 (d) NON-DRIVE PRECAST CONC. MANHOLES  
 (e) M.H. FRAME & COVER  
 (f) M.H. SET  
 (g) BEDDING FOR SEWER PIPE  
 (h) GRADING AND ENCASING  
 (i) WYE OF THE SUPPORT  
 (j) ALLOWABLE TRENCH WIDTH

**COLLECT CHARGES AS INDICATED**

PROFILE ALIGNMENT AND GRADE OF **P.C. 8188**  
**SANITARY SEWERS** PAGE 1

TO BE CONSTRUCTED IN  
**DEL AMO PLACE**  
**PARCEL MAP NO. 725**

PRIVATE CONTRACT NO. 8188

W.S. 26  
 2 SHEETS; 3 PAGES  
 SCALE: VERT. 1" = 4' HORIZ. 1" = 40'  
 OCTOBER, 1968  
 PREPARED IN THE OFFICES OF  
**VOORHEIS-TRINDLE-NELSON**  
 15794 BEACH BOULEVARD  
 WESTMINSTER, CALIFORNIA, 92683  
 REG. C. E. NO. 10,012  
 FOR LEGEND SEE PLAN NO. S-1

NOTE:  
 GRADES TO WHICH THIS IMPROVEMENT IS TO BE CONSTRUCTED ARE SHOWN ON PLANS AND PROFILES. GRADE POINTS FOR TOP OF CURBS, CENTER LINE OF STREETS OR ALLEYS ARE SHOWN BY CIRCLES ON PROFILES. AT ALL POINTS BETWEEN DESIGNATED POINTS THE GRADE SHALL BE ESTABLISHED SO AS TO CONFORM TO A STRAIGHT LINE DRAWN BETWEEN SAID DESIGNATED POINTS. ELEVATIONS ARE IN FEET ABOVE U.S.C. & G.S. SEA LEVEL DATUM OF 1929. THESE DRAWINGS AND THE DATA HEREON ARE HEREBY MADE A PART OF THE SPECIFICATIONS, AS REVISED, AND WORK SHALL BE CONSTRUCTED ACCORDING TO THE UNIFORM STANDARD SPECIFICATIONS FOR PUBLIC WORKS CONSTRUCTION AND COUNTY ENGINEER SPECIAL PROVISIONS DATED 10/01/68, AS REVISED, AND SHALL BE PROSECUTED ONLY IN THE PRESENCE OF THE COUNTY ENGINEER. THE CONTRACTOR MUST OBTAIN A PERMIT TO EXCAVATE IN COUNTY STREETS FROM THE L.A. COUNTY ENGINEER. WORK CAN BE STARTED ON PUBLIC STREETS, ALLEYS OR HIGHWAYS ONLY AFTER THE COUNTY ENGINEER HAS BEEN NOTIFIED AND PAID A FEE TO THE COUNTY ENGINEER, ROOM 300, COUNTY ENGINEERING BUILDING, ROAD DEPT., DISTRICT OFFICE NO. 12435, 12435 WILSHIRE AVENUE, DISTRICT OFFICE, SUFFICIENT TO COVER THE COST OF THE PROJECT. THIS NOTE APPLIES TO ALL PAGES.  
 IF WORK IS TO BE DONE IN A STATE HIGHWAY, A PERMIT MUST BE OBTAINED FROM THE STATE OF CALIFORNIA, DIVISION OF HIGHWAYS, 128 SOUTH SPRING STREET, LOS ANGELES, CALIFORNIA.

COUNTY OF LOS ANGELES, CALIFORNIA  
 JOHN A. LAMBIE, COUNTY ENGINEER J. D. PARKHURST, CHIEF ENGINEER  
 APPROVED BY Robert M. Miller APPROVED BY J. D. Parkhurst  
 REGIONAL ENGINEER OFFICE ENGINEER

CHECKED BY Edward U. Kelly 10/10/68  
 NO. C.E. NO. 10555-3  
 J.N. 0250.02

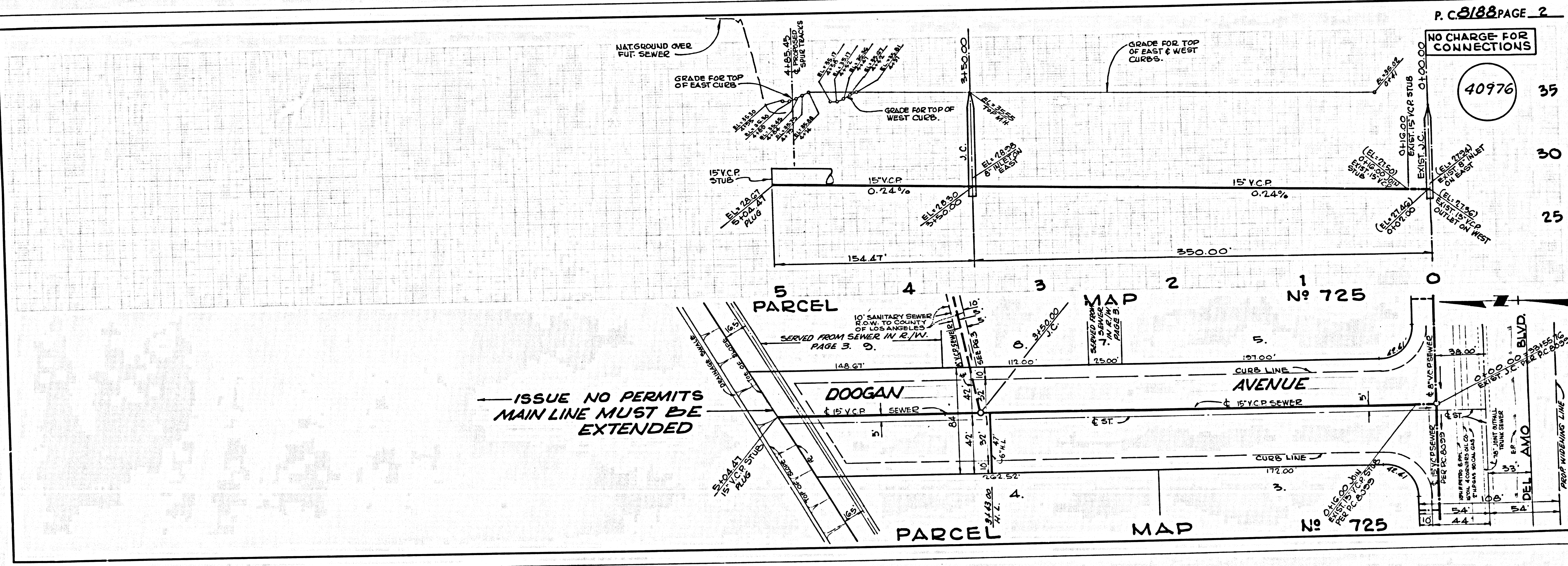

ISSUE NO PERMITS  
 MAIN LINE MUST BE  
 EXTENDED

NO CHARGE FOR CONNECTIONS

