

B.M. BY 7554 ELEV. 928.231
R.D. 8M. 746 2 FT. S. CATCH BASIN ON S.E. COR. AQUADA RD. OVER CROSSING & WEST BOUND ON ONT. RAMP VENTURA FRWY 40 FT. S. & 22 FT. E. INT. MALIBU QUAD. 19 65.

NOTE: ALL LOTS IN TRACT NO 27815 EXCEPT LOTS 2, 15, 19, 30 AND 32 ARE SERVED BY EXISTING HOUSE LATERALS CONSTRUCTED UNDER R.C. 7534, TRAC. NO 24374.

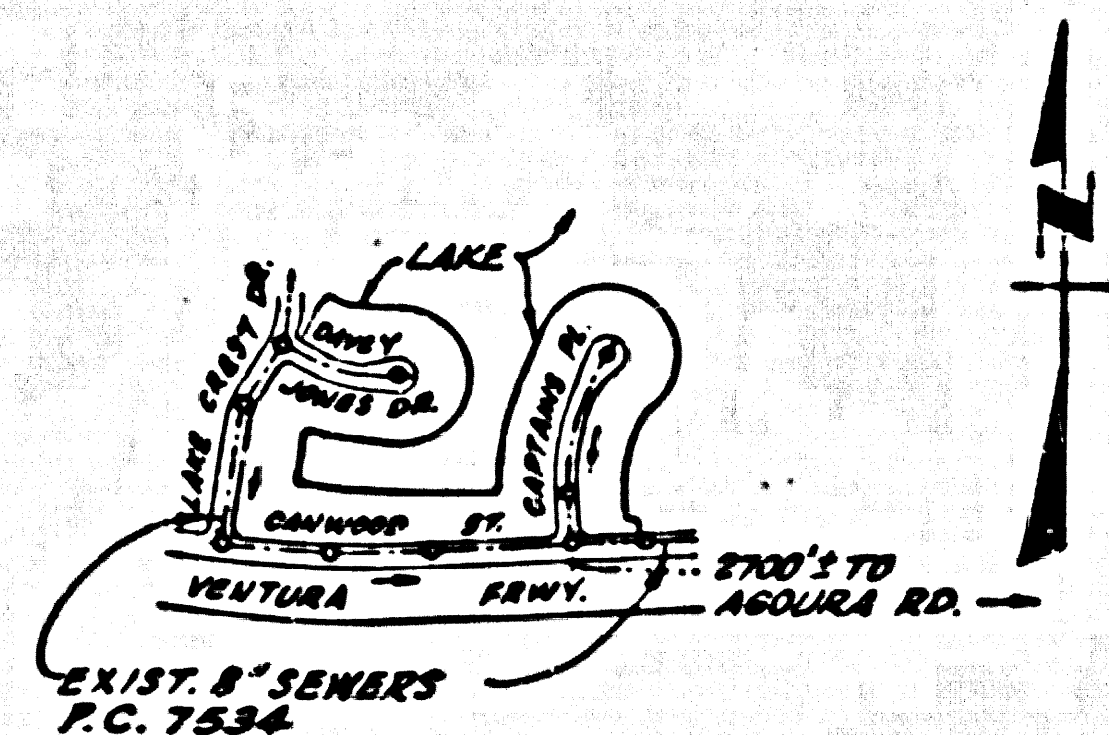

INDEX MAP
P.C. 8208
SCALE: 1"=400'

DOUBLE SCALE
CALABASAS BLDG. DIST. NO. 91

PROFILE, ALIGNMENT AND GRADE OF
SANITARY SEWERS P.C. 8208
PAGE 1
TO BE CONSTRUCTED IN

TRACT NO 27815
(A RESUBDIVISION OF A PORTION OF TRACT NO 24374)
HOUSE LATERALS TO SERVE LOTS 2, 15, 19, 30 & 32
PRIVATE CONTRACT NO. 8208

W.S. 93 ABANDONED
1 SHEET; 2 PAGES

SCALE: VERT. 1"=4' HORIZ. 1"=40' NOVEMBER, 1968

PREPARED IN THE OFFICES OF
MEINTHE & GUARDI INC.
670 MONTEREY PASS ROAD
MONTEREY PARK, CALIF.
By: [Signature] REG. C. E. NO. 16107

- NOTES:
1. HOUSE LATERALS TO BE CONSTRUCTED WITH INVERTS AT PROPERTY LINE & FEET BELOW CURB GRADE EXCEPT AS NOTED.
2. PROVIDE STAKES ON THE PROPERTY LINE OR PROPERTY LINES PRODUCED AT RIGHT ANGLES TO THE SEWER LINE AT THE CENTER LINE OF EACH MANHOLE.
3. NO REPRESENTATIVE OF THE COUNTY ENGINEER WILL SURVEY OR LAY OUT ANY PORTION OF THE WORK.
4. THE PRIVATE ENGINEER SHALL FURNISH THE COUNTY ENGINEER WITH GRADE SHEETS AND STATIONING FOR ALL HOUSE LATERALS AND "T" OR "T" BRANCHES AND SHALL PROVIDE STAKES FOR THEM AT THEIR PROPER LOCATIONS WITH STATIONING PLAINLY MARKED. ALL HOUSE LATERALS SHALL BE CONSTRUCTED AT A STRAIGHT ALIGNMENT AT RIGHT ANGLES FROM THE MAIN LINE SEWER EXCEPT AS SHOWN ON THE PLANS. HOUSE LATERALS FROM CHIMNEYS SHALL NOT HAVE AN ANGLE OF LESS THAN 45° WITH THE MAIN LINE SEWER. ANY CHANGE IN ALIGNMENT SHALL BE REQUESTED IN WRITING BY THE PRIVATE ENGINEER.
5. THE PRIVATE ENGINEER SHALL FURNISH THE HOUSE LATERAL DEPTH AT THE PROPERTY LINE BELOW THE TOP OF CURB ELEVATION FOR EACH HOUSE LATERAL ON THE GRADE SHEET.
6. NO REVISIONS SHALL BE MADE IN THESE PLANS WITHOUT THE APPROVAL OF THE COUNTY ENGINEER.
7. THE CONTRACTOR SHALL NOTIFY THE CONSTRUCTION DIVISION BY TELEPHONE, HOURS 9:00 A.M. TO 5:00 P.M., AT LEAST TWENTY-FOUR HOURS BEFORE STARTING ANY WORK UNDER THIS CONTRACT.
8. ALL STRUCTURES SHALL BE EITHER BRICK MANHOLES PER S-5 OR PRECAST CONCRETE MANHOLES PER S-5 OR S-6, EXCEPT AS NOTED.
9. "T" OR "T" BRANCHES MAY BE USED FOR CONNECTIONS TO MAINLINE SEWERS EXCEPT AS NOTED.
10. MANHOLE TOPS IN UNIMPROVED RIGHTS OF WAY TO BE 3 1/2 INCHES ABOVE FINISHED GRADE.
11. USE EXTRA STRENGTH PIPE. ALL PIPE IS STANDARD DEPTH EXCEPT AS NOTED.
12. WITHEPPED CLAY PIPE JOINTS SHALL BE TYPE "B", "T", OR "B" PER STANDARD SPECIFICATIONS SECTION 206-2.
13. IF A POWER POLE IS WITHIN THREE FEET OF THE SEWER, THE SEWER SHALL BE ENCASED, PER S-25, TWO FEET ON EACH SIDE FROM THE POINT OF INTERFERENCE.
14. IF DURING THE COURSE OF CONSTRUCTION IT IS DETERMINED THAT THERE IS LESS THAN FOUR FEET OF COVER OVER THE TOP OF A MAIN LINE OR HOUSE LATERAL V.C.P. SEWER WHICH IS NOT INDICATED ON THE PLANS, THE PIPE SHALL BE ENCASED PER S-25, UNLESS OTHERWISE APPROVED BY THE COUNTY ENGINEER.
15. RESURFACE ALL TRENCHES WITHIN PAVED AREAS TO MEET L.A. COUNTY ROAD DEPT. OR CALIFORNIA STATE HIGHWAY REQUIREMENTS BY ACCORDANCE WITH PERMITS.
16. SEWERS TO BE TESTED FOR LEAKAGE PER SECTION 206-2.3.7 OF THE STANDARD SPECIFICATIONS.
17. REFER TO SECTION 7-16.1.1 OF THE STANDARD SPECIFICATIONS, REGARDING SAFETY ORDERS.
18. ALL JOINTS BETWEEN CAST IRON PIPE AND WITHEPPED CLAY PIPE SHALL BE MADE WITH A RUBBER JOINT, TYPE "C" OR "B", WITH BUSHING IF NECESSARY PER STANDARD SPECIFICATIONS, SECTION 206-2.

THE FOLLOWING LATEST REVISIONS OF STANDARD PLANS ON FILE IN THE OFFICE OF THE COUNTY ENGINEER SHALL APPLY IN THE CONSTRUCTION OF THIS PROJECT.

LEGEND

MINIMUM PUBLIC SAFETY REQUIREMENTS	S-1
MINIMUM PUBLIC SAFETY REQUIREMENTS	S-2
MINIMUM PUBLIC SAFETY REQUIREMENTS	S-3
MINIMUM PUBLIC SAFETY REQUIREMENTS	S-4
MINIMUM PUBLIC SAFETY REQUIREMENTS	S-5
MINIMUM PUBLIC SAFETY REQUIREMENTS	S-6
MINIMUM PUBLIC SAFETY REQUIREMENTS	S-7
MINIMUM PUBLIC SAFETY REQUIREMENTS	S-8
MINIMUM PUBLIC SAFETY REQUIREMENTS	S-9
MINIMUM PUBLIC SAFETY REQUIREMENTS	S-10
MINIMUM PUBLIC SAFETY REQUIREMENTS	S-11
MINIMUM PUBLIC SAFETY REQUIREMENTS	S-12
MINIMUM PUBLIC SAFETY REQUIREMENTS	S-13
MINIMUM PUBLIC SAFETY REQUIREMENTS	S-14
MINIMUM PUBLIC SAFETY REQUIREMENTS	S-15
MINIMUM PUBLIC SAFETY REQUIREMENTS	S-16
MINIMUM PUBLIC SAFETY REQUIREMENTS	S-17
MINIMUM PUBLIC SAFETY REQUIREMENTS	S-18
MINIMUM PUBLIC SAFETY REQUIREMENTS	S-19
MINIMUM PUBLIC SAFETY REQUIREMENTS	S-20
MINIMUM PUBLIC SAFETY REQUIREMENTS	S-21
MINIMUM PUBLIC SAFETY REQUIREMENTS	S-22
MINIMUM PUBLIC SAFETY REQUIREMENTS	S-23
MINIMUM PUBLIC SAFETY REQUIREMENTS	S-24
MINIMUM PUBLIC SAFETY REQUIREMENTS	S-25
MINIMUM PUBLIC SAFETY REQUIREMENTS	S-26
MINIMUM PUBLIC SAFETY REQUIREMENTS	S-27
MINIMUM PUBLIC SAFETY REQUIREMENTS	S-28
MINIMUM PUBLIC SAFETY REQUIREMENTS	S-29
MINIMUM PUBLIC SAFETY REQUIREMENTS	S-30

UTILITY COMPANIES
SOU. CALIF. EDISON CO.
SOU. CALIF. GAS CO. } IN JOINT TRENCH
PACIFIC TELEPHONE CO.
LAS VIRGENES MUN. WATER DIST.

COLLECT CHARGES AS INDICATED

