

PROFILE SCALE

HORIZ. 1" = 40'
VERT. 1" = 4'

B.M. #11 El. 268.064 R.D.L.B. 182-257
L.A.C.S. Mon. in H.H. 260' S. E. of E. San Gabriel Blvd.
First P.I. East. (Use East Edge)

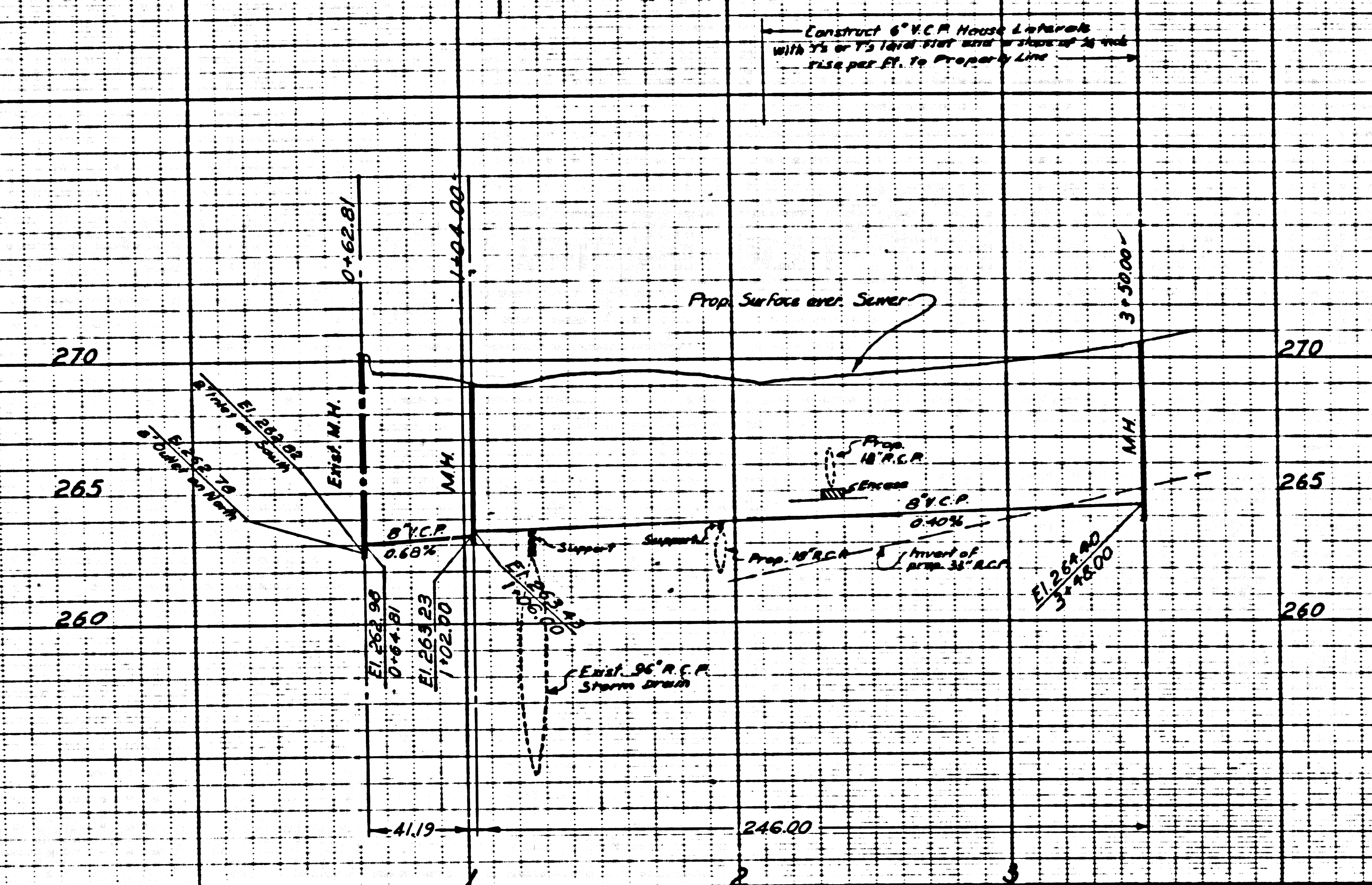

REVIEWED
DESIGN SECTION ABC DATE
C.C. 8210 J.N. 0778.68

GENERAL SEWER NOTES

- Sanitary sewers shall be constructed in accordance with the Standard Specifications for Public Works Construction (hereinafter referred to as the Standard Specifications), Special Provisions and Standard Plans on file in the office of the County Engineer.
- Existing sewer services and flow shall be maintained at all times.
- All concrete cross gutters, curbs, gutters and driveways shall be tunneled or jacked per Los Angeles County Road Department requirements.
- Refer to Section 7-10.4.1 of the Standard Specifications for safety orders.
- The contractor shall notify the Construction Division of the County Engineer by telephone 629-4747, Ext. 81551, at least 24 hours before starting any work under this contract.
- Construction under this project shall conform to the following Standard Plans: S-1, S-2, S-3, S-13, S-15, S-17, S-21, S-22, S-23, S-30, S-33 and S-34.
- 1" or 1/2" branches may be used for connection to main line sewer.
- Vitrified clay pipe joints shall be type "D", "A" or "G" per Section 208-2 of Standard Specifications.
- No revisions shall be made to these plans without the approval of the County Engineer.
- Sewer pipe and appurtenances shall be abandoned in accordance with Section 308-3 of Standard Specifications.

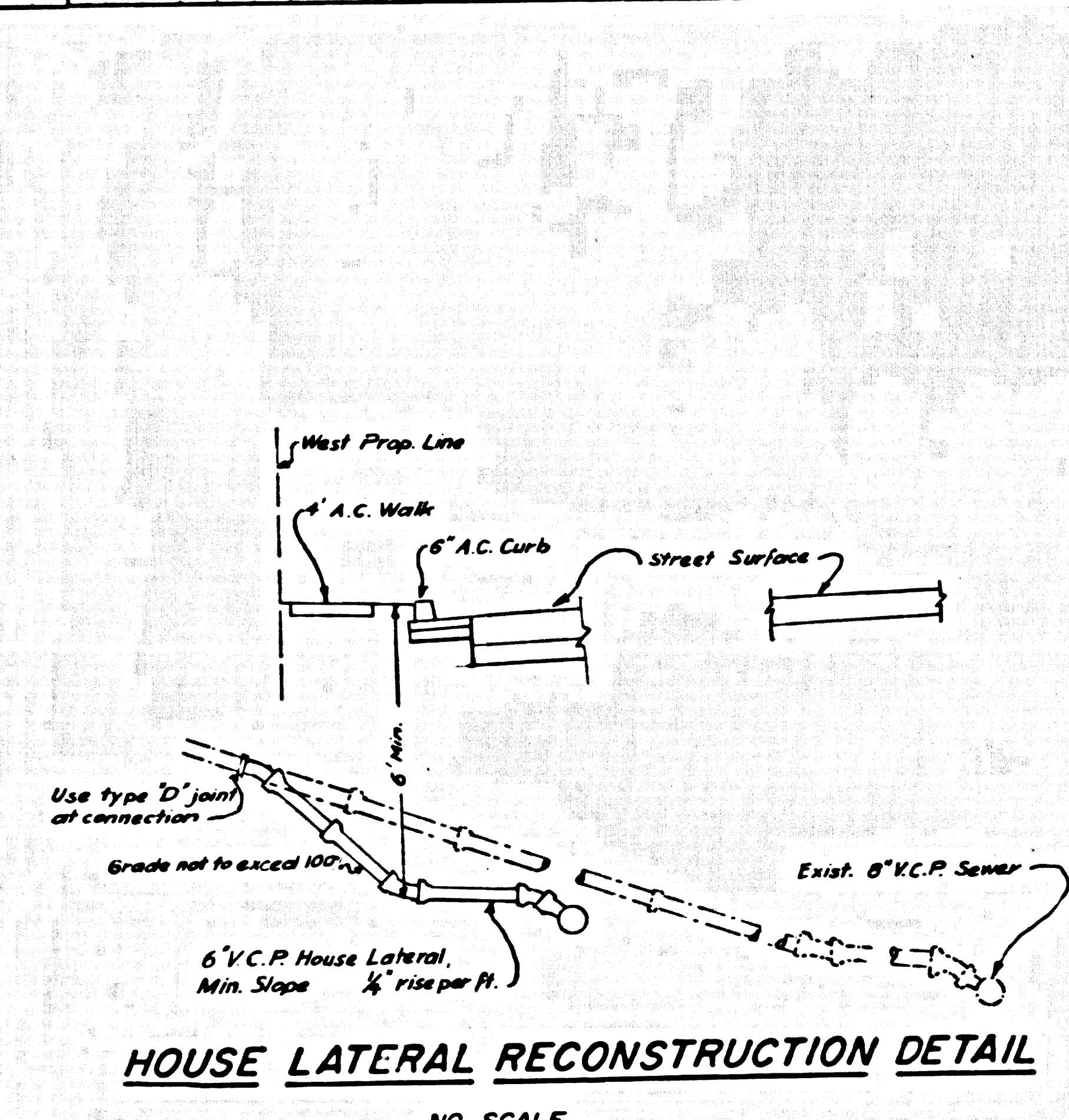

HOUSE LATERAL RECONSTRUCTION DETAIL
NO SCALE

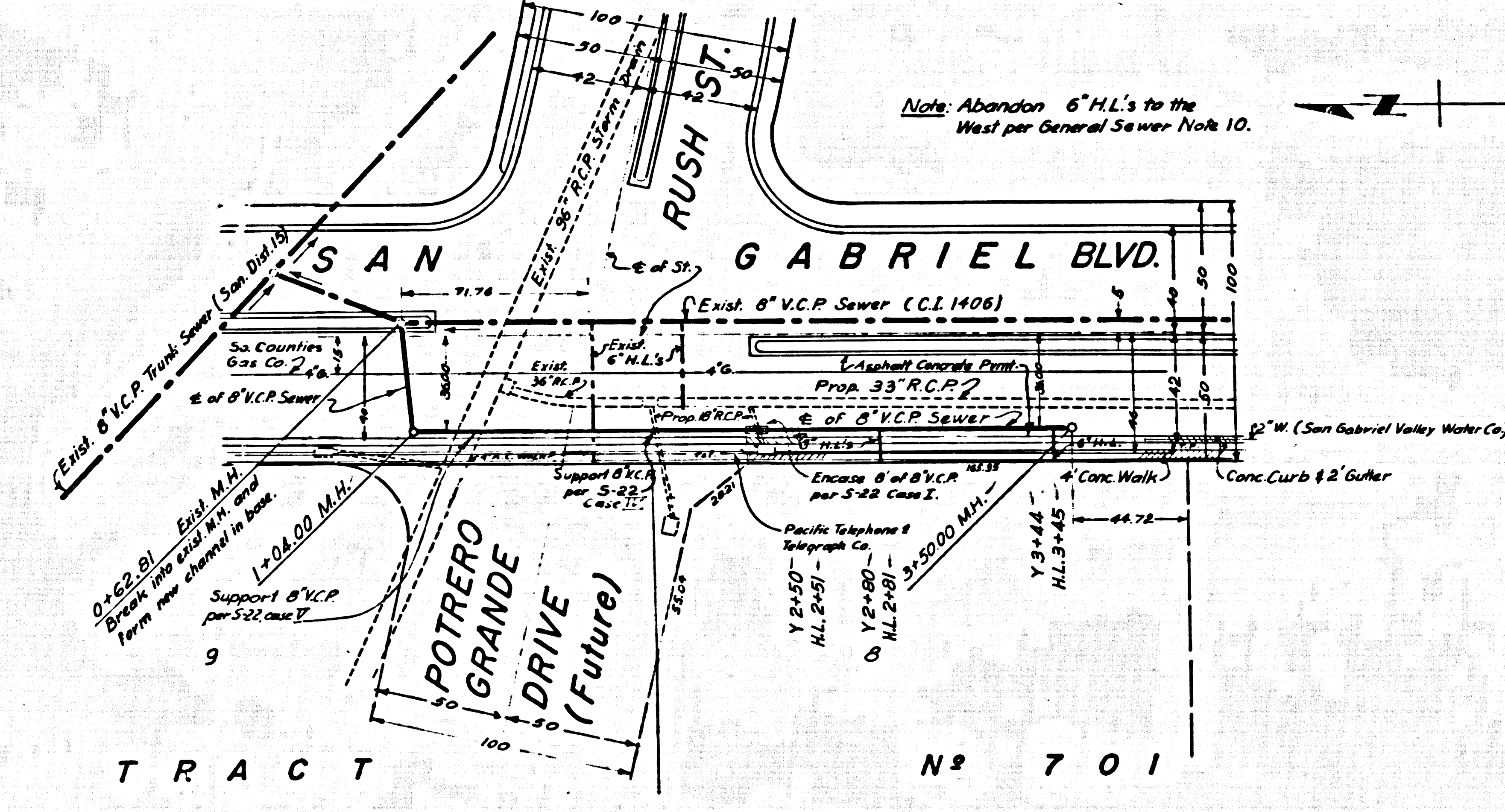

TRACT # 701
M. B. 16-110-111

CASH CONTRACT
Nº2734
PROFILE, GRADE AND ALIGNMENT OF
SANITARY SEWER 42302
TO BE CONSTRUCTED IN
SAN GABRIEL BLVD.
COUNTY OF LOS ANGELES

JOHN A. LAMBIE COUNTY ENGINEER
DESIGNED BY *Roughland 1-10-69* APPROVED *Roughland 1-10-69*
R.E.E. BY *Roughland* (DATE) ASSISTANT ENGINEER (LATE)
SANITATION DIVISION
JOHN D. PARKHURST
CHIEF ENGINEER COUNTY SANITATION DIST. NO. 15
APPROVED BY *Roughland*
OFFICE ENGINEER

County Sanitation Districts shall be notified prior to the following so that required inspection can be made (Phone 337-1025 - 446-6099)
Acceptance of the project.
No connections for the disposal of industrial wastes shall be made to sewers shown on these drawings without written permission from the Chief Engineer and General Manager of the County Sanitation Districts.

REFERENCE	LAYOUT	RECORD PLANS
M.S. 36	TRACED	
R.D.L.B. 182	CHECKED	
	INSPECTOR	

LOS ANGELES COUNTY ROAD DEPARTMENT			
HIGHWAY DIVISION		JOB NAME LIMITS	
DATE	BY	REVISIONS	SHEET OF SHTS. DWG. NO.

SCALE HORIZ. 1" = 40'
VERT. 1" = 4'

JOB NO.

SHEET OF SHTS. DWG. NO.