

B.M. 21-4-A ELEV. 116.410, F.D. 1391-9A
 ROSECRANS AVE. E. AVIATOR BLVD. 186.5' W/O A. INT. B.
 41.5' W/O 4. OF AVIATOR BLVD. IN A WELL PROTECTED
 BY A CAST IRON COVER MARKED "C.E. MON. A.C. 1"
 MON. STAMPED "B.M. 21-4-A 1960 K.E. 5869"
 SET IN CONC. 10" BELOW TOP OF CURB.
 QUAD. 19 65

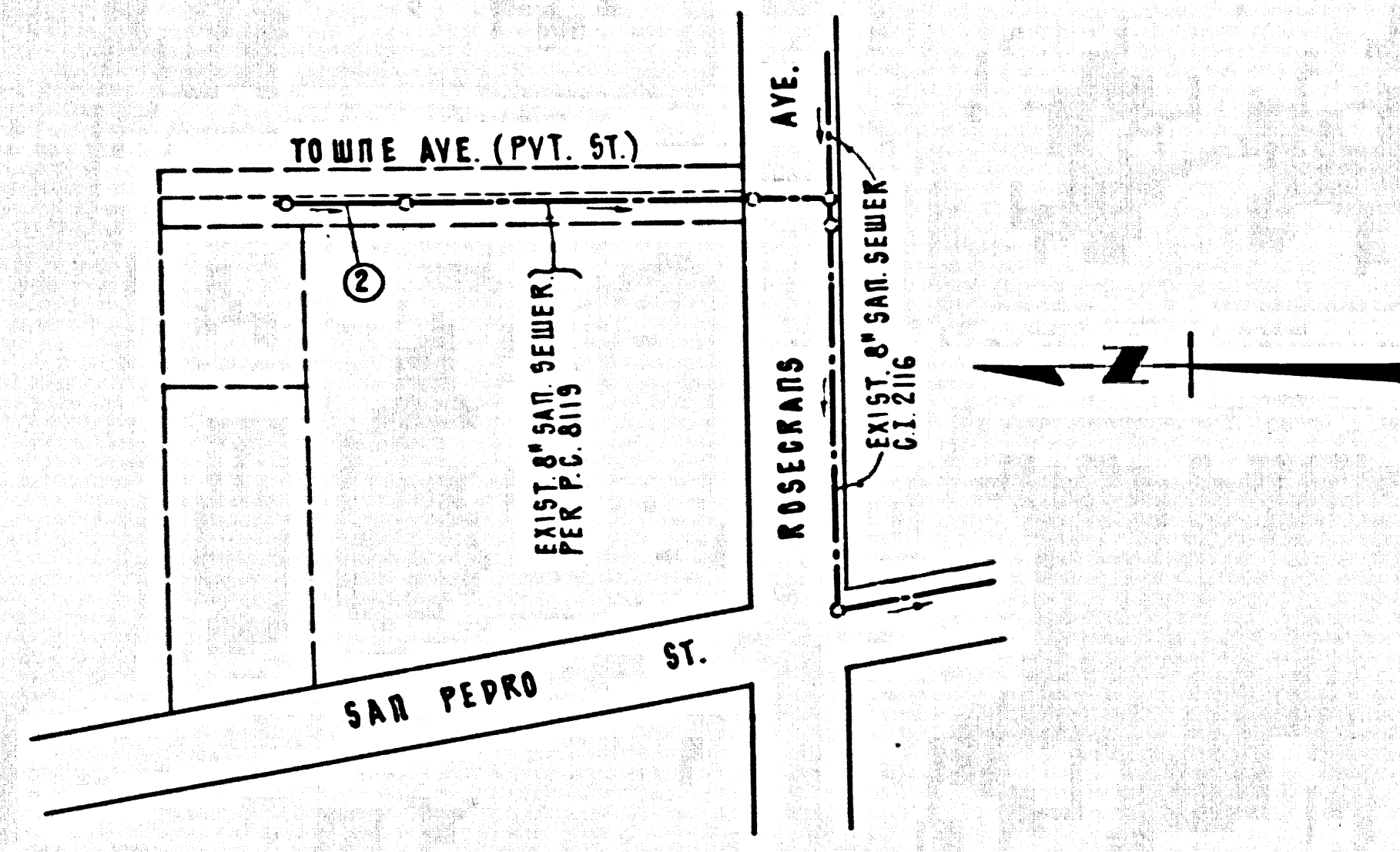

INDEX MAP
 SCALE: 1" = 200'
 P.C. 8213

County Sanitation Districts shall be notified prior to the following so that required inspection can be made (Phone 866-5697 - 636-5097)

Acceptance of the project.

No connections for the disposal of industrial wastes shall be made to sewers shown on these drawings without written permission from the Chief Engineer and General Manager of the County Sanitation Districts.

LENNOX BLDG. DIST. NO. 7

- NOTES:
1. PROVIDE STAKES ON THE PROPERTY LINE OR PROPERTY LINES PRODUCED AT RIGHT ANGLES TO THE SEWER LINE AT THE CENTER LINE OF EACH MANHOLE.
 2. NO REPRESENTATIVE OF THE COUNTY ENGINEER WILL SURVEY OR LAY OUT ANY PORTION OF THE WORK.
 3. THE PRIVATE ENGINEER SHALL FURNISH THE COUNTY ENGINEER WITH GRADE SHEETS AND STATIONING FOR ALL HOUSE LATERALS AND "T" BRANCHES AND SHALL PROVIDE STAKES FOR THEM AT THEIR PROPER LOCATIONS WITH STATIONING PLAINLY MARKED. ALL HOUSE LATERALS SHALL BE CONSTRUCTED IN A STRAIGHT ALIGNMENT AT RIGHT ANGLES FROM THE MAIN LINE SEWER EXCEPT AS SHOWN ON THE PLANS. HOUSE LATERALS FROM CHIMNEYS SHALL NOT HAVE AN ANGLE OF LESS THAN 45° WITH THE MAIN LINE SEWER. ANY CHANGE IN ALIGNMENT SHALL BE REQUESTED BY WRITING BY THE PRIVATE ENGINEER.
 4. THE PRIVATE ENGINEER SHALL FURNISH THE HOUSE LATERAL DEPTH AT THE PROPERTY LINE BELOW THE TOP OF CURB ELEVATION FOR EACH HOUSE LATERAL ON THE GRADE SHEET.
 5. NO REVISIONS SHALL BE MADE IN THESE PLANS WITHOUT THE APPROVAL OF THE COUNTY ENGINEER.
 6. THE CONTRACTOR SHALL NOTIFY THE CONSTRUCTION DIVISION BY TELEPHONE, BANGSON 9-0747, EXT. 81551, AT LEAST TWENTY-FOUR HOURS BEFORE STARTING ANY WORK UNDER THIS CONTRACT.
 7. ALL STRUCTURES SHALL BE EITHER BRICK MANHOLES PER 5-3 OR PRECAST CONCRETE MANHOLES PER 5-5 OR 5-6, EXCEPT AS NOTED.
 8. USE STANDARD MANHOLE FRAMES AND COVERS, S.T.E. EXCEPT AS NOTED.
 9. MANHOLE TOPS IN UNIMPROVED RIGHTS-OF-WAY TO BE SIX INCHES ABOVE FINISHED GRADE.
 10. USE EXTRA STRENGTH PIPE, ALL PIPE IS STANDARD DEPTH EXCEPT AS NOTED.
 11. VITRIFIED CLAY PIPE JOINTS SHALL BE TYPE "D," "E" OR "G" PER STD. SPEC. SEC. 208-2.
 12. IF A POWER POLE IS WITHIN THREE FEET OF THE SEWER, THE SEWER SHALL BE ENCASED, PER 5-25, TWO FEET ON EACH SIDE FROM THE POINT OF INTERFERENCE.
 13. IF DURING THE COURSE OF CONSTRUCTION IT IS DETERMINED THAT THERE IS LESS THAN FOUR FEET OF COVER OVER THE TOP OF A MAIN LINE OR HOUSE LATERAL V.C.P. SEWER WHICH IS NOT INDICATED ON THE PLANS, THE PIPE SHALL BE ENCASED PER 5-25, UNLESS OTHERWISE APPROVED BY THE COUNTY ENGINEER.
 14. HOUSE LATERALS TO BE CONSTRUCTED WITH INVERTS AT R/W LINE 6 FEET BELOW GRADE OF CONC. GUTTER.
 15. REINFORCE ALL TRENCHES WITHIN PAVED AREAS.
 16. SEWERS TO BE TESTED FOR LEAKAGE PER SECTION 506-2, S.T. STANDARD SPECIFICATIONS.
 17. REFER TO SECTION 7-10-4.1 OF THE STANDARD SPECIFICATIONS, REGARDING SAFETY ORDERS.

- THE FOLLOWING LATEST STANDARD PLANS ON FILE IN THE OFFICE OF THE COUNTY ENGINEER SHALL APPLY IN THE CONSTRUCTION OF THIS PROJECT:
- | | | |
|---|---------------------|------|
| LEGEND | SAFETY REQUIREMENTS | 5-1 |
| BRICK MANHOLE | | 5-2 |
| NON-REINFORCED PRECAST CONCRETE MANHOLE | | 5-3 |
| REINFORCED PRECAST CONCRETE MANHOLE | | 5-4 |
| MANHOLE FRAME AND COVER | | 5-5 |
| MANHOLE STEP | | 5-15 |
| PIPE FOR SEWER PIPE | | 5-17 |
| CRAPPLING AND ENCASEMENT | | 5-21 |
| PIPE OR TREE SUPPORT | | 5-23 |
| ALLOWABLE TRENCH WIDTHS | | 5-26 |
| | | 5-33 |

COLLECT CHARGES AS INDICATED

PROFILE, ALIGNMENT AND GRADE OF
 SANITARY SEWERS PAGE 1
 TO BE CONSTRUCTED IN
 TOWNE AVENUE (PVT. STREET)

PRIVATE CONTRACT NO. 8213

W.S. 26
 1 SHEET, 2 PAGES

SCALE: VERT. 1" = 4' NOVEMBER, 1968

PREPARED BY THE OFFICES OF
 L. M. NERENBAUM & ASSOC. INC.
 7466 BEVERLY BLVD., L.A. CALIF. 90056
 BY: Lewis M. Nerenbaum
 REG. C.E. NO. 8356

41145

FOR LEGEND SEE PLAN NO. S-1
 * PER PUBLIC WORKS CONSTRUCTION AND COUNTY ENGINEER SPECIAL PROVISIONS DATED JAN. 2, 1959 AS REVISED.
 GRADES TO WHICH THIS IMPROVEMENT IS TO BE CONSTRUCTED ARE SHOWN ON PLANS AND PROFILES. GRADE POINTS FOR TOP OF CURB, CENTER LINE OF STREET, OR CENTER LINE OF ALLEYS ARE SHOWN BY CIRCLES ON PROFILES. ALL POINTS BETWEEN DESIGNATED POINTS THE GRADE SHALL BE ESTABLISHED SO AS TO CONFORM TO A STRAIGHT LINE DRAWN BETWEEN SAID DESIGNATED POINTS. ELEVATIONS ARE IN FEET ABOVE U.S.C. & G.S. MEAN LEVEL DATUM OF 1929.
 THIS DRAWING AND THE DATA HEREON ARE HEREBY MADE A PART OF THE SPECIFICATIONS.
 WORK SHALL BE CONSTRUCTED ACCORDING TO STANDARD SPECIFICATIONS.
 AND SHALL BE PROSECUTED ONLY IN THE PRESENCE OF THE COUNTY ENGINEER.
 BEFORE WORK CAN BE STARTED, THE CONTRACTOR MUST OBTAIN A PERMIT TO EXCAVATE IN COUNTY STREETS FROM THE L.A. COUNTY ROAD DEPT., DISTRICT OFFICE NO. 10, 1000 W. 10TH ST., LOS ANGELES, CALIF. 90057. COUNTY ENGINEER'S BUREAU, THE WEST SECOND STREET ON THE WEST SIDE OF THE COURTHOUSE, DISTRICT OFFICE, BUREAU OF PUBLIC WORKS, DISTRICT OFFICE, 1000 W. 10TH ST., LOS ANGELES, CALIF. 90057. BUREAU OF PUBLIC WORKS, DISTRICT OFFICE, 1000 W. 10TH ST., LOS ANGELES, CALIF. 90057. APPROVAL OF THIS PLAN BY THE COUNTY OF LOS ANGELES DOES NOT CONSTITUTE A REPRESENTATION AS TO THE ACCURACY OF THE LOCATION OF OR THE EXISTENCE OR NON-EXISTENCE OF ANY UNDERGROUND UTILITY PIPE, OR STRUCTURE WITHIN THE LIMITS OF THE PROJECT. THIS NOTE APPLIES TO ALL PAGES.
 IF WORK IS TO BE DONE IN A STATE HIGHWAY, A PERMIT MUST BE OBTAINED FROM THE STATE OF CALIFORNIA, DIVISION OF HIGHWAYS, 120 SOUTH SPRING STREET, LOS ANGELES, CALIFORNIA.

COUNTY OF LOS ANGELES, CALIFORNIA
 JOHN A. LAMBIE, COUNTY ENGINEER J. D. PARKHURST, CHIEF ENGINEER
 CO. SAN. DIST. NO. 7
 APPROVED BY: [Signature] APPROVED BY: [Signature]
 REGIONAL ENGINEER OFFICE ENGINEER

CHECKED BY: [Signature] 2/10/69
 REG. C.E. NO. 13352

J. N. 0369.51

P. C. 8213 PAGE 2

COLLECT CHARGES AS INDICATED

41146

