

B.M. BY 3043 ELEV. 35.783
 ROB M TAG W CB SERVICE IS 1 FT + N BCR NE
 COR NORMANDE AVE + LEVINSON ST 35
 FT + N + 30 FT + E C/L INT.
 GARDENA QUAD. 19_65

THE FOLLOWING LATEST REVISED STANDARD PLANS ON FILE IN THE
 OFFICE OF THE COUNTY ENGINEER SHALL APPLY IN THE CONSTRUCTION
 OF THIS PROJECT:

- LEGEND
- S-1 MIN. PUBLIC SAFETY REQUIREMENTS
 - S-2 BRICK MANHOLE
 - S-3 NON REINFORCED PRECAST CONCRETE MANHOLE
 - S-4 REINFORCED PRECAST CONCRETE MANHOLE
 - S-5 MANHOLE FRAME AND COVER
 - S-6 MANHOLE STEP
 - S-7 BEDDING FOR SEWER PIPE
 - S-8 CRADLING AND ENCASEMENT
 - S-9 WYE OR TEE SUPPORT
 - S-10 ALLOWABLE TRENCH WIDTHS
 - S-11 STOPPER

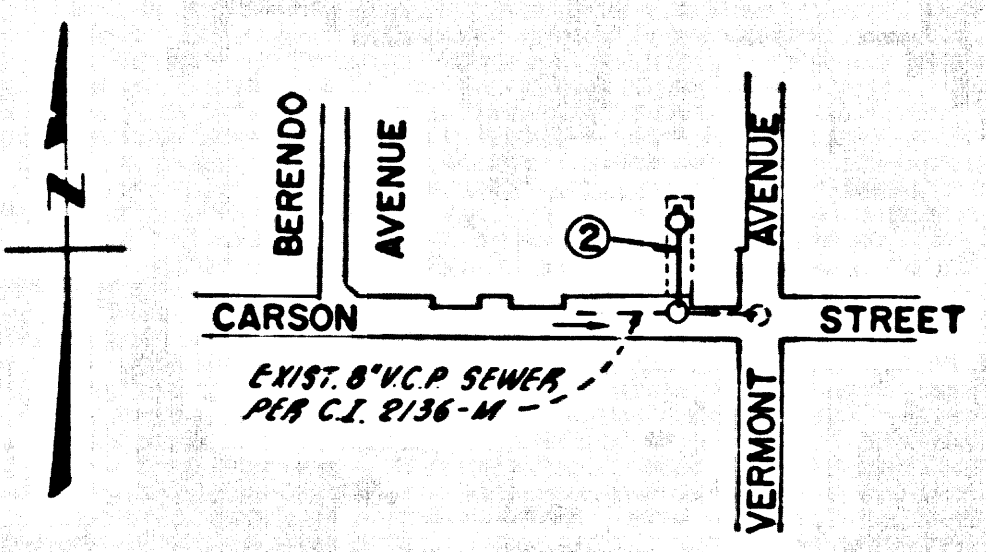

INDEX MAP
 SCALE: 1"=600'
 P.C. 8217

No connections for the disposal of
 industrial wastes shall be made to
 sewers shown on these drawings
 without written permission from the
 Chief Engineer and General Manager
 of the County Sanitation Districts.

LOMITA BLDG. DIST. NO. 12

PROFILE, ALIGNMENT AND GRADE OF
 SANITARY SEWERS PAGE 1

TO BE CONSTRUCTED IN
 PARCEL MAP 724

PRIVATE CONTRACT NO. 8217

W.S. 28
 1 SHEET 2 PAGES

SCALE: VERT. 1"=4' HORIZ. 1"=40' NOVEMBER, 1968

41177

PREPARED IN THE OFFICES OF
 DUDLEY H. CLARK & ASSOCIATES
 16610 VENTURA BOULEVARD
 ENGINO, CALIFORNIA 91318

BY: *[Signature]*
 REG. C. E. NO. 10261

FOR LEGEND SEE PLAN NO. S-1

NOTE:
 GRADES TO WHICH THIS IMPROVEMENT IS TO BE CONSTRUCTED ARE SHOWN ON PLANS AND PROFILE. GRADE POINTS FOR TOP OF
 CURBS, CENTER LINE OF STREETS, OR CENTER LINE OF ALLEYS ARE SHOWN BY CIRCLES ON PROFILE. AT ALL POINTS BETWEEN DESIGNATED
 POINTS THE GRADE SHALL BE ESTABLISHED SO AS TO CONFORM TO A STRAIGHT LINE DRAWN BETWEEN SAID DESIGNATED POINTS.
 SEPARATIONS ARE BY FEET ABOVE B.C.E. & S.L. BE LEVEL BOTTOM OF TRENCH.
 THIS DRAWING AND THE DATA HEREON ARE HEREBY MADE A PART OF THE SPECIFICATIONS.
 WORK SHALL BE CONSTRUCTED ACCORDING TO STANDARD SPECIFICATIONS FOR PUBLIC PRIVATE CONSTRUCTION AND SPECIAL PROVISIONS
 WHICH SHALL BE OBTAINED FROM THE COUNTY ENGINEER'S OFFICE.
 THE CONTRACTOR SHALL BE RESPONSIBLE FOR OBTAINING ALL NECESSARY PERMITS FROM THE L.A. COUNTY ENGINEER'S BUREAU,
 THE WEST SECOND STREET OFFICE, DISTRICT OFFICE NO. 12, 16610 VENTURA BOULEVARD, ENGINO, CALIFORNIA 91318.
 APPROVAL OF THIS PLAN BY THE COUNTY OF LOS ANGELES DOES NOT CONSTITUTE A REPRESENTATION AS TO THE ACCURACY OF THE
 LOCATION OF OR THE EXISTENCE OR NON-EXISTENCE OF ANY UNDERGROUND UTILITY PIPE, OR STRUCTURE WITHIN THE LIMITS OF THIS
 PROJECT. THIS NOTE APPLIES TO ALL PAGES.
 IF WORK IS TO BE DONE IN A STATE HIGHWAY, A PERMIT MUST BE OBTAINED FROM THE STATE OF CALIFORNIA, DIVISION OF HIGHWAYS,
 128 SOUTH SPRING STREET, LOS ANGELES, CALIFORNIA.

- NOTES:
1. PROFILE STAKES ON THE PROPERTY LINE OR PROPERTY LINES PRODUCED AT RIGHT ANGLES TO THE SEWER LINE AT THE CENTER LINE OF EACH MANHOLE.
 2. NO REPRESENTATIVE OF THE COUNTY ENGINEER WILL SURVEY OR LAY OUT ANY PORTION OF THE WORK.
 3. THE PRIVATE ENGINEER SHALL FURNISH THE COUNTY ENGINEER WITH GRADE SHEETS AND STATIONING FOR ALL HOUSE LATERALS AND 12" OR 18" BRANCHES AND SHALL PROVIDE STAKES FOR THEM AT THEIR PROPER LOCATIONS WITH STATIONING PLAINLY MARKED. ALL HOUSE LATERALS SHALL BE CONSTRUCTED IN A STRAIGHT ALIGNMENT AT RIGHT ANGLES FROM THE MAIN LINE SEWER EXCEPT AS SHOWN ON THE PLANS. HOUSE LATERALS FROM CHIMNEYS SHALL NOT HAVE AN ANGLE OF LESS THAN 45° WITH THE MAIN LINE SEWER. ANY CHANGE IN ALIGNMENT SHALL BE REQUESTED BY WRITING BY THE PRIVATE ENGINEER.
 4. THE PRIVATE ENGINEER SHALL FURNISH THE HOUSE LATERAL DEPTH AT THE PROPERTY LINE BELOW THE TOP OF CURB ELEVATION FOR EACH HOUSE LATERAL ON THE GRADE SHEET.
 5. NO REVISIONS SHALL BE MADE IN THESE PLANS WITHOUT THE APPROVAL OF THE COUNTY ENGINEER.
 6. THE CONTRACTOR SHALL NOTIFY THE CONSTRUCTION DIVISION BY TELEPHONE, MADISON 9-0707, EXT. 81381, AT LEAST TWENTY-FOUR HOURS BEFORE STARTING ANY WORK UNDER THIS CONTRACT.
 7. ALL STRUCTURES SHALL BE EITHER BRICK MANHOLES PER S-3 OR PRECAST CONCRETE MANHOLES PER S-4 OR S-5, EXCEPT AS NOTED.
 8. 12" OR 18" BRANCHES MAY BE USED FOR CONNECTIONS TO MAINLINE SEWERS EXCEPT AS NOTED.
 9. MANHOLE TOPS IN UNIMPROVED RIGHTS-OF-WAY TO BE SIX INCHES ABOVE FINISHED GRADE.
 10. USE EXTRA STRENGTH PIPE, ALL PIPE IS STANDARD UNLESS NOTED.
 11. WITHELD CLAY PIPE JOINTS SHALL BE TYPE "D", "F" OR "G" PER STANDARD SPECIFICATIONS SECTION 708-2.
 12. IF A POWER POLE IS WITHIN THREE FEET OF THE SEWER, THE SEWER SHALL BE ENCASED, PER S-23, TWO FEET ON EACH SIDE FROM THE POINT OF INTERFERENCE.
 13. IF DURING THE COURSE OF CONSTRUCTION IT IS DETERMINED THAT THERE IS LESS THAN FOUR FEET OF COVER OVER THE TOP OF A MAIN LINE OR HOUSE LATERAL V.C.P. SEWER WHICH IS NOT INDICATED ON THE PLANS, THE PIPE SHALL BE ENCASED PER S-23, UNLESS OTHERWISE APPROVED BY THE COUNTY ENGINEER.
 14. HOUSE LATERALS TO BE CONSTRUCTED WITH INVERTS AT PROPERTY LINE 6 FEET BELOW CURB GRADE EXCEPT AS NOTED.
 15. RESURFACE ALL TRENCHES WITHIN PAVED AREAS TO MEET L.A. COUNTY ROAD DEPT. OR CALIFORNIA STATE HIGHWAY REQUIREMENTS IN ACCORDANCE WITH PERMITS.
 16. SEWERS TO BE TESTED FOR LEAKAGE PER SECTION 706-2.3.7 OF THE STD. SPECS.
 17. REFER TO SECTION 7-M.1.1 OF THE STD. SPECS, REGARDING SAFETY DEVICES.

County Sanitation Districts shall be notified prior to the following so that required inspection can be made (Phone 636-3085 - 636-3097)

Acceptance of the project.

COLLECT CHARGES AS INDICATED

COUNTY OF LOS ANGELES, CALIFORNIA
 JOHN A. LAMBE, COUNTY ENGINEER J. D. PARKHURST, CHIEF ENGINEER
 CO. SAN. DIST. NO. 12
 APPROVED BY: *[Signature]* REGIONAL ENGINEER APPROVED BY: *[Signature]* OFFICE ENGINEER

CHECKED BY: *[Signature]* 11-19-68
 REG. C. E. NO. 9406

J. N. 0250.02

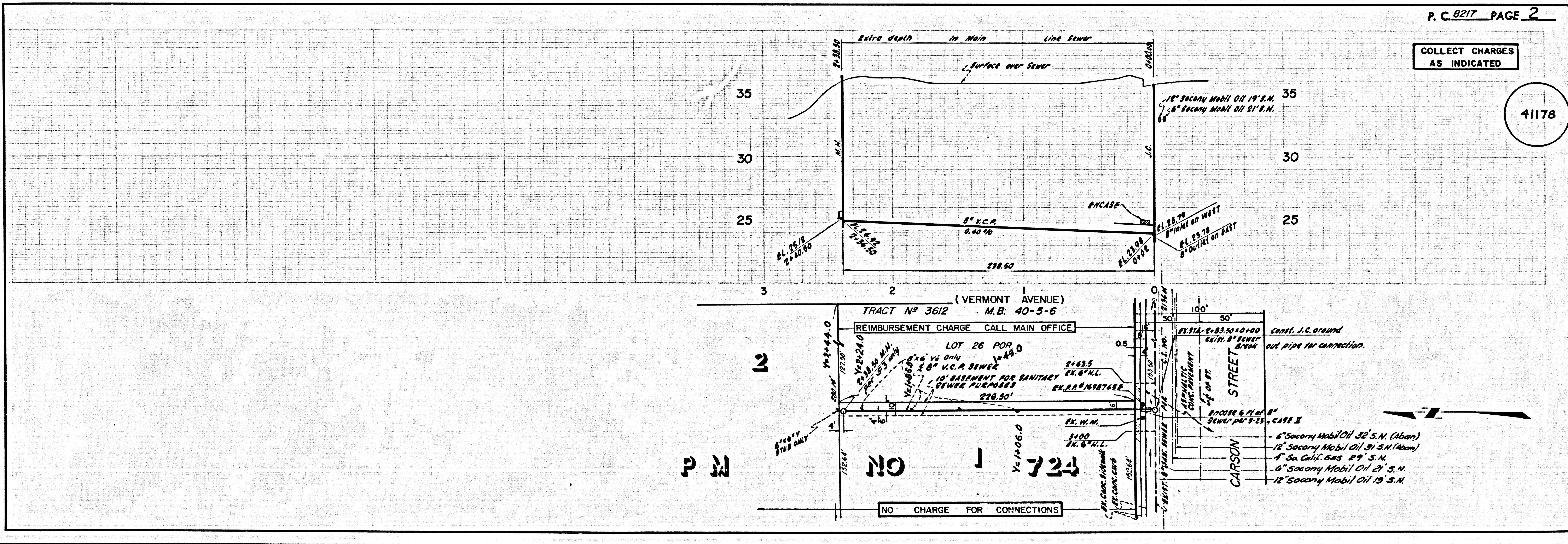

COLLECT CHARGES AS INDICATED

41178