

Profile Scale
 Horiz. : 1" = 40'
 Vert. : 1" = 4'

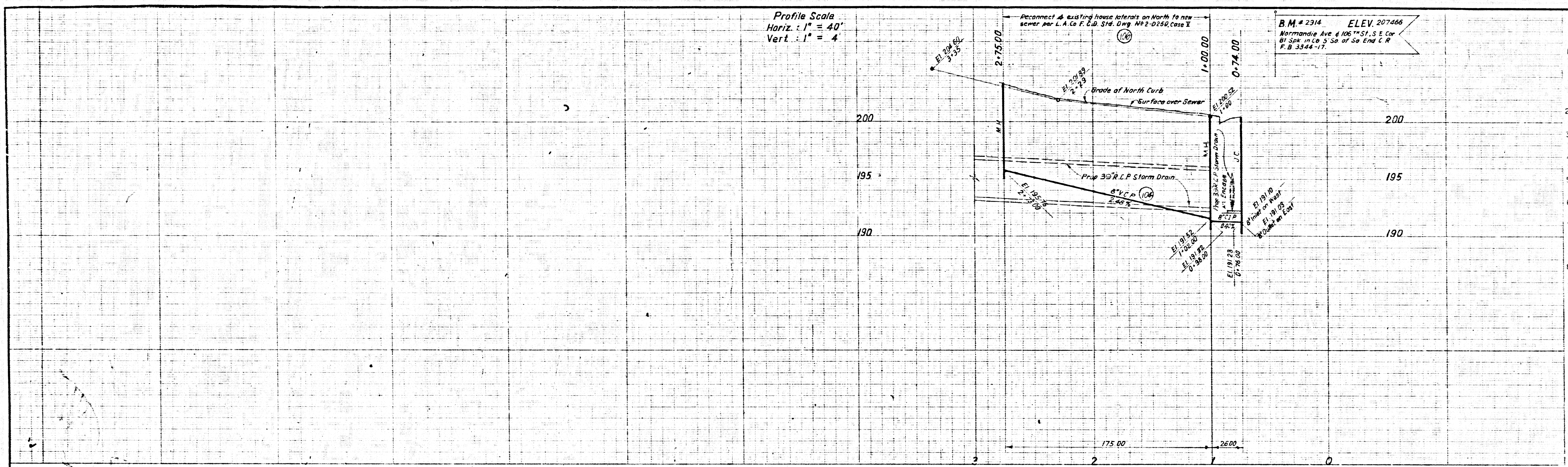

GENERAL SEWER NOTES

- Sanitary sewers shall be constructed in accordance with the Standard Specifications for Public Works Construction (hereinafter referred to as the Standard Specifications), as amended by the L.A. County Engineer.
- Verified clay pipe joints shall be Type "F" or "G" per Section 208-2 of Standard Specifications.
- "T" or "Y" branches may be used for connection to main line sewers.
- Sewer pipe and appurtenances shall be abandoned in accordance with Section 306-3 of Standard Specifications.
- Existing sewer services and flow shall be maintained at all times.
- No revisions shall be made to these plans without the approval of the County Engineer.
- The Contractor shall notify the Construction Division of the County Engineer by telephone 623-4747, Ext. 6151, at least twenty-four hours before starting any work under this contract.
- All concrete cross-gutters, curbs, gutters and driveways shall be furnished or jacked per Los Angeles County Road Department requirements.
- All cast iron sewer pipe and joints shall be in accordance with Sections 207-9(a) and 207-9(b) of Section 208-2 of the (S.D.S.) OF THE STANDARD SPECIFICATIONS.

C.C. 8232

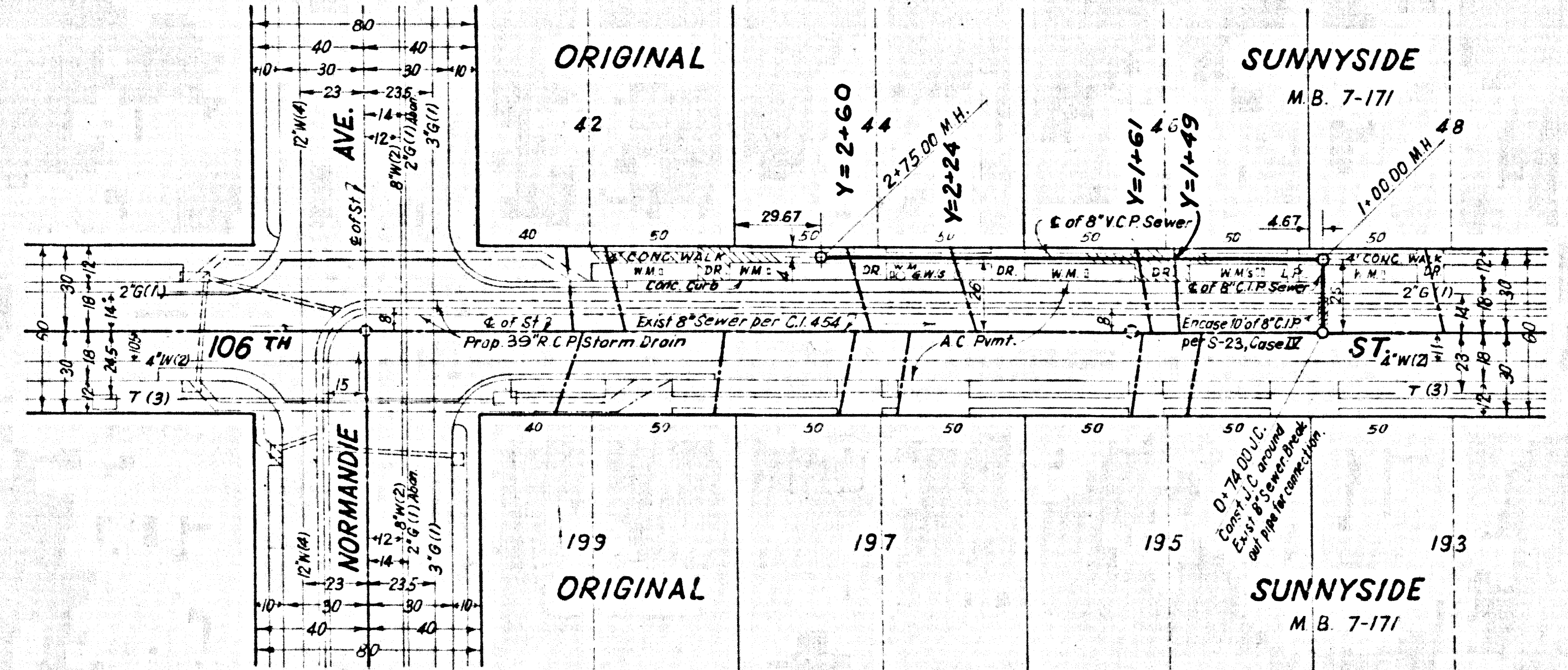

No connections for the disposal of industrial wastes shall be made to sanitary sewers on these drawings without written permission from the County Engineer and General Manager of the County Sanitation Districts.

County Sanitation Districts shall be notified prior to the following so that required inspection can be made (Phone 207-2000 - 600-2077).

41927

NOTE: This sheet applies to all proposals.

REVISIONS		
MARK	DATE	DESCRIPTION

Underground utility companies are as follows:
 (1) Southern California Gas Co.
 (2) L.A. Co. Waterworks Dist. NYI
 (3) Pacific Telephone
 (4) Southern California Water Co.

NOTE: SEE SHEET 9 FOR STORM DRAIN CONSTRUCTION

APPROVED
JOHN D. PARKHURST
 CHIEF ENGINEER
 CO. SAN. DIST. NYI S

PREPARED BY
JOHN A. LAMBIE
 COUNTY ENGINEER
 C.C. 8232
 RECOMMENDED BY
[Signature]
 ASST. DIVISION ENGINEER, SANITATION DIVISION

1964 STORM DRAIN BOND ISSUE
 LOS ANGELES COUNTY
 FLOOD CONTROL DISTRICT
 COUNTY
 PROJECT NO. 1208
 COUNTY ENGINEER
JOHN A. LAMBIE
 SANITARY SEWER RECONSTRUCTION
 PLAN AND PROFILE
 C.C. 8232
 RECOMMENDED BY
[Signature]
 DIVISION ENGINEER, SANITATION DIVISION
 APPROVED BY
[Signature]
 CHIEF ENGINEER
 COUNTY ENGINEER
 SCALE: 1" = 40'
 DATE: MAY '69
 DWG. NO. 364-1208-D2 21
 SHEET 21 OF 21

C.C. 8232