

B.M. BL 1232 ELEV. 1266.36
 1"=80' CONC. FOOTING OF CHAIN LINK FENCE SD 11
 W. CL. BOUQUET CANYON ROAD + 25 FT. S.
 L.A. CITY AQUEDUCT 500 FT. N. ENT. CO.
 REHABILITATION CTR. MKD (BM)
 NEWHALL QUAD. 1965

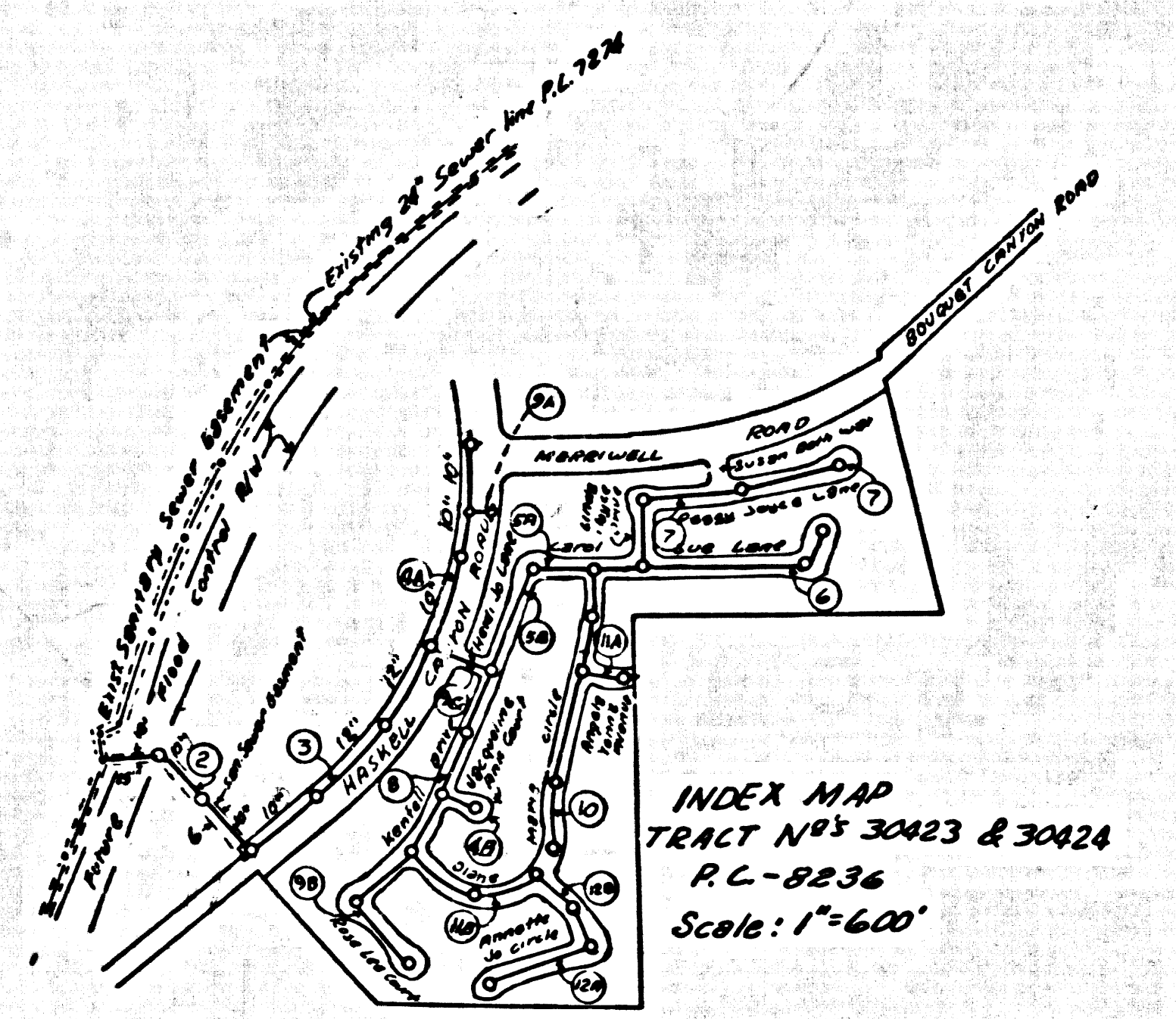

NOTES: continued
 20. **SEWER BACKFILL IN DISSEMINATED AREAS:**
 a) Backfill trench and replace with earth removed so as to achieve the natural or finished grades and slopes shown on the grading plan approved for this tract by Bldg. & Safety Division.
 b) All backfill and earth replaced shall be compacted to a minimum of 90% of max. density, per ASTM Standard Method of Testing D 698-57T. As modified. Acceptable certification of such compaction shall be submitted to the Construction Division.
 Lots No. 40 and 41 Tract 30423 are platted recreation lots and will not be served. Lots 42 through 104 of Tract 30424 are platted recreation lots and will not be served.

REVISIONS:
 1. Page 2 - Revised sewer grades from station 875.24 to station 875.24 to accommodate for center station change.
 2. Page 3 - Revised sewer grades from station 875.24 to station 875.24 to accommodate for center station change.
 3. Pages 5-7 - Revised catchment areas and changed at times, due to revised Tract Map.
 APPROVED: *Ralph Schaper* DATE: 4/22/69
 OFFICE OF THE COUNTY ENGINEER R.C.E. 13906

County Sanitation Districts shall be notified prior to the following so that required impounding can be made.
 Phone 337-1028 or 446-6699.

No connections for the disposal of industrial wastes shall be made in areas shown on these drawings without written permission from the Chief Engineer and General Manager of the County Sanitation Districts.

ALLOW NO CONSTRUCTION BETWEEN STA. 1+00 & 2+75.24 (P.B. 2) UNTIL TRACTS 30423 & 30424 ARE RECORDED

NEWHALL BLDG. DIST. NO. 82

- PROFILE, ALIGNMENT AND GRADE OF
 SANITARY SEWERS
 TO BE CONSTRUCTED IN
 TRACT No's 30423 & 30424
 PRIVATE CONTRACT NO. 8236
 270-5-129
 6 SHEETS; 12 PAGES
 SCALE: HORIZ. 1"=40' VERT. 1"=4'
 APRIL, 1969
 PREPARED IN THE OFFICES OF
 STEELE, SPINDLER & ASSOCIATES
 13047 VENTURA BLVD., STUDIO CITY, CALIF.
 REG. C. E. NO. 13194
- NOTES:
 1. HOUSE LATERALS TO BE CONSTRUCTED WITH INVERTS AT PROPERTY LINE 6 FEET BELOW CURB GRADE EXCEPT AS NOTED.
 2. PROVIDE STAIRS ON THE PROPERTY LINE OR PROPERTY LINES PRODUCED AT RIGHT ANGLES TO THE SEWER LINE AT THE CENTER LINE OF EACH MANHOLE.
 3. NO REPRESENTATIVE OF THE COUNTY ENGINEER WILL SURVEY OR LAY OUT ANY PORTION OF THE WORK.
 4. THE PRIVATE ENGINEER SHALL FURNISH THE COUNTY ENGINEER WITH GRADE SHEETS AND STATIONING FOR ALL HOUSE LATERALS AND "T" OR "T" BRANCHES AND SHALL PROVIDE STAIRS FOR THEM AT THEIR PROPER LOCATIONS WITH STATIONING PLAINLY MARKED. ALL HOUSE LATERALS SHALL BE CONSTRUCTED IN A STRAIGHT ALIGNMENT AT RIGHT ANGLES FROM THE MAIN LINE SEWER EXCEPT AS SHOWN ON THE PLANS. HOUSE LATERALS FROM CHIMNEYS SHALL NOT HAVE AN ANGLE OF LESS THAN 45° WITH THE MAIN LINE SEWER. ANY CHANGE IN ALIGNMENT SHALL BE REQUESTED IN WRITING BY THE PRIVATE ENGINEER.
 5. THE PRIVATE ENGINEER SHALL FURNISH THE HOUSE LATERAL DEPTH AT THE PROPERTY LINE BELOW THE TOP OF CURB ELEVATION FOR EACH HOUSE LATERAL ON THE GRADE SHEET.
 6. NO REVISIONS SHALL BE MADE IN THESE PLANS WITHOUT THE APPROVAL OF THE COUNTY ENGINEER.
 7. THE CONTRACTOR SHALL NOTIFY THE CONSTRUCTION DIVISION BY TELEPHONE, MADISON 9-4749, EXT. 81581, AT LEAST TWENTY-FOUR HOURS BEFORE STARTING ANY WORK UNDER THIS CONTRACT.
 8. ALL STRUCTURES SHALL BE EITHER BRICK MANHOLES PER S-3 OR PRECAST CONCRETE MANHOLES PER S-3 OR S-4, EXCEPT AS NOTED.
 9. "T" OR "T" BRANCHES MAY BE USED FOR CONNECTIONS TO MAINLINE SEWERS EXCEPT AS NOTED.
 10. MANHOLE TOPS IN UNIMPROVED RIGHTS OF WAY TO BE 2 1/2 INCHES ABOVE FINISHED GRADE, EXCEPT AS NOTED.
 11. USE EXTRA STRENGTH PIPE. ALL PIPE IS STANDARD DEPTH EXCEPT AS NOTED.
 12. WITHEDED CLAY PIPE JOINTS SHALL BE TYPE "B", "C", OR "D" PER STANDARD SPECIFICATIONS SECTION 306-2.
 13. IF A POWER POLE IS WITHIN THREE FEET OF THE SEWER, THE SEWER SHALL BE ENCASED, PER S-23, TWO FEET ON EACH SIDE FROM THE POINT OF INTERFERENCE.
 14. IF DURING THE COURSE OF CONSTRUCTION IT IS DETERMINED THAT THERE IS LESS THAN FOUR FEET OF COVER OVER THE TOP OF A MAIN LINE OR HOUSE LATERAL V.C.P. SEWER WHICH IS NOT INDICATED ON THE PLANS, THE PIPE SHALL BE ENCASED PER S-23, UNLESS OTHERWISE APPROVED BY THE COUNTY ENGINEER.
 15. INSURE ALL TRENCHES WITHIN PAVED AREAS TO MEET L.A. COUNTY ROAD DEPT. OR CALIFORNIA STATE HIGHWAY REQUIREMENTS IN ACCORDANCE WITH PERMITS.
 16. SEWERS TO BE TESTED FOR LEAKAGE PER SECTION 306-2.3.7 OF THE STANDARD SPECIFICATIONS.
 17. REFER TO SECTION 7-78.1.1 OF THE STANDARD SPECIFICATIONS, REGARDING SAFETY ORDERS.
 18. ALL JOINTS BETWEEN CAST IRON PIPE AND WITHEDED CLAY PIPE SHALL BE MADE WITH A RUBBER SLEEVE JOINT, TYPE "C" OR "D", WITH RUBBER JOINT NECESSARY PER STANDARD SPECIFICATIONS SECTION 306-2.
 19. BRIDGES TO BE DONE PRIOR TO SEWER CONSTRUCTION.
 THE FOLLOWING LATEST REVISED STANDARD PLANS ON FILE IN THE OFFICE OF THE COUNTY ENGINEER SHALL APPLY IN THE CONSTRUCTION OF THIS PROJECT:
- | | |
|---|------|
| SECTION | NO. |
| MINIMUM PUBLIC SAFETY REQUIREMENTS | S-1 |
| BRICK MANHOLE | S-3 |
| NON-REINFORCED PRECAST CONCRETE MANHOLE | S-4 |
| REINFORCED PRECAST CONCRETE MANHOLE | S-5 |
| MANHOLE FRAME AND COVER | S-6 |
| STANDARD MANHOLE SET | S-7 |
| ROOFING FOR SEWER PIPE | S-8 |
| CHANGING LINE ENCASEMENT | S-23 |
| WYE ON THE SUPPORT | S-24 |
| ALLOWABLE TRENCH WIDTHS | S-25 |
- The following Sanitation District Standards shall apply in the construction of this project:
 Standard Pressure Manhole Frame & Cover S-A-20B
- REVISIONS:
 1. Offset M.H. at Sta. C+4872 Page 2 & (Page 3) due to Gas Line
 APPROVED: *Ralph Schaper* DATE: 4/22/69
 OFFICE OF THE COUNTY ENGINEER R.C.E. 13906
- REVISIONS:
 Revise sewer grades on pages 5-B & 9-C.
 APPROVED: *Ralph Schaper* DATE: 4-6-70
 OFFICE OF THE COUNTY ENGINEER R.C.E. 13906

COLLECT CHARGES AS INDICATED

REVISIONS:
 Revise sewer grades on pages 5-B & 9-C.
 APPROVED: *Ralph Schaper* DATE: 4-6-70
 OFFICE OF THE COUNTY ENGINEER R.C.E. 13906

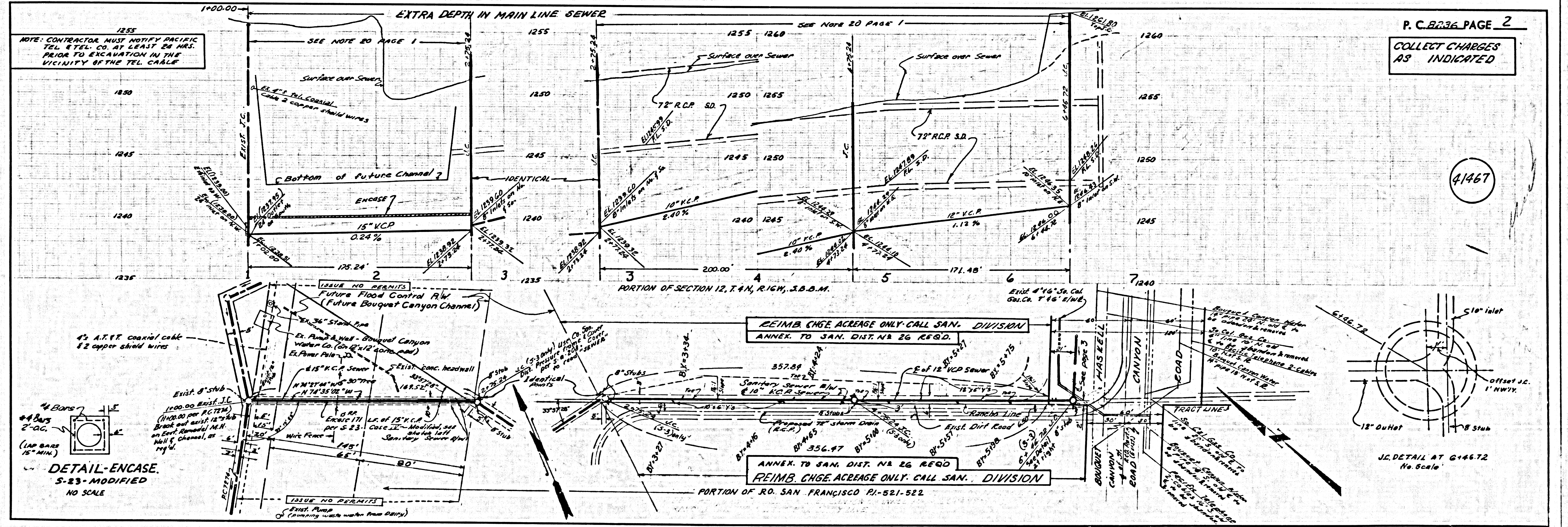

COLLECT CHARGES AS INDICATED

REVISIONS:
 Revise sewer grades on pages 5-B & 9-C.
 APPROVED: *Ralph Schaper* DATE: 4-6-70
 OFFICE OF THE COUNTY ENGINEER R.C.E. 13906

