

B.M. SL642 ELEV. 1262.07
 ROAD DEPT. B.M. NO. SIDE CONC. BASE
 AT N.E. COR. EDISON HIGH TENSION
 TOWER #M-373W3-335 TO E LYONS AVE.
 130 E E WILLY CANYON RD.
 N.E. WHALL QUAD. 1958

THE FOLLOWING COUNTY ENGINEER STANDARD PLANS
 APPLY TO THIS PROJECT

- LEGEND
- MINIMUM PUBLIC SAFETY REQUIREMENTS S-1
 - BRICK MANHOLE S-2
 - NON-REINFORCED PRECAST CONC. MANHOLE S-3
 - REINFORCED PRECAST CONC. MANHOLE S-4
 - MANHOLE FRAME AND COVER S-15
 - MANHOLE STEP S-17
 - BEDDING FOR SEWER PIPE S-21
 - CREDLING & ENCASEMENT S-23
 - WYE & Tee SUPPORT S-26
 - ALLOWABLE TRENCH WIDTH S-33
 - WYE SADDLE - HOUSE LATERAL S-38

REVISION:
 P. 4 - Revised Street Alignment and
 Grades At Sarda Rd. & Avenida
 Escalera. Added eo to H.L. Sewing
 Lot 100.
 P. 3 & 4 Revised Lot Numbers.
 (Eliminated One Lot)
 Approved: R. J. [Signature] Date: 2/23/69
 Office of The County Engineer

DOUBLE SCALE
 NEWHALL BLDG. DIST. NO. 8.2

PROFILE, ALIGNMENT AND GRADE OF
 SANITARY SEWERS PAGE 1
 CONSTRUCTED IN

TRACT N° 25112
 PRIVATE CONTRACT NO. 8258.

INDEX 2525121
 3 SHEETS, 6 PAGES
 SCALE: HORIZ. 1" = 40' VERT. 1" = 4'
 FEB. 1969
 PREPARED IN THE OFFICE OF
 VOORHEIS-TRINDLE CO.
 5919 VAN NUYS BLVD., VAN NUYS, CALIF.
 REG. C. E. NO. 16744

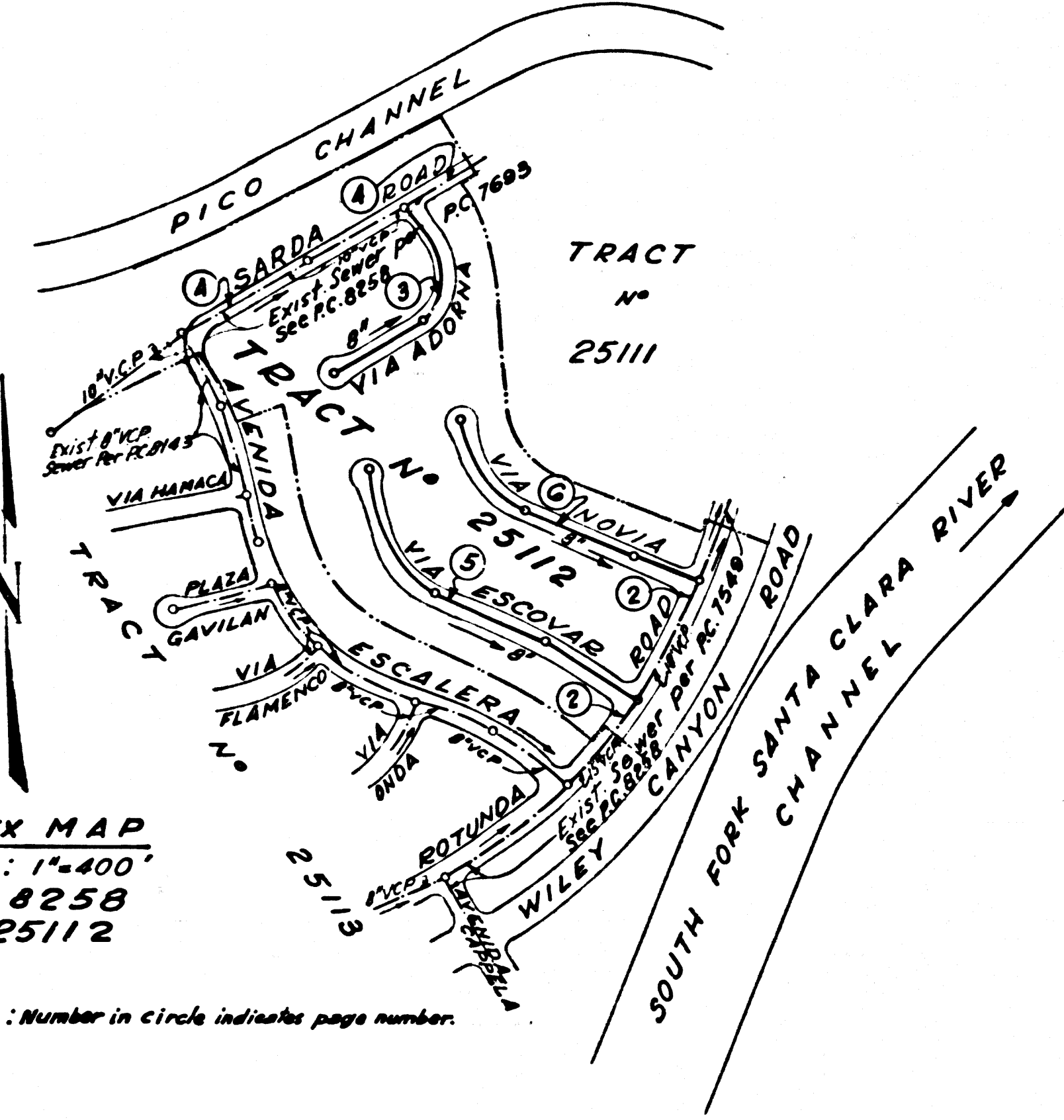

GRADING TO BE DONE PRIOR TO
 SEWER CONSTRUCTION.
 LOTS THAT DO NOT HAVE SERVICE:
 LOT 102 IS RESTRICTED USE
 FOR WALKS, TREES, PLANTING
 AND LANDSCAPING.

County Sanitation Districts shall be
 notified prior to the following so
 that required inspection can be made
 (Phone 587-1025 or 444-4408).

Acceptance of the project.

No connections for the disposal of
 industrial wastes shall be made to
 sewers shown on these drawings
 without written permission from the
 Chief Engineer and General Manager
 of the County Sanitation Districts.

- NOTES:
1. PROVIDE STAKES ON THE PROPERTY LINE OR PROPERTY LINE PRODUCED AT RIGHT ANGLES TO THE SEWER LINE AT THE CENTER LINE OF EACH MANHOLE.
 2. NO REPRESENTATIVE OF THE COUNTY ENGINEER WILL SURVEY OR LAY OUT ANY PORTION OF THE WORK.
 3. THE PRIVATE ENGINEER SHALL FURNISH THE COUNTY ENGINEER WITH GRADE SHEETS AND STATIONING FOR ALL HOUSE LATERALS AND "T" BRANCHES AND SHALL PROVIDE STAKES FOR THEM AT THEIR PROPER LOCATIONS WITH STATIONING PLANT MARKERS. ALL HOUSE LATERALS SHALL BE CONSTRUCTED IN A STRAIGHT ALIGNMENT AT RIGHT ANGLES TO THE MAIN LINE SEWER EXCEPT AS SHOWN ON THE PLANS. HOUSE LATERALS FROM CHIMNEYS SHALL NOT HAVE AN ANGLE OF LESS THAN 45° WITH THE MAIN LINE SEWER. ANY CHANGE IN ALIGNMENT SHALL BE REQUESTED BY WRITING BY THE PRIVATE ENGINEER.
 4. THE PRIVATE ENGINEER SHALL FURNISH THE HOUSE LATERAL DEPTH AT THE PROPERTY LINE BELOW THE TOP OF CURB ELEVATION FOR EACH HOUSE LATERAL ON THE GRADE SHEET.
 5. NO REVISIONS SHALL BE MADE IN THESE PLANS WITHOUT THE APPROVAL OF THE COUNTY ENGINEER.
 6. THE CONTRACTOR SHALL NOTIFY THE COUNTY ENGINEER DIVISION BY TELEPHONE, RAMBSON 9-242, EXT. 8128, AT LEAST TWENTY-FOUR HOURS BEFORE STARTING ANY WORK UNDER THE CONTRACT.
 7. ALL STRUCTURES SHALL BE EITHER BRICK MANHOLES PER S-2, OR PRECAST CONCRETE MANHOLES PER S-3 & S-4 EXCEPT AS NOTED.
 8. USE STANDARD MANHOLE FRAMES AND COVERS, S-18.
 9. USE EXTRA STRENGTH PIPE ALL PIPE IS STANDARD DEPTH EXCEPT AS NOTED.
 10. VITRIFIED CLAY PIPE JOINTS SHALL BE TYPE "D" "4" OR "6" PER STD. SEC. 508-2.
 11. IF A POWER POLE IS WITHIN THREE FEET OF THE SEWER, THE SEWER SHALL BE ENCASED, PER S-23, TWO FEET ON EACH SIDE FROM THE POINT OF INTERFERENCE.
 12. IN MAKING THE COVER OF CONSTRUCTION IT IS REMEMBERED THAT THERE IS LESS THAN FOUR FEET OF COVER OVER THE TOP OF A MAIN LINE OR HOUSE LATERAL V.C.P. SEWER WHICH IS NOT INDICATED ON THE PLAN, THE PIPE SHALL BE ENCASED PER S-23 UNLESS OTHERWISE APPROVED BY THE COUNTY ENGINEER.
 13. HOUSE LATERALS TO BE CONSTRUCTED WITH INVERTS AT PROPERTY LINE 6 FEET BELOW CURB GRADE.
 14. REINFORCE ALL TRENCHES WITHIN PAVED AREAS TO ARIET L.A. COUNTY ROAD DEPT. OR CALIFORNIA STATE HIGHWAY DEPT. REQUIREMENTS IN ACCORDANCE WITH PERMITS.
 15. SEWERS TO BE TESTED FOR LEAKAGE PER SEC. 506-2.8.7 OF STD. SPEC.
 16. REFER TO SEC. 1-10.1.1 BY STD. SPECIFICATIONS REGARDING SAFETY OFFICERS.
 17. THE OR WYE BRANCHES MAY BE USED FOR CONN. TO MAIN LINE SEWER EXCEPT AS NOTED.
 18. SPECIAL BACKFILL IN DESIGNATED AREAS: (A) BACKFILL 7-1/2 INCH (B) REPLACE OTHER BACKFILL REMOVED UP TO 30" - ACHIEVE THE NATURAL FINISHED GRADE AND SLOPES SHOWN ON GRADE SHEET APPROVED FOR THIS TRACT BY: BUILDING & SAFETY DIVISION; (C) ALL BACKFILL AND EARTH TO BE REPLACED SHALL BE COMPACTED TO THE DENSITY BY S.M.S. PER A.S.T.M. METHOD AS TEST D 698-62 AS MODIFIED AS INDICATED ON THE DRAWINGS.
 19. ACCEPTABLE CERTIFICATION OF SOIL COMPACTIONS SHALL BE SUBMITTED TO THE CONST. DIVISION.
 20. SEWER PIPE BEDDING SHALL CONFORM TO S-21.

COLLECT CHARGES
 AS INDICATED

NOTICE TO CONTRACTOR
 The existence and location of any underground utility pipes or structures shown on these plans are obtained by a search of the available records. To the best of my knowledge there are no existing utilities except as shown on these plans. The contractor is required to take due precautionary measures to protect the utility lines shown and any other lines not of record or not shown on these plans.
 Michael J. [Signature] 2-17-69 REG. 16744

NOTE:
 GRADES TO WHICH THIS IMPROVEMENT IS TO BE CONSTRUCTED ARE SHOWN ON PLANS AND PROFILES. GRADE POINTS FOR TOP OF CURB, CENTER LINE OF STREETS, OR CENTER LINE OF ALLEYS ARE SHOWN BY CIRCLES ON PROFILES. AT ALL POINTS BETWEEN DESIGNATED POINTS THE GRADE SHALL BE ESTABLISHED SO AS TO CONFORM TO A STRAIGHT LINE BETWEEN SAID DESIGNATED POINTS. ELEVATIONS ARE IN FEET ABOVE U.S.C. & G.S. MEAN SEA LEVEL OF 1929.
 WORK SHALL BE CONSTRUCTED ACCORDING TO STANDARD SPECIFICATIONS FOR PUBLIC WORKS CONSTRUCTION (OR ENGINEER SPECIAL PROVISIONS DATED JAN. 1, 1960 AS REVISED) AND SHALL BE PRECEDED BY THE PRESENCE OF AN ENGINEER. BEFORE WORK CAN BE STARTED, THE CONTRACTOR MUST OBTAIN A PERMIT TO EXCAVATE FROM THE L.A. COUNTY ROAD DEPT., DISTRICT OFFICE NO. 11 AND PAY A FEE TO THE COUNTY ENGINEER, ROOM 300, COUNTY ENGINEERING BUILDING, 500 WEST SECOND STREET, DISTRICT OFFICE, SUPERVISOR TO COVER THE COST OF CONSTRUCTION INSPECTION AND RECORD PLANS. APPROVAL OF THIS PLAN BY THE COUNTY OF LOS ANGELES DOES NOT CONSTITUTE A REPRESENTATION AS TO THE ACCURACY OF THE LOCATION OF OR THE EXISTENCE OR NON-EXISTENCE OF ANY UNDERGROUND UTILITY PIPE, OR STRUCTURE WITHIN THE LIMITS OF THIS PROJECT. THIS NOTE APPLIES TO ALL PAGES.
 IF WORK IS TO BE DONE IN A STATE HIGHWAY, A PERMIT MUST BE OBTAINED FROM THE STATE OF CALIFORNIA, DIVISION OF HIGHWAY, 120 SOUTH SPRING STREET, LOS ANGELES, CALIFORNIA.

COUNTY OF LOS ANGELES, CALIFORNIA
 JOHN A. LAMBIE, COUNTY ENGINEER J. D. PARKHURST, CHIEF ENGINEER
 CO. SAN. DIST. NO. 8.2
 APPROVED BY: [Signature] APPROVED BY: [Signature]
 PROFESSIONAL ENGINEER 4/24/69 OFFICE ENGINEER

CHECKED BY: Ralph Schap [Signature] DATE 4/23/69
 REG. C. E. NO. 13426

J.N.0250.02

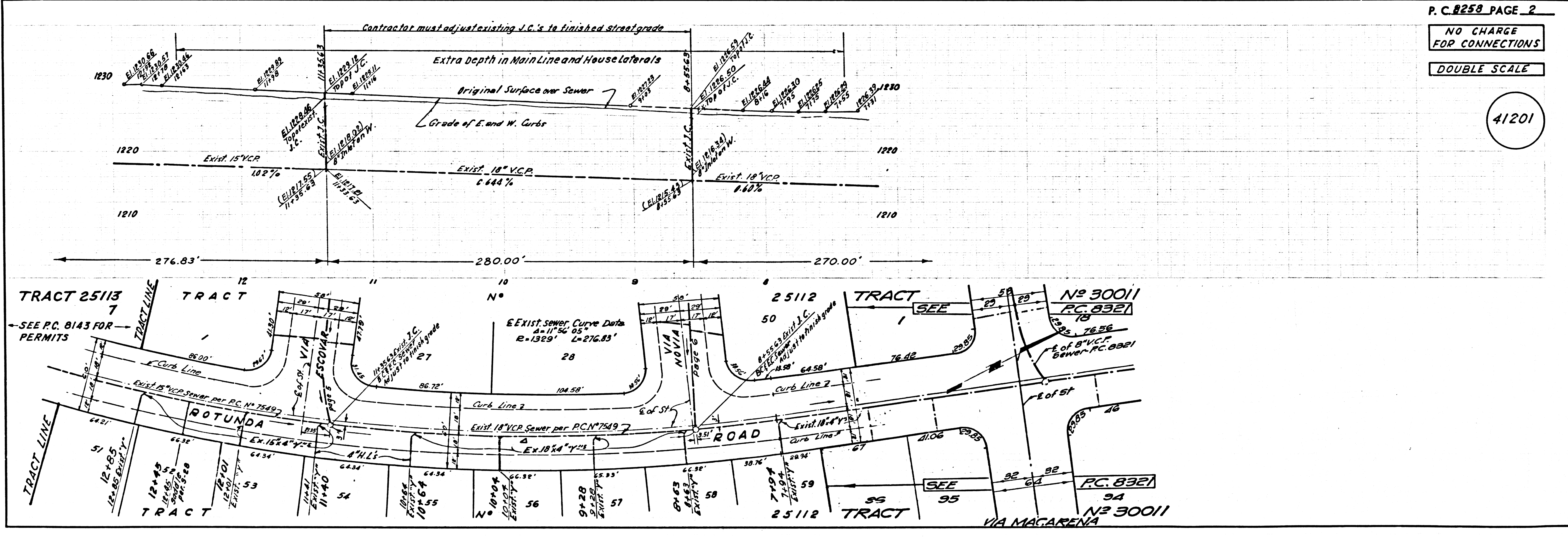

P.C. 8258 PAGE 2
 NO CHARGE
 FOR CONNECTIONS
 DOUBLE SCALE

41201

