

B.M. BL 1595 ELEV. 1438.479
 C.S.B.M. Mon. Flush 60 Ft W of 35 Ft. N.E.
 Int. Sierra Hwy & Soledad Cyn. marked
 (B.M. 201-110-1361)
 NEWHALL QUAD. 19 65

UNDERGROUND STRUCTURES

All underground utilities or structures reported by the owner or others and those shown on the records examined are indicated with their approximate location and extent. The owner by accepting these plans or proceeding with improvements pursuant thereto agrees to assume liability and to hold the undersigned harmless for any damages resulting from the existence of the underground utilities or structures not reported to the undersigned, not indicated on the public records examined, local or at variance with that reported or shown on records examined.

The contractor is required to take due precautionary measures to protect the utilities or structures shown and any other utilities or structures found at the site. It shall be the contractor's responsibility to notify the owners of the utilities or structures concerned before starting work.

Berry S. Fischer
 Barry S. Fischer R.C.E. #13066

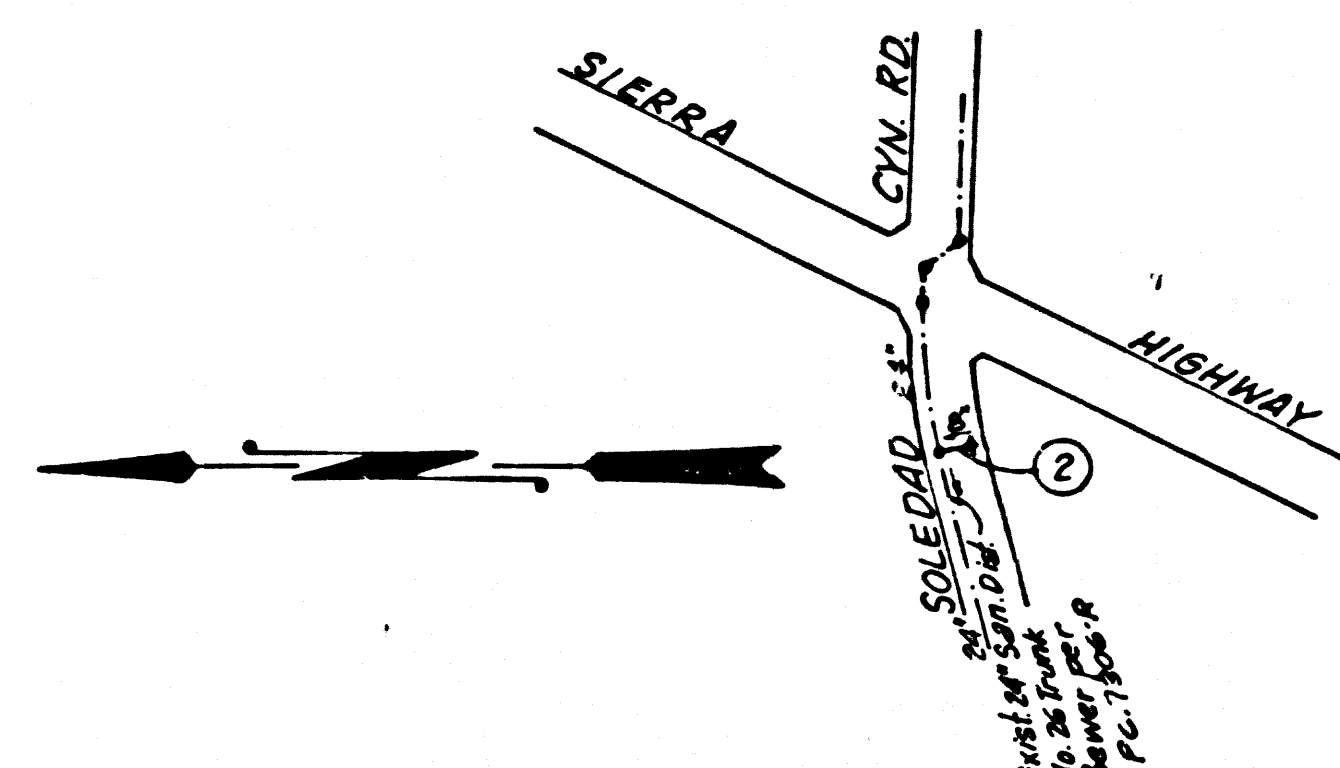

INDEX MAP
 1"=500'
 NUMBER IN CIRCLE INDICATES PAGE NUMBER.
 P.C. No. 8280

No connections for the disposal of industrial wastes shall be made to sewer shown on these drawings without written permission from the Chief Engineer and General Manager of the County Sanitation District.

COLLECT CHARGES AS INDICATED

**DOUBLE SCALE
 NEWHALL BLDG. DIST. NO. 82**

- NOTES:
- HOUSE LATERALS TO BE CONSTRUCTED WITH INVERTS AT PROPERTY LINE 4 FEET BELOW CURB GRADE
 - PROVIDE STAKES ON THE PROPERTY LINE OR PROPERTY LINES PRODUCED AT RIGHT ANGLES TO THE SEWER LINE AT THE CENTER LINE OF EACH MANHOLE.
 - NO REPRESENTATIVE OF THE COUNTY ENGINEER WILL SURVEY OR LAY OUT ANY PORTION OF THE WORK.
 - THE PRIVATE ENGINEER SHALL FURNISH THE COUNTY ENGINEER WITH GRADE SHEETS AND STATIONING FOR ALL HOUSE LATERALS AND "T" OR "T" BRANCHES AND SHALL PROVIDE STAKES FOR THEM AT THEIR PROPER LOCATIONS WITH STATIONING PLAINLY MARKED. ALL HOUSE LATERALS SHALL BE CONSTRUCTED IN A STRAIGHT ALIGNMENT AT RIGHT ANGLES FROM THE MAIN LINE SEWER EXCEPT AS SHOWN ON THE PLANS. HOUSE LATERALS FROM SHEDS SHALL BE CONSTRUCTED AT RIGHT ANGLES FROM THE MAIN LINE SEWER. ANY CHANGE IN ALIGNMENT SHALL BE REQUESTED IN WRITING BY THE PRIVATE ENGINEER.
 - THE PRIVATE ENGINEER SHALL FURNISH THE HOUSE LATERAL DEPTH AT THE PROPERTY LINE BELOW THE TOP OF CURB ELEVATION FOR EACH HOUSE LATERAL ON THE GRADE SHEET.
 - NO REVISIONS SHALL BE MADE IN THESE PLANS WITHOUT THE APPROVAL OF THE COUNTY ENGINEER.
 - THE CONTRACTOR SHALL NOTIFY THE CONSTRUCTION DIVISION BY TELEPHONE, MADISON 9-4747, EXT. 8158, AT LEAST TWENTY-FOUR HOURS BEFORE STARTING ANY WORK UNDER THIS CONTRACT.
 - ALL STRUCTURES SHALL BE EITHER BRICK MANHOLES PER S-3 OR PRECAST CONCRETE MANHOLES PER S-5 OR S-4, EXCEPT AS NOTED.
 - "T" BRANCH BRANCHES MAY BE USED FOR CONNECTIONS TO MAINLINE SEWERS EXCEPT AS NOTED.
 - MANHOLES SHALL BE 36" DIAMETER UNLESS OTHERWISE SHOWN OR NOTED OTHERWISE.
 - USE EXTRA STRENGTH PIPE ALL PIPE IS STANDARD DEPTH EXCEPT AS NOTED.
 - VITRIFIED CLAY PIPE JOINTS SHALL BE TYPE "B", "P", OR "C" PER STANDARD SPECIFICATIONS SECTION 308-2.
 - IF A POWER POLE IS WITHIN THREE FEET OF THE SEWER, THE SEWER SHALL BE ENCASED, PER S-23, TWO FEET ON EACH SIDE FROM THE POINT OF INTERFERENCE.
 - IF DURING THE COURSE OF CONSTRUCTION IT IS DETERMINED THAT THERE IS LESS THAN FOUR FEET OF COVER OVER THE TOP OF A MAIN LINE OF HOUSE LATERAL V.C.P. SEWER WHICH IS NOT INDICATED ON THE PLANS, THE PIPE SHALL BE ENCASED PER S-23, UNLESS OTHERWISE APPROVED BY THE COUNTY ENGINEER.
 - RESURFACE ALL TRENCHES WITHIN PAVED AREAS TO MEET L.A. COUNTY ROAD DEPT. OR CALIFORNIA STATE HIGHWAY REQUIREMENTS IN ACCORDANCE WITH PERMITS.
 - SEWERS TO BE TESTED FOR LEAKAGE PER SECTION 308-2.3.7 OF THE STANDARD SPECIFICATIONS.
 - REFER TO SECTION 7-16.1.1 OF THE STANDARD SPECIFICATIONS, REGARDING SAFETY ORDS.
 - ALL JOINTS BETWEEN CAST IRON PIPE AND VITRIFIED CLAY PIPE SHALL BE MADE WITH A RUBBER SLEEVE JOINT, TYPE "C" OR "D", WITHIN BUSHING IF NECESSARY PER STANDARD SPECIFICATIONS, SECTION 308-2.

THE FOLLOWING LATEST REVISED STANDARD PLANS ON FILE IN THE OFFICE OF THE COUNTY ENGINEER SHALL APPLY IN THE CONSTRUCTION OF THIS PROJECT.

MINIMUM PUBLIC SAFETY REQUIREMENTS	S-3
BRICK MANHOLE	S-4
NON-REINFORCED PRECAST CONCRETE MANHOLE	S-5
REINFORCED PRECAST CONCRETE MANHOLE	S-6
MANHOLE FRAME AND COVER	S-15
STANDARD MANHOLE STEP	S-17
HOODING FOR SEWER PIPE	S-21
CLADDING AND ENCASEMENT	S-23
WYE OR TEE SUPPORT	S-24
ALWAYS TRENCH WIDTH	S-25

County Sanitation Districts shall be notified prior to the following on that required inspection can be made (Phone 837-1022 - 666-8899)
 Breaking into existing manholes on District trunk sewer.
 Acceptance of the project.

PROFILE, ALIGNMENT AND GRADE OF
SANITARY SEWERS PAGE 1

SOLEDAD CANYON ROAD

PRIVATE CONTRACT NO. 8280

261-S-145
 1 SHEET OF 2 PAGES
 SCALE: VERT. 1"=8' APRIL, 1969
 HORIZ. 1"=80'
 PREPARED IN THE OFFICES OF
FISCHER ENGINEERING CO.
 16218 Ventura Blvd., Encino, Calif.
 783-7681
Berry S. Fischer
 REG. C. E. NO. 13066

41285

NOTE:
 GRADES TO WHICH THIS IMPROVEMENT IS TO BE CONSTRUCTED ARE SHOWN ON PLANS AND PROFILES. GRADE POINTS FOR TOP OF CURBS, CENTER LINE OF STREETS, OR CENTER LINE OF ALLEYS ARE SHOWN BY CIRCLES ON PROFILES AT ALL POINTS BETWEEN DESIGNATED POINTS. THE GRADE SHALL BE ESTABLISHED SO AS TO CONFORM TO A STRAIGHT LINE DRAWN BETWEEN SAID DESIGNATED POINTS. ELEVATIONS ARE IN FEET ABOVE U.S.C. & G.S. MEAN LEVEL DATUM OF 1929.
 REVISIONS ARE IN ACCORDANCE WITH THE STANDARD SPECIFICATIONS FOR PUBLIC WORKS CONSTRUCTION AND SPECIAL WORKS SHALL BE CONSTRUCTED ACCORDING TO THE STANDARD SPECIFICATIONS FOR PUBLIC WORKS CONSTRUCTION AND SPECIAL PROVISIONS FOR THE CONSTRUCTION OF SANITARY SEWERS DATED JAN. 2, 1965, AS REVISED, AND SHALL BE PROSECUTED ONLY IN THE PRESENCE OF THE COUNTY ENGINEER.
 BEFORE WORK CAN BE STARTED, THE CONTRACTOR MUST OBTAIN A PERMIT TO EXCAVATE IN COUNTY STREETS FROM THE L.A. COUNTY ROAD DEPT., DISTRICT OFFICE NO. 5, AND PAY A FEE TO THE COUNTY ENGINEER, ROOM 206, COUNTY ENGINEERING BUILDING, 126 WEST SECOND STREET OR, NEWHALL, DISTRICT OFFICE, SUPPLEMENT TO COVER THE COST OF CONSTRUCTION INSPECTION AND RECORD PLANS.
 APPROVAL OF THIS PLAN BY THE COUNTY OF LOS ANGELES DOES NOT CONSTITUTE A REPRESENTATION AS TO THE ACCURACY OF THE LOCATION OF OR THE EXISTENCE OR NON-EXISTENCE OF ANY UNDERGROUND UTILITY PIPE, OR STRUCTURE WITHIN THE LIMITS OF THIS PROJECT. THIS NOTE APPLIES TO ALL PAGES.
 IF WORK IS TO BE DONE IN A STATE HIGHWAY, A PERMIT MUST BE OBTAINED FROM THE STATE OF CALIFORNIA, DIVISION OF HIGHWAY, 130 SOUTH SPRING STREET, LOS ANGELES, CALIFORNIA.

COUNTY OF LOS ANGELES, CALIFORNIA
 JOHN A. LAMBIE, COUNTY ENGINEER J. D. PARKHURST, CHIEF ENGINEER
 CO. 54621E, NO. 59
 APPROVED BY *R. Williams* 5/1/69 APPROVED BY *J. D. Parkhurst*
 REGIONAL ENGINEER OFFICE ENGINEER
 CHECKED BY *Ralph Schafar* 5/1/69
 REG. C.E. NO. 13906

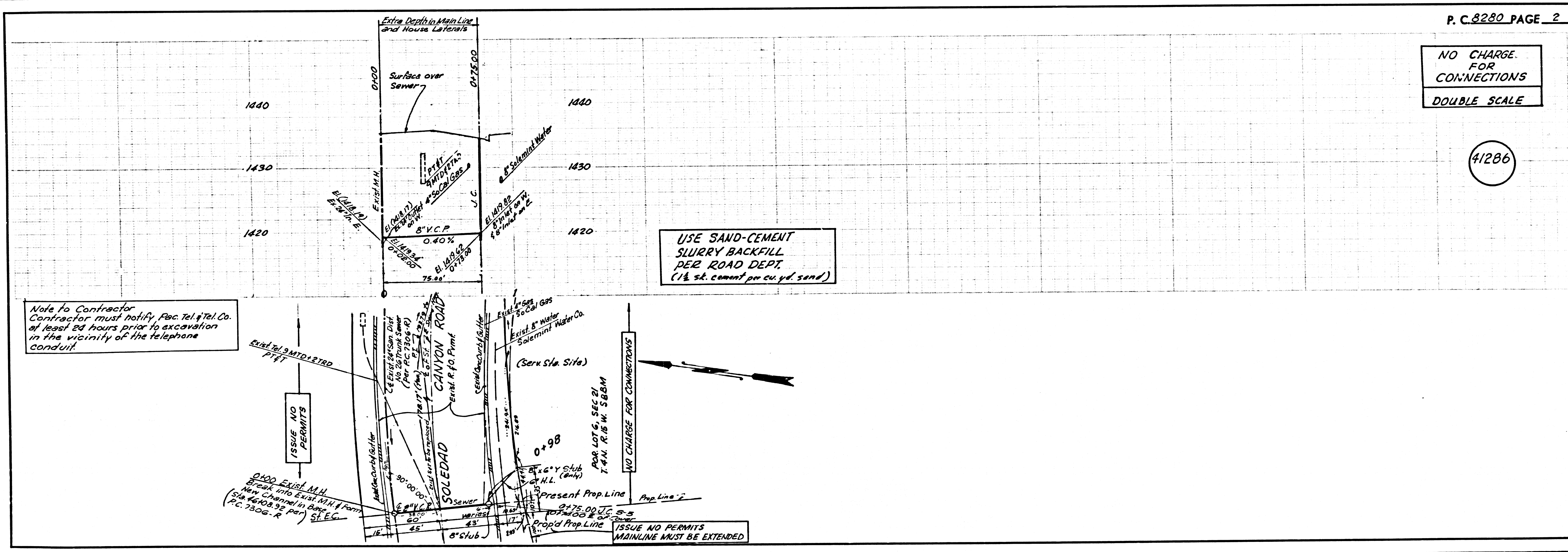

Note to Contractor
 Contractor must notify Pac. Tel. & Tel. Co. at least 24 hours prior to excavation in the vicinity of the telephone conduit.

USE SAND-CEMENT SLURRY BACKFILL PER ROAD DEPT. (1 1/2 st. cement per cu. yd. sand)

P. C. 8280 PAGE 2
NO CHARGE FOR CONNECTIONS
 DOUBLE SCALE

41286