

B.M. D.G. 2127 ELEV. 769.213
 P.O. B.M. Top W. Curb 2 Ft. S. B.C.P. SW corner
 Diamond Bar Blvd. and Golden Springs Dr.
 63 Ft. 3 and 42 Ft. W. of 4 Int.
 01/18/69 QUAD. 19 65

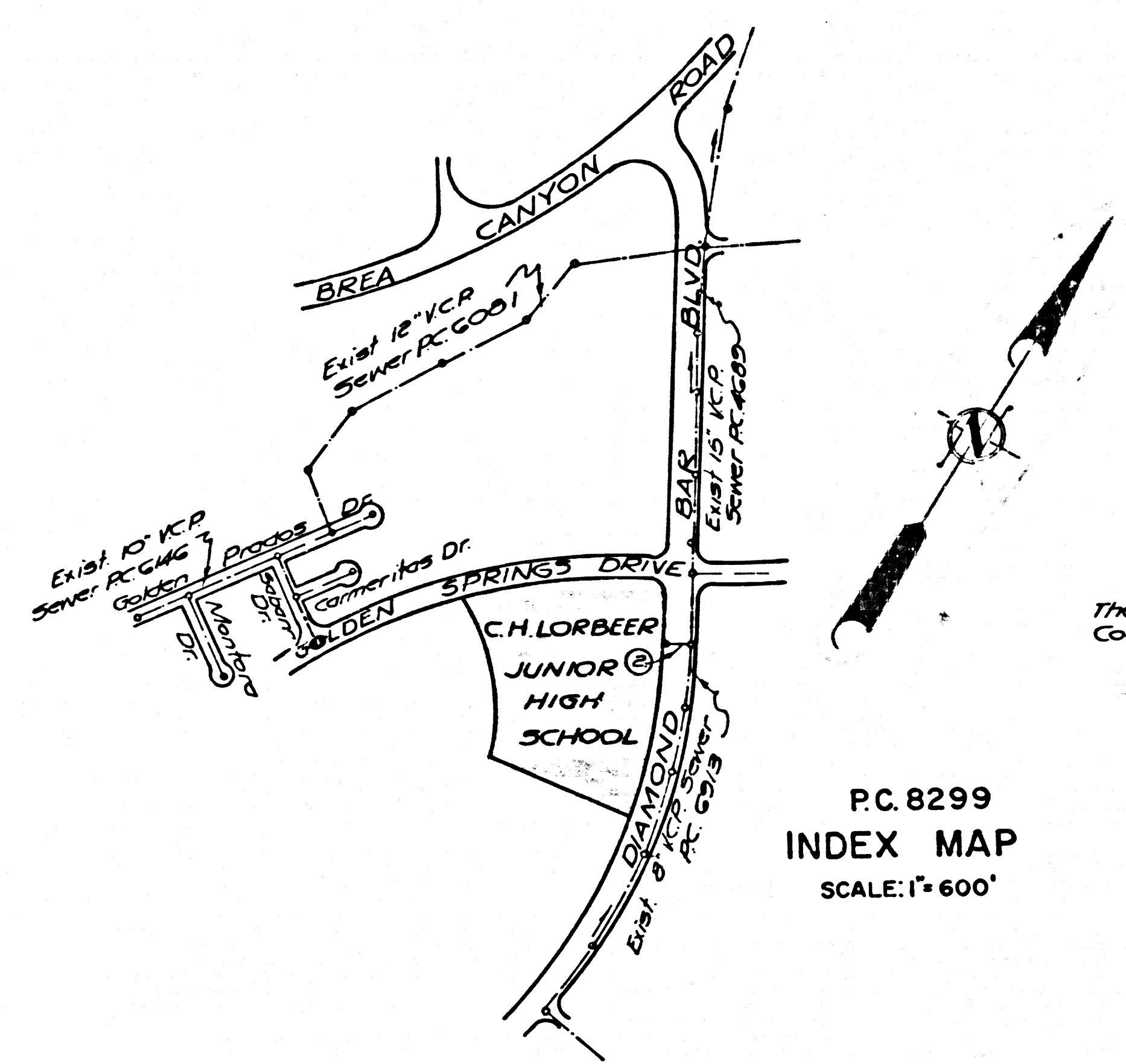

P.C. 8299
 INDEX MAP
 SCALE: 1" = 600'

The following latest revised Standard Plans on file in the office of the County Engineer shall apply in the construction of this project:

Legend	5-1
Minimum Public Safety Requirements	5-2
Brick Manhole	5-3
Non-reinforced precast concrete manhole	5-5
Reinforced precast concrete manhole	5-6
Manhole frame and cover	5-15
Standard manhole step	5-17
Bedding for sewer pipe	5-21
Cradling and encasement	5-23
Wye or Tee support	5-25
Allowable trench widths	5-33

No connections for the disposal of industrial wastes shall be made to sewers shown on these drawings without written permission from the Chief Engineer and General Manager of the County Sanitation Districts.

SAN DIMAS BLDG. DIST. NO. 10

- PROVIDE STAKES ON THE PROPERTY LINE OR PROPERTY LINES PRODUCED AT RIGHT ANGLES TO THE SEWER LINE AT THE CENTER LINE OF EACH MANHOLE.
- NO REPRESENTATIVE OF THE COUNTY ENGINEER WILL SURVEY OR LAY OUT ANY PORTION OF THE WORK.
- THE PRIVATE ENGINEER SHALL FURNISH THE COUNTY ENGINEER WITH GRAB SHEETS AND STATIONING FOR ALL HOUSE LATERALS AND "T" OR "Y" BRANCHES AND SHALL PROVIDE STAKES FOR THEM AT THEIR HOME LOCATIONS WITH STATIONING PLAINLY MARKED. ALL HOUSE LATERALS SHALL BE CONSTRUCTED IN A STRAIGHT ALIGNMENT AT RIGHT ANGLES FROM THE MAIN LINE SEWER EXCEPT AS SHOWN ON THE PLANS. HOUSE LATERALS FROM CHIMNEYS SHALL NOT HAVE AN ANGLE OF LESS THAN 45° WITH THE MAIN LINE SEWER. ANY CHANGE IN ALIGNMENT SHALL BE REQUESTED IN WRITING BY THE PRIVATE ENGINEER.
- THE PRIVATE ENGINEER SHALL FURNISH THE HOUSE LATERAL DEPTH AT THE PROPERTY LINE BELOW THE TOP OF CURB ELEVATION FOR EACH HOUSE LATERAL ON THE GRADE SHEET.
- NO REVISIONS SHALL BE MADE IN THESE PLANS WITHOUT THE APPROVAL OF THE COUNTY ENGINEER.
- THE CONTRACTOR SHALL NOTIFY THE CONSTRUCTION DIVISION BY TELEPHONE, MADISON 9-4747, EXT. 8138, AT LEAST TWENTY-FOUR HOURS BEFORE STARTING ANY WORK UNDER THIS CONTRACT.
- ALL STRUCTURES SHALL BE EITHER BRICK MANHOLES PER 5-3 OR PRECAST CONCRETE MANHOLES PER 5-5 OR 5-6, EXCEPT AS NOTED.
- Y or T branches may be used for connections to manhole sewers except as noted.
- MANHOLE TOPS IN UNIMPROVED RIGHTS-OF-WAY TO BE FINISHED WITH FINISHED GRADE.
- USE EXTRA STRENGTH PIPE. ALL PIPE IS STANDARD DEPTH EXCEPT AS NOTED.
- Verified clay pipe joints shall be type "D", "K" or "G" per Standard Specifications section 208-2.
- IF A POWER POLE IS WITHIN THREE FEET OF THE SEWER, THE SEWER SHALL BE ENCASED, PER 5-23, TWO FEET ON EACH SIDE FROM THE POINT OF INTERFERENCE.
- IF DURING THE COURSE OF CONSTRUCTION IT IS DETERMINED THAT THERE IS LESS THAN FOUR FEET OF COVER OVER THE TOP OF A MAIN LINE OR HOUSE LATERAL V.C.P. SEWER WHICH IS NOT INDICATED ON THE PLANS, THE PIPE SHALL BE ENCASED PER 5-23, UNLESS OTHERWISE APPROVED BY THE COUNTY ENGINEER.
- HOUSE LATERALS TO BE CONSTRUCTED WITH INVERTS AT PROPERTY LINE 4 FEET BELOW CURB GRADE EXCEPT AS NOTED.
- RESURFACE ALL TRENCHES WITHIN PAVED AREAS TO MEET I.A. COUNTY ROAD DEPT. OR CALIFORNIA STATE HIGHWAY REQUIREMENTS IN ACCORDANCE WITH PERMITS.
- SEWERS TO BE TESTED FOR LEAKAGE PER SECTION 206.3.2.2 UNIFORM STANDARD SPECIFICATIONS.
- Refer to section 7-0-4.1 of the Standard Specifications regarding safety orders.
- SPECIAL BACKFILL IN DESIGNATED AREAS:
 (a) BACKFILL TRENCH AND REFURGE OTHER EARTH REMOVED SO AS TO ACHIEVE THE NATURAL OR FINISHED GRADES AND SLOPES SHOWN ON THE GRADING PLAN APPROVED FOR THIS TRACT BY THE BUILDING AND SAFETY DIVISION.
 (b) ALL BACKFILL AND EARTH REPLACED SHALL BE COMPACTED TO A MINIMUM OF 90% OF MAXIMUM DENSITY PER A.S.T.M. STANDARD METHOD OF TEST D96-97 AS MODIFIED. ACCEPTABLE CERTIFICATION OF SUCH COMPACTION SHALL BE SUBMITTED TO THE CONSTRUCTION DIVISION.
- All joints between cast iron pipe and verified clay pipe shall be made with a rubber gasket joint type "S" or "D" with bedding as necessary per Standard Specifications, section 208-2.
- Contractor shall uncover existing waterlines and verify depths prior to constructing any sewer and shall immediately notify the Engineer of any discrepancy.

COLLECT CHARGES AS INDICATED

County Sanitation Districts shall be notified prior to the following so that required inspections can be made (Phone 827-1025 - 499-6000)

Acceptance of the project.

PROFILE ALIGNMENT AND GRADE OF
 SANITARY SEWERS P.C. 8299
 CONSTRUCTED IN
 DIAMOND BAR BOULEVARD

PRIVATE CONTRACT NO. 8299

W.S. 39-C3
 1 SHEET OF 2 PAGES
 SCALE: VERT. 1" = 4'
 HORIZ. 1" = 40'
 MAY 8, 1969
 PREPARED IN THE OFFICES OF
 ASSOCIATED ENGINEERS
 316 EAST E STREET, ONTARIO, CAL.
 91764
 R.E. Mills
 REG. C. E. NO. 1344

NOTE: GRADES TO WHICH THIS IMPROVEMENT IS TO BE CONSTRUCTED ARE SHOWN ON PLANS AND PROFILES. GRADE POINTS FOR TOP OF CURB, CENTER LINE OF STREET, OR CENTER LINE OF ALLEYS ARE SHOWN BY CIRCLES ON PROFILES. AT ALL POINTS BETWEEN DESIGNATED POINTS, THE GRADE SHALL BE ESTABLISHED TO A STRAIGHT LINE DRAWN BETWEEN SAID DESIGNATED POINTS. ELEVATIONS ARE IN FEET ABOVE U.S.C. & G.S. SEA LEVEL DATUM OF 1929.

WORK SHALL BE CONSTRUCTED ACCORDING TO THE STANDARD SPECIFICATIONS FOR PUBLIC WORKS CONSTRUCTION AND SPECIAL PROVISIONS for the construction of Sanitary Sewers Adopted Jan. 6, 1963, as revised and shall be interpreted only in the presence of the County Engineer. BEFORE WORK CAN BE STARTED, THE CONTRACTOR MUST OBTAIN A PERMIT TO EXCAVATE IN COUNTY STREETS FROM THE L.A. COUNTY AND PAY A FEE TO THE COUNTY ENGINEER, ROOM 330, COUNTY ENGINEERING BUILDING, 100 WEST SECOND STREET, ONTARIO, CALIF. 91764. REGIONAL OFFICE, SUFFICIENT TO COVER THE COST OF CONSTRUCTION INSPECTION AND RECORD PLANS.

APPROVAL OF THIS PLAN BY THE COUNTY OF LOS ANGELES DOES NOT CONSTITUTE A REPRESENTATION AS TO THE ACCURACY OF THE LOCATION OF OR THE EXISTENCE OR NON-EXISTENCE OF ANY UNDERGROUND UTILITY PIPE, OR STRUCTURE WITHIN THE LIMITS OF THIS PROJECT. THIS NOTE APPLIES TO ALL PAVED HIGHWAYS & AREAS MUST BE OBTAINED FROM THE STATE OF CALIFORNIA, DIVISION OF HIGHWAYS, 130 SOUTH SPRING STREET, LOS ANGELES, CALIFORNIA.

COUNTY OF LOS ANGELES, CALIFORNIA
 JOHN A. LAMBIE, COUNTY ENGINEER J. D. PARKHURST, CHIEF ENGINEER
 APPROVED BY: J.M.C. 7-2-69 APPROVED BY: J.D.P. 7-1-69
 ASST. Sanitation Division Engineer. CHIEF ENGINEER

CHECKED BY: J.M.C. 7-1-69
 REG. C. E. NO. 10223 Date

41484

P.C. 8299 PAGE 2
 NO CHARGE FOR CONNECTIONS

