

B.M. 21 608 ELEV. 1216.346  
 U.S.C. 665. Man. 5 and Bridge 53-14  
 over Placerita Creek 3/4 of S. and C.  
 10'E. of S. San Fernando Rd. 2 1/2 MI. N.  
 of Newhall Sta. 4514, (1937-1953)  
 NEWHALL QUAD. 19 65

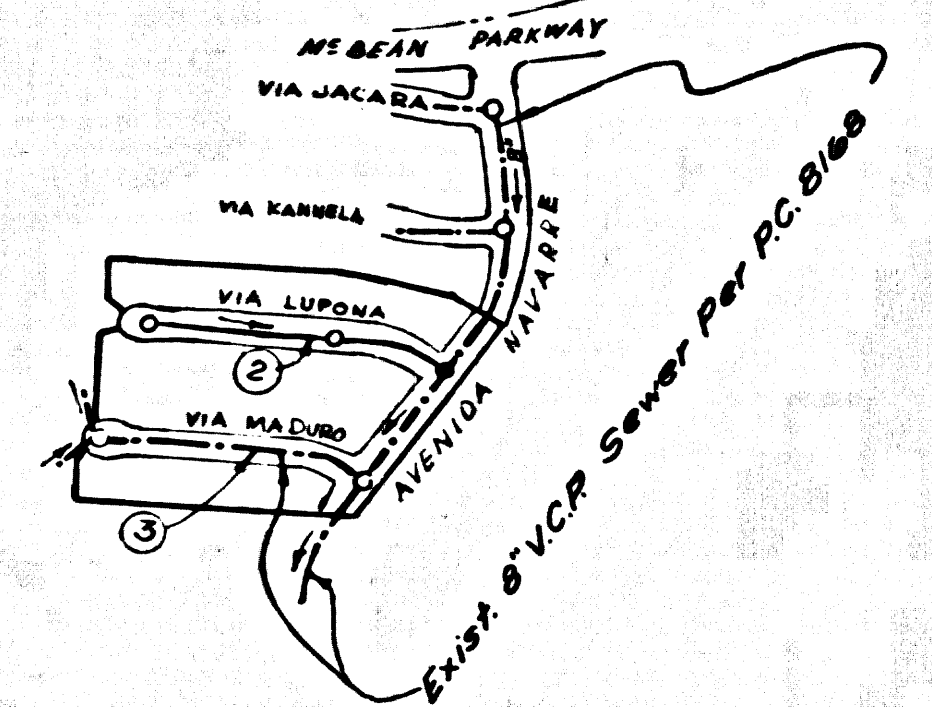
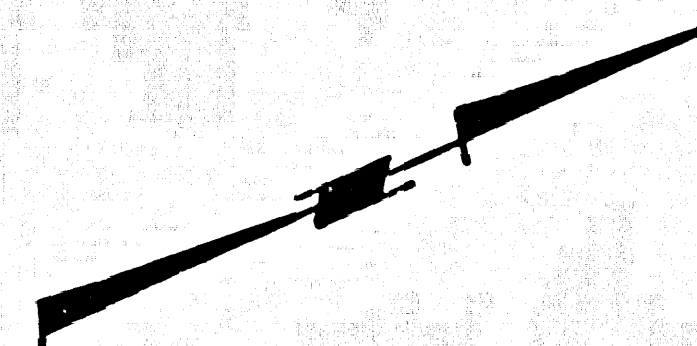

**INDEX MAP**  
 SCALE 1" = 500'  
 TRACT N° 30600  
 P.C. 8317

NOTE:  
 1. Numbers shown in circles indicate page number of plans.

**19. Special Backfill in Designated Areas:**  
 (a) Backfill trench and replace other earth removed so as to achieve the original or finished grades and slopes shown on the grading plan approved for this development by the Building and Safety Division.  
 (b) All backfill and earth replaced shall be compacted to a minimum of 90% of maximum density per ASTM Standard Method of Test D 698-57 T as modified acceptance certification of such compaction shall be submitted to the Construction Division.

**NOTICE TO CONTRACTOR**  
 The existence and location of any underground pipes, or structures shown on these plans were obtained by a search of available records to the best of our knowledge there are no existing utilities except as shown on these plans.  
 The Contractor is required to take precautionary measures to protect the existing utility lines and lay lines not shown on these plans.

No exemption for the disposal of industrial waste shall be used to sewers shown on these drawings without written permission from the Chief Engineer and General Manager of the County Sanitation Districts.

County Sanitation Districts shall be notified prior to the following so that required inspection can be made (Phone 287-1025 - 688-1161)

Acceptance of the project.

COLLECT CHARGES AS INDICATED

**NEWHALL BLDG. DIST. NO. 8.2**

- NOTES:
- HOUSE LATERALS TO BE CONSTRUCTED WITH INVERTS AT PROPERTY LINE 4 FEET BELOW CURB GRADE
  - PROVIDE STAKES ON THE PROPERTY LINE OR PROPERTY LINES PRODUCED AT RIGHT ANGLES TO THE SEWER LINE AT THE CENTER LINE OF EACH MANHOLE.
  - NO REPRESENTATIVE OF THE COUNTY ENGINEER WILL SURVEY ON LAY OUT ANY PORTION OF THE WORK.
  - THE PRIVATE ENGINEER SHALL FURNISH THE COUNTY ENGINEER WITH GRADE SHEETS AND STATIONING FOR ALL HOUSE LATERALS AND "T" OR "T" BRANCHES AND SHALL PROVIDE STAKES FOR THEM AT THEIR PROPER LOCATIONS WITH STATIONING PLAINLY MARKED. ALL HOUSE LATERALS SHALL BE CONSTRUCTED IN A STRAIGHT ALIGNMENT AT RIGHT ANGLES FROM THE MAIN LINE SEWER EXCEPT AS SHOWN ON THE PLANS. HOUSE LATERALS FROM CHIMNEYS SHALL NOT HAVE AN ANGLE OF LESS THAN 45° WITH THE MAIN LINE SEWER. ANY CHANGE IN ALIGNMENT SHALL BE REQUESTED IN WRITING BY THE PRIVATE ENGINEER.
  - THE PRIVATE ENGINEER SHALL FURNISH THE HOUSE LATERAL DEPTH AT THE PROPERTY LINE BELOW THE TOP OF CURB ELEVATION FOR EACH HOUSE LATERAL ON THE GRADE SHEET.
  - NO REVISIONS SHALL BE MADE IN THESE PLANS WITHOUT THE APPROVAL OF THE COUNTY ENGINEER.
  - THE CONTRACTOR SHALL NOTIFY THE CONSTRUCTION DIVISION BY TELEPHONE, MADISON 9-4740, EXT. 8155, AT LEAST TWENTY-FOUR HOURS BEFORE STARTING ANY WORK UNDER THIS CONTRACT.
  - ALL STRUCTURES SHALL BE EITHER BRICK MANHOLES PER S-2 OR PRECAST CONCRETE MANHOLES PER S-56 ..., EXCEPT AS NOTED.
  - "T" OR "T" BRANCHES MAY BE USED FOR CONNECTIONS TO MAINLINE SEWERS EXCEPT AS NOTED.
  - USE BEST STRENGTH PIPE, ALL PIPE IS STANDARD DITCH
  - WITHEDED CLAY PIPE JOINTS SHALL BE TYPE "B", "C", OR "D" PER STANDARD SPECIFICATIONS SECTION 308.2
  - IF A POWER POLE IS WITHIN THREE FEET OF THE SEWER, THE SEWER SHALL BE ENCASED, PER S-28, TWO FEET ON EACH SIDE FROM THE POINT OF INTERFERENCE.
  - IF DURING THE COURSE OF CONSTRUCTION IT IS DETERMINED THAT THERE IS LESS THAN FOUR FEET OF COVER OVER THE TOP OF A MAIN LINE OR HOUSE LATERAL V.C.P. SEWER WHICH IS NOT INDICATED ON THE PLANS, THE PIPE SHALL BE ENCASED PER S-28, UNLESS OTHERWISE APPROVED BY THE COUNTY ENGINEER.
  - RESURFACE ALL TRENCHES WITHIN PAVED AREAS TO MEET L.A. COUNTY ROAD DEPT. OR CALIFORNIA STATE HIGHWAY REQUIREMENTS IN ACCORDANCE WITH PERMITS.
  - SEWERS TO BE TESTED FOR LEAKAGE PER SECTION 306.3.7.7 OF THE STANDARD SPECIFICATIONS.
  - REFER TO SECTION 7.14.1.1 OF THE STANDARD SPECIFICATIONS, REGARDING SAFETY ORDERS.
  - ALL JOINTS BETWEEN CAST IRON PIPE AND WITHEDED CLAY PIPE SHALL BE MADE WITH A RUBBER SLEEVE JOINT, TYPE "C" OR "D", WITH BUSHING IF NECESSARY PER STANDARD SPECIFICATIONS, SECTION 308.2.

THE FOLLOWING LATEST REVISED STANDARD PLANS ON FILE IN THE OFFICE OF THE COUNTY ENGINEER SHALL APPLY IN THE CONSTRUCTION OF THIS PROJECT.

LEGEND	S-1
MINIMUM PUBLIC SAFETY REQUIREMENTS	S-2
BRICK MANHOLE	S-3
NON-REINFORCED PRECAST CONCRETE MANHOLE	S-56
REQUIREMENTS OF BRICK AND PIPE	S-57
MANHOLE FRAME AND COVER	S-58
STANDARD MANHOLE STEP	S-59
SEWING FOR SEWER PIPE	S-60
ENCASING AND ENCASEMENT	S-28
PIPE OR THE SUPPORT	S-29
ALLOWABLE TRENCH WIDTH	S-30
SADDLES	S-31

PROFILE, ALIGNMENT AND GRADE OF  
**SANITARY SEWERS** P.C. 8317  
 TO BE CONSTRUCTED IN PAGE 1  
**TRACT N° 30600**

PRIVATE CONTRACT NO. 8317  
 255-S-121  
 W.S. 62  
 2 SHEETS; 3 PAGES

SCALE: HORIZ. 1" = 40'  
 VERT. 1" = 4'  
 PREPARED IN THE OFFICES OF  
 SIKHRI ENGINEERING ASSOCIATES, INC.  
 18208 BURBANK BOULEVARD  
 VAN NUYS, CALIFORNIA 91411  
 REG. C. E. NO. 9553

NOTE:  
 GRADES TO WHICH THIS IMPROVEMENT IS TO BE CONSTRUCTED ARE SHOWN ON PLANS AND PROFILES. GRADE POINTS FOR TOP OF CURB, CENTER LINE OF STREETS, OR CENTER LINE OF ALLEYS ARE SHOWN BY CIRCLES ON PROFILES. AT ALL POINTS BETWEEN DESIGNATED POINTS THE GRADE SHALL BE ESTABLISHED SO AS TO CONFORM TO A STRAIGHT LINE DRAWN BETWEEN SAID DESIGNATED POINTS. ELEVATIONS ARE IN FEET ABOVE U.S.C. & G.S. MEAN LEVEL DATUM OF 1929.  
 WORK SHALL BE CONSTRUCTED ACCORDING TO THE STANDARD SPECIFICATIONS FOR PUBLIC WORKS CONSTRUCTION (1978 EDITION) PROVISIONS FOR THE CONSTRUCTION OF SANITARY SEWERS DATED APRIL 7, 1978 AND SHALL BE PROSECUTED ONLY IN THE PRESENCE OF THE COUNTY ENGINEER.  
 APPROVAL OF THIS PLAN BY THE COUNTY OF LOS ANGELES DOES NOT CONSTITUTE A REPRESENTATION AS TO THE ACCURACY OF THE LOCATION OF OR THE EXISTENCE OR NON-EXISTENCE OF ANY UNDERGROUND UTILITY PIPE, OR STRUCTURE WITHIN THE LIMITS OF THIS PROJECT. THIS NOTE APPLIES TO ALL PAGES.  
 IF WORK IS TO BE DONE IN A STATE HIGHWAY, A PERMIT MUST BE OBTAINED FROM THE STATE OF CALIFORNIA, DIVISION OF HIGHWAYS, 120 SOUTH SPRING STREET, LOS ANGELES, CALIFORNIA.

COUNTY OF LOS ANGELES, CALIFORNIA  
 JOHN A. LAMBE, COUNTY ENGINEER J. D. PARKHURST, CHIEF ENGINEER  
 CO. SAN. DIST. NO. 8.2  
 APPROVED BY: [Signature] 11-5-70 APPROVED BY: [Signature]  
 REGIONAL ENGINEER DATE OFFICE ENGINEER

CHECKED BY: [Signature] 11-6-70  
 REGIONAL ENGINEER DATE  
 REG. C.E. NO. 14390

42555

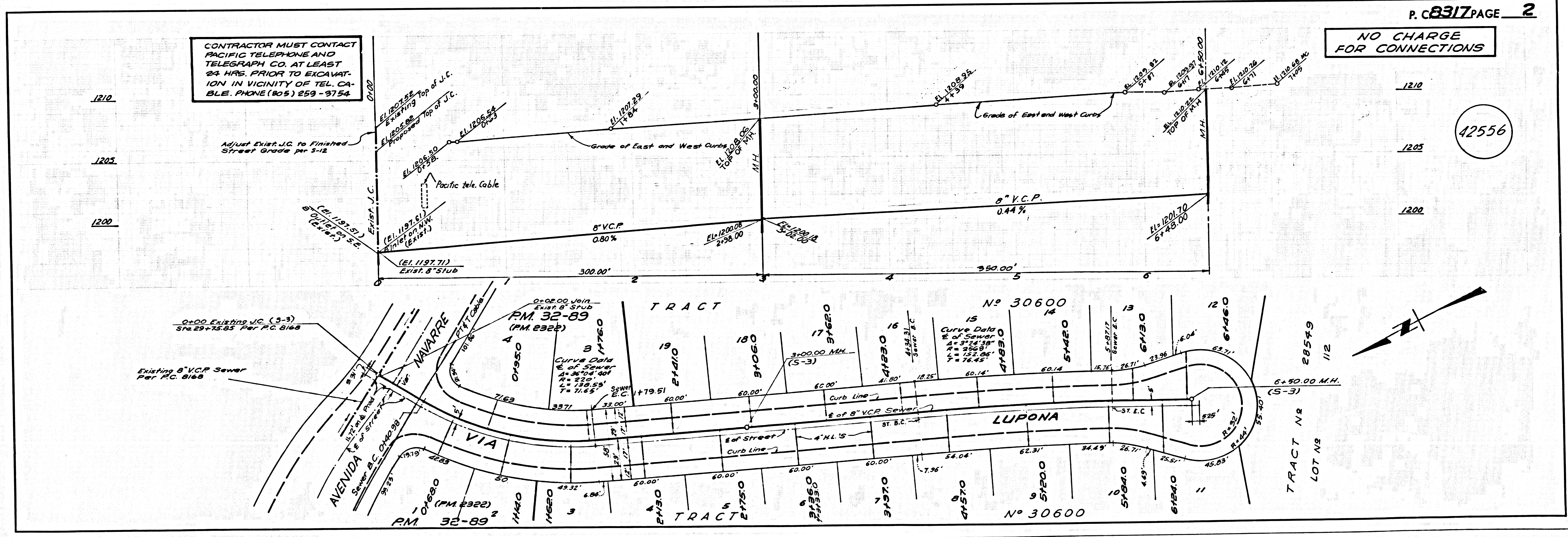

CONTRACTOR MUST CONTACT PACIFIC TELEPHONE AND TELEGRAPH CO. AT LEAST 24 HRS. PRIOR TO EXCAVATION IN VICINITY OF TEL. CABLE. PHONE (805) 259-3754

NO CHARGE FOR CONNECTIONS

42556



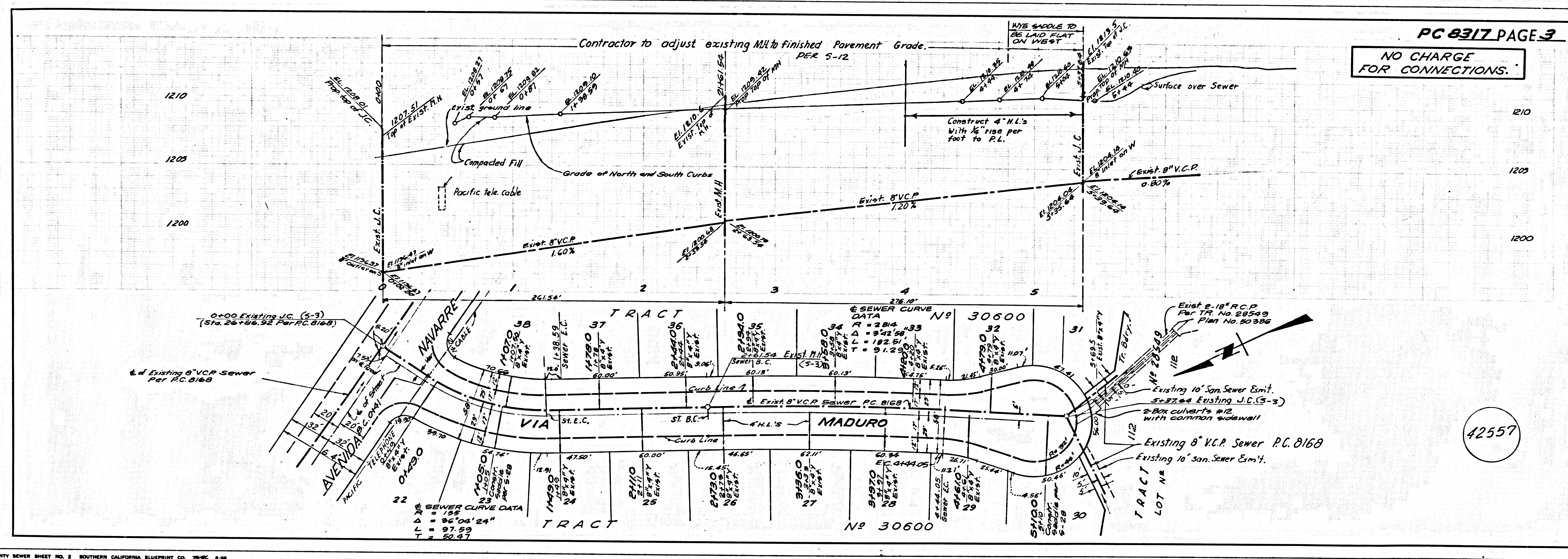

PC 8317 PAGE 3  
 NO CHARGE  
 FOR CONNECTIONS.

42557

L.A. COUNTY SEWER SHEET NO. 2 SOUTHERN CALIFORNIA BLUEPRINT CO. 8/48

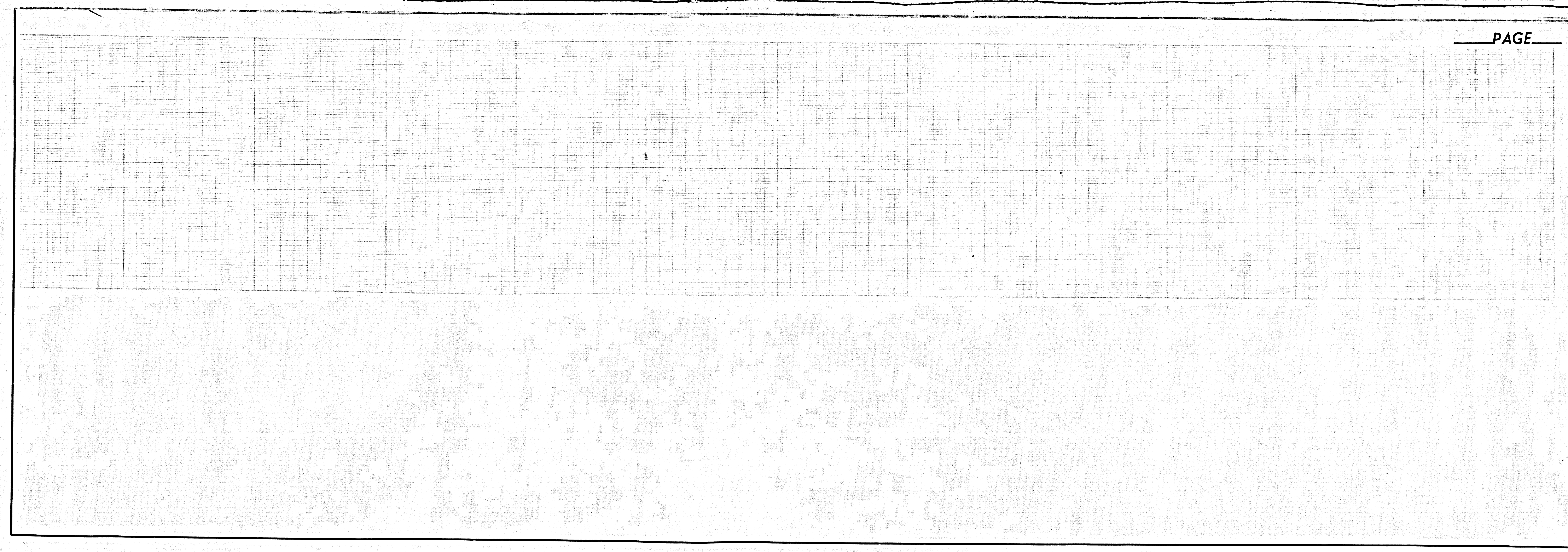

PAGE