

B.M. BY 7434 ELEV. 145.721  
 L.C.B.M. W. Co. 1<sup>st</sup> N. S. BCR @  
 S.W. cor. Millersgrove Dr. & La  
 Nietos Rd. 55 ft. S. & 18 ft. W. of  
 1/4 mt. RIVERA QUAD. 1905

THE FOLLOWING LATEST REVISED STANDARD PLANS ON FILE IN THE OFFICE OF THE COUNTY ENGINEER SHALL APPLY IN THE CONSTRUCTION OF THIS PROJECT:

LEADERS	5-1
MINIMUM PIPE SLOPE REQUIREMENTS	5-2
BRICK MANHOLE	5-3
MAN-REINFORCED PRECAST CONCRETE MANHOLE	5-4
REINFORCED PRECAST CONCRETE MANHOLE	5-5
MANHOLE FRAME AND COVER	5-15
STANDARD MANHOLE STEP	5-17
ROUNDING FOR SEWER PIPE	5-21
CRADLING AND ENCASUREMENT	5-23
PIPE ON THE SURFACE	5-25
ALLOWABLE TRENCH WIDTHS	5-27

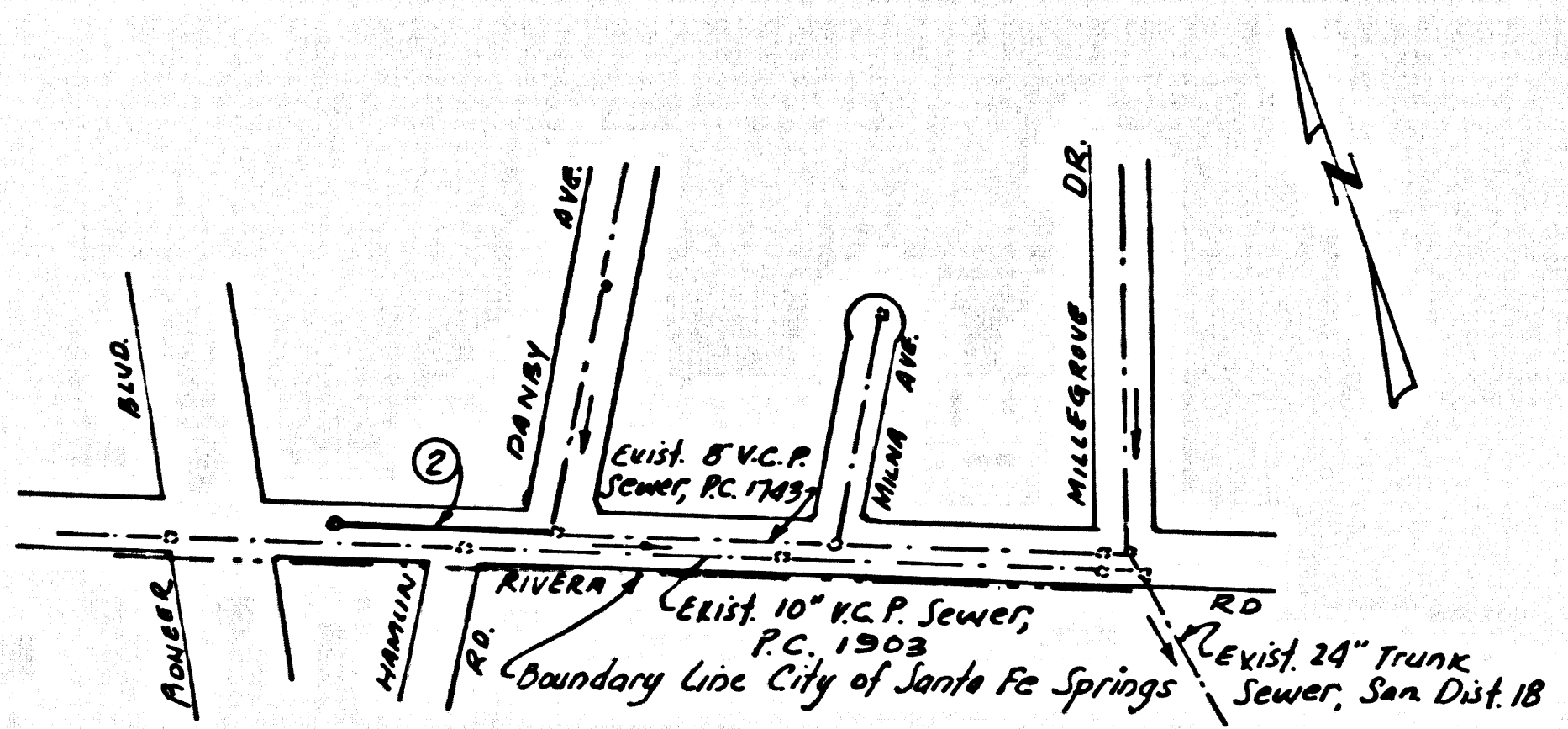

Note: Number in circle indicates page number

INDEX MAP  
 RIVERA ROAD P.C. 8323  
 SCALE: 1"=200'

County Sanitation Districts shall be notified prior to the following so that required inspection can be made (Phone 877-1200 - 440-8877)

acceptance of the project.

No connections for the disposal of industrial wastes shall be made to sewers shown on these drawings without written permission from the Chief Engineer and General Manager of the County Sanitation District.

WHITTIER BLDG. DIST. NO. 11.0

- NOTE:
- PROVIDE STAKES ON THE PROPERTY LINE OR PROPERTY LINES PRODUCED AT RIGHT ANGLES TO THE SEWER LINE AT THE CENTER LINE OF EACH MANHOLE.
  - NO REPRESENTATIVE OF THE COUNTY ENGINEER WILL SURVEY OR LAY OUT ANY PORTION OF THE WORK.
  - THE PRIVATE ENGINEER SHALL FURNISH THE COUNTY ENGINEER WITH GRADE SHEETS AND STATIONING FOR ALL HOUSE LATERALS AND "T" BRANCHES AND SHALL PROVIDE STAKES FOR THEM AT THEIR PROPER LOCATIONS WITH STATIONING PLAINLY MARKED. ALL HOUSE LATERALS SHALL BE CONSTRUCTED IN A STRAIGHT ALIGNMENT AT RIGHT ANGLES FROM THE MAIN LINE SEWER EXCEPT AS SHOWN ON THE PLANS. HOUSE LATERALS FROM CHIMNEYS SHALL NOT HAVE AN ANGLE OF LESS THAN 45° WITH THE MAIN LINE SEWER. ANY CHANGE IN ALIGNMENT SHALL BE REQUESTED BY THE PRIVATE ENGINEER.
  - THE PRIVATE ENGINEER SHALL FURNISH THE HOUSE LATERAL DEPTH AT THE PROPERTY LINE BELOW THE TOP OF CURB ELEVATION FOR EACH HOUSE LATERAL ON THE GRADE SHEET.
  - NO REVISIONS SHALL BE MADE IN THESE PLANS WITHOUT THE APPROVAL OF THE COUNTY ENGINEER.
  - THE CONTRACTOR SHALL NOTIFY THE CONSTRUCTION DIVISION BY TELEPHONE, MADISON 9-07, EXT. 8151, AT LEAST TWENTY-FOUR HOURS BEFORE STARTING ANY WORK UNDER THIS CONTRACT.
  - ALL STRUCTURES SHALL BE SET BY BRICK MANHOLES PER 5-3 OR PRECAST CONCRETE MANHOLES PER 5-4 OR 5-5.
  - USE STANDARD MANHOLE FRAMES AND COVERS, 5-15.
  - USE EXTRA STRENGTH PIPE. ALL PIPE IS STANDARD DEPTH EXCEPT AS NOTED.
  - U.C.P. JOINTS SHALL BE TYPE 6, 7, OR 8, PER STD. SPECS. S.E.C. 205-2.
  - IF A POWER POLE IS WITHIN THREE FEET OF THE SEWER, THE SEWER SHALL BE ENCASED, PER 5-23, TWO FEET ON EACH SIDE FROM THE POINT OF INTERFERENCE.
  - IF DURING THE COURSE OF CONSTRUCTION IT IS DETERMINED THAT THERE IS LESS THAN FOUR FEET OF COVER OVER THE TOP OF A MAIN LINE OR HOUSE LATERAL V.C.P. SEWER WHICH IS NOT INDICATED ON THE PLANS, THE PIPE SHALL BE ENCASED PER 5-23, UNLESS OTHERWISE APPROVED BY THE COUNTY ENGINEER.
  - HOUSE LATERALS TO BE CONSTRUCTED WITH INVERTS AT 1/2" PER FOOT SLIDE TO PROPERTY LINE.
  - RESURFACE ALL TRENCHES WITHIN PAVED AREAS TO MEET L.A. COUNTY ROAD DEPT. OR CALIFORNIA STATE HIGHWAY REQUIREMENTS IN ACCORDANCE WITH PERMITS.
  - SEWERS TO BE TESTED PER LANGUAGE PER SECTION 204-2.3.7 UNIFORM STANDARD SPECIFICATIONS.
  - REFER TO SECTION 7-10-41 OF THE STANDARD SPECIFICATIONS, REGARDING SAFETY ORDERS.
  - SPECIAL BACKFILL IN DESIGNATED AREAS:
    - BACKFILL TRENCH AND REPLACE OTHER EARTH BENEATH SO AS TO ACHIEVE THE ORIGINAL OR FINISHED GRADES AND SLAPES SHOWN ON THE GRADE SHEET APPROVED FOR THIS TRACT BY THE BUILDING & SAFETY DIVISION.
    - ALL BACKFILL AND EARTH REPLACED SHALL BE COMPACTED TO A MINIMUM OF 90% OF MAXIMUM DENSITY PER A.S.T.M. STANDARD METHOD OF TEST D-1557-57T AS MODIFIED. A COMPACTED CERTIFICATION OF SUCH COMPACTION SHALL BE SUBMITTED TO THE CONSTRUCTION DIVISION.

PROFILE, ALIGNMENT AND GRADE OF P.C. 8323  
 SANITARY SEWERS PAGE 1

TO BE CONSTRUCTED IN  
 PARCEL MAP NO 851 & 1269  
 RIVERA ROAD

PRIVATE CONTRACT NO. 8323

W.S. 36  
 1 SHEET, 2 PAGES  
 SCALE: HORIZ. 1"=40' VERT. 1"=4'  
 JUNE, 1969  
 PREPARED IN THE OFFICES OF  
 OLSON SURVEYING SERVICE INC.  
 BY Ronald W. Bishop 6-30-69  
 REG. C.E. NO. 15510

FOR LEGEND SEE PLAN NO. 5-1

NOTE:  
 GRADES TO WHICH THE IMPROVEMENT IS TO BE CONSTRUCTED ARE SHOWN ON PLANS AND PROFILES. GRADE POINTS FOR TOP OF CURBS, CENTER LINE OF STREETS, OR CENTER LINE OF ALLEYS ARE SHOWN BY CIRCLES ON PROFILES. AT ALL POINTS BETWEEN DESIGNATED POINTS THE GRADE SHALL BE ESTABLISHED SO AS TO CONFORM TO A STRAIGHT LINE DRAWN BETWEEN SAID DESIGNATED POINTS. ELEVATIONS ARE IN FEET ABOVE U.S.C. & G.S. SEA LEVEL DATUM OF 1929.

WORK SHALL BE CONSTRUCTED ACCORDING TO STANDARD SPECIFICATIONS FOR PUBLIC UTILITIES (EIGHT EDITION SPECIAL INTERPRETATION) AS REVISED AND SHALL BE PROSECUTED ONLY IN THE PRESENCE OF THE COUNTY ENGINEER.

BEFORE WORK CAN BE STARTED, THE CONTRACTOR MUST OBTAIN A PERMIT TO EXCAVATE IN COUNTY STREETS FROM THE L.A. COUNTY ROAD DEPT., DISTRICT OFFICE NO. 1, 05, AND PAY A FEE TO THE COUNTY ENGINEER, ROOM 385, COUNTY ENGINEERING BUILDING, 100 WEST SECOND STREET, LOS ANGELES, CALIFORNIA. REGIONAL OFFICE, SUBMITTANT TO COVER THE COST OF CONSTRUCTION INSPECTION AND RECORD PLANS.

APPROVAL OF THIS PLAN BY THE COUNTY OF LOS ANGELES DOES NOT CONSTITUTE A REPRESENTATION AS TO THE ACCURACY OF THE LOCATION OF OR THE EXISTENCE OR NON-EXISTENCE OF ANY UNDERGROUND UTILITY PIPE, OR STRUCTURE WITHIN THE LIMITS OF THIS PROJECT. THIS NOTE APPLIES TO ALL PAGES.

IF WORK IS TO BE DONE IN A STATE HIGHWAY, A PERMIT MUST BE OBTAINED FROM THE STATE OF CALIFORNIA, DIVISION OF HIGHWAYS, 128 SOUTH SPRING STREET, LOS ANGELES, CALIFORNIA.

COUNTY OF LOS ANGELES, CALIFORNIA  
 JOHN A. LAMBIE, COUNTY ENGINEER J. D. PARKHURST, CHIEF ENGINEER  
 CO. SAN. DIST. NO. 12  
 APPROVED BY [Signature] APPROVED BY [Signature]  
 AS COUNTY ENGINEER AS CHIEF ENGINEER

CHECKED BY: [Signature] 7/10/69  
 REG. C.E. NO. 15931

J.N. 0250.05

COLLECT CHARGES  
 AS INDICATED

NOTICE TO CONTRACTOR  
 The existence and location of any underground utility pipes or structures shown on these plans are obtained by a search of the available records. To the best of my knowledge there are no existing utilities except as shown on these plans. The contractor is required to take due precautionary measures to protect the utility lines shown and any other lines not shown on these plans.  
 Ronald W. Bishop  
 6-30-69  
 REG. C.E. NO. 15510

P.C. 8323 PAGE 2

NO CHARGE FOR CONNECTIONS

41391

