

B.M. B.L. No 63 ELEV. 2397.770  
 L. & T. NR. M.G.R. @ S.W. COR. 10<sup>TH</sup> ST.  
 EAST & AVENUE "J" 48 feet WEST  
 & 45 feet SOUTH of & INTERSECTION  
 LANCASTER QUAD. 19 65

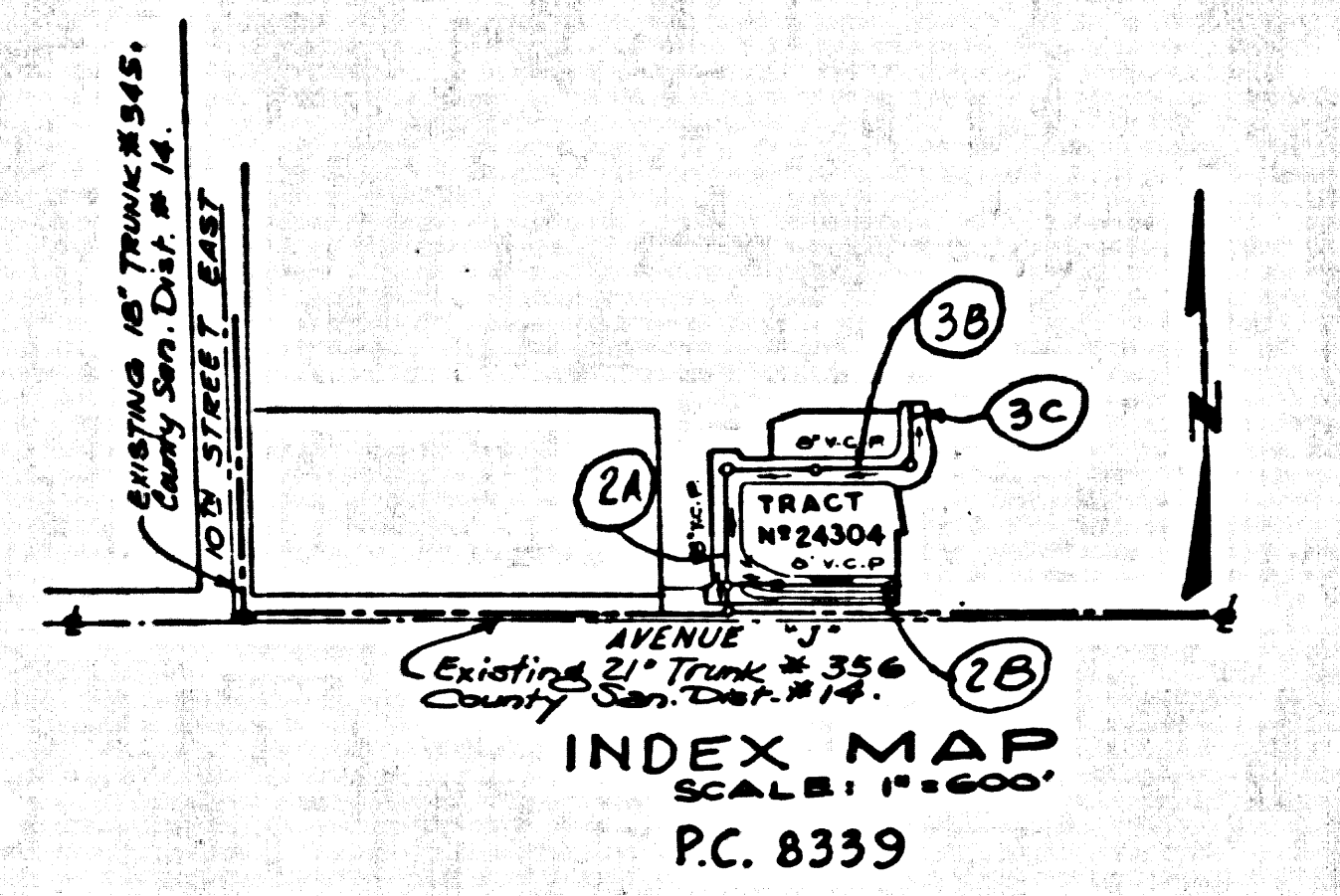

No connections for the disposal of industrial wastes shall be made to sewers shown on these drawings without written permission from the Chief Engineer and General Manager of the County Sanitation Districts.

County Sanitation Districts shall be notified prior to the following so that required inspection can be made (Phone 857-1023 - 0882307)

Commencement of construction of manhole on District trunk sewer.

Breaking into existing manhole on District trunk sewer.

Acceptance of the project.

### LANCASTER BLDG. DIST. NO. 8

- NOTES:
- PROVIDE STAKES ON THE PROPERTY LINE OR PROPERTY LINES PRODUCED AT RIGHT ANGLES TO THE SEWER LINE AT THE CENTER LINE OF EACH MANHOLE.
  - NO REPRESENTATIVE OF THE COUNTY ENGINEER WILL SURVEY OR LAY OUT ANY PORTION OF THE WORK.
  - THE PRIVATE ENGINEER SHALL FURNISH THE COUNTY ENGINEER WITH GRADE SHEETS AND STATIONING FOR ALL HOUSE LATERALS AND 18" V.C.P. SEWERS. THE PRIVATE ENGINEER SHALL PROVIDE STAKES FOR THEM AT THEIR PROPOSED LOCATIONS WITH STATIONING PLAINLY MARKED. ALL HOUSE LATERALS SHALL BE CONSTRUCTED IN A STRAIGHT ALIGNMENT AT RIGHT ANGLES FROM THE MAIN LINE SEWER EXCEPT AS SHOWN ON THE PLANS. HOUSE LATERALS FROM CHIMNEYS SHALL NOT HAVE AN ANGLE OF LESS THAN 45° WITH THE MAIN LINE SEWER. ANY CHANGE IN ALIGNMENT SHALL BE REQUESTED BY WRITING BY THE PRIVATE ENGINEER.
  - THE PRIVATE ENGINEER SHALL FURNISH THE HOUSE LATERAL DEPTH AT THE PROPERTY LINE BELOW THE TOP OF CURB ELEVATION FOR EACH HOUSE LATERAL ON THE GRADE SHEET.
  - NO REVISIONS SHALL BE MADE IN THESE PLANS WITHOUT THE APPROVAL OF THE COUNTY ENGINEER.
  - THE CONTRACTOR SHALL NOTIFY THE CONSTRUCTION DIVISION BY TELEPHONE, MANHOLE 5-9-67, EXT. 81581, AT LEAST TWENTY-FOUR HOURS BEFORE STARTING ANY WORK UNDER THIS CONTRACT.
  - MANHOLES SHALL BE BRICK SEWER STRUCTURES PER S-3. PRECAST CONCRETE MANHOLES PER S-4 OR S-4 MAY BE USED AS AN ALTERNATE TO LOCATIONS APPROVED BY THE COUNTY ENGINEER.
  - USE STANDARD MANHOLE FRAMES AND COVERS, S-16, EXCEPT AS NOTED.
  - MANHOLE HOLES IN UNIMPROVED HIGHWAYS OR WAYS TO BE SET SIX INCHES ABOVE FINISHED GRADE.
  - USE EXTRA STRENGTH PIPE. ALL PIPE IS STANDARD DEPTH EXCEPT AS NOTED.
  - USE ANTI-CORROSION JOINTS FOR ALL V.C.P. JOINTS PER SPECS. SECS. 56, 48 & 49.
  - IF A POWER POLE IS WITHIN THREE FEET OF THE SEWER, THE SEWER SHALL BE ENCASED, PER S-25, TWO FEET ON EACH SIDE FROM THE POINT OF INTERFERENCE.
  - IF DURING THE COURSE OF CONSTRUCTION IT IS DETERMINED THAT THERE IS LESS THAN FOUR FEET OF COVER OVER THE TOP OF A MAIN LINE OR HOUSE LATERAL V.C.P. SEWER WHICH IS NOT INDICATED ON THE PLANS, THE PIPE SHALL BE ENCASED PER S-25, UNLESS OTHERWISE APPROVED BY THE COUNTY ENGINEER.
  - HOUSE LATERALS TO BE CONSTRUCTED WITH INVERTS AT PROPERTY LINE & SET BELOW CURB GRADE EXCEPT AS NOTED.
  - REQUIRE ALL TRENCHES WITHIN PAVED AREAS TO MEET L.A. COUNTY ROAD DEPT. OR CALIFORNIA STATE HIGHWAY REQUIREMENTS IN ACCORDANCE WITH PERMITS.
  - ALL TRENCHES SHALL BE PROTECTED BY SAFETY ORBES WHICH BE STRICTLY ENFORCED.
  - THE FOLLOWING LATEST REVISED STANDARD PLANS ARE FILED IN THE OFFICE OF THE COUNTY ENGINEER. THESE PLANS SHALL BE USED IN THE CONSTRUCTION OF THIS PROJECT:
 

ALLEYS	S-1
MINIMUM PUBLIC SAFETY REQUIREMENTS	S-2
BRICK MANHOLES	S-3
MANHOLE HOLES IN UNIMPROVED HIGHWAYS OR WAYS TO BE SET SIX INCHES ABOVE FINISHED GRADE	S-4
MANHOLES PERCAST CONCRETE MANHOLE	S-5
MANHOLE FRAMES AND COVERS	S-16
STANDARD MANHOLE STEPS	S-17
BLOCKING FOR SEWER PIPE	S-21
GRADING AND DRAINAGE	S-22
WAYS OR THE SUPPORT	S-23
REPAIRS TO EXISTING SEWERS	S-24
CHIMNEY PIPE & BASE	S-27

**COLLECT CHARGES AS INDICATED**

**NOTICE TO CONTRACTOR**

The existence and location of any underground utility pipes or structures shown on these plans are obtained by a search of the available records. To the best of our knowledge there are no existing utilities except as shown on these plans. The contractor is required to take due precautionary measures to protect the utility lines shown and any other lines not of record or not shown on these plans.

*Erinquin Rosendo*  
 S.E.E. 1177

PROFILE ALIGNMENT AND GRADE OF  
**SANITARY SEWERS** PAGE 1  
 CONSTRUCTED FOR

**TRACT No 24304**  
 PRIVATE CONTRACT NO. 8339

W.S. 70  
 2 SHEETS, 3 PAGES  
 SCALE: VERT. 1" = 4'  
 HORIZ. 1" = 40'  
 July, 1969  
 PREPARED IN THE OFFICES OF  
**CONSOLIDATED ENGINEERING CO.**  
 8845 OLYMPIC BLVD.  
 BEVERLY HILLS, CALIFORNIA  
 REG. C. E. NO. 10813

NOTES:

GRADE TO WHICH THIS IMPROVEMENT IS TO BE CONSTRUCTED ARE SHOWN ON PLANS AND PROFILES. GRADE POINTS FOR TOP OF CURBS, CENTER LINE OF STREETS, OR CENTER LINE OF ALLEYS ARE SHOWN BY CIRCLES ON PROFILES. AT ALL POINTS BETWEEN DESIGNATED POINTS THE GRADE SHALL BE ESTABLISHED SO AS TO CONFORM TO A STRAIGHT LINE BETWEEN SAID DESIGNATED POINTS. ELEVATIONS ARE IN FEET ABOVE U.S.C. & G.S. MEAN LEVEL DATUM OF 1929.

WORK SHALL BE CONDUCTED IN ACCORDANCE WITH STANDARD SPECIFICATIONS FOR PUBLIC WORKS, COUNTY OF LOS ANGELES, PREPARED BY THE COUNTY ENGINEER. THE CONTRACTOR SHALL BE RESPONSIBLE FOR THE CONSTRUCTION OF SANITARY SEWERS BEFORE WORK CAN BE STARTED. THE CONTRACTOR MUST OBTAIN A PERMIT TO EXCAVATE IN COUNTY STREETS FROM THE L.A. COUNTY ROAD DEPT. DISTRICT OFFICE IN THE COUNTY ENGINEER'S ROOM, 80, COUNTY ENGINEERING BUILDING, 100 WEST SECOND STREET OR AVENUE 10, VAN NUYS, CALIFORNIA. REGIONAL OFFICE, SUFFICIENT TO COVER THE COST OF CONSTRUCTION INSPECTION AND RECORD PLANS.

APPROVAL OF THIS PLAN BY THE COUNTY OF LOS ANGELES DOES NOT CONSTITUTE A REPRESENTATION AS TO THE ACCURACY OF THE LOCATION OF OR THE EXISTENCE OR NON-EXISTENCE OF ANY UNDERGROUND UTILITY PIPE, OR STRUCTURE WITHIN THE LIMITS OF THE PROJECT. THIS NOTE APPLIES TO ALL PAGES.

IT IS THE POLICY OF THE COUNTY OF LOS ANGELES THAT A PERMIT MUST BE OBTAINED FROM THE STATE OF CALIFORNIA, DIVISION OF HIGHWAYS, 1200 SOUTH SPRING STREET, LOS ANGELES, CALIFORNIA.

COUNTY OF LOS ANGELES, CALIFORNIA  
 JOHN A. LAMBIE, COUNTY ENGINEER J. D. PARKHURST, CHIEF ENGINEER  
 CO. SAN. DIST. NO. 8  
 APPROVED BY: *[Signature]* APPROVED BY: *[Signature]*  
 REGIONAL ENGINEER OFFICE ENGINEER

SUBMITTED BY: *[Signature]*  
 CHECKED BY: *Richard J. Fowley* 9/14/69  
 REG. C. E. NO. 118782

J. N. 0250.02

