

B.M. 86 1873 ELEV. 614.209  
 COUNTY SURVEYOR MONUMENT IN WELL 30' DOWN  
 NEAR CTR. OF TRAFFIC ISLAND AT INT. OF VALLEY BLVD.  
 LA PUENTE RD. & GRAND AVE. M.K.D. (BM 11-95)  
 OTTERBEIN QUAD. 19 65

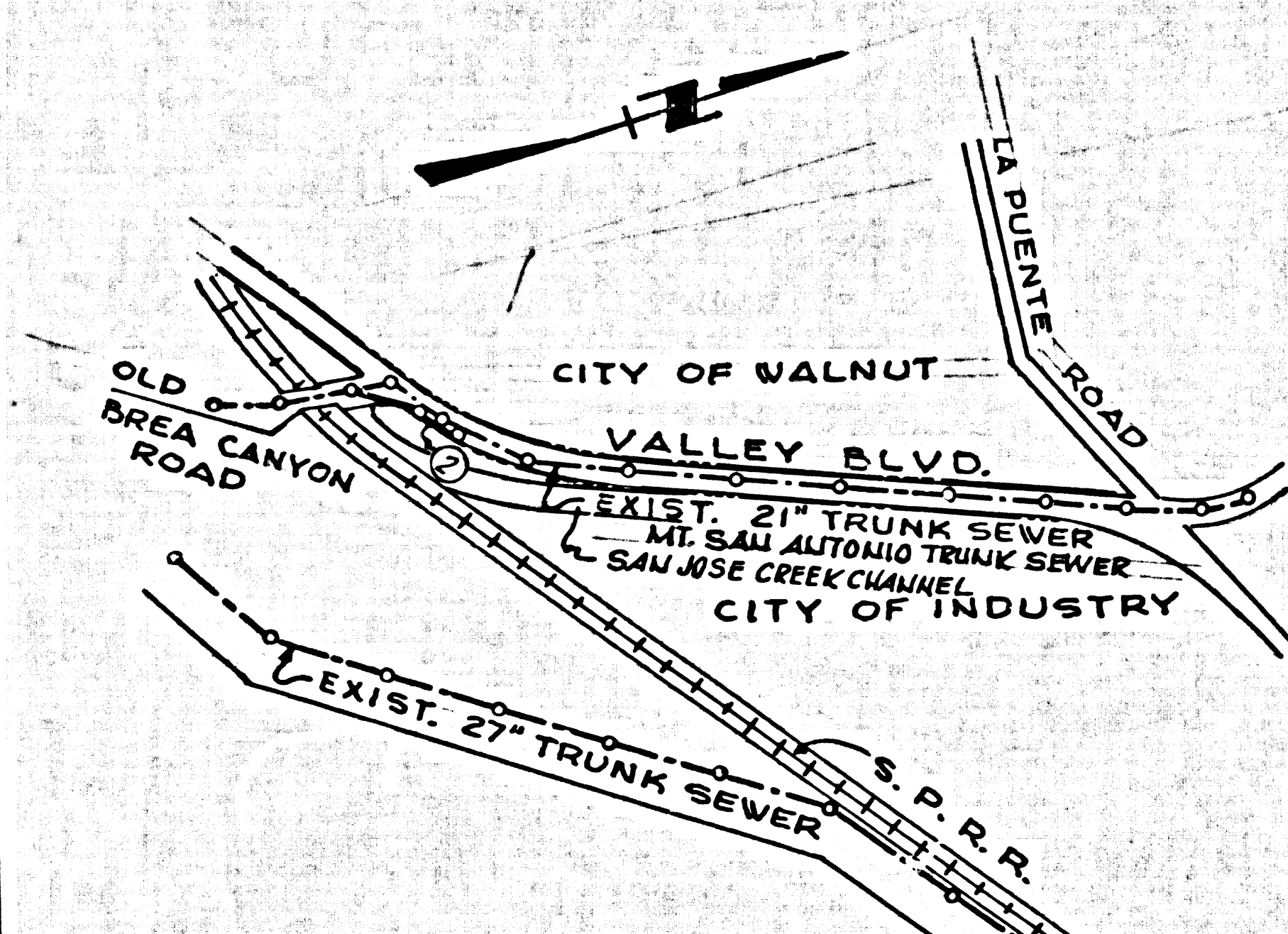

INDEX MAP  
 SCALE: 1" = 600'  
 P.C. 8348

LA PUENTE BLDG. DIST. NO. 2

- NOTES:
1. PROVIDE STAKES ON THE PROPERTY LINE OR PROPERTY LINES PRODUCED AT RIGHT ANGLES TO THE SEWER LINE AT THE CENTER LINE OF EACH MANHOLE.
  2. NO REPRESENTATIVE OF THE COUNTY ENGINEER WILL SURVEY OR LAY OUT ANY PORTION OF THE WORK.
  3. THE PRIVATE ENGINEER SHALL FURNISH THE COUNTY ENGINEER WITH GRADE SHEETS AND STATIONING FOR ALL HOUSE LATERALS AND 12" OR 14" BRANCHES AND SMALL PROVIDE STAKES FOR THEM AT THEIR PROPER LOCATIONS WITH STATIONING PLAINLY MARKED. ALL HOUSE LATERALS SHALL BE CONSTRUCTED IN A STRAIGHT ALIGNMENT AT RIGHT ANGLES FROM THE MAIN LINE SEWER EXCEPT AS SHOWN ON THE PLANS. HOUSE LATERALS FROM CHIMNEYS SHALL NOT HAVE AN ANGLE OF LESS THAN 45° WITH THE MAIN LINE SEWER. ANY CHANGE IN ALIGNMENT SHALL BE REQUESTED IN WRITING BY THE PRIVATE ENGINEER.
  4. THE PRIVATE ENGINEER SHALL FURNISH THE HOUSE LATERAL DEPTH AT THE PROPERTY LINE FROM THE TOP OF CURB ELEVATION FOR EACH HOUSE LATERAL ON THE GRADE SHEET.
  5. NO REVISIONS SHALL BE MADE IN THESE PLANS WITHOUT THE APPROVAL OF THE COUNTY ENGINEER.
  6. THE CONTRACTOR SHALL NOTIFY THE CONSTRUCTION DIVISION BY TELEPHONE, MADISON 9-4747, EXT. 8159, AT LEAST TWENTY-FOUR HOURS BEFORE STARTING ANY WORK UNDER THIS CONTRACT.
  7. ALL STRUCTURES SHALL BE EITHER BRICK MANHOLES PER S-4 OR S-4, OR PRECAST CONCRETE MANHOLES PER S-4 OR S-4, EXCEPT AS NOTED.
  8. 12" OR 14" BRANCHES MAY BE USED FOR CONNECTIONS TO MAINLINE SEWER EXCEPT AS NOTED.
  9. MANHOLE TOPS IN UNIMPROVED RIGHTS-OF-WAY TO BE SIX INCHES ABOVE FINISHED GRADE.
  10. USE EXTRA STRENGTH PIPE. ALL PIPE IS STANDARD UNLESS OTHERWISE SPECIFIED.
  11. INTERFED CLAY PIPE SHALL BE 12" OR 14" V.C.P. PER STANDARD SPECIFICATIONS SECTION 205-2.
  12. IF A POWER POLE IS WITHIN THREE FEET OF THE SEWER, THE SEWER SHALL BE ENCASED, PER S-23, TWO FEET ON EACH SIDE FROM THE POINT OF INTERFERENCE.
  13. IF DURING THE COURSE OF CONSTRUCTION IT IS DETERMINED THAT THERE IS LESS THAN FOUR FEET OF COVER OVER THE TOP OF A MAIN LINE OR HOUSE LATERAL V.C.P. SEWER WHICH IS NOT INDICATED ON THE PLANS, THE PIPE SHALL BE ENCASED PER S-23, UNLESS OTHERWISE APPROVED BY THE COUNTY ENGINEER.
  14. HOUSE LATERALS TO BE CONSTRUCTED AT 14" DEPTH PER PART 7 TO PROPERTY LINE.
  15. RESURFACE ALL TRENCHES WITHIN PAVED AREAS TO MEET L.A. COUNTY ROAD DEPT. OR CALIFORNIA STATE HIGHWAY REQUIREMENTS BY ACCORDANCE WITH PERMITS.
  16. SEWERS TO BE TESTED FOR LEAKAGE PER SECTION 204-2.22 UNIFORM STANDARD SPECIFICATIONS.
  17. REFER TO SECTION 204-2.11 OF THE STANDARD SPECIFICATIONS REGARDING SAFETY BARRIERS.
  18. ALL UNPAVED AREAS MUST BE PROTECTED AND UNPAVED CLAY PIPE SHALL BE MADE WITH A RUBBER SLEEVE UNDER THE 12" OR 14" V.C.P. PIPE UNLESS OTHERWISE SPECIFIED PER SECTION 205-2.

LEGEND

MULTIPLYING PUBLIC SAFETY REQUIREMENTS	S-1
BRICK MANHOLE	S-4
UNREINFORCED PRECAST CONCRETE MANHOLE	S-4
UNREINFORCED PRECAST CONCRETE MANHOLE	S-4
MANHOLE FRAMES AND COVERS	S-5
STANDARD MANHOLE STEPS	S-7
GRADING FOR SEWER DUES	S-23
GRADING AND ENCASUREMENT	S-23
PIPE OR TRENCH SURVEY	S-23
ALLOWABLE TRENCH WIDTHS	S-23

COLLECT CHARGES AS INDICATED

County Sanitation Districts shall be notified prior to the following so that required inspections can be made (Phone 537-1028 or 4-600-9977)  
 Breaking into existing manhole on District trunk sewer.  
 Acceptance of the project.

PROFILE ALIGNMENT AND GRADE OF  
 SANITARY SEWERS  
 CONSTRUCTED IN

P.C. 8348  
 PAGE 1  
 VALLEY BOULEVARD  
 PRIVATE CONTRACT NO. 8348

W.S. 39  
 1 SHEET OF 2 PAGES  
 SCALE: VERT. 1" = 4' HORIZ. 1" = 40'  
 MARCH 1970  
 PREPARED IN THE OFFICES OF  
 Mc DANIEL & ASSOCIATES  
 500 N. ANAHEIM BLVD. ANAHEIM, CALIF.  
 REG. C. E. NO. 9808

FOR LEGEND SEE PLAN NO. S-1

NOTE:  
 GRADES TO WHICH THIS IMPROVEMENT IS TO BE CONSTRUCTED ARE SHOWN ON PLANS AND PROFILES. GRADE POINTS FOR POP-UP CURBS, CENTER LINE OF STREETS OR CENTER LINE OF ALLEYS ARE SHOWN BY CIRCLES ON PROFILES AT ALL POINTS BETWEEN DESIGNATED POINTS THE GRADE SHALL BE ESTABLISHED TO ADJUST TO A STRAIGHT LINE DRAWN BETWEEN SAID DESIGNATED POINTS. ELEVATIONS ARE IN FEET ABOVE U.S.C. & G.S. SEA LEVEL DATUM OF 1929.

WORK SHALL BE CONSTRUCTED ACCORDING TO THE STANDARD SPECIFICATIONS FOR PUBLIC WORKS MAINTENANCE, 1970 EDITION, L.A. COUNTY ENGINEER'S OFFICE, 500 N. ANAHEIM BLVD., ANAHEIM, CALIF. 92806, DATED APRIL 7, 1970. THESE SPECIFICATIONS SHALL BE THE BASIS OF CONTRACT ADMINISTRATION BY THE COUNTY OF LOS ANGELES, COUNTY ENGINEER'S OFFICE, DISTRICT OFFICE NO. 1, 150 WEST SECOND STREET, LOS ANGELES, CALIF. 90012. CONTRACTOR SHALL BE RESPONSIBLE TO COVER THE COST OF THE 12" WEST SECOND STREET OF THE COUNTY OF LOS ANGELES, COUNTY ENGINEER'S OFFICE, DISTRICT OFFICE NO. 1, 150 WEST SECOND STREET, LOS ANGELES, CALIF. 90012. APPROVAL OF THIS PLAN BY THE COUNTY OF LOS ANGELES DOES NOT CONSTITUTE A REPRESENTATION AS TO THE ACCURACY OF THE LOCATION OR THE EXISTENCE OR NON-EXISTENCE OF ANY UNDERGROUND UTILITY PIPE, OR STRUCTURE WITHIN THE LIMITS OF THIS PROJECT. THIS NOTE APPLIES TO ALL PAGES.

COUNTY OF LOS ANGELES, CALIFORNIA  
 JOHN A. LAMBIE, COUNTY ENGINEER  
 J. D. PARKHURST, CHIEF ENGINEER  
 APPROVED BY: [Signature]  
 APPROVED BY: [Signature]  
 SUBMITTED BY: [Signature]  
 CHECKED BY: Ralph Schaper 5/7/70  
 REG. C.E. NO. 13906  
 REVISION: REALIGNMENT OF 8" V.C.P. SEWER TO AVOID CONFLICT WITH 21" WATER MAIN  
 APPROVED: Ralph Schaper 5/7/70  
 REG. C.E. NO. 13906  
 J.N. 0370.00

In connection with the proposed industrial wastes shall be made to streets shown on these drawings without written permission from the Chief Engineer and General Manager of the County Sanitation Districts.

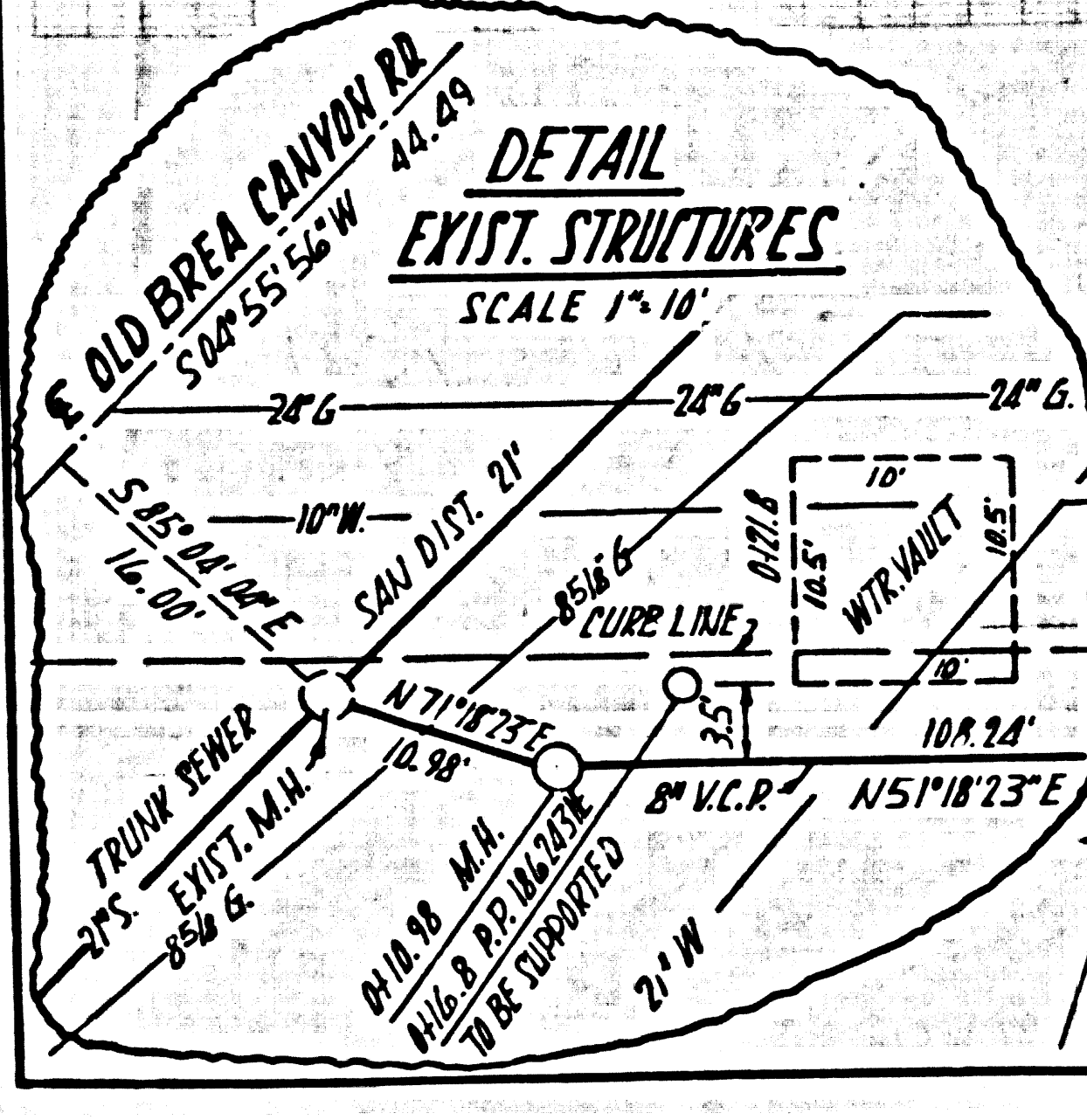
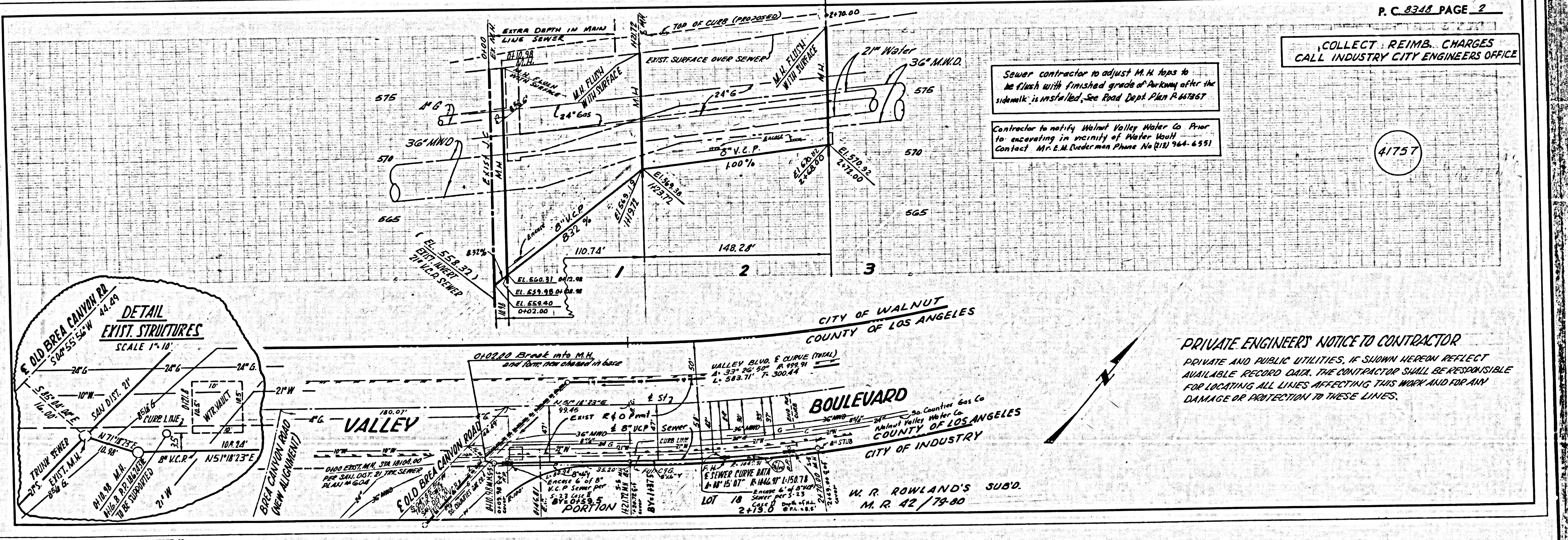

Sewer contractor to adjust M.H. tops to be flush with finished grade of Parkway after the sidewalk is installed. See Road Dept. Plan R. 647367  
 Contractor to notify Walnut Valley Water Co. Prior to encroaching in vicinity of Water Vault Contact: Mr. E.M. Underman Phone No (818) 764-6551

PRIVATE ENGINEER'S NOTICE TO CONTRACTOR  
 PRIVATE AND PUBLIC UTILITIES, IF SHOWN HEREON REFLECT AVAILABLE RECORDED DATA. THE CONTRACTOR SHALL BE RESPONSIBLE FOR LOCATING ALL LINES AFFECTING THIS WORK AND FOR ANY DAMAGE OR PROTECTION TO THESE LINES.