

B.M. B.O. 3109 ELEV. 582.971  
 R.D.B.M. TAG E. CO. 1 FT. N. B.C.R. @ NE COR. 5TH  
 AVE. & CANNON GROVE DR. 80 FT. N. & 18 FT. E. APPROX.  
 & INT.  
 OTTERBEIN QUAD. 19 65

THE FOLLOWING LATEST REVISED STANDARD DETAILS IN THIS OFFICE OF THE COUNTY ENGINEER  
 SHALL APPLY IN THE CONSTRUCTION OF THIS PROJECT

LETTERS  
 MINIMUM PUBLIC UTILITY REQUIREMENTS 5-1  
 DETAIL MANHOLE PRECAST CONCRETE MANHOLE 5-2  
 MANHOLE FRAMING AND COVER 5-3  
 BEDDING FOR SEWER PIPES 5-4  
 VENTILATION AND CLEANOUTS 5-5  
 VENTILATION AND CLEANOUTS 5-6  
 ALLOWABLE TRENCH WIDTHS 5-7

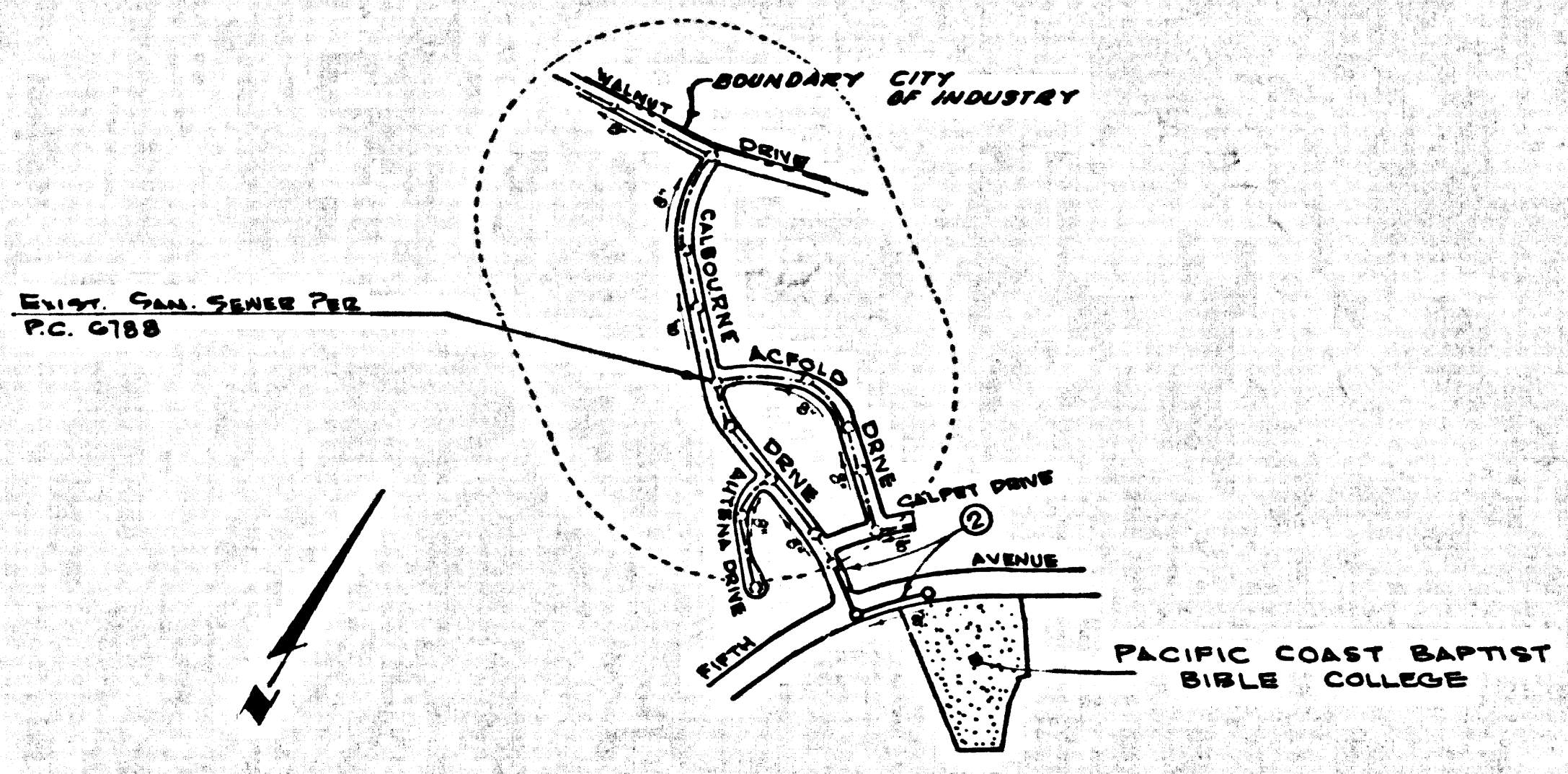

INDEX MAP  
 SCALE 1"=600'  
 PACIFIC COAST BAPTIST  
 BIBLE COLLEGE  
 P.C. 8359

LA PUENTE BLDG. DIST. NO. 2

- NOTES:
1. PROVIDE STAKES ON THE PROPERTY LINE OR PROPERTY LINES PRODUCED AT RIGHT ANGLES TO THE SEWER LINE AT THE CENTER LINE OF EACH MANHOLE.
  2. NO REPRESENTATIVE OF THE COUNTY ENGINEER WILL SURVEY OR LAY OUT ANY PORTION OF THE WORK.
  3. THE PRIVATE ENGINEER SHALL MAINTAIN THE COUNTY ENGINEER WITH GRADE SHEETS AND STATIONING FOR ALL HOUSE LATERALS AND "T" OR "Y" BRANCHES AND SHALL PROVIDE STAKES FOR THEM AT THEIR PROPER LOCATIONS WITH STATIONING PLAINLY MARKED. ALL HOUSE LATERALS SHALL BE CONSTRUCTED IN A STRAIGHT ALIGNMENT AT RIGHT ANGLES FROM THE MAIN LINE SEWER EXCEPT AS SHOWN ON THE PLANS. HOUSE LATERALS FROM CHIMNEYS SHALL NOT HAVE AN ANGLE OF LESS THAN 45° WITH THE MAIN LINE SEWER. ANY CHANGE IN ALIGNMENT SHALL BE REQUESTED IN WRITING BY THE PRIVATE ENGINEER.
  4. THE PRIVATE ENGINEER SHALL FINISH THE HOUSE LATERAL DEPTH AT THE PROPERTY LINE BELOW 7" BE TOP OF CURB ELEVATION FOR EACH HOUSE LATERAL ON THE GRADE SHEET.
  5. NO REVISIONS SHALL BE MADE IN THESE PLANS WITHOUT THE APPROVAL OF THE COUNTY ENGINEER.
  6. THE CONTRACTOR SHALL NOTIFY THE CONSTRUCTION DIVISION BY TELEPHONE, MADISON 9-4747, EXT. 81281, AT LEAST TWENTY-FOUR HOURS BEFORE STARTING ANY WORK UNDER THIS CONTRACT.
  7. ALL STRUCTURES SHALL BE EITHER BRICK MANHOLES PER 5-3 OR PRECAST CONCRETE MANHOLES PER 5-2 OR 5-4, EXCEPT AS NOTED.
  8. "Y" BRANCHES MAY BE USED FOR CONNECTIONS TO MAIN SEWER EXCEPT AS NOTED.
  9. MANHOLE TOPS IN UNIMPROVED RIGHTS-OF-WAY TO BE SIX INCHES ABOVE FINISHED GRADE.
  10. USE DETAILS SHOWN HEREIN FOR ALL PIPE IN STANDARD SIZES EXCEPT AS NOTED.
  11. INTERIOR CLAY PIPE SHALL BE 12" OR 15" PER STANDARD SPECIFICATIONS 508-2.
  12. IF A POWER POLE IS WITHIN THREE FEET OF THE SEWER, THE SEWER SHALL BE ENCASED, PER 5-23, TWO FEET ON EACH SIDE FROM THE POINT OF INTERFERENCE.
  13. IF DURING THE COURSE OF CONSTRUCTION IT IS DETERMINED THAT THERE IS LESS THAN FOUR FEET OF COVER OVER THE TOP OF A MAIN LINE OR HOUSE LATERAL V.C.P. SEWER WHICH IS NOT INDICATED ON THE PLANS, THE PIPE SHALL BE ENCASED PER 5-23, UNLESS OTHERWISE APPROVED BY THE COUNTY ENGINEER.
  14. HOUSE LATERALS TO BE CONSTRUCTED WITH INVERTS AT PROPERTY LINE & FIVE FEET BELOW CURB GRADE EXCEPT AS NOTED.
  15. REFACE ALL TRENCHES WITHIN PAVED AREAS TO MEET LA COUNTY ROAD DEPT. & CALIFORNIA STATE HIGHWAY REQUIREMENTS IN ACCORDANCE WITH PERMITS.
  16. SEWERS TO BE TESTED FOR LEAKAGE PER SECTION 366-232 UNIFORM STANDARD SPECIFICATIONS.
  17. REFER TO SECTION 366-232 OF THE STANDARD SPECIFICATIONS REGARDING SIFTY ORDERS.
  18. SPECIAL BACKFILL IN DESIGNATED AREAS:  
 a. BACKFILL TRENCH AND REPLACE OTHER EARTH REMOVED SO AS TO ACHIEVE THE NATURAL OR FINISHED GRADES AND SLOPES SHOWN ON THE GRADING PLAN APPROVED FOR THIS TRACT BY THE BUILDING AND SAFETY DIVISION.  
 b. ALL BACKFILL AND EARTH REPLACES SHALL BE COMPACTED TO A MINIMUM OF 95% OF MAXIMUM DENSITY PER A.S.T.M. STANDARD METHOD OF TEST 99A-57 AS MONITORED. ACCEPTABLE CERTIFICATION OF SUCH COMPACTION SHALL BE SUBMITTED TO THE CONSTRUCTION DIVISION.
  19. ALL JOINTS BETWEEN CAST IRON PIPE AND VITRIFIED CLAY PIPE SHALL BE MADE WITH A RUBBER SLEEVE JOINT PER "C" OR "D" (WITH BUSHING IF NECESSARY) PER STANDARD SPECIFICATIONS SECTION 508-2.
  20. NO WORK SHALL BE PERFORMED DURING RAINY WEATHER.

No connections for the disposal of industrial wastes shall be made to sewers shown on these plans without written permission from the Chief Engineer and General Manager of the County Sanitation Districts.

COLLECT CHARGES AS INDICATED

County Sanitation Districts shall be notified prior to the following so that required inspection can be made (Phone 287-1025 - 099-8899)

Acceptance of the project.

PROFILE ALIGNMENT AND GRADE OF  
 SANITARY SEWERS  
 CONSTRUCTED IN  
 CALBOURNE DRIVE

PRIVATE CONTRACT NO. 8359

W.S. 39-AA  
 SHEET 2 PAGES

SCALE: VERT. 1"=4' HORIZ. 1"=40' AUGUST, 1969

PREPARED IN THE OFFICES OF  
 HAROLD L. JOHNSON ENGINEERING  
 641 WEST GLENNDALE STREET, COVINA, CALIF. ED 29114  
 BY: *Harold L. Johnson* REG. C. E. NO. 1969

FOR LEGEND SEE PLAN NO. S-1

NOTE:  
 GRADES TO WHICH THIS IMPROVEMENT IS TO BE CONSTRUCTED ARE SHOWN ON PLANS AND PROFILES. GRADE POINTS FOR TOP OF CURB, COVER LINE OF STREETS, OR CENTER LINE OF ALLEYS ARE SHOWN BY CIRCLES ON PROFILES. AT ALL POINTS BETWEEN DESIGNATED POINTS THE GRADE SHALL BE ESTABLISHED SO AS TO CONFORM TO A STRAIGHT LINE DRAWN BETWEEN SAID DESIGNATED POINTS. ELEVATIONS ARE IN FEET ABOVE M.S.L. & C.E. SEA LEVEL DATUM OF 1929.

STANDARD SPECIFICATIONS FOR PUBLIC WORKS CONSTRUCTION (1967 EDITION, WITH 1968 & 1969 SUPPLEMENTS) AND COUNTY ENGINEER SPECIAL PROVISIONS DATED JAN. 1, 1969 AND AMENDMENTS PREPARED ONLY IN THE PRESENCE OF THE COUNTY ENGINEER.  
 BEFORE WORK CAN BE STARTED, THE CONTRACTOR MUST OBTAIN A PERMIT TO EXCAVATE IN COUNTY STREETS FROM THE LA COUNTY ROAD DEPT. SERVICE OFFICE NO. 1.  
 APPROVAL OF THIS PLAN BY THE COUNTY OF LOS ANGELES DOES NOT CONSTITUTE A REPRESENTATION AS TO THE ACCURACY OF THE LOCATION OF OR THE EXISTENCE OR NON-EXISTENCE OF ANY UNDERGROUND UTILITY PIPE, OR STRUCTURE WITHIN THE LIMITS OF THE PROJECT. THIS NOTE APPLIES TO ALL PAGES.  
 IF WORK IS TO BE DONE IN A STATE HIGHWAY, A PERMIT MUST BE OBTAINED FROM THE STATE OF CALIFORNIA, DIVISION OF HIGHWAYS, 126 SOUTH SPRING STREET, LOS ANGELES, CALIFORNIA.

COUNTY OF LOS ANGELES, CALIFORNIA  
 JOHN A. LAMBIE, COUNTY ENGINEER J. D. PARKHURST, CHIEF ENGINEER  
 APPROVED BY: *John A. Lambie* APPROVED BY: *J. D. Parkhurst*  
 SAN DIMAS REGIONAL ENGINEER OFFICE ENGINEER

CHECKED BY: *Ralph A. Lapa* 2-27-70  
 REG. C.E. NO. 13466

41795

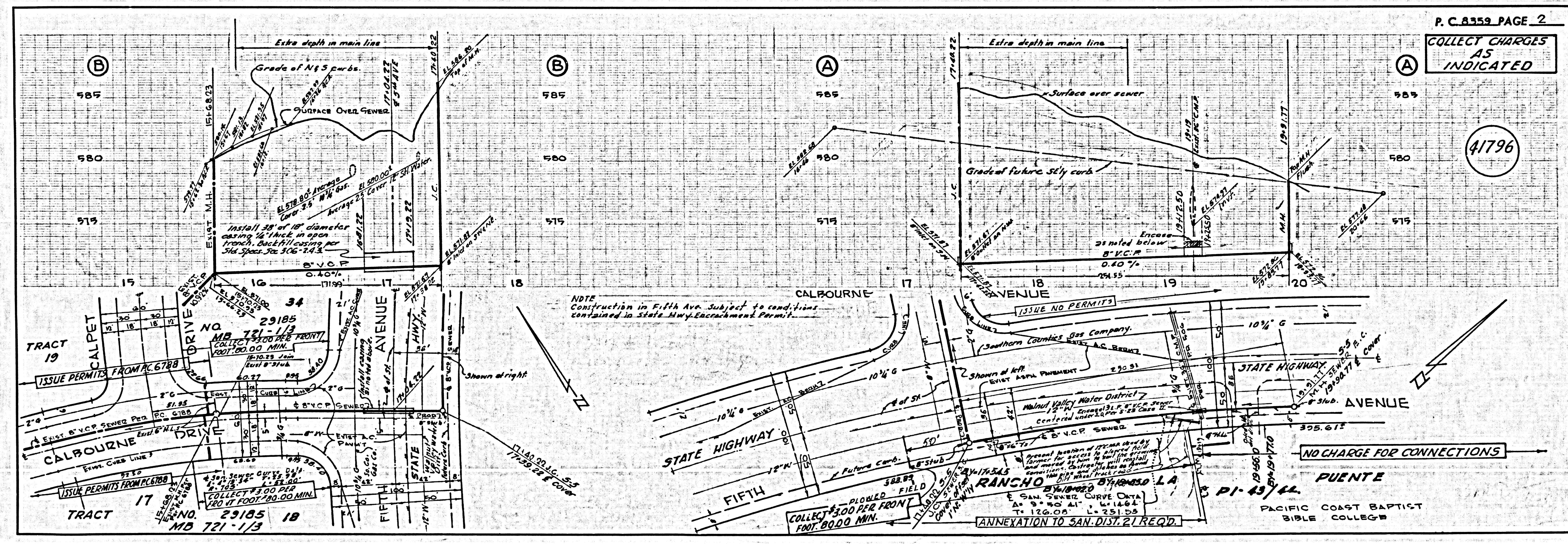

P.C. 8359 PAGE 2  
 COLLECT CHARGES AS INDICATED

41796