

B.M. BL 2203 ELEV. 2323.037  
 C. & M. MON. IN WELL @ E. INT.  
 AVENUE "I" AND 20TH ST. W.  
 MARKED (SEC. COR. 891710  
 R. 12 W., T. 7 N.)  
 LANCASTER QUAD. 1965

LANCASTER BLDG. DIST. NO. 8.0

PROFILE, ALIGNMENT AND GRADE OF  
 SANITARY SEWERS PAGE 1  
 CONSTRUCTED IN

AVENUE "I" 42183  
 PRIVATE CONTRACT NO. 8400  
 W.S. 71-D-4  
 1 SHEETS; 2 PAGES

SCALE: HORIZ. 1" = 40' VERT. 1" = 4'  
 JANUARY 16, 1970  
 PREPARED IN THE OFFICES OF  
 HOLM, TAIT, AND ASSOC.

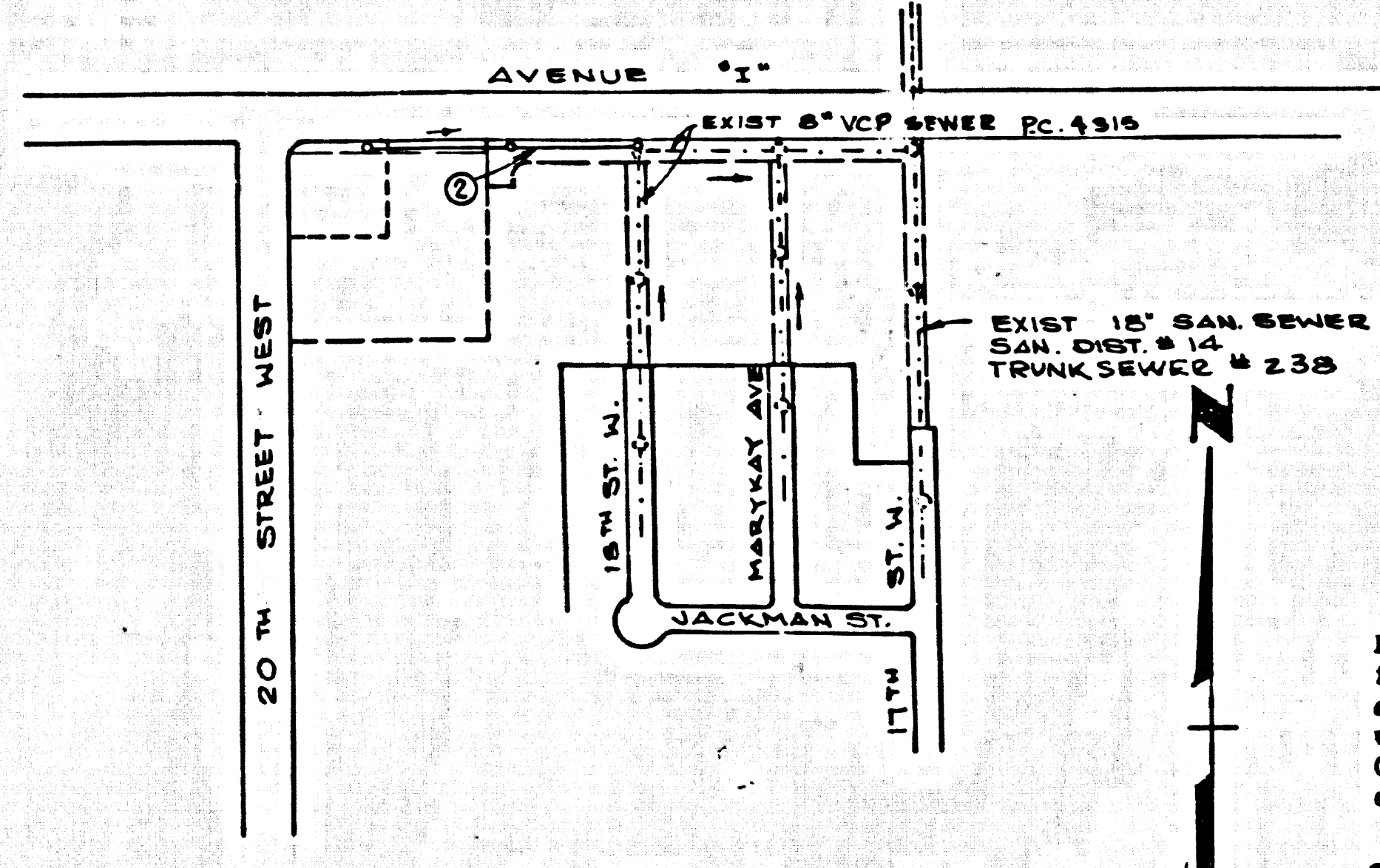

INDEX MAP  
 SCALE: 1" = 400'  
 P.C. 8400  
 ② INDICATES PAGE NO.

No connections for the disposal of industrial wastes shall be made to sewers shown on these drawings without written permission from the Chief Engineer and General Manager of the County Sanitation Districts.  
 County Sanitation Districts shall be notified prior to the following so that required inspection can be made (Phone 337-1025 or 656-3097)

Acceptance of the project.

- NOTES:
- PROVIDE STAKES ON THE PROPERTY LINE OR PROPERTY LINES PRODUCED AT RIGHT ANGLES TO THE SEWER LINE AT THE CENTER LINE OF EACH MANHOLE.
  - NO REPRESENTATIVE OF THE COUNTY ENGINEER WILL SURVEY OR LAY OUT ANY PORTION OF THE WORK.
  - THE PRIVATE ENGINEER SHALL FURNISH THE COUNTY ENGINEER WITH GRADE SHEETS AND STATIONING FOR ALL "T" OR "T" BRANCHES AND SHALL PROVIDE STAKES FOR TYPIC AT THEIR PROPER LOCATIONS WITH STATIONING PLAINLY MARKED.
  - THE PRIVATE ENGINEER SHALL BE RESPONSIBLE FOR THE PROTECTION OF ALL EXISTING UTILITIES AND STRUCTURES.
  - NO REVISIONS SHALL BE MADE IN THESE PLANS WITHOUT THE APPROVAL OF THE COUNTY ENGINEER.
  - THE CONTRACTOR SHALL NOTIFY THE CONSTRUCTION DIVISION BY TELEPHONE, MADISON 9-4747, EXT. 81551, AT LEAST TWENTY-FOUR HOURS BEFORE STARTING ANY WORK UNDER THIS CONTRACT.
  - ALL STRUCTURES SHALL BE EITHER BRICK MANHOLES PER S-3 OR PRECAST CONCRETE MANHOLES PER S-34.
  - "T" OR "T" BRANCHES MAY BE USED FOR CONNECTIONS TO MAINLINE SEWERS.
  - ALL H. TOPS IN UNIMPROVED AREAS TO BE SIX INCHES ABOVE FINISHED GRADE EXCEPT AS NOTED.
  - USE EXTRA STRENGTH PIPE ALL PIPE IS STANDARD DEPTH EXCEPT AS NOTED.
  - VITRIFIED CLAY PIPE JOINTS SHALL BE TYPE "B", "F", OR "G" PER STANDARD SPECIFICATIONS SECTION 308.2.
  - IF A POWER POLE IS WITHIN THREE FEET OF THE SEWER, THE SEWER SHALL BE ENCASED, PER S-23, TWO FEET ON EACH SIDE FROM THE POINT OF INTERFERENCE.
  - IF DURING THE COURSE OF CONSTRUCTION IT IS DETERMINED THAT THERE IS LESS THAN FOUR FEET OF COVER OVER THE TOP OF A MAIN LINE OR HOUSE LATERAL V.C.P. SEWER WHICH IS NOT INDICATED ON THE PLANS, THE PIPE SHALL BE ENCASED PER S-23, UNLESS OTHERWISE APPROVED BY THE COUNTY ENGINEER.
  - RESURFACE ALL TRENCHES WITHIN PAVED AREAS TO MEET L.A. COUNTY ROAD DEPT. OR CALIFORNIA STATE HIGHWAY REQUIREMENTS IN ACCORDANCE WITH PERMITS.
  - SEWERS TO BE TESTED FOR LEAKAGE PER SECTION 306.3.3.7 OF THE STANDARD SPECIFICATIONS.
  - REFER TO SECTION 7.10.1.1 OF THE STANDARD SPECIFICATIONS, REGARDING SAFETY ORDERS.
  - ALL JOINTS BETWEEN CAST IRON PIPE AND VITRIFIED CLAY PIPE SHALL BE MADE WITH A RUBBER SLEEVE JOINT, TYPE "C" OR "D", WITH BUSHING IF NECESSARY PER STANDARD SPECIFICATIONS, SECTION 308.2.

THE FOLLOWING LATEST REVISED STANDARD PLANS ON FILE IN THE OFFICE OF THE COUNTY ENGINEER SHALL APPLY IN THE CONSTRUCTION OF THIS PROJECT.

LEGEND	S-1
MINIMUM PUBLIC SAFETY REQUIREMENTS	S-2
BRICK MANHOLE	S-3
NON-REINFORCED PRECAST CONCRETE MANHOLE	S-34
REINFORCED-PRECAST CONCRETE MANHOLE	S-35
MANHOLE FRAME AND COVER	S-36
STANDARD MANHOLE STEP	S-37
BEDDING FOR SEWER PIPE	S-38
CHANGING LINE ENCASUREMENT	S-39
WYE OR TE SUPPORT	S-40
ALLOWABLE TRENCH WIDTHS	S-41

Revised 2-1-71  
 Change invert elev. of M.H. @ I-00.00 to 2312.70.  
 Most wly M.H. moved to sta. 6+75.00.  
 Approved R.D. Kopycky 4/11/71 16742  
 Office of Co. Engr. R.E. No.

NOTE:  
 GRADES TO WHICH THIS IMPROVEMENT IS TO BE CONSTRUCTED ARE SHOWN ON PLANS AND PROFILE. GRADE POINTS FOR TOP OF CURBS, CENTER LINE OF STREETS, OR CENTER LINE OF ALLEYS ARE SHOWN BY CIRCLES ON PROFILES. AT ALL POINTS BETWEEN DESIGNATED POINTS THE GRADE SHALL BE ESTABLISHED SO AS TO CONFORM TO A STRAIGHT LINE DRAWN BETWEEN SAID DESIGNATED POINTS. ELEVATIONS ARE IN FEET ABOVE U.S.C. & G.S. SEA LEVEL DATUM OF 1929.  
 WORK SHALL BE CONSTRUCTED ACCORDING TO THE STANDARD SPECIFICATIONS FOR PUBLIC WORKS CONSTRUCTION, 1970 EDITION, 10-10-70. SPECIAL PROVISIONS FOR THE CONSTRUCTION OF SANITARY SEWERS DATED APRIL 7, 1970, AND SHALL BE PROSECUTED ONLY IN THE PRESENCE OF THE COUNTY ENGINEER.  
 BEFORE WORK CAN BE STARTED, THE CONTRACTOR MUST OBTAIN A PERMIT TO EXCAVATE IN COUNTY STREETS FROM THE L.A. COUNTY ROAD DEPT., DISTRICT OFFICE NO. 3, AND PAY A FEE TO THE COUNTY ENGINEER, ROOM 336, COUNTY ENGINEERING BUILDING, 108 WEST SECOND STREET, ANTELOPE VALLEY, REGIONAL OFFICE, SUFFICIENT TO COVER THE COST OF CONSTRUCTION INSPECTION AND RECORD PLANS.  
 APPROVAL OF THIS PLAN BY THE COUNTY OF LOS ANGELES DOES NOT CONSTITUTE A REPRESENTATION AS TO THE ACCURACY OF THE LOCATION OF OR THE EXISTENCE OR NON-EXISTENCE OF ANY UNDERGROUND UTILITY PIPE, OR STRUCTURE WITHIN THE LIMITS OF THIS PROJECT. THIS NOTE APPLIES TO ALL PAGES.  
 IF WORK IS TO BE DONE IN A STATE HIGHWAY, A PERMIT MUST BE OBTAINED FROM THE STATE OF CALIFORNIA, DIVISION OF HIGHWAYS, 130 SOUTH SPRING STREET, LOS ANGELES, CALIFORNIA.

COUNTY OF LOS ANGELES, CALIFORNIA  
 JOHN A. LAMBIE, COUNTY ENGINEER  
 J. D. PARKURST, CHIEF ENGINEER  
 CO. SAN DIST. NO. 14  
 APPROVED [Signature] 7/1/70 REGIONAL ENGINEER  
 APPROVED BY [Signature] 7/1/70 DISTRICT ENGINEER  
 CHECKED BY R.D. Kopycky 4/11/70 DATE  
 REG. C.E. NO. 16742

COLLECT CHARGES AS INDICATED

J.N. 0370.22

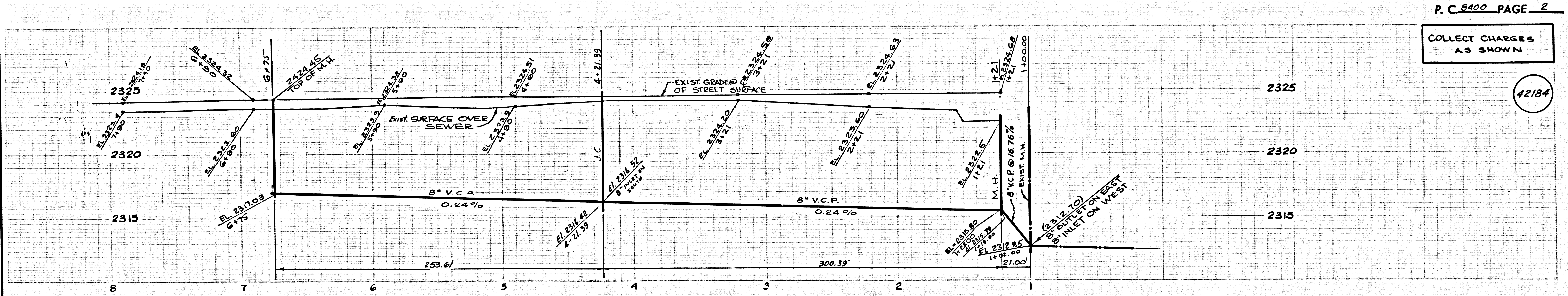

P.C. 8400 PAGE 2

COLLECT CHARGES AS SHOWN

